

# FRONT PROPELLER SHAFT ASSEMBLY (for 4WD)

## COMPONENTS

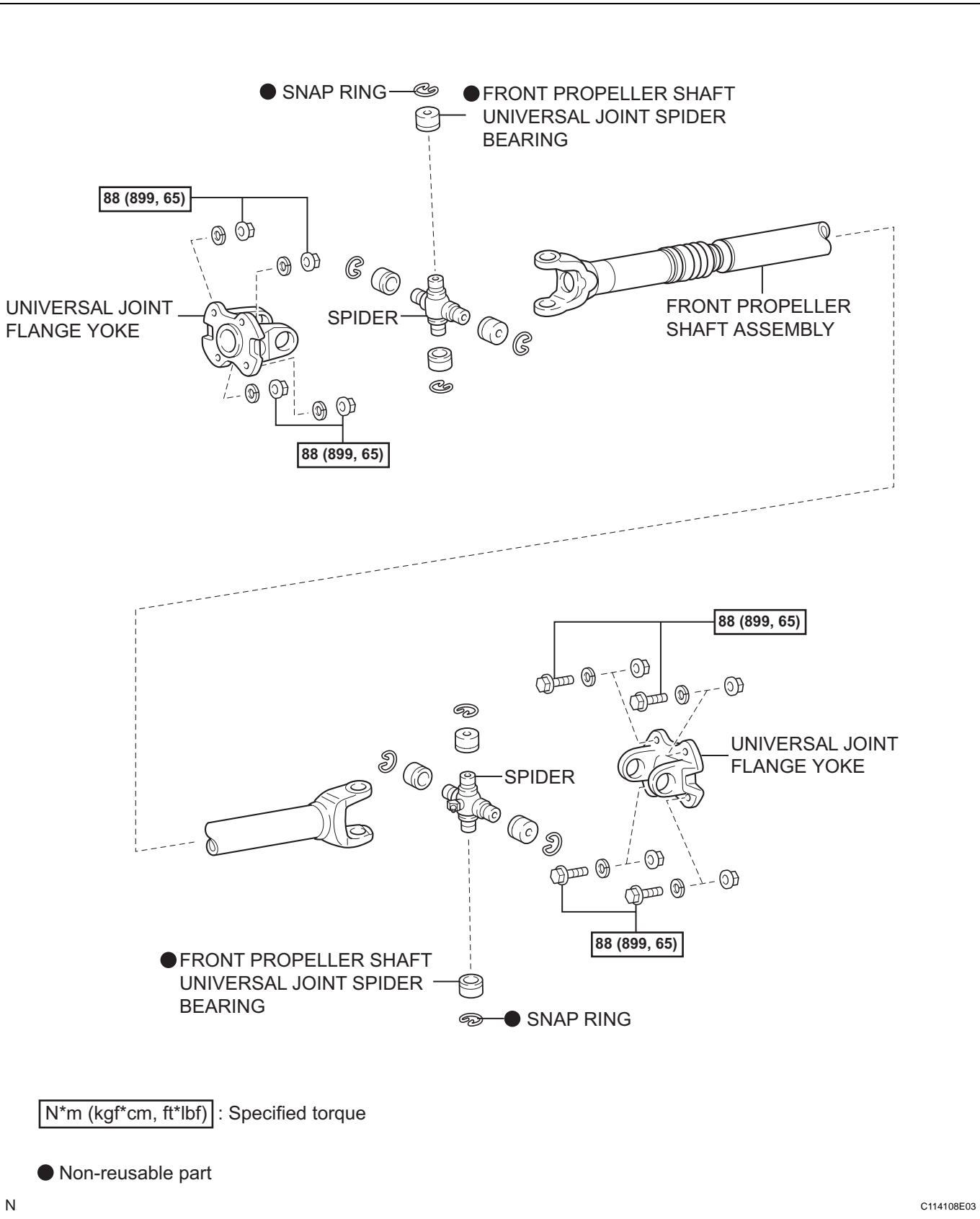

PR

## REMOVAL

1. REMOVE EXHAUST FRONT PIPE ASSEMBLY NO. 2 (for 1GR-FE) (See page [EX-3](#))

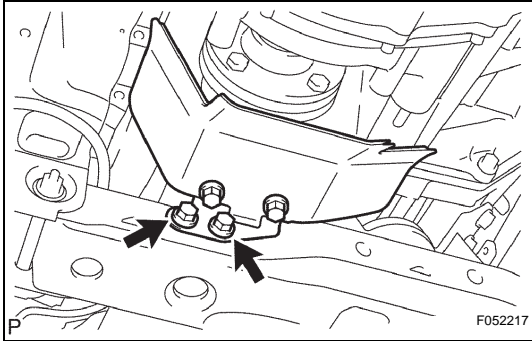

2. REMOVE PROPELLER SHAFT HEAT INSULATOR BRACKET SUB-ASSEMBLY

- (a) Remove the 2 bolts and propeller shaft heat insulator bracket.

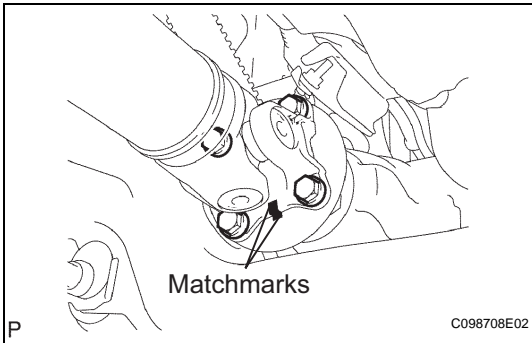

3. REMOVE FRONT PROPELLER SHAFT ASSEMBLY

- (a) Place matchmarks on the propeller shaft flange and differential flange.
- (b) Remove the 4 nuts, 4 bolts, 4 washers and front propeller shaft.

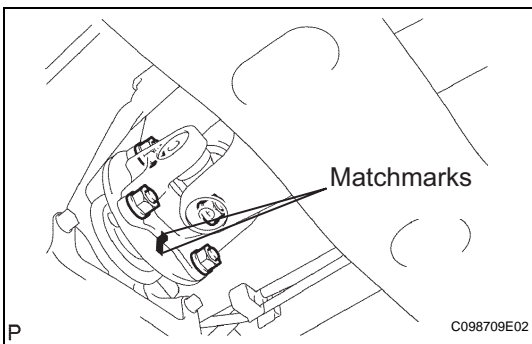

- (c) Place matchmarks on the propeller shaft flange and transfer flange.
- (d) Remove the 4 nuts, 4 washers and front propeller shaft.