

REMOVAL

1. DISCONNECT CABLE FROM NEGATIVE BATTERY TERMINAL
2. REMOVE REAR WHEEL
3. DRAIN BRAKE FLUID
4. REMOVE REAR BRAKE DRUM SUB-ASSEMBLY (See page [BR-68](#))
5. REMOVE FRONT BRAKE SHOE (See page [BR-68](#))
6. REMOVE REAR BRAKE SHOE (See page [BR-69](#))
7. REMOVE REAR SPEED SENSOR (See page [BC-304](#))
8. SEPARATE PARKING BRAKE CABLE ASSEMBLY NO. 3
 - (a) Remove the 2 bolts and disconnect the parking brake cable from the backing plate.

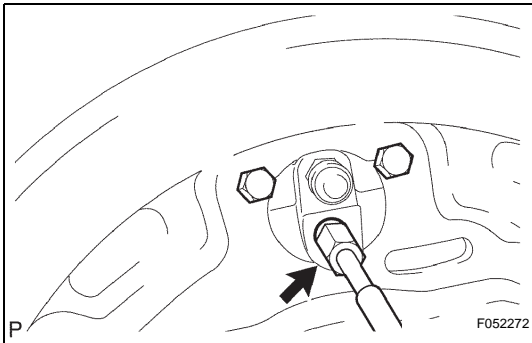

9. SEPARATE REAR BRAKE TUBE NO. 8
 - (a) Using SST, separate the brake tube, and use a container to catch the brake fluid as it flows out.
SST 09023-00101

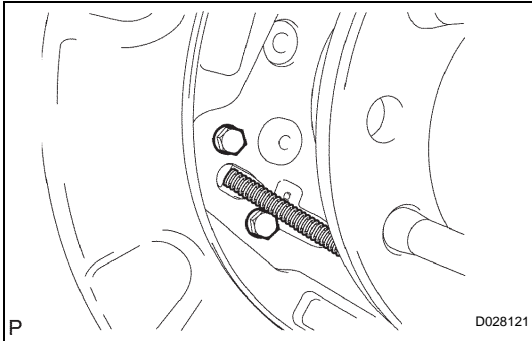
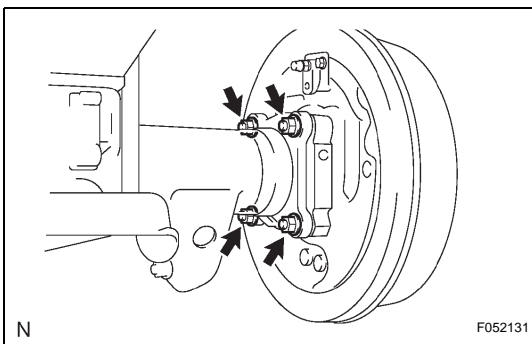

10. REMOVE REAR AXLE SHAFT WITH BACKING PLATE
 - (a) Remove the 4 nuts and rear axle shaft with backing plate.
 - (b) Remove the O-ring.

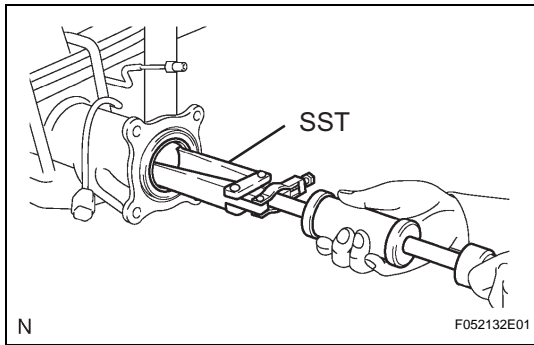

11. REMOVE REAR AXLE SHAFT OIL SEAL

- (a) Using SST, remove the oil seal.
SST 09308-00010

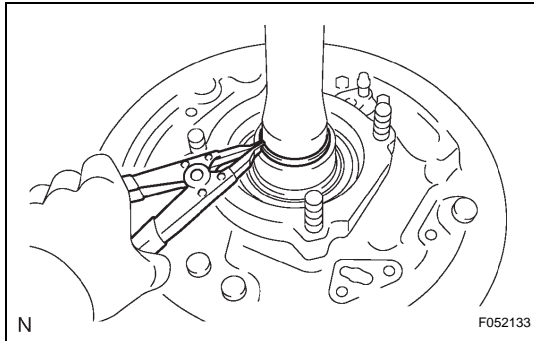

DISASSEMBLY

1. REMOVE REAR AXLE SHAFT SNAP RING

- (a) Using a snap ring expander, remove the snap ring.

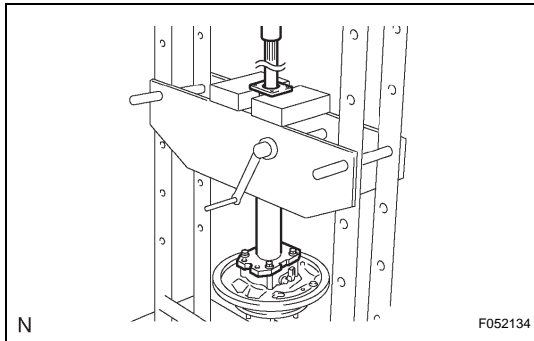

2. REMOVE REAR AXLE SHAFT

- (a) Using SST and press, remove the rear axle shaft.
SST 09521-25011, 09521-25021

3. REMOVE REAR AXLE BEARING RETAINER INNER

- (a) Remove the rear axle bearing retainer inner from the rear axle bearing.

4. REMOVE REAR AXLE SHAFT WASHER

- (a) Remove the rear axle shaft washer from the rear axle bearing.

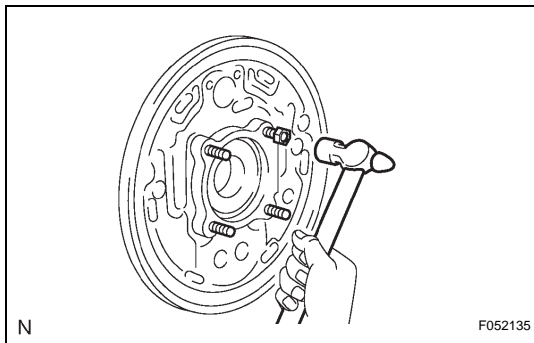

5. REMOVE REAR AXLE HUB AND BEARING ASSEMBLY

- (a) Attach the 4 nuts to the rear axle housing bolts.
 (b) Using a hammer, remove the 4 rear axle housing bolts and rear axle bearing.

NOTICE:

Do not reuse the nuts previously removed from the vehicle.

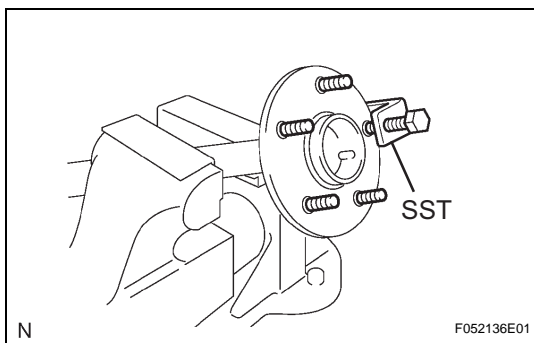

6. REMOVE REAR AXLE HUB BOLT

- (a) for 2WD:
 (1) Using SST, remove the 5 hub bolts.
SST 09650-17011
 (b) Remove the deflector and deflector gasket from the rear axle shaft.

AH

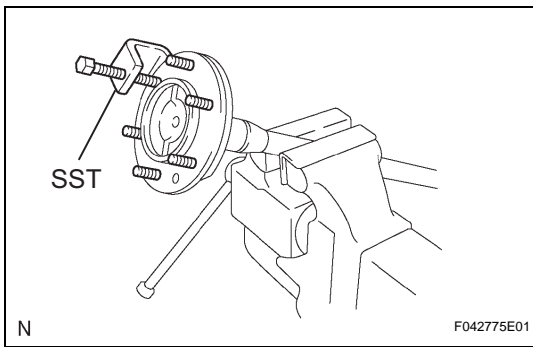

- (c) for 4WD and Pre-Runner:
 - (1) Using SST, remove the 6 hub bolts.
SST 09650-17011
- (d) Remove the deflector and deflector gasket from the rear axle shaft.

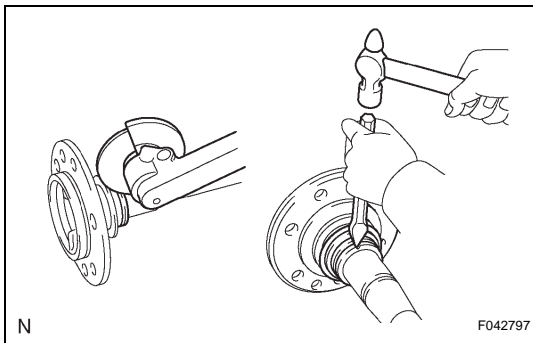

7. REMOVE REAR AXLE BEARING OIL SEAL

- (a) Grind the rear axle bearing inner race surface using a grinder, and then chisel them out with a chisel.
- (b) Remove the rear axle shaft oil seal from the rear axle shaft.

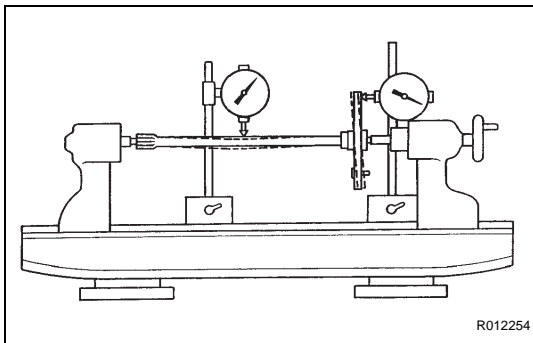

INSPECTION

1. INSPECT REAR AXLE SHAFT

- (a) Using a dial indicator, measure the runout of the shaft and flange.

Maximum runout:

Shaft runout: 1.5 mm (0.0591 in.)

Flange runout: 0.05 mm (0.0020 in.)

If the rear axle shaft or flange is damaged or worn, or the runout is greater than the maximum, replace the rear axle shaft.

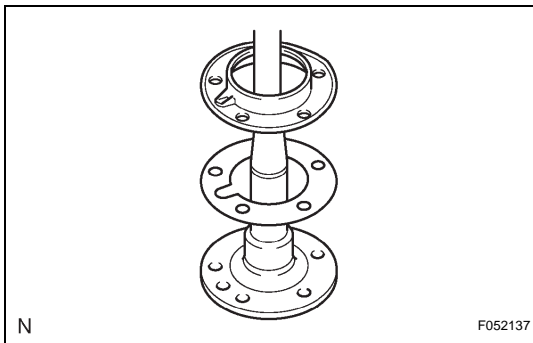

REASSEMBLY

1. INSTALL REAR AXLE HUB BOLT

- (a) for 2WD:
 - (1) Install a new deflector gasket and deflector onto the rear axle shaft.

HINT:

Make sure that the deflector and deflector gasket are installed in the correct direction shown in the illustration.

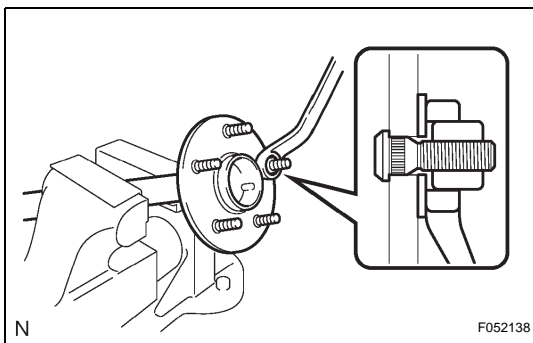

- (2) Install the 5 bolts through the axle hub.
- (3) Install a washer plate, as shown in the illustration, through the hub bolt, and install the hub bolt by tightening the hub nut.