

- (c) for 4WD and Pre-Runner:
 - (1) Using SST, remove the 6 hub bolts.
SST 09650-17011
- (d) Remove the deflector and deflector gasket from the rear axle shaft.

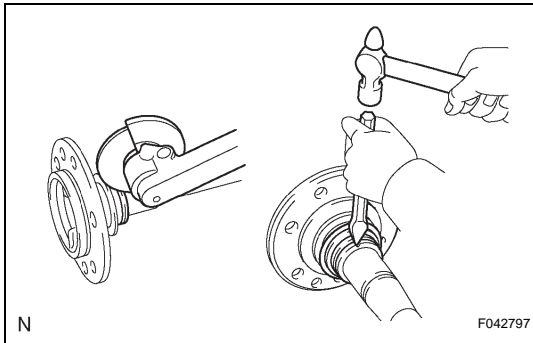

7. REMOVE REAR AXLE BEARING OIL SEAL

- (a) Grind the rear axle bearing inner race surface using a grinder, and then chisel them out with a chisel.
- (b) Remove the rear axle shaft oil seal from the rear axle shaft.

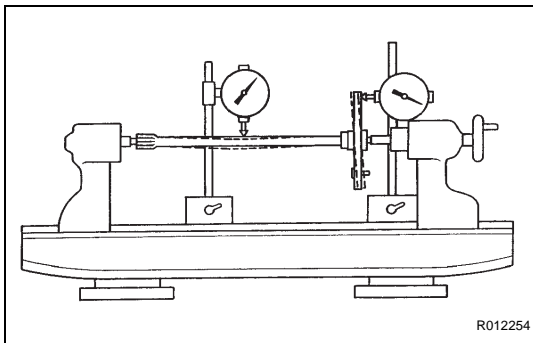

INSPECTION

1. INSPECT REAR AXLE SHAFT

- (a) Using a dial indicator, measure the runout of the shaft and flange.

Maximum runout:

Shaft runout: 1.5 mm (0.0591 in.)

Flange runout: 0.05 mm (0.0020 in.)

If the rear axle shaft or flange is damaged or worn, or the runout is greater than the maximum, replace the rear axle shaft.

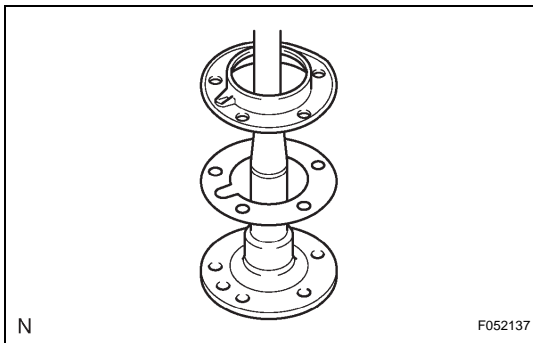

REASSEMBLY

1. INSTALL REAR AXLE HUB BOLT

- (a) for 2WD:
 - (1) Install a new deflector gasket and deflector onto the rear axle shaft.

HINT:

Make sure that the deflector and deflector gasket are installed in the correct direction shown in the illustration.

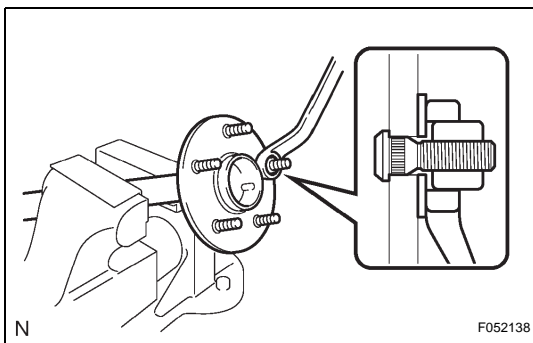

- (2) Install the 5 bolts through the axle hub.
- (3) Install a washer plate, as shown in the illustration, through the hub bolt, and install the hub bolt by tightening the hub nut.

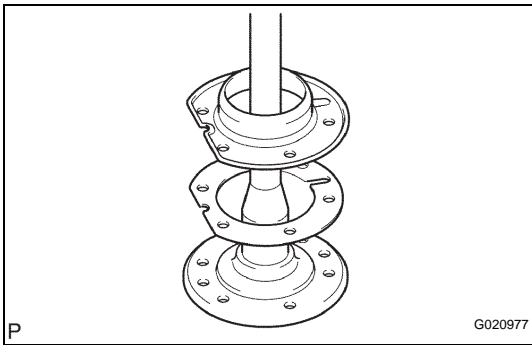

- (b) for 4WD and Pre-Runner:
 (1) Install a new deflector gasket and deflector onto the rear axle shaft.
 HINT:
 Align the 2 notches.

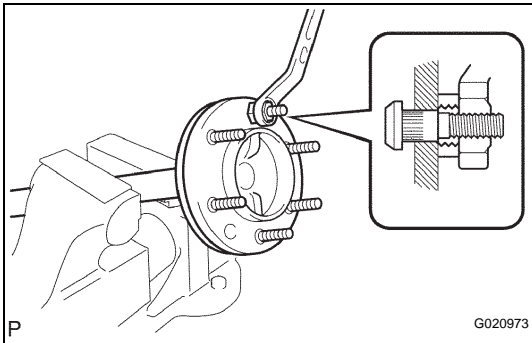

- (2) Install the 6 bolts through the axle hub.
 (3) Install the washer plate, as shown in the illustration, through the hub bolt, and install the hub bolt by tightening the hub nut.

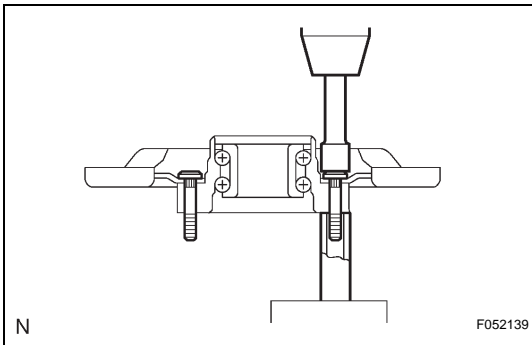

2. INSTALL REAR AXLE HUB AND BEARING ASSEMBLY

- (a) Position the backing plate on the rear axle bearing, and install the 4 parking brake plates onto the rear axle housing bolts using 2 socket wrenches and a press.

3. INSTALL REAR AXLE SHAFT WASHER

- (a) Install the rear axle shaft plate washer onto the rear axle shaft.

4. INSTALL REAR AXLE BEARING RETAINER INNER

- (a) Install a new rear axle bearing retainer inner onto the rear axle shaft.

5. INSTALL REAR AXLE SHAFT

- (a) Using SST and a press, install the rear axle shaft onto the rear axle bearing.

SST 09521-25011

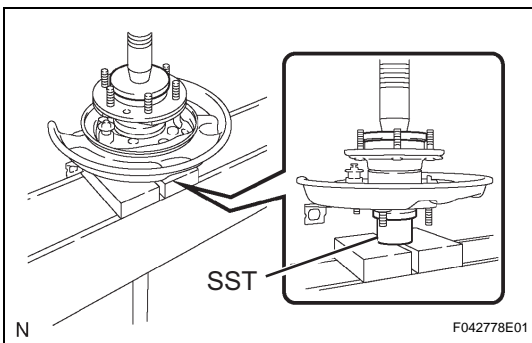

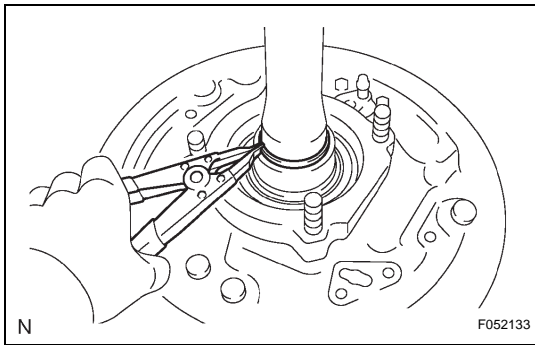

6. INSTALL REAR AXLE SHAFT SNAP RING

- (a) Using a snap ring expander, install a new snap ring.

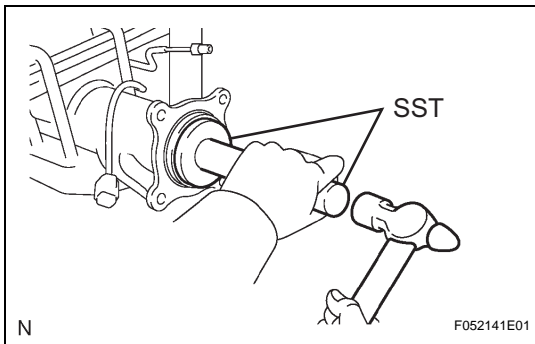

INSTALLATION

1. INSTALL REAR AXLE SHAFT OIL SEAL

- (a) Using SST and a hammer, install a new oil seal.
SST 09950-60020 (09951-00770), 09950-70010 (09951-07150)

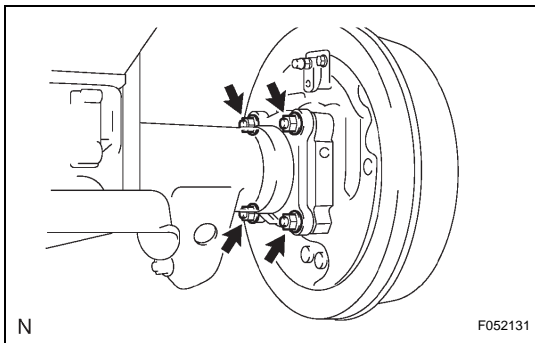

2. INSTALL REAR AXLE SHAFT WITH BACKING PLATE

- (a) Install a new O-ring.
- (b) Install the rear axle shaft with backing plate with the 4 nuts.
Torque: 36 N*m (367 kgf*cm, 27 ft.*lbf)

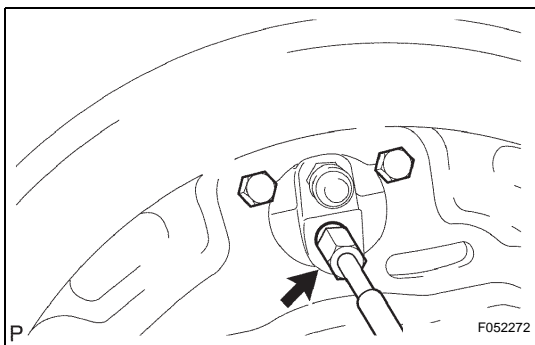

3. INSTALL REAR BRAKE TUBE NO. 8

- (a) Using SST, connect the brake tube.
SST 09023-00101
Torque: 15 N*m (155 kgf*cm, 11 ft.*lbf)

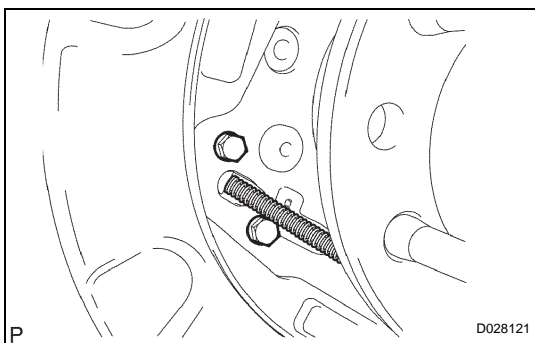

4. INSTALL PARKING BRAKE CABLE ASSEMBLY NO. 3

- (a) Install the parking brake cable with the 2 bolts onto the backing plate.
Torque: 8.0 N*m (82 kgf*cm, 71 in.*lbf)

5. INSTALL REAR SPEED SENSOR (See page [BC-304](#))

6. APPLY HIGH TEMPERATURE GREASE (See page [BR-71](#))

7. INSTALL REAR BRAKE SHOE (See page [BR-71](#))

8. INSTALL FRONT BRAKE SHOE (See page [BR-72](#))

9. **INSPECT REAR DRUM BRAKE INSTALLATION** (See page [BR-73](#))
10. **INSTALL REAR BRAKE DRUM SUB-ASSEMBLY** (See page [BR-73](#))
11. **ADJUST REAR DRUM BRAKE SHOE CLEARANCE** (See page [BR-74](#))
12. **INSTALL REAR WHEEL**
Torque: 113 N*m (1,152 kgf*cm, 83 ft.*lbf)
13. **CONNECT CABLE TO NEGATIVE BATTERY TERMINAL**
Torque: 3.9 N*m (40 kgf*cm, 35 in.*lbf)
(See page [IN-5](#))
14. **FILL RESERVOIR WITH BRAKE FLUID (w/ VSC)** (See page [BR-4](#))
15. **FILL RESERVOIR WITH BRAKE FLUID (w/o VSC)** (See page [BR-7](#))
16. **BLEED MASTER CYLINDER (w/o VSC)** (See page [BR-7](#))
17. **BLEED BRAKE LINE (w/ VSC)** (See page [BR-4](#))
18. **BLEED BRAKE LINE (w/o VSC)** (See page [BR-7](#))
19. **CHECK FLUID LEVEL IN RESERVOIR (w/ VSC)** (See page [BR-6](#))
20. **CHECK FLUID LEVEL IN RESERVOIR (w/o VSC)** (See page [BR-8](#))
21. **CHECK FOR BRAKE FLUID LEAKAGE**
22. **INSPECT PARKING BRAKE PEDAL TRAVEL** (for Automatic Transmission) (See page [PB-1](#))
23. **INSPECT PARKING BRAKE LEVER TRAVEL** (for Manual Transmission) (See page [PB-1](#))
24. **ADJUST PARKING BRAKE PEDAL TRAVEL** (for Automatic Transmission) (See page [PB-2](#))
25. **ADJUST PARKING BRAKE LEVER TRAVEL** (for Manual Transmission) (See page [PB-2](#))
26. **CHECK VSC SENSOR SIGNAL (w/ VSC)** (See page [BC-103](#))
27. **CHECK ABS SENSOR SIGNAL (w/o VSC)** (See page [BC-7](#))