

- (d) Remove the cotter pin and the nut.
- (e) Using SST, remove the front lower ball joint attachment LH.
SST 09628-00011

DISASSEMBLY

1. REMOVE FRONT LOWER ARM BUSH NO. 1

- (a) Using a hammer and chisel, raise the flange of the bush diagonally as shown in the illustration.

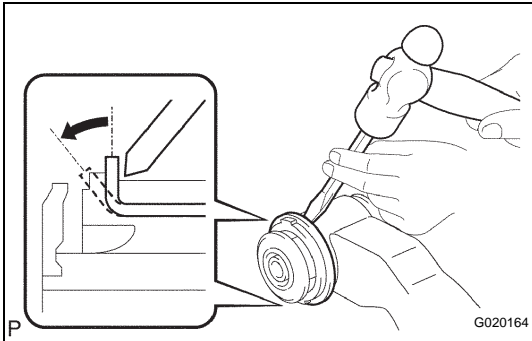

- (b) Using SST, remove the lower arm bush.

SST 09950-40011 (09951-04010, 09952-04010, 09953-04020, 09954-04010, 09955-04011, 09957-04010, 09958-04011), 09950-60010 (09951-00470)

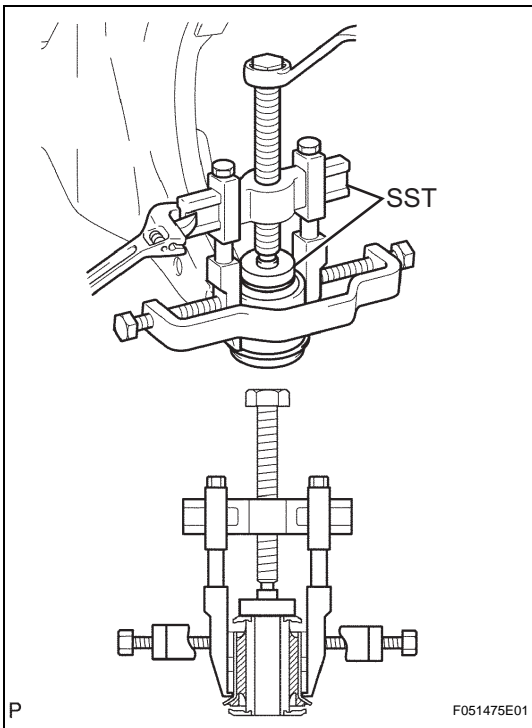

2. REMOVE FRONT LOWER ARM BUSH NO. 2

- (a) Using a hammer and chisel, raise the flange of the bush diagonally as shown in the illustration.

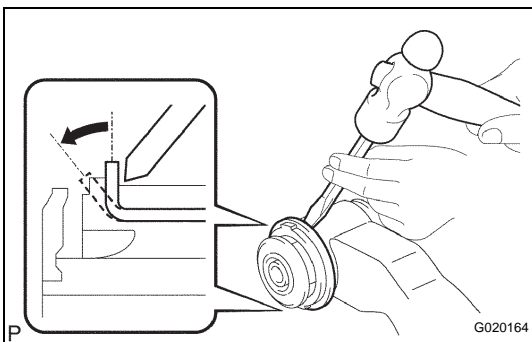

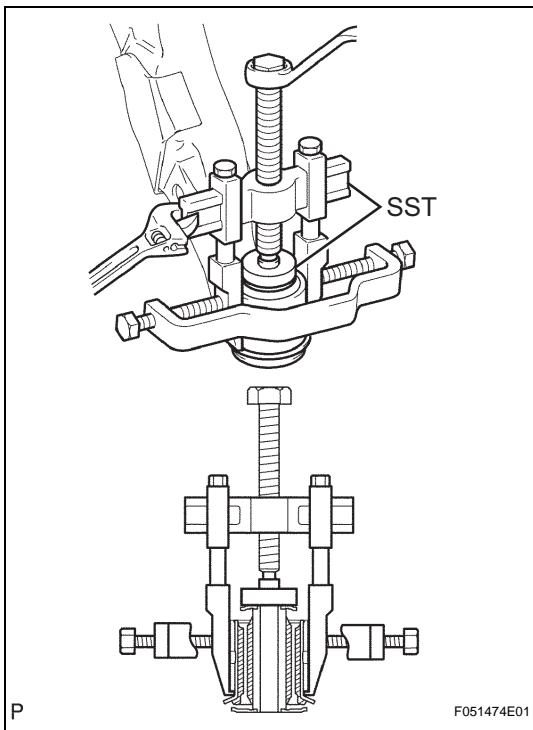

- (b) Using SST, remove the lower arm bush.

SST 09950-40011 (09951-04010, 09952-04010, 09953-04020, 09954-04010, 09955-04011, 09957-04010, 09958-04011), 09950-60010 (09951-00520)

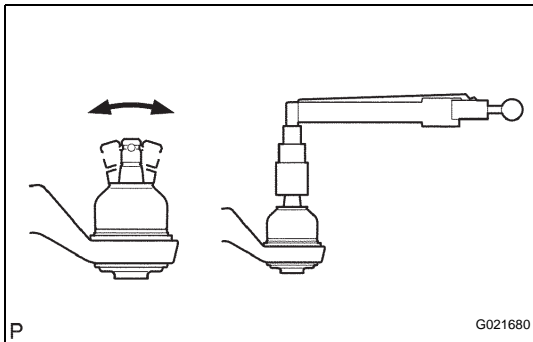

INSPECTION

1. INSPECT FRONT SUSPENSION LOWER ARM

- (a) Flip the ball joint stud back and forth 5 times, as shown in the illustration, before installing the nut.
- (b) Using a torque wrench, turn the nut continuously at a rate of 2 to 4 seconds per turn and take the torque reading on the 5th turn.

Torque: 3.0 N*m (31 kgf*cm, 27 in.*lbf) or less

- (c) Check for any cracks and grease leakage on the ball joint dust cover.

REASSEMBLY

1. INSTALL FRONT LOWER ARM BUSH NO. 1

- (a) Install a new lower arm bush using SST, a press and steel plate.

SST 09631-12090, 09631-32020

NOTICE:

Push the lower arm bush in until the bush positioning protrusions come to the positions shown in the illustration.

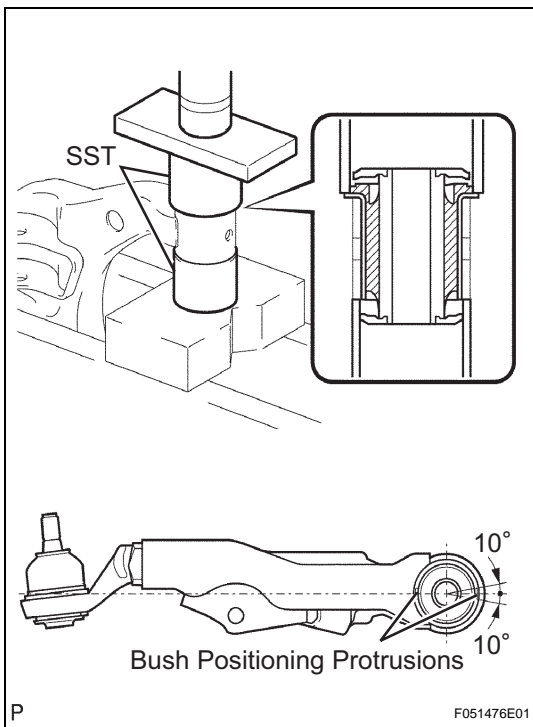

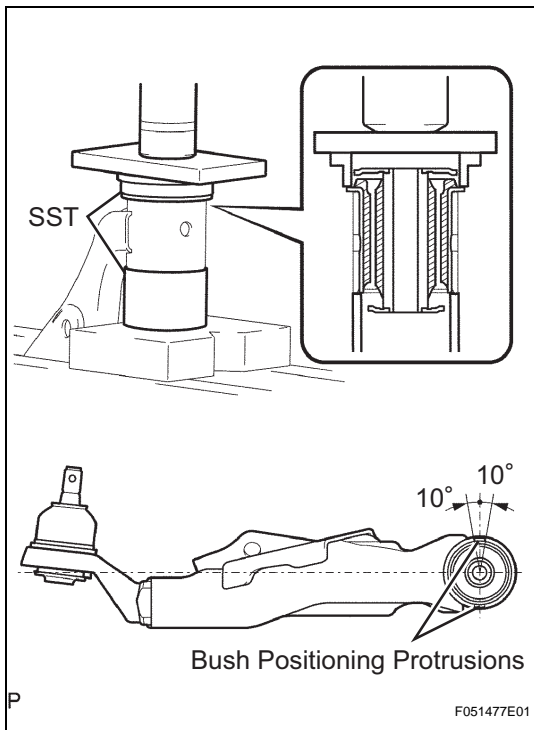

2. INSTALL FRONT LOWER ARM BUSH NO. 2

- (a) Install a new lower arm bush using SST, a press and steel plate.

SST 09502-12010, 09631-12090

NOTICE:

Push the lower arm bush in until the bush positioning protrusions come to the positions shown in the illustration.

INSTALLATION

1. TEMPORARILY TIGHTEN FRONT SUSPENSION LOWER ARM

- (a) Align the matchmarks on the camber adjust cam No. 2 and toe adjust cam. Temporarily tighten the bolt and the nut.
- (b) Install the front lower ball joint attachment, a new nut and a new cotter pin.

Torque: 140 N*m (1,428 kgf*cm, 103 ft.*lbf)

- (c) Install the front lower ball joint attachment with the 2 bolts.

Torque: 160 N*m (1,631 kgf*cm, 118 ft.*lbf)

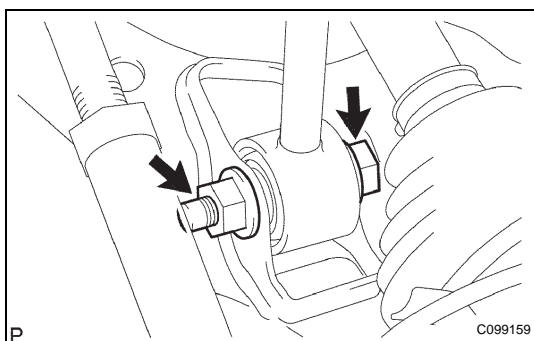
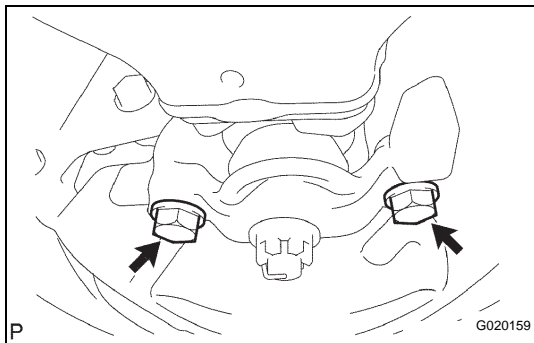
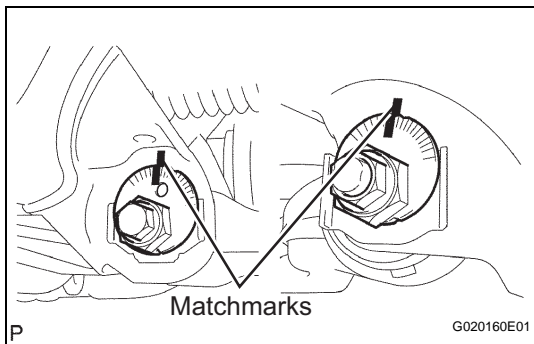

2. TEMPORARILY TIGHTEN FRONT SHOCK ABSORBER WITH COIL SPRING

- (a) Install the front shock absorber with coil spring, bolt and washer, and temporarily tighten the nut.

3. INSTALL FRONT WHEEL

Torque: 113 N*m (1,152 kgf*cm, 83 ft.*lbf)

4. STABILIZE SUSPENSION

- (a) Jack down the vehicle.
- (b) Bounce the vehicle up and down several times to stabilize the suspension.

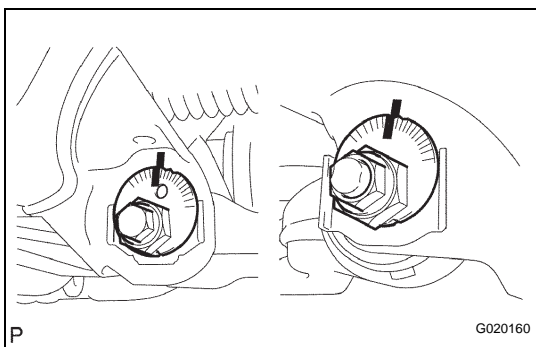
**5. FULLY TIGHTEN FRONT SUSPENSION LOWER ARM**

(a) Fully tighten the bolt and the nut.

Torque: 135 N*m (1,377 kgf*cm, 100 ft.*lbf)

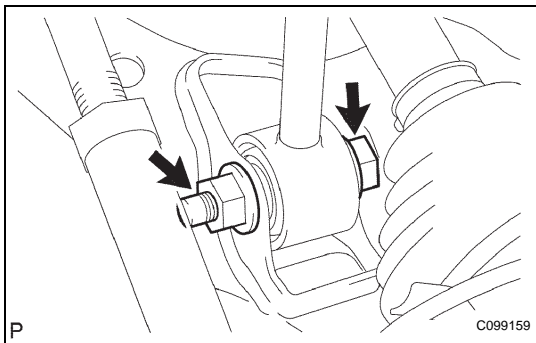
**6. FULLY TIGHTEN FRONT SHOCK ABSORBER WITH COIL SPRING**

(a) Fully tighten the nut.

Torque: 83 N*m (846 kgf*cm, 61 ft.*lbf)

7. INSPECT AND ADJUST FRONT WHEEL ALIGNMENT

(See page [SP-7](#))