

FRONT UPPER SUSPENSION ARM (for 2WD)

COMPONENTS

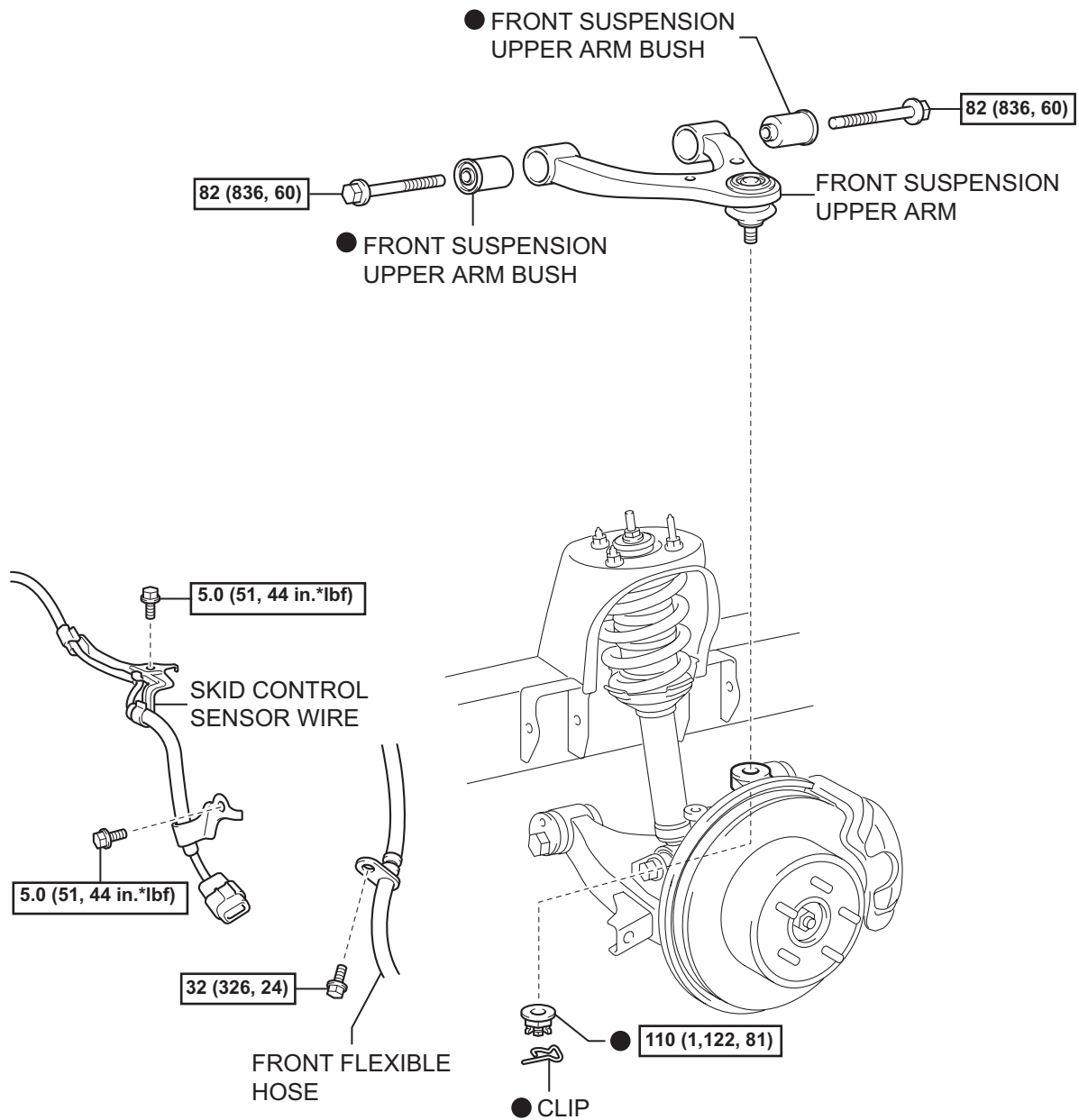

N*m (kgf*cm, ft*lbf) : Specified torque

● Non-reusable part

SP

REMOVAL

1. **DISCONNECT CABLE FROM NEGATIVE BATTERY TERMINAL**
2. **REMOVE FRONT WHEEL**
3. **INSPECT FRONT SUSPENSION UPPER ARM**
 - (a) Check that there is no slack on the ball joint by shaking the upper arm up and down by hand.
4. **SEPARATE SKID CONTROL SENSOR WIRE**
 - (a) Remove the speed sensor connector.
 - (b) Remove the 2 bolts, and separate the skid control sensor wire.

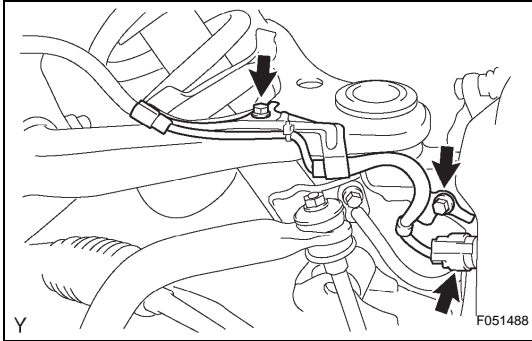

5. **SEPARATE FRONT FLEXIBLE HOSE**
 - (a) Remove the bolt, and separate the front flexible hose.

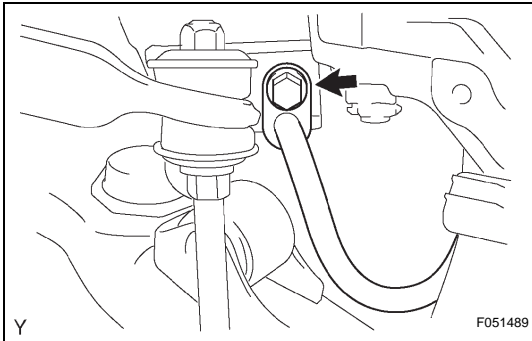

6. **REMOVE FRONT SUSPENSION UPPER ARM**
 - (a) Support the front suspension lower arm with a jack.
 - (b) Remove the clip and nut.
 - (c) Using SST, separate the upper ball joint from the steering knuckle.
SST 09628-62011

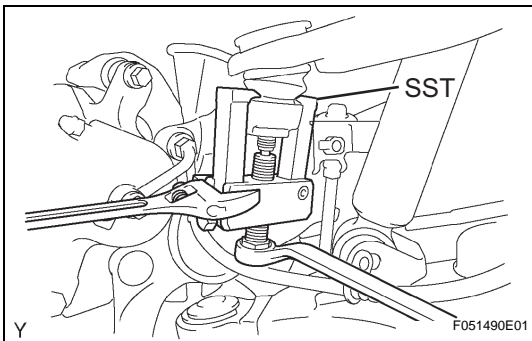

- (d) Remove the 2 bolts.
- (e) Remove the front suspension upper arm.

