

BRAKE BOOSTER (w/o VSC)

COMPONENTS

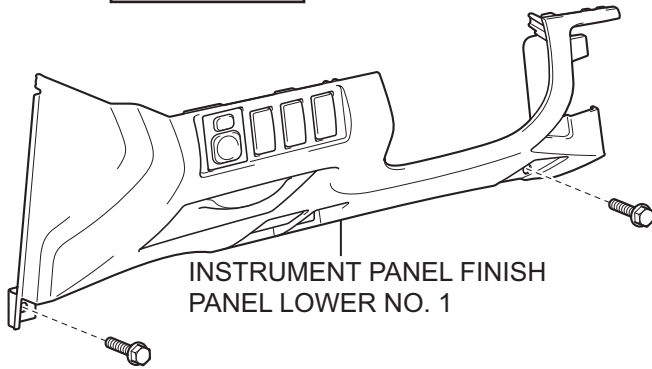

for Automatic Transmission:

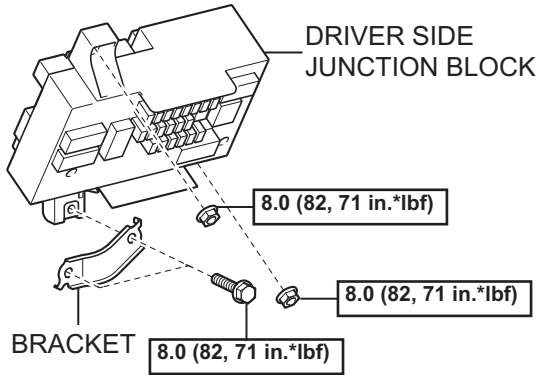

INSTRUMENT PANEL UNDER TRAY

BR

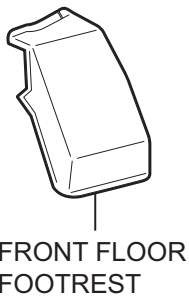
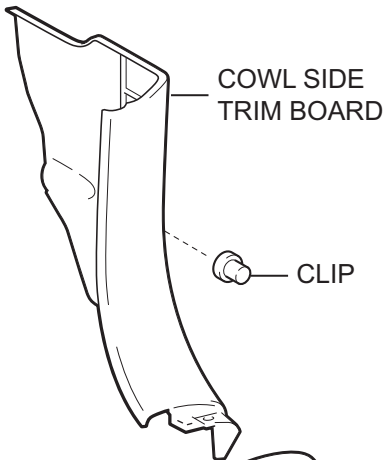

for Manual Transmission:



INSTRUMENT PANEL HOLE COVER

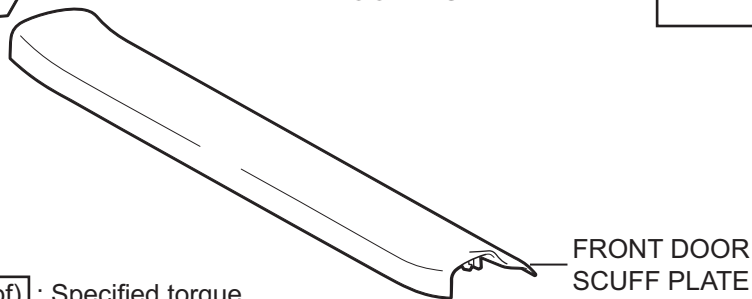

N*m (kgf*cm, ft*lbf) : Specified torque

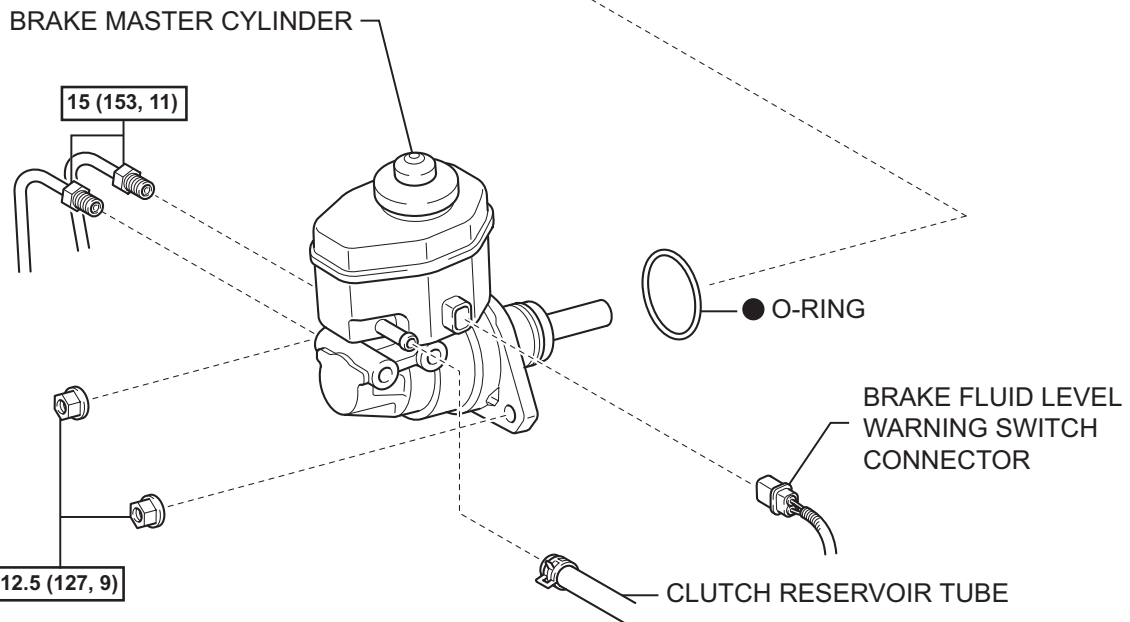
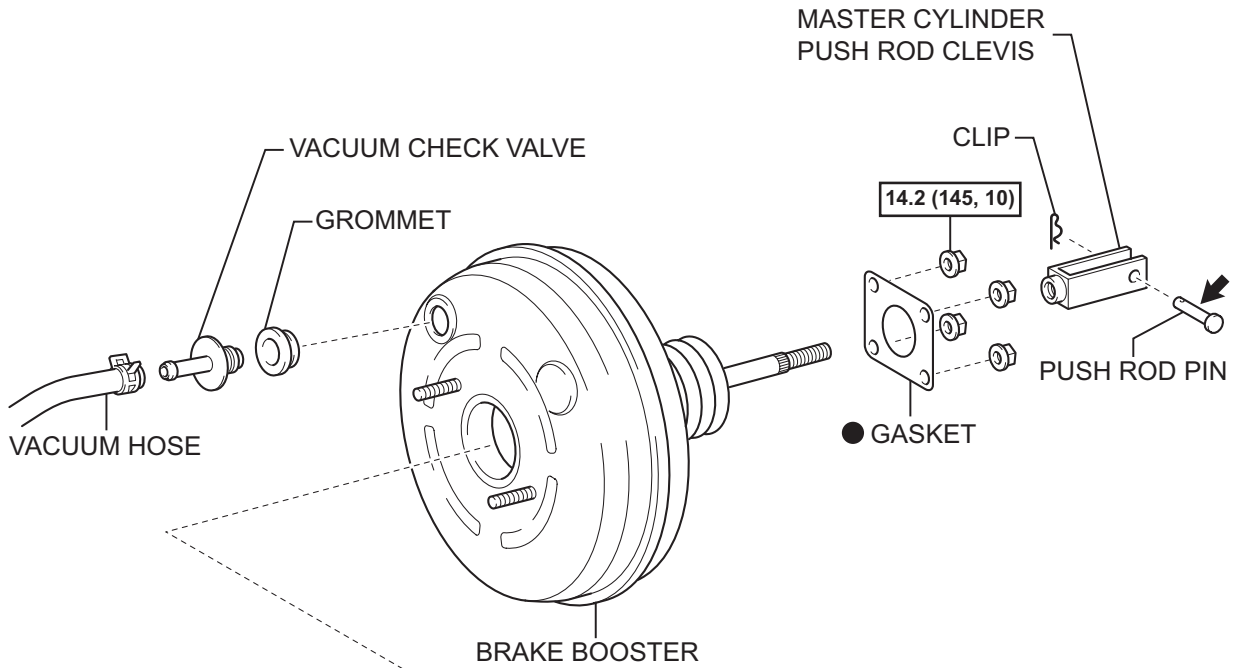

$\boxed{\text{N}\cdot\text{m (kgf}\cdot\text{cm, ft}\cdot\text{lbf)}}$: Specified torque

● Non-reusable part

← Lithium soap base glycol grease

BR

ON-VEHICLE INSPECTION

1. INSPECT BRAKE BOOSTER

(a) Check the air tightness.

- (1) Start the engine and stop it after 1 or 2 minutes. Depress the brake pedal several times slowly.

HINT:

If the pedal can be depressed to the floor the 1st time, but cannot be depressed as far on the 2nd or 3rd time, the booster is airtight.

- (2) Depress the brake pedal while the engine is running, and stop the engine with the pedal depressed.

HINT:

If there is no change in the pedal reserve distance after holding the pedal for 30 seconds, the booster is airtight.

(b) Check the operation.

- (1) Depress the brake pedal several times with the ignition switch at OFF and check that there is no change in the pedal reserve distance.

- (2) Depress the brake pedal and start the engine.

HINT:

If the pedal goes down slightly, the operation is normal.

2. INSPECT VACUUM CHECK VALVE

(a) Check the vacuum check valve.

- (1) Slide the clip and disconnect the vacuum hose.
- (2) Remove the vacuum check valve.

- (3) Check that there is ventilation from the booster to the engine, and no ventilation from the engine to the booster.

If any fault is found, replace the vacuum check valve.

