

FRONT BRAKE (for 4WD and Pre-Runner)

COMPONENTS

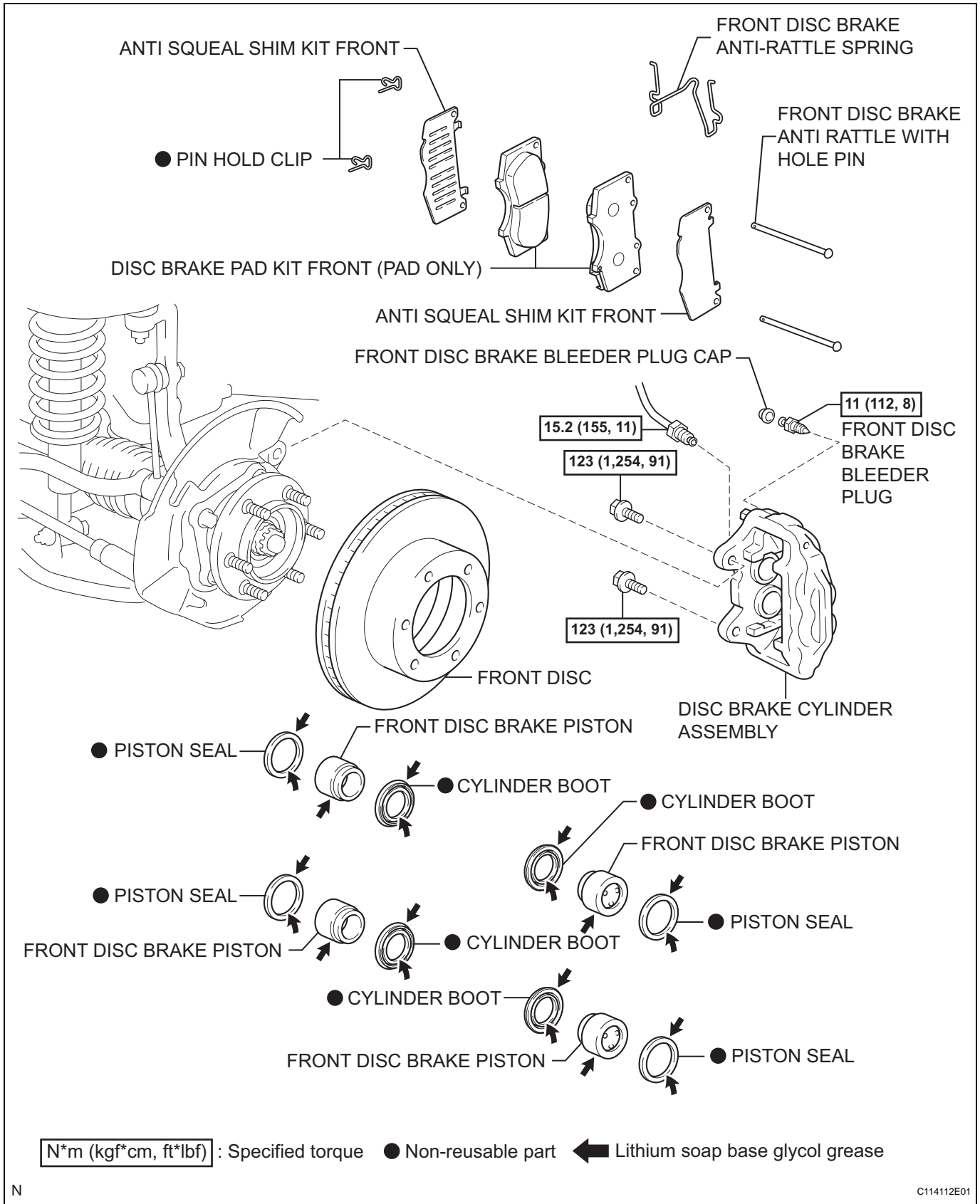

BR

REMOVAL

1. REMOVE FRONT WHEEL

2. DRAIN BRAKE FLUID

NOTICE:

Immediately wash off any brake fluid that comes into contact with any painted surfaces.

3. REMOVE FRONT DISC BRAKE ANTI RATTLE WITH HOLE PIN

- Remove the 2 pin hold clips, then remove the 2 anti-rattle w/ hole pins from the disc brake cylinder.
- Remove the anti-rattle spring from the disc brake pad.

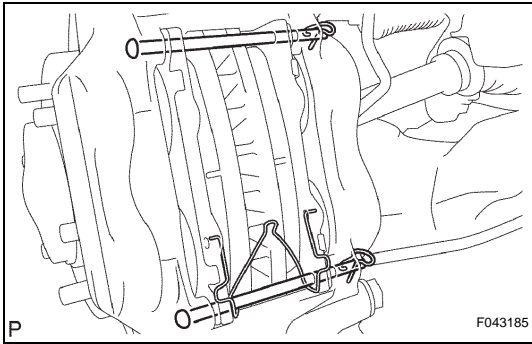

4. REMOVE DISC BRAKE PAD KIT FRONT (PAD ONLY)

- Remove the 2 disc brake pads with anti-squeal shim from the disc brake cylinder.

5. REMOVE ANTI SQUEAL SHIM KIT FRONT

- Remove the 2 anti-squeal shims from each of the disc brake pads.

6. REMOVE DISC BRAKE CYLINDER ASSEMBLY

- Using SST, disconnect the brake tube from the disc brake cylinder.

SST 09023-00101

HINT:

Use a container to collect the brake fluid as it drains out.

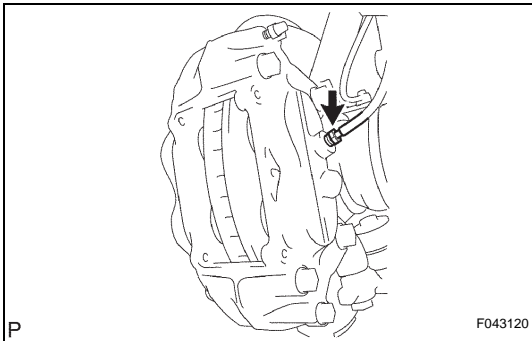

- Remove the 2 bolts and disc brake cylinder.

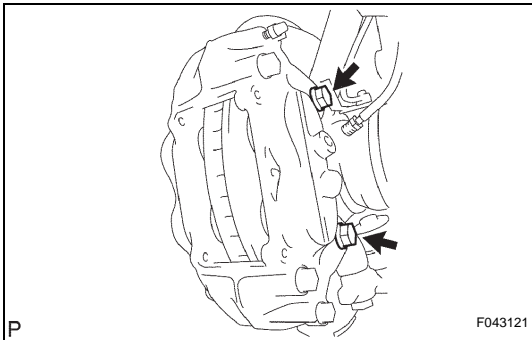

7. INSPECT DISC THICKNESS

- Using a micrometer, measure the disc thickness.

Standard thickness:

28.0 mm (1.102 in.)

Minimum thickness:

26.0 mm (1.024 in.)

8. REMOVE FRONT DISC

- Make matchmarks on the disc and the axle hub.
- Remove the front disc.

