

REMOVAL

1. DISCONNECT CABLE FROM NEGATIVE BATTERY TERMINAL
2. REMOVE FRONT DOOR SCUFF PLATE (for Regular Cab) (See page [IR-40](#))
3. REMOVE FRONT DOOR SCUFF PLATE (for Access Cab) (See page [IR-61](#))
4. REMOVE FRONT DOOR SCUFF PLATE (for Double Cab) (See page [IR-12](#))
5. REMOVE FRONT FLOOR FOOTREST (See page [IR-1](#))
6. REMOVE COWL SIDE TRIM BOARD (for Regular Cab) (See page [IR-40](#))
7. REMOVE COWL SIDE TRIM BOARD (for Access Cab) (See page [IR-61](#))
8. REMOVE COWL SIDE TRIM BOARD (for Double Cab) (See page [IR-12](#))
9. REMOVE INSTRUMENT PANEL HOLE COVER (See page [IP-9](#))
10. SEPARATE HOOD LOCK CONTROL LEVER SUB-ASSEMBLY (See page [ED-3](#))
11. REMOVE INSTRUMENT PANEL FINISH PANEL LOWER NO. 1 (See page [IP-12](#))
12. REMOVE PARKING BRAKE LEVER
 - (a) Release the parking brake lever.
 - (b) Remove the clip and pin and separate the sleeve.
 - (c) Remove the 2 bolts and parking brake lever assembly.

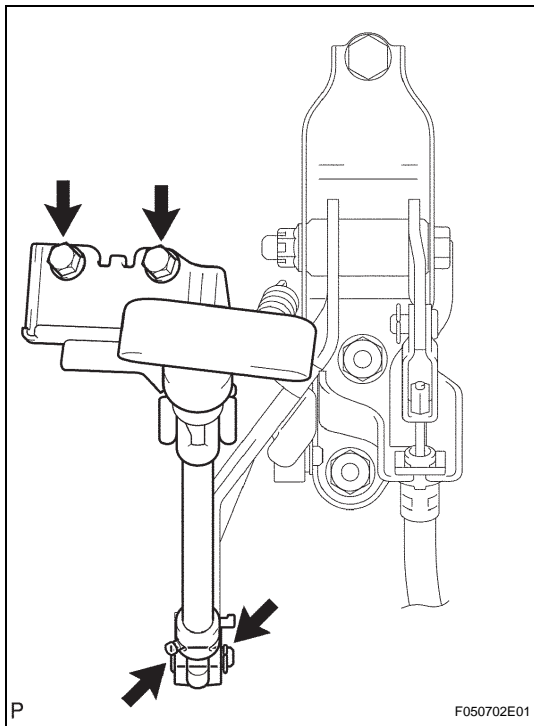

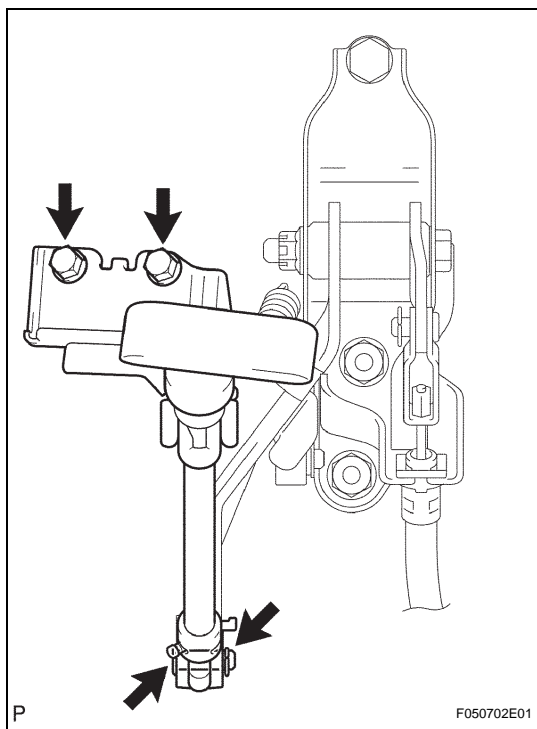

INSTALLATION

1. **INSTALL PARKING BRAKE LEVER**
 - (a) Install the parking brake lever assembly with the 2 bolts.
Torque: 6.0 N*m (61 kgf*cm, 53 in.*lbf)
 - (b) Install the sleeve with the pin and clip.
2. **INSTALL INSTRUMENT PANEL FINISH PANEL LOWER NO. 1** (See page [IP-22](#))
3. **INSTALL HOOD LOCK CONTROL LEVER SUB-ASSEMBLY** (See page [ED-8](#))
4. **INSTALL INSTRUMENT PANEL HOLE COVER** (See page [IP-25](#))
5. **INSTALL COWL SIDE TRIM BOARD** (for Regular Cab) (See page [IR-52](#))
6. **INSTALL COWL SIDE TRIM BOARD** (for Access Cab) (See page [IR-52](#))
7. **INSTALL COWL SIDE TRIM BOARD** (for Double Cab) (See page [IR-29](#))
8. **INSTALL FRONT FLOOR FOOTREST** (See page [IR-1](#))
9. **INSTALL FRONT DOOR SCUFF PLATE** (for Regular Cab) (See page [IR-52](#))
10. **INSTALL FRONT DOOR SCUFF PLATE** (for Access Cab) (See page [IR-75](#))
11. **INSTALL FRONT DOOR SCUFF PLATE** (for Double Cab) (See page [IR-29](#))
12. **CONNECT CABLE TO NEGATIVE BATTERY TERMINAL**
Torque: 3.9 N*m (40 kgf*cm, 35 in.*lbf)
 (See page [IN-5](#))