

REPAIR

1. STEERING OFF CENTER REPAIR PROCEDURE

- (a) Inspect steering wheel off center.
 - (1) Apply masking tape to the top center of the steering wheel and steering column upper cover.
 - (2) Drive the vehicle in a straight line for 100 meters at a constant speed of 35 mph (56 km/h), and hold the steering wheel to maintain the course.

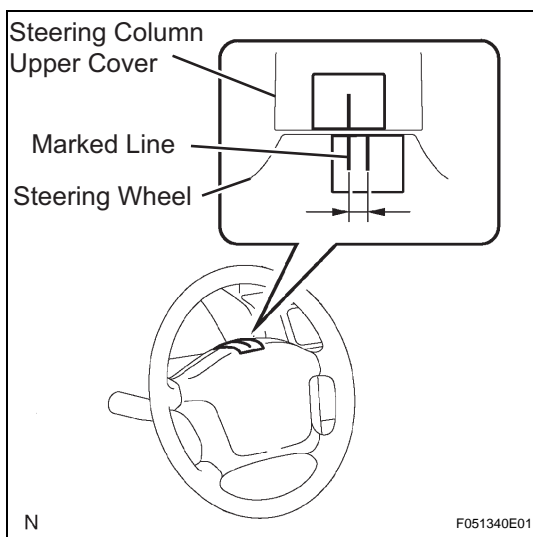
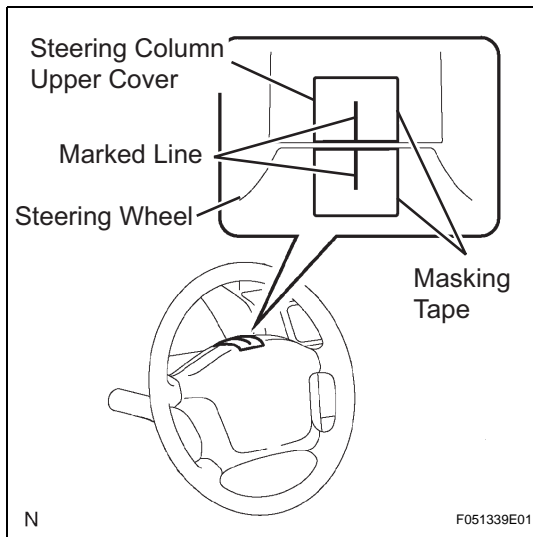
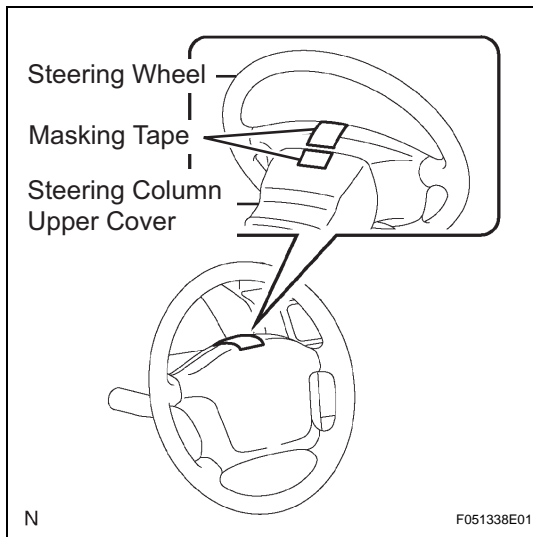

- (3) Draw a line on the masking tape as shown in the illustration.

- (4) Turn the steering wheel to its straight position. HINT:

Refer to the steering column upper cover and marked line on the steering wheel for the straight position.

- (5) Draw a new line on the masking tape or the steering wheel as shown in the illustration.
- (6) Measure the distance between the 2 lines on the masking tape of the steering wheel.
- (7) Convert the measured distance to the steering angle.

Measured distance 1 mm (0.04 in.):

Steering angle approximately 1 deg.

HINT:

Make a note of the steering angle.

SR

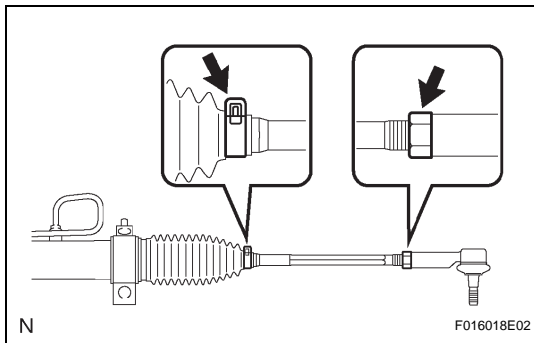
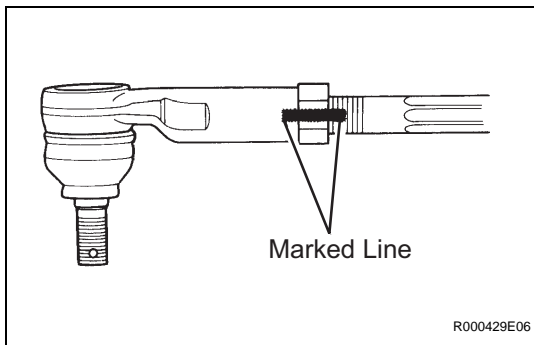

- (b) Adjust the steering angle.
- (1) Draw a line on the RH and LH tie rods and on the RH and LH rack ends which can easily be seen.
 - (2) Using a paper gauge, measure the distance from RH and LH tie rod ends to the rack end screws.

HINT:

 - Measure both the RH and LH side.
 - Make a note of the measured values.
 - (3) Remove the RH and LH boot clips from the rack boots.
 - (4) Loosen the RH and LH lock nuts.
 - (5) Turn the RH and LH rack ends by the same amount (but in different directions) according to the steering angle.

Amount of turn:
360° turn of rack end (1.5 mm (0.059 in.) horizontal movement) - 12° of steering angle.
 - (6) Tighten the RH and LH lock nuts.

Torque: 55.5 N*m (566 kgf*cm, 41 ft.*lbf)

NOTICE:
Make sure that the difference in length between the RH and LH tie rod ends and rack end screws is less than 1.5 mm (0.059 in.).
 - (7) Install the RH and LH boot clips.