

## REMOVAL

1. **PRECAUTION**  
(See page [RS-1](#))
2. **DISCONNECT CABLE FROM NEGATIVE BATTERY TERMINAL**  
Wait for at least 90 seconds after disconnecting the cable to prevent the airbag from working.
3. **PLACE FRONT WHEELS FACING STRAIGHT AHEAD**
4. **REMOVE NO.2 LOWER STEERING WHEEL COVER**
  - (a) Using a screwdriver with its tip wrapped in protective tape, disengage the claw and remove the steering wheel cover lower No. 2.

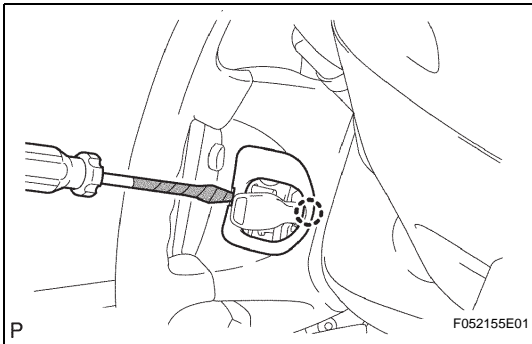

5. **REMOVE NO.3 LOWER STEERING WHEEL COVER**
  - (a) Using a screwdriver with its tip wrapped in protective tape, disengage the claw and remove the No. 3 lower steering wheel cover.
6. **REMOVE STEERING PAD (See page [RS-558](#))**

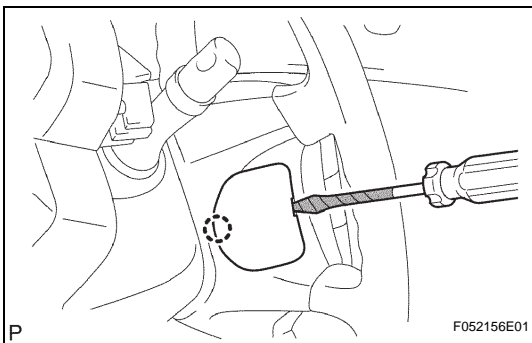

7. **REMOVE STEERING WHEEL ASSEMBLY**
  - (a) Remove the steering wheel assembly set nut.
  - (b) Place matchmarks on the steering wheel assembly and main shaft assembly.
  - (c) Using SST, remove the steering wheel assembly.  
**SST 09950-50013 (09951-05010, 09952-05010, 09953-05020, 09954-05021)**

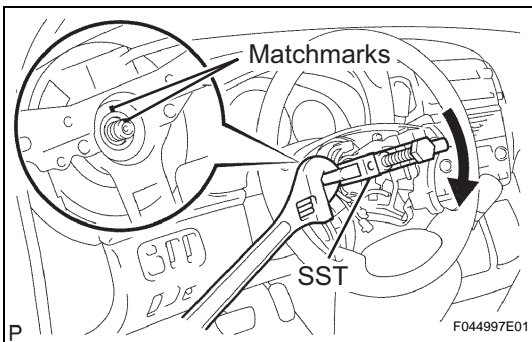

8. **REMOVE LOWER STEERING COLUMN COVER**
  - (a) Remove the 2 screws.
  - (b) Disengage the 2 claws to remove the lower steering column cover.

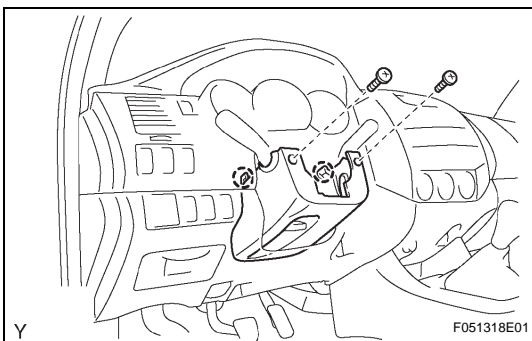

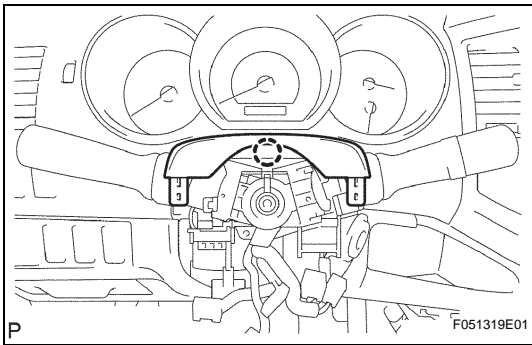

9. **REMOVE UPPER STEERING COLUMN COVER**
  - (a) Disengage the claw and then remove the upper steering column cover.
10. **REMOVE SPIRAL CABLE SUB-ASSEMBLY** (See page [RS-566](#))
11. **REMOVE WINDSHIELD WIPER SWITCH ASSEMBLY** (See page [WW-17](#))
12. **REMOVE FRONT FLOOR FOOTREST** (See page [IR-1](#))
13. **REMOVE FRONT DOOR SCUFF PLATE LH** (for Regular Cab) (See page [IR-40](#))
14. **REMOVE FRONT DOOR SCUFF PLATE LH** (for Access Cab) (See page [IR-61](#))
15. **REMOVE FRONT DOOR SCUFF PLATE LH** (for Double Cab) (See page [IR-12](#))
16. **REMOVE COWL SIDE TRIM BOARD LH** (for Regular Cab) (See page [IR-40](#))
17. **REMOVE COWL SIDE TRIM BOARD LH** (for Access Cab) (See page [IR-61](#))
18. **REMOVE COWL SIDE TRIM BOARD LH** (for Double Cab) (See page [IR-12](#))
19. **REMOVE INSTRUMENT PANEL UNDER TRAY** (for Pedal Type Parking Brake) (See page [IP-9](#))
20. **REMOVE INSTRUMENT PANEL HOLE COVER** (for Lever Type Parking Brake) (See page [IP-9](#))
21. **REMOVE INSTRUMENT PANEL LOWER LH** (See page [IP-14](#))
22. **REMOVE INSTRUMENT PANEL COVER SUB-ASSEMBLY LOWER** (See page [IP-14](#))
23. **REMOVE STEERING COLUMN HOLE COVER**
  - (a) Disengage the 4 clips and remove the steering column hole cover.
24. **REMOVE NO. 1 ENGINE UNDER COVER SUB-ASSEMBLY**
  - (a) Remove the No. 1 engine under cover sub-assembly with the 4 bolts.

SR

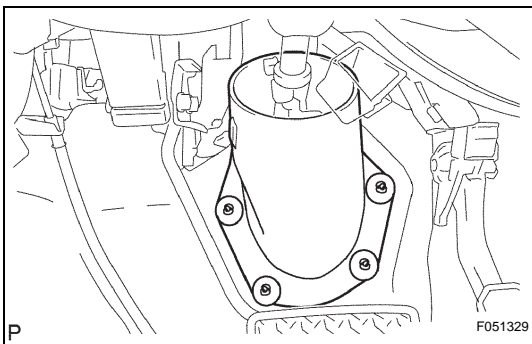

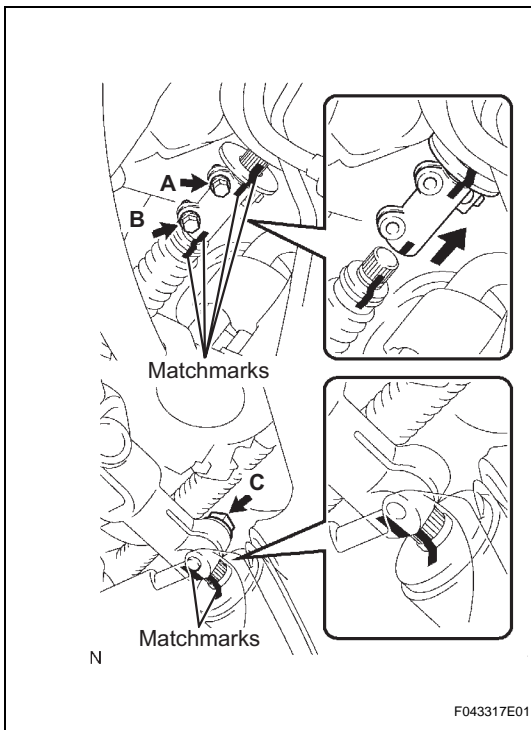
**25. REMOVE NO. 2 STEERING INTERMEDIATE SHAFT**

- (a) Mark matchmarks on the power steering gear assembly and No. 2 steering intermediate shaft.
- (b) Remove bolt C and No. 2 steering intermediate shaft from the power steering gear assembly.

**26. REMOVE STEERING SLIDING YOKE**

- (a) Mark matchmarks on the steering sliding yoke, steering intermediate shaft sub-assembly No. 2 and steering intermediate shaft assembly.
- (b) Remove bolts A and B from the steering sliding yoke.
- (c) Slide the steering sliding yoke up and separate it from the steering intermediate shaft sub-assembly No. 2.
- (d) Pull down the steering sliding yoke from the steering intermediate shaft assembly to remove.

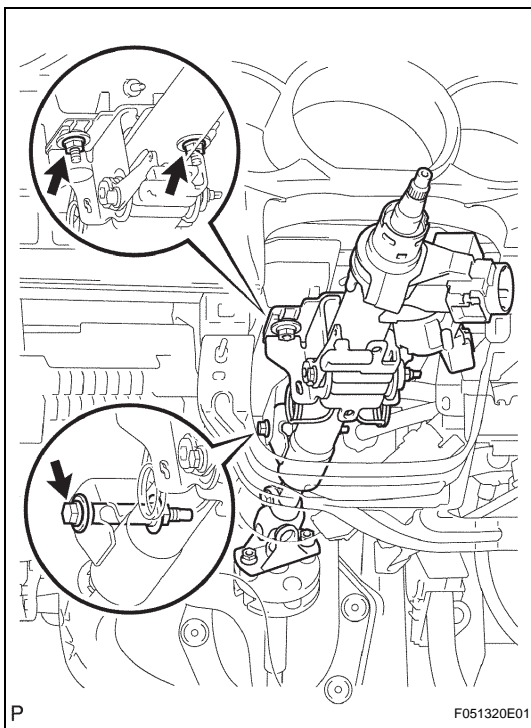
**27. REMOVE STEERING COLUMN ASSEMBLY**

- (a) Disconnect the connectors and wire harness clamps.
- (b) Remove the bolt and 2 nuts, then remove the steering column assembly from the instrument panel reinforcement assembly.

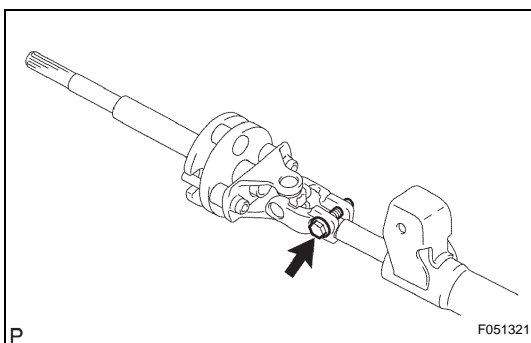
**DISASSEMBLY****1. REMOVE STEERING INTERMEDIATE SHAFT ASSEMBLY**

- (a) Place matchmarks on the steering intermediate shaft sub-assembly and steering shaft.
- (b) Remove the bolt and steering intermediate shaft sub-assembly.

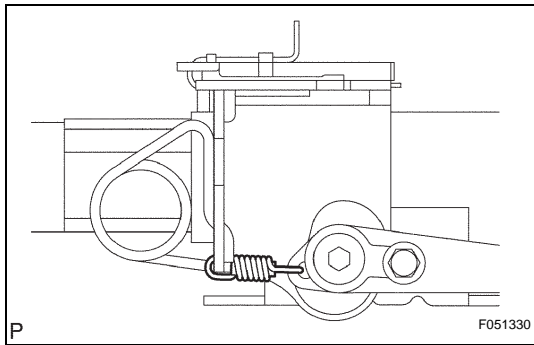

## 2. REMOVE TILT LEVER RETURN SPRING

- (a) Remove the tilt lever return spring from the steering upper support bracket and steering tilt lever.

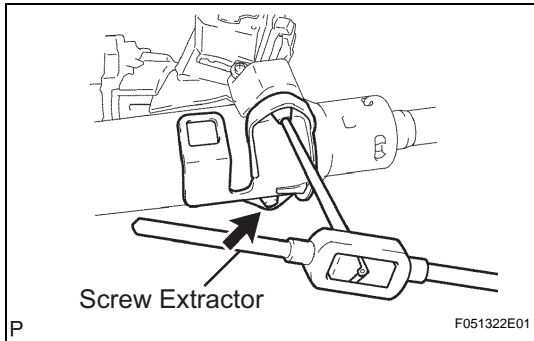

## 3. REMOVE UPPER STEERING COLUMN CLAMP

- (a) Using a centering punch, make the center of the 2 taped- hand bolts.
- (b) Using a drill, make a hole in the 2 steering lock set bolts and set a screw extractor.
- (c) Using the screw extractor, remove the steering column bracket assembly upper and upper steering column clamp from the steering column tube upper.

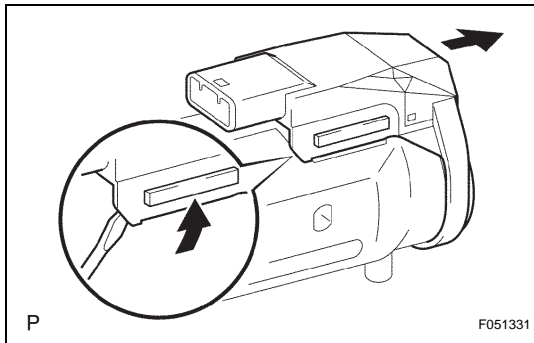

## 4. REMOVE TRANSPONDER KEY AMPLIFIER

- (a) Widen the claw hung on the upper bracket by approximately 1.0 mm (0.039 in.) using a screwdriver.
- (b) Pull the transponder key amplifier toward the rear of the vehicle with the claw open.

### NOTICE:

**Take care not to apply excessive force to prevent the case from being damaged.**

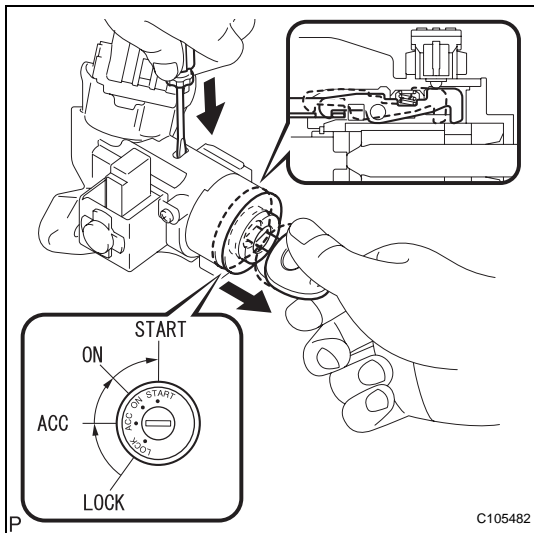

## 5. REMOVE IGNITION SWITCH LOCK CYLINDER & KEY SET

- (a) Place the ignition switch lock cylinder assembly in the accessory position.
- (b) Insert screwdriver in the steering column bracket assembly upper as shown in the illustration. Then slide ignition switch lock cylinder assembly until the claw of the ignition switch lock cylinder assembly comes into contact with the steering column bracket assembly upper stopper.

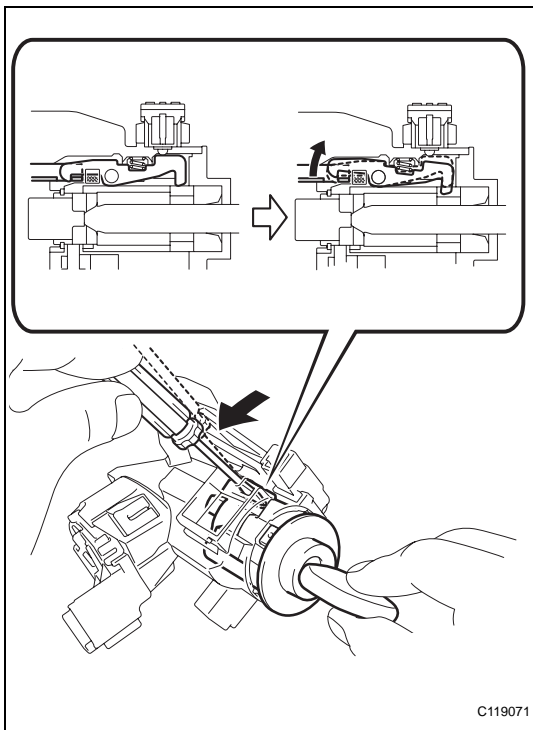

- (c) Insert a screwdriver into the steering column bracket assembly upper as shown in the illustration. Then tilt the screwdriver as shown in the illustration to disengage the claw of the ignition lock cylinder assembly and remove the cylinder.

HINT:

When the ignition lock cylinder assembly disengages, a click sound is heard.

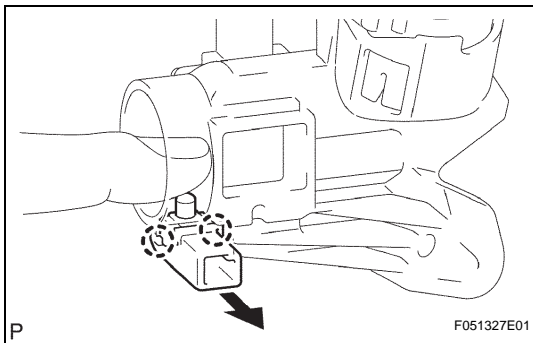

**6. REMOVE UN-LOCK WARNING SWITCH ASSEMBLY**

- (a) Disconnect the un-lock warning switch assembly connector from the ignition or start switch assembly.  
 (b) Remove the un-lock warning switch assembly toward the rear of the vehicle by pushing up the center part.

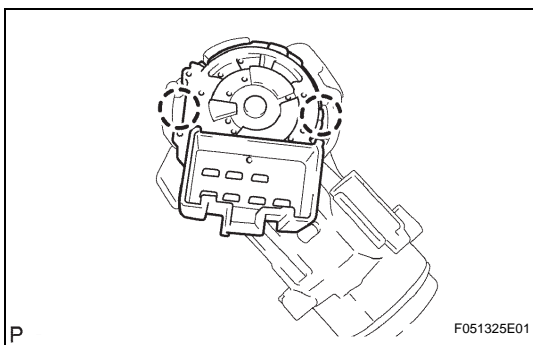

**7. REMOVE IGNITION OR STARTER SWITCH ASSEMBLY**

- (a) Disengage the 2 claws and ignition or starter switch assembly from the steering column bracket assembly upper.

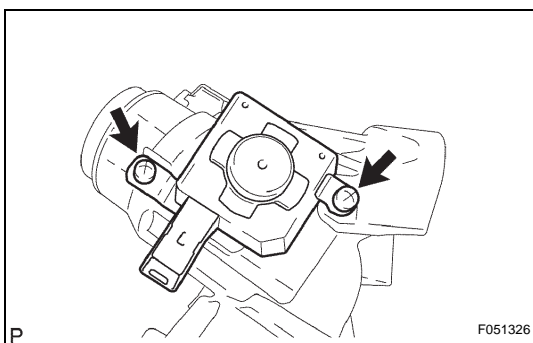

**8. REMOVE KEY INTER LOCK SOLENOID (for Automatic Transmission)**

- (a) Remove the 2 screws and key inter lock solenoid from the steering column bracket assembly upper.

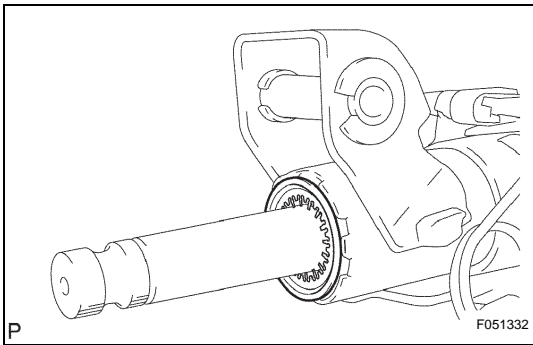

### 9. REMOVE STEERING MAIN SHAFT ASSEMBLY

- (a) Using a screwdriver, remove the steering column No. 1 ring from the steering main shaft.

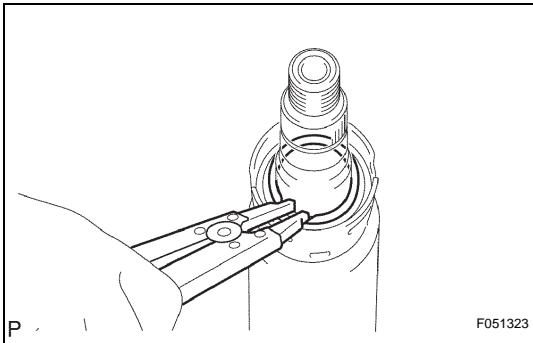

- (b) Using a snap ring expander, remove the snap ring and No. 1 main shaft.
- (c) Remove the compression spring, bearing thrust collar and bearing from the No. 1 main shaft.

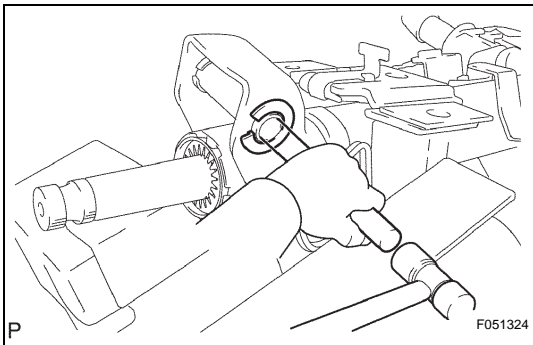

### 10. REMOVE NO.1 TILT STEERING SUPPORT COLLAR

- (a) Using a brass bar, hammer and vise, gently strike the central part of the steering column bracket spacer and remove it.
- (b) Remove the No. 1 tilt steering support collar from the steering column tube lower.