

DISASSEMBLY

1. **REMOVE STEERING GEAR OUTLET RETURN TUBE**
 - (a) Using SST, remove the return tube.
SST 09023-12701

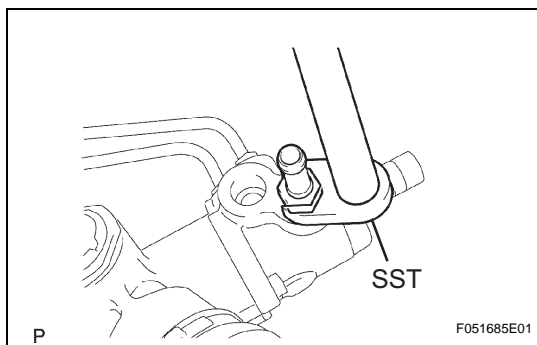

2. **REMOVE STEERING TURN PRESSURE TUBE**
 - (a) Using SST, remove the 2 pressure tubes.
SST 09023-38401
 - (b) Remove the 4 O-rings from the pressure tubes.

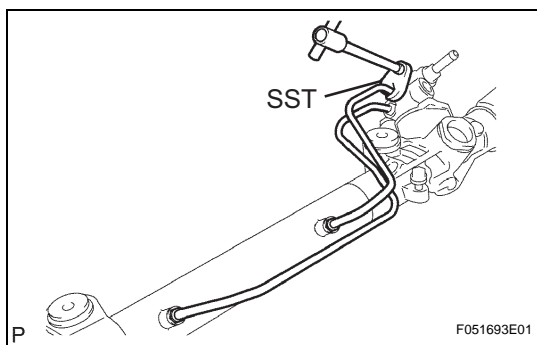
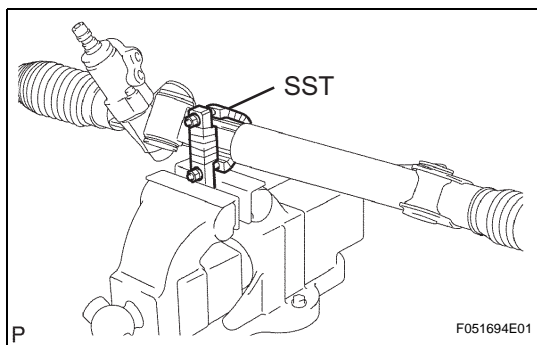

3. **FIX POWER STEERING LINK**
 - (a) Using SST, fix the power steering link between aluminium plates in a vise, as shown in the illustration.
SST 09612-00012
NOTICE:
When using a vise, do not over tighten it.

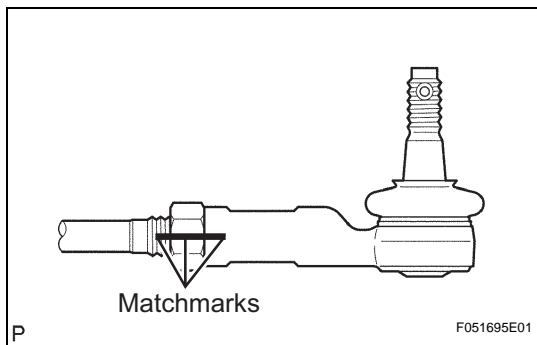

4. **REMOVE TIE ROD END SUB-ASSEMBLY LH**
 - (a) Place matchmarks on the tie rod end, lock nut and rack end.
 - (b) Loosen the lock nut and remove the tie rod end and lock nut.

5. **REMOVE TIE ROD END SUB-ASSEMBLY RH**
HINT:
The removal procedure for the RH side is the same as that for the LH side.

6. **REMOVE STEERING RACK BOOT CLIP**
 - (a) Remove the 2 rack boot clips.

7. **REMOVE STEERING RACK BOOT NO. 1 CLAMP**
 - (a) Using pliers, remove the rack boot No. 1 clamp.
NOTICE:
Be careful not to damage the steering rack boot No. 1.

8. **REMOVE STEERING RACK BOOT NO. 2 CLAMP**
HINT:
The removal procedure for the No. 2 side is the same as that for the No. 1 side.

9. REMOVE STEERING RACK BOOT NO. 1**10. REMOVE STEERING RACK BOOT NO. 2****11. REMOVE STEERING RACK END SUB-ASSEMBLY**

- (a) Using a screwdriver and hammer, unstake the claw washer.

NOTICE:

Avoid any impact to the power steering rack.

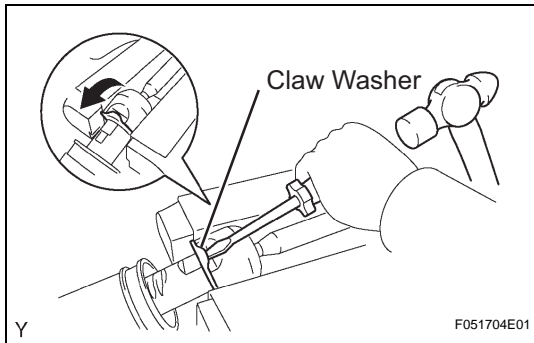

- (b) Using 2 SSTs, remove the 2 steering rack ends and 2 claw washers.

SST 09922-10010**NOTICE:**

- Turn SST 09922-10010 in the direction shown in the illustration.
- Securely hold the steering rack end with SST.

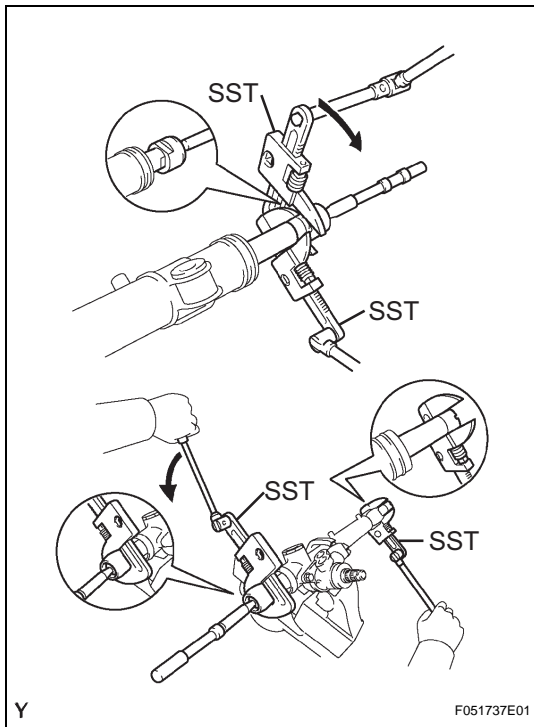
**12. REMOVE STEERING GEAR RACK GUIDE**

- (a) Using SST, remove the rack guide spring cap nut.

SST 09922-10010**NOTICE:**

Turn SST 09922-10010 in the direction shown in the illustration.

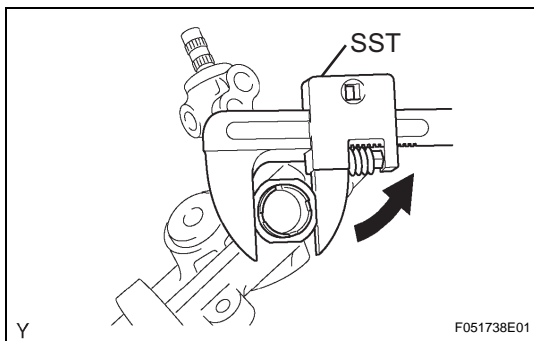

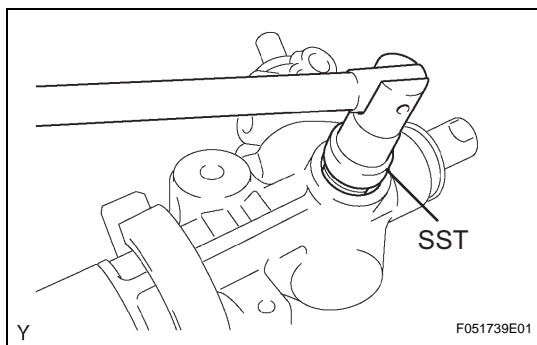

- (b) Using SST, remove the rack guide spring cap.
SST 09631-10021
- (c) Remove the rack guide spring and rack guide.

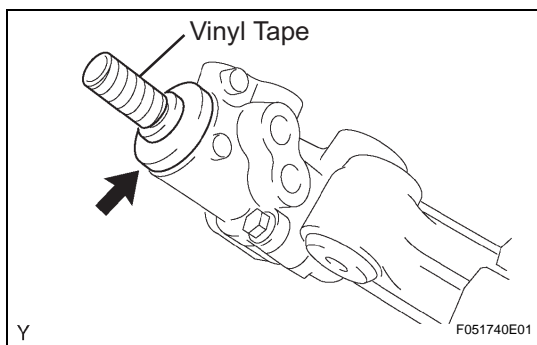

13. REMOVE POWER STEERING CONTROL VALVE ASSEMBLY

- (a) Wind vinyl tape around the serrated portion of the control valve.
- (b) Remove the dust cover from the control valve housing.

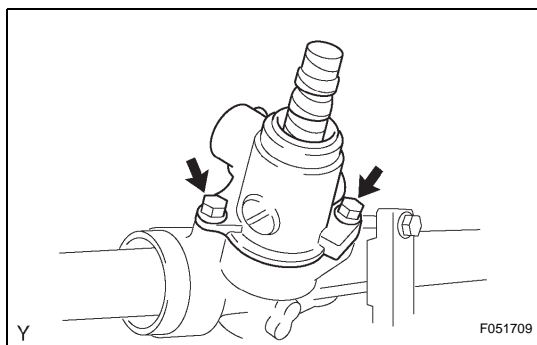

- (c) Remove the 2 bolts and control valve w/ control valve housing.
- (d) Remove the O-ring from the control valve housing.

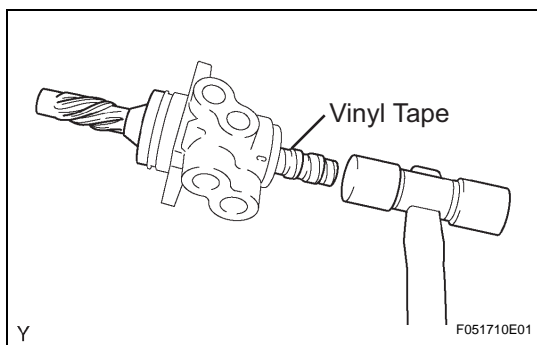

- (e) To prevent the oil seal lip from getting damaged, wind vinyl tape around the serrated portion of the control valve.
- (f) Using a plastic hammer, remove the control valve from the control valve housing.

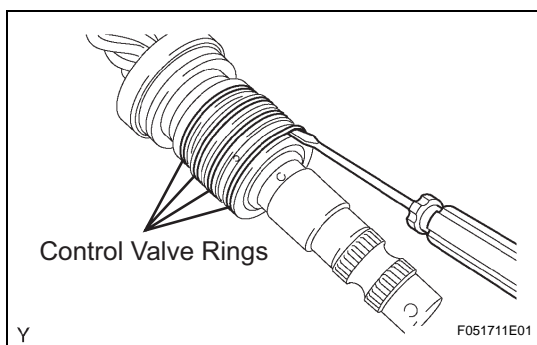

- (g) Using a screwdriver, remove the 4 control valve rings.
NOTICE:
Be careful not to damage the grooves for the control valve rings.

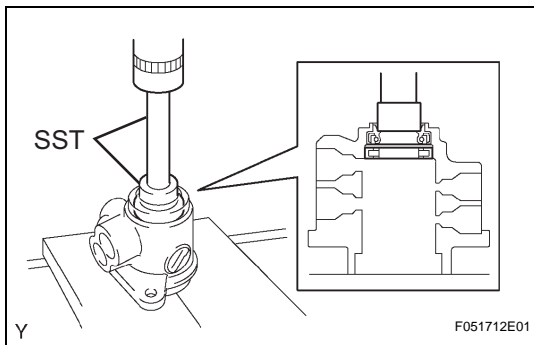

14. REMOVE POWER STEERING CONTROL VALVE UPPER OIL SEAL

- (a) Using SST and a press, remove the control valve upper bearing and control valve upper oil seal from the control valve housing.

SST 09950-60010 (09951-00250), 09950-70010 (09951-07150)

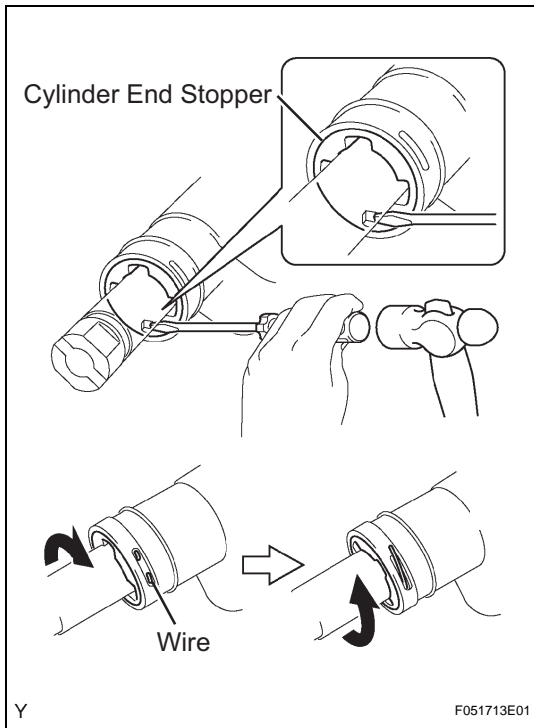

15. REMOVE CYLINDER END STOPPER

- (a) Using a screwdriver and hammer, turn the cylinder end stopper clockwise until the wire end can be seen through the service hole.
- (b) Using a screwdriver and hammer, turn the cylinder end stopper counterclockwise, and remove the wire and cylinder end stopper.

16. REMOVE POWER STEERING RACK

17. REMOVE POWER STEERING RACK BUSH

- (a) Remove the rack bush from the power steering rack.
- (b) Using a screwdriver, remove the O-ring from the rack bush.

- (c) Using SST, remove the rack bush oil seal.

SST 09527-21011, 09612-24014 (09613-22011)

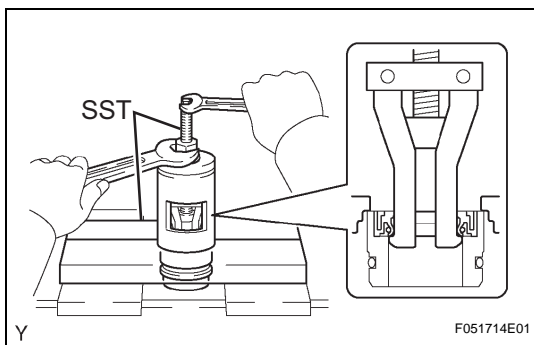

18. REMOVE POWER STEERING CYLINDER TUBE OIL SEAL

- (a) Using SST and a press, remove the cylinder tube oil seal.

SST 09950-60010 (09951-00290), 09950-70010 (09951-07360)

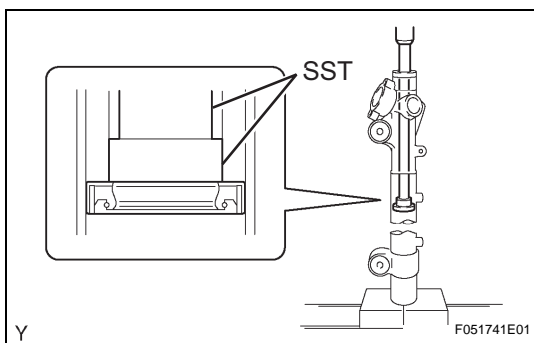

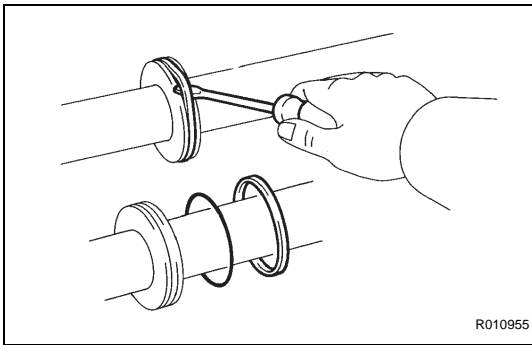
**19. REMOVE RACK STEERING PISTON RING**

- (a) Using a screwdriver, remove the piston ring and O-ring.

NOTICE:

Be careful not to damage the groove for the piston ring.

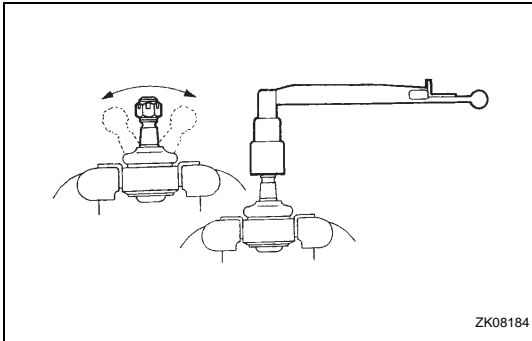
**INSPECTION****1. INSPECT TIE ROD END SUB-ASSEMBLY**

- (a) Flip the ball joint stud back and forth 5 times as shown in the illustration before installing the nut.
- (b) Using a torque wrench, turn the nut continuously at a rate of 2 to 4 seconds per turn and check the torque reading on the 5th turn.

Torque: 0.83 to 3.43 N*m (8.5 to 35.0 kgf*cm, 7.35 to 30.36 in.*lbf)

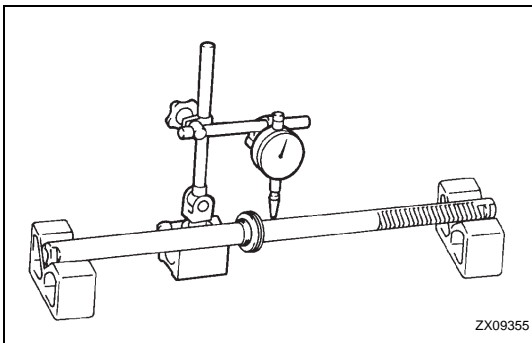
**2. INSPECT POWER STEERING RACK**

- (a) Using a dial indicator, check the power steering rack for runout, teeth wear and damage.

Maximum runout:

0.3 mm (0.012 in.)

If necessary, replace the power steering link assembly.

- (b) Check the back surface for wear and damage. If necessary, replace the power steering link assembly.