

REASSEMBLY

1. INSTALL NO. 1 COOLER UNIT DRAIN HOSE

2. INSTALL COOLER THERMISTOR SENSOR

- (a) Engage the 2 clamps and install the cooler thermistor sensor.

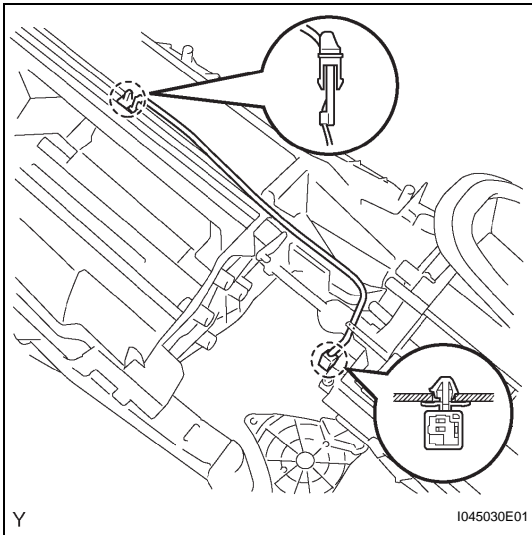

3. INSTALL EXPANSION VALVE

- (a) Apply sufficient compressor oil to 2 new seal washers and the fitting surface of the expansion valve.

Compressor oil:

RL-897 or equivalent

- (b) Install the 2 seal washers onto the expansion valve.
 (c) Using "Torx" socket wrench T25, install the expansion valve with the 2 bolts.

Torque: 7.0 N*m (71 kgf*cm, 62 in.*lbf)

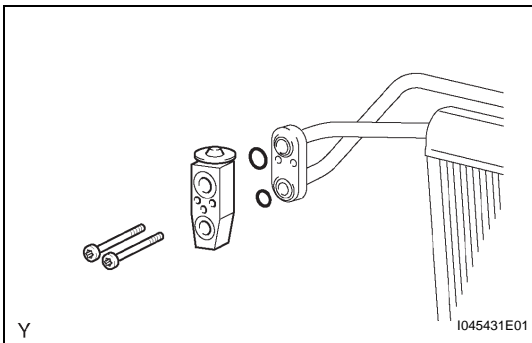

4. INSTALL VALVE TO CONNECTOR TUBE

- (a) Apply sufficient compressor oil to 2 new seal washers and fitting surface of the valve to connector tube.

Compressor oil:

RL-897 or equivalent

- (b) Install the 2 seal washers onto the valve to connector tube.
 (c) Using "Torx" socket wrench E10, install the air conditioning tube assembly with the bolt.

Torque: 25 N*m (255 kgf*cm, 18 ft.*lbf)

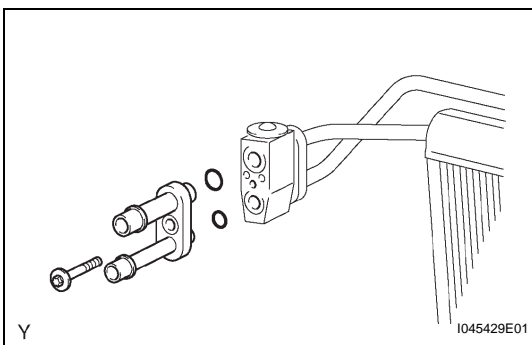

5. INSTALL EVAPORATOR CORE

- (a) Attach the evaporator side seal to both sides of the evaporator.

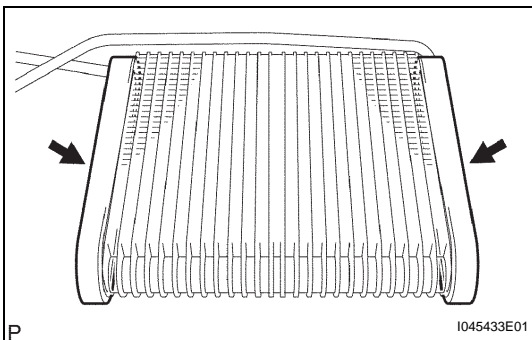

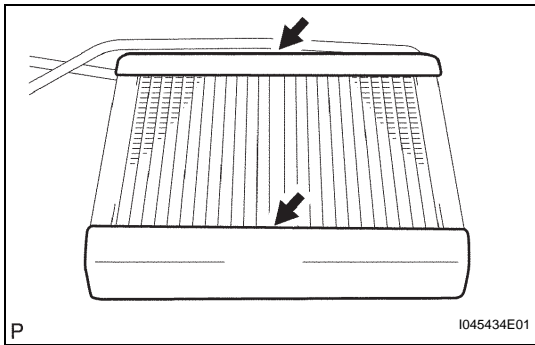

- (b) Attach the evaporator top seal to the upper side and the evaporator bottom seal to the lower side of the evaporator.

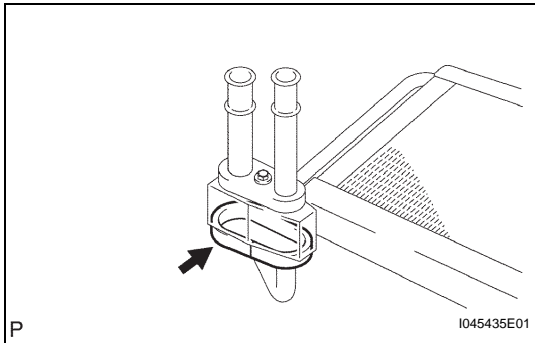

- (c) Align and apply the expansion valve seal to the periphery of the expansion valve protrusions on the back side of the expansion valve.

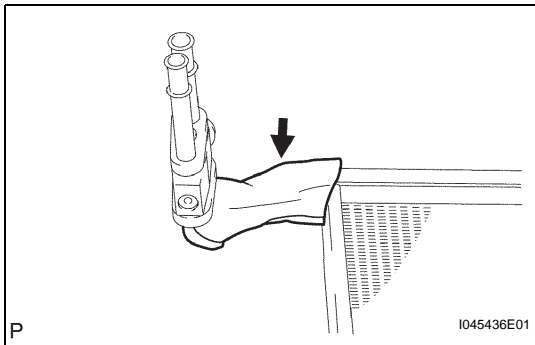

- (d) Align and attach the 2 different seals to the evaporator inlet and outlet pipes.

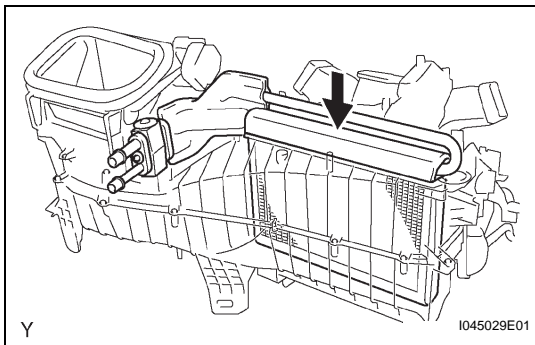

- (e) Install the evaporator core.

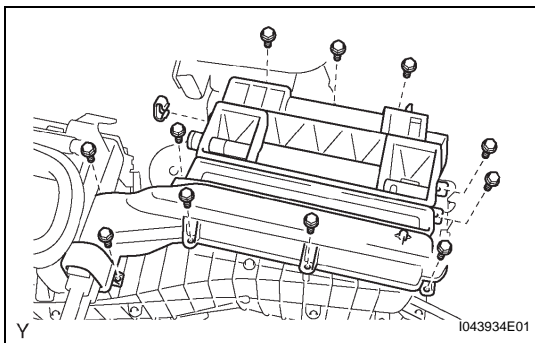

- (f) Install the mode case with the clip and 11 bolts.
Torque: 2.0 N*m (20 kgf*cm, 18 in.*lbf)

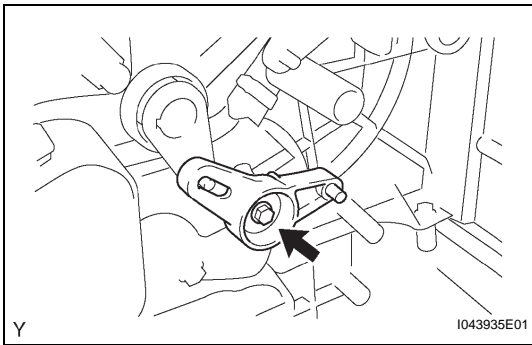

- (g) Install the heater pivot with the bolt.
Torque: 2.0 N*m (20 kgf*cm, 18 in.*lbf)

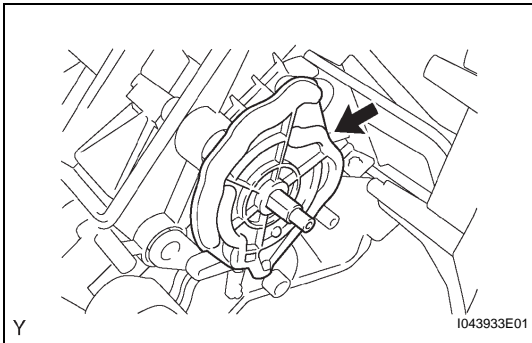

- (h) Install the mode cam.

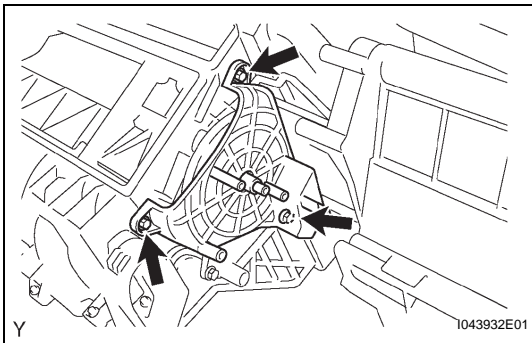

- (i) Install the mode mounting plate with the 3 bolts.
Torque: 2.0 N*m (20 kgf*cm, 18 in.*lbf)

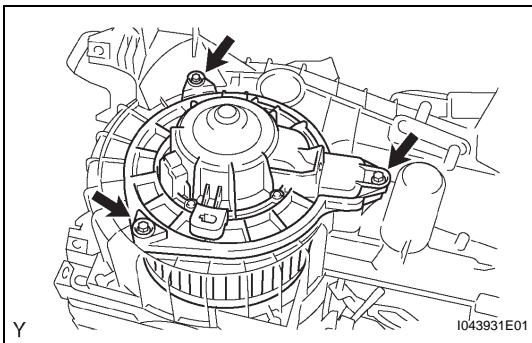

6. INSTALL BLOWER MOTOR

- (a) Install the blower motor with the 3 bolts.
Torque: 2.0 N*m (20 kgf*cm, 18 in.*lbf)

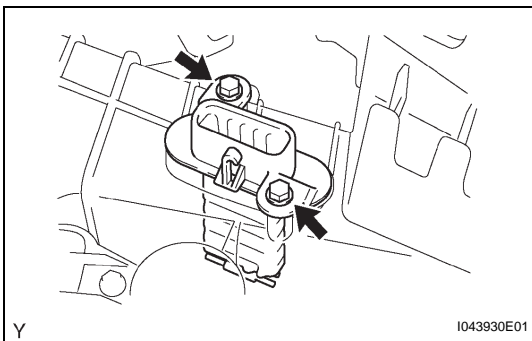

7. INSTALL BLOWER RESISTOR

- (a) Install the blower resistor with the 2 bolts.
Torque: 2.0 N*m (20 kgf*cm, 18 in.*lbf)

8. INSTALL HEATER RADIATOR ASSEMBLY

(a) Apply the heater core short seal to both sides of the heater core.

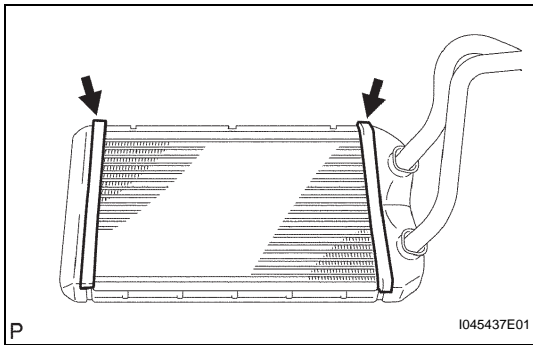

(b) Apply the heater core long seal to the upper and lower sides of the heater core.

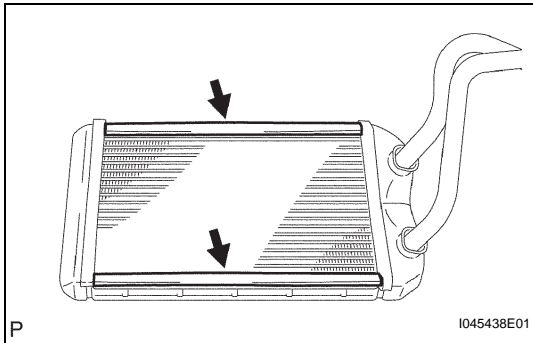

(c) Apply the heater core header seal to the right side of the heater core.

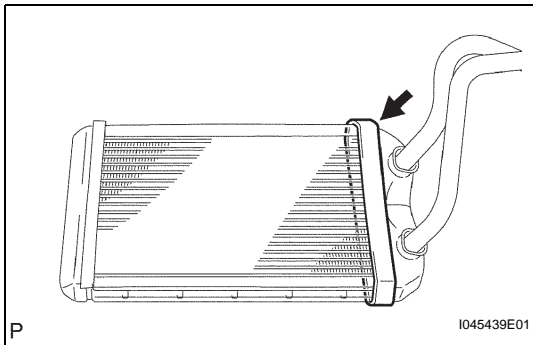

(d) Using "Torx" socket wrench T30, install the heater radiator assembly with the bolt and clamp.
Torque: 4.0 N*m (41 kgf*cm, 35 in.*lbf)

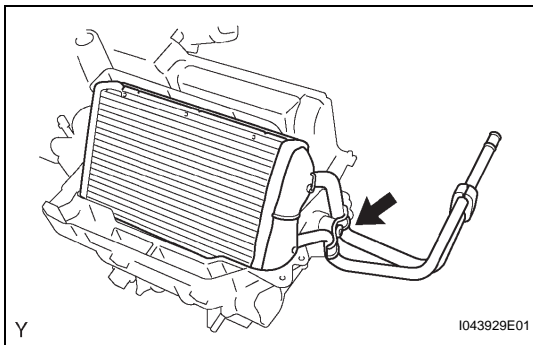

(e) Install the heater cover case with the 8 bolts.
Torque: 2.0 N*m (20 kgf*cm, 18 in.*lbf)

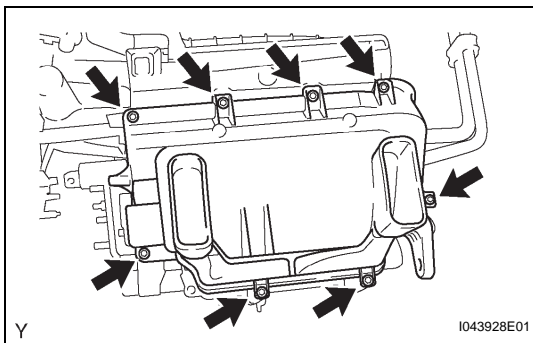

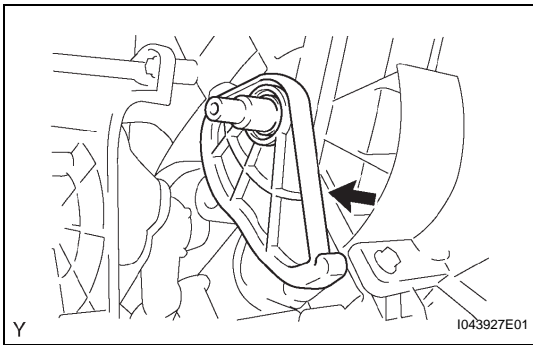

(f) Install the temperature cam.

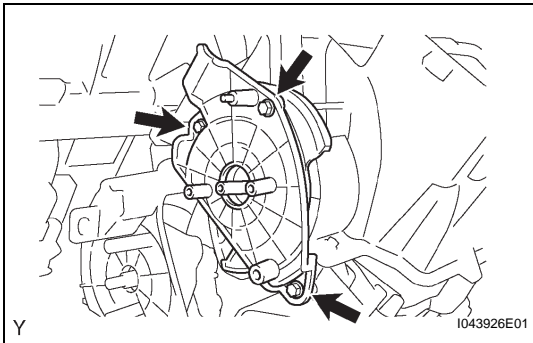

(g) Install the temperature mounting plate with the 3 bolts.

Torque: 2.0 N*m (20 kgf*cm, 18 in.*lbf)

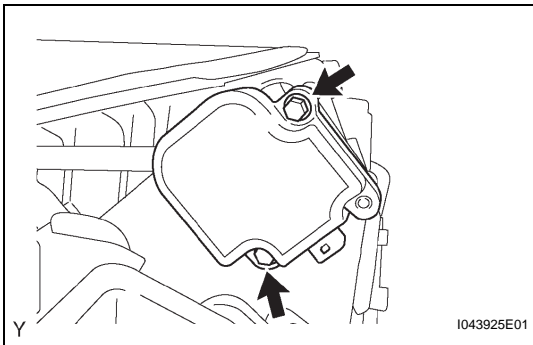

9. INSTALL AIR INLET CONTROL SERVO MOTOR

(a) Install the air inlet control servo motor with the 2 bolts.

Torque: 2.0 N*m (20 kgf*cm, 18 in.*lbf)

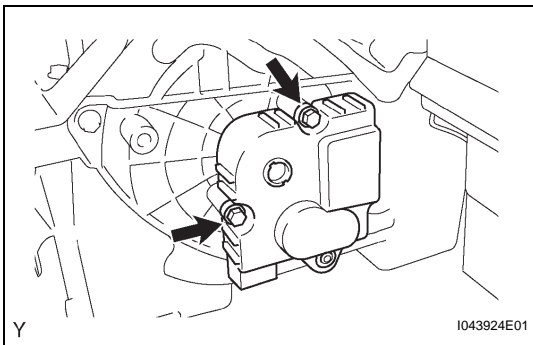

10. INSTALL AIR MIX CONTROL SERVO MOTOR

(a) Install the air mix control servo motor with the 2 bolts.

Torque: 2.0 N*m (20 kgf*cm, 18 in.*lbf)

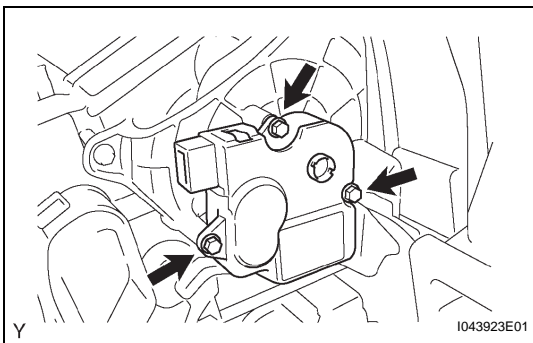

11. INSTALL MODE CONTROL SERVO MOTOR

(a) Install the mode control servo motor with the 3 bolts.

Torque: 2.0 N*m (20 kgf*cm, 18 in.*lbf)

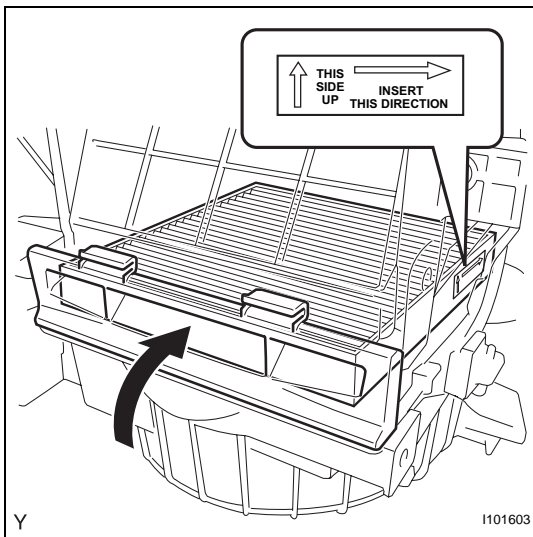
**12. INSTALL AIR FILTER**

- (a) Install the air filter.

NOTICE:

Check the installation direction as shown and install the air filter.

- (b) Engage the 2 tabs and close the filter door.

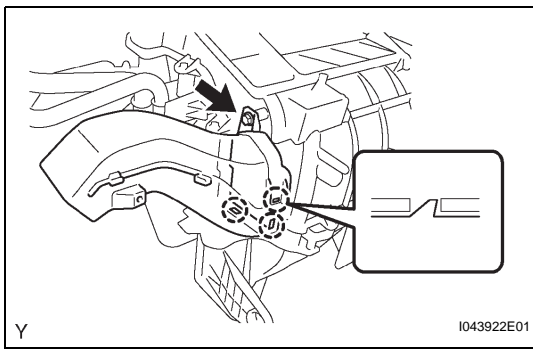
**13. INSTALL NO. 1 AIR DUCT**

- (a) Engage the 3 claws and install the air duct.
 (b) Install the bolt.

Torque: 2.0 N*m (20 kgf*cm, 18 in.*lbf)

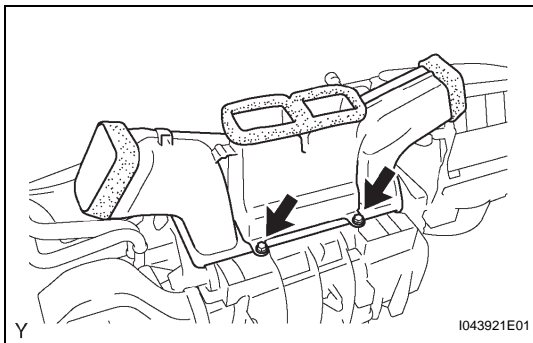
**14. INSTALL HEATER TO REGISTER CENTER DUCT**

- (a) Install the heater to register duct center with the 2 bolts.

Torque: 2.0 N*m (20 kgf*cm, 18 in.*lbf)

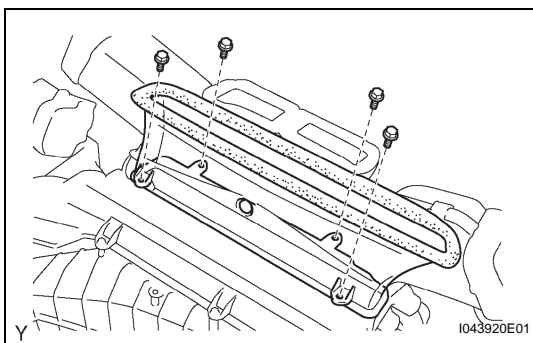
**15. INSTALL DEFROSTER NOZZLE ASSEMBLY LOWER**

- (a) Install the defroster nozzle assembly lower with the 4 bolts.

Torque: 2.0 N*m (20 kgf*cm, 18 in.*lbf)