

INSTALLATION

CAUTION:

Some of these service operations affect the SRS airbag system. Read the precautionary notices concerning the SRS airbag system before servicing (See page RS-1).

1. INSTALL FRONT SHOULDER BELT ANCHOR ADJUSTER ASSEMBLY

- (a) Insert the 2 claws of the front shoulder belt anchor adjuster into the hole in the body and mount the bolt.

Torque: 42 N*m (430 kgf*cm, 31 ft.*lbf)

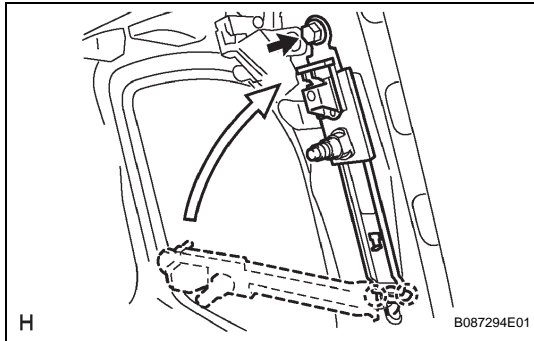

2. INSTALL FRONT SEAT OUTER BELT ASSEMBLY

- (a) Check the amount of inclination required to lock the retractor.

- (1) Gently incline the retractor from its initial position. Check that the belt does not lock when the retractor is inclined 15° or less in any directions. Also check that the belt locks when the inclination of the retractor is 45° or more.

NOTICE:

Do not disassemble the retractor.

If operation is not as specified, replace the front seat outer belt.

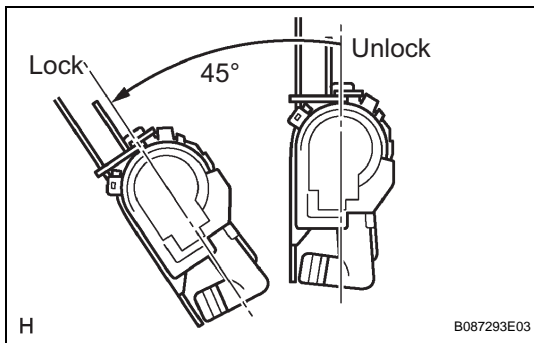

- (b) Hook the lower stay of the retractor onto the 2 body hooks.

- (c) Tighten bolt A, and then tighten bolt B.

Torque: 8.5 N*m (85 kgf*cm, 75 in.*lbf) for bolt A
42 N*m (430 kgf*cm, 31 ft.*lbf) for bolt B

- (d) Connect the pretensioner connector as shown in the illustration.

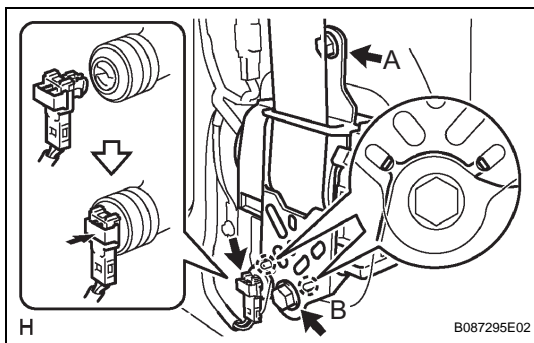

- (e) Install the shoulder anchor with the nut.

Torque: 42 N*m (430 kgf*cm, 31 ft.*lbf)

- (f) Check that the shoulder anchor rotates smoothly.



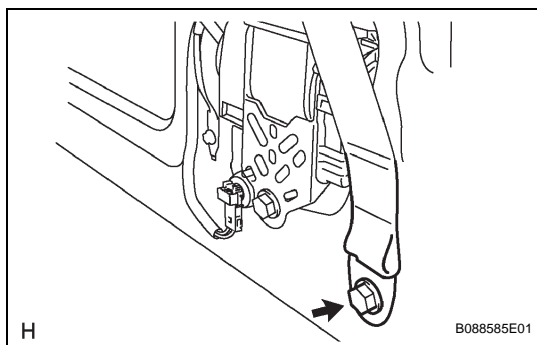

(g) Install the floor anchor of the front seat outer belt with the bolt.

(h) Check the ELR lock.

NOTICE:

- The check should be performed with the front seat outer belt installed.
- Do not allow the anchor part of the front seat belt outer and the protruding parts of the door panel to overlap.

(1) With the belt installed, check that the belt locks when it is pulled out quickly.
If operation is not as specified, replace the front seat outer belt.

(i) Remove the bolt and floor anchor.

3. INSTALL ACCESS PANEL INSIDE HANDLE SUB-ASSEMBLY (See page ED-62)

4. INSTALL REAR DOOR TRIM BOARD SUB-ASSEMBLY

- (a) Engage the 9 clips and install the rear door trim board.
(b) Install the clip.

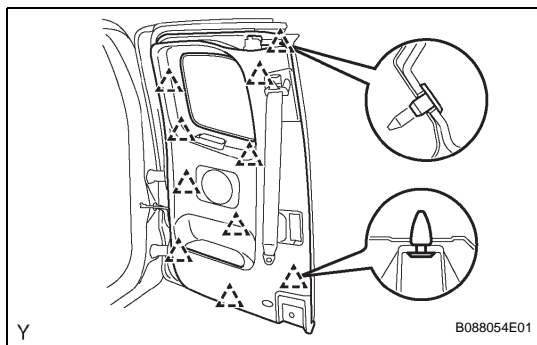

5. INSTALL ACCESS PANEL INSIDE HANDLE BEZEL

- (a) Install the access panel inside handle bezel with the screw.
(b) Close the cover.

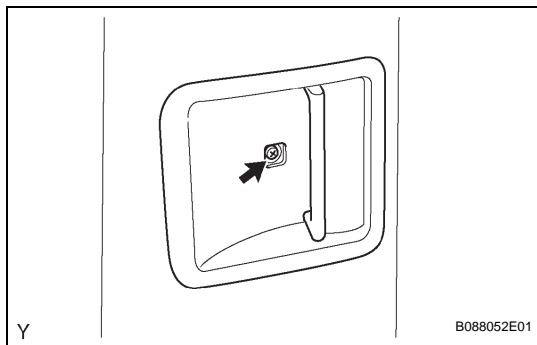

6. INSTALL DOOR PULL HANDLE

- (a) Install the door pull handle with the screw.

7. INSTALL LAP BELT OUTER ANCHOR COVER (See page ED-63)

8. INSTALL ACCESS PANEL REAR WEATHERSTRIP (See page ED-64)

9. CONNECT CABLE TO NEGATIVE BATTERY TERMINAL

Torque: 3.9 N*m (40 kgf*cm, 35 in.*lbf)

10. INSPECT SRS WARNING LIGHT

(See page RS-28)

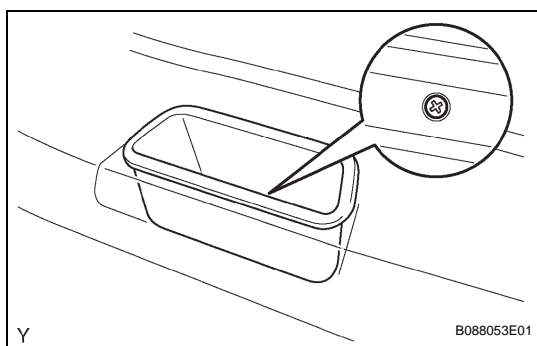

DISPOSAL

HINT:

When scrapping vehicles equipped with a seat belt pretensioner or disposing of a front seat outer belt (with seat belt pretensioner), always first activate the seat belt pretensioner in accordance with the procedures described below. If any abnormality occurs during activation of the seat belt pretensioner, contact the SERVICE DEPARTMENT of TOYOTA MOTOR SALES, U.S.A., INC. When disposing of a front seat outer belt assembly (with seat belt pretensioner) that was activated in a collision, start by step 2-(f) in this section.

CAUTION:

- **Never dispose of a front seat outer belt assembly that has an inactivated pretensioner.**
- **The seat belt pretensioner produces a loud, exploding sound when it activates. Perform the operation where it will not be a nuisance to persons nearby .**
- **When activating a front seat outer belt (with seat belt pretensioner), stand at least 10 m (33 ft) away from the front seat outer belt.**
- **Use gloves and safety glasses when handling a front seat belt with an activated pretensioner.**
- **Always wash your hands with water after completing activation.**
- **Do not apply water to a front seat outer belt that has an activated pretensioner.**
- **When activating the seat belt pretensioner, always use the specified SST (SRS air bag deployment tool).**
- **Perform operation in a place away from electrical interference.**

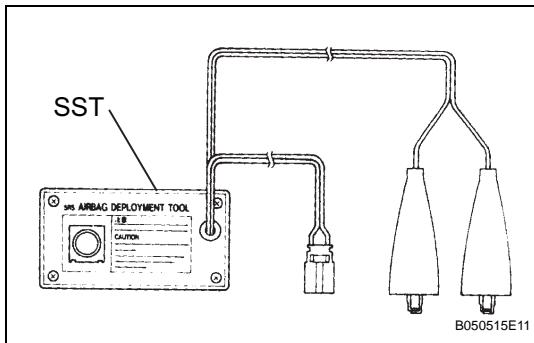
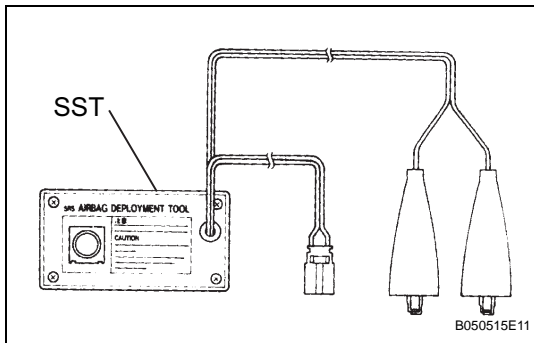

1. DISPOSE OF FRONT SEAT OUTER BELT ASSEMBLY (When Installed in Vehicle)

HINT:

Prepare a battery to power activation of the seat belt pretensioner.

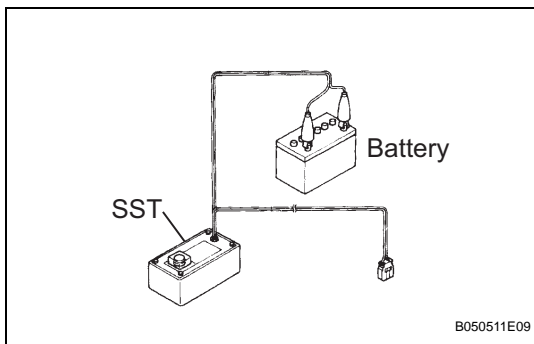

- (a) Check whether SST is functioning.
SST 09082-00700, 09082-00770

CAUTION:

When activating the seat belt pretensioner, always use the specified SST.

- (1) Connect SST red clip to the battery positive (+) terminal and the black clip to the battery negative (-) terminal.

HINT:

Do not connect the yellow connector. The yellow connector is used to connect to the seat belt pretensioner.

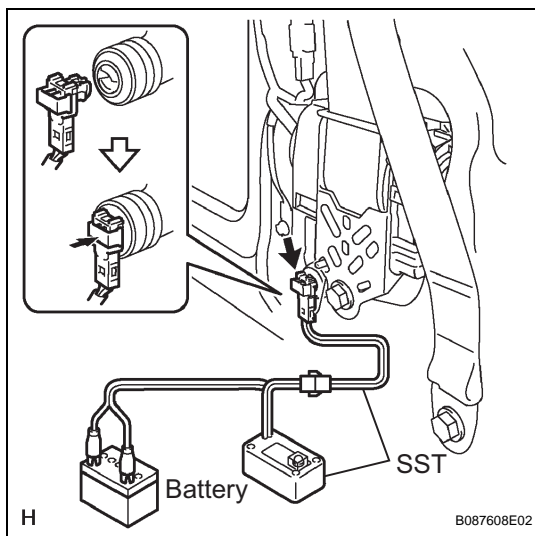
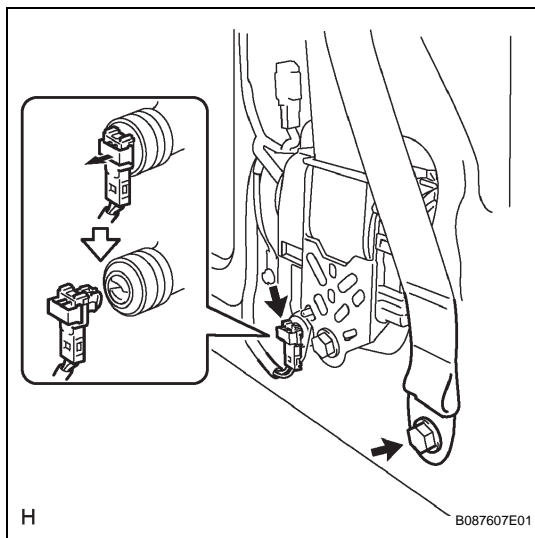
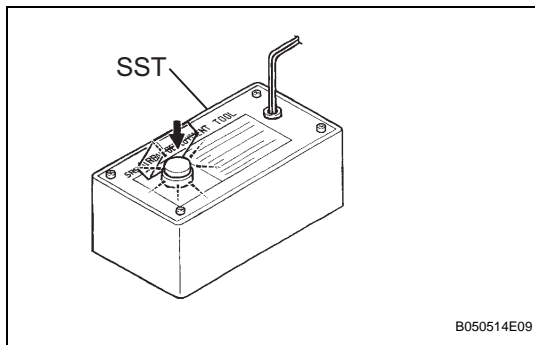

- (2) Press SST activation switch and check that the LED of SST activation switch turns on.

CAUTION:

If the LED turns on when the activation switch is not being pressed, SST may be malfunctioning. Do not use SST.

- (b) Disconnect SST from the battery.
 (c) Disconnect the pretensioner connector.
- (1) Disconnect cable from negative battery terminal.
 - (2) Remove the access panel rear weatherstrip (See page SB-36).
 - (3) Remove the lap belt outer anchor cover (See page SB-36).
 - (4) Remove the door pull handle (See page SB-36).
 - (5) Remove the access panel inside handle bezel (See page SB-36).
 - (6) Remove the rear door trim board (See page SB-37).
 - (7) Install the floor anchor with the bolt.
Torque: 42 N*m (430 kgf*cm, 31 ft.*lbf)
 - (8) Disconnect the pretensioner connector as shown in the illustration.

- (d) Connect the SST.
 (1) Connect SST, then connect the yellow connector to the seat belt pretensioner.

SST 09082-00700, 09082-00770

NOTICE:

To avoid damaging SST connector and wire harness, do not lock the secondary lock of the twin lock.

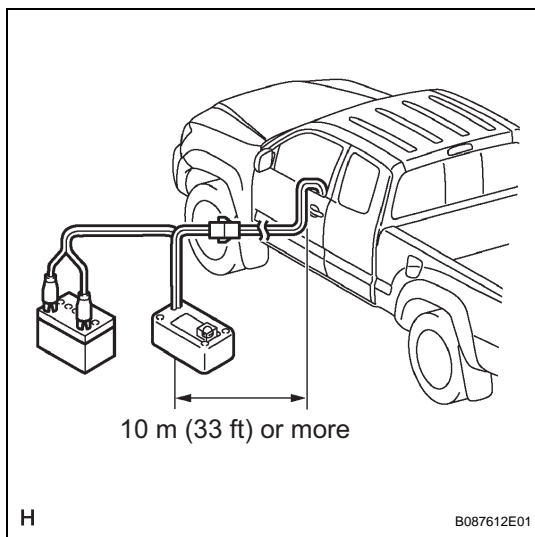

- (2) Move SST at least 10 m (33 ft) away from the front of the vehicle.
- (3) Close all the doors and windows of the vehicle.
HINT:
Do not close the windows fully. Leave a gap for inserting SST wire harness.
NOTICE:
Take care not to damage SST wire harness.
- (4) Connect SST red clip to the battery positive (+) terminal and the black clip to the battery negative (-) terminal.
- (e) Activate the seat belt pretensioner.
 - (1) Confirm that no one is inside the vehicle or within 10 m (33 ft) of the vehicle.
 - (2) Press SST activation switch and activate the seat belt pretensioner.
HINT:
The seat belt pretensioner operates simultaneously with SST activation switch LED light.
- (f) Dispose of the outer belt (with the seat belt pretensioner).
CAUTION:
 - **Do not touch the outer belt for at least 30 minutes after the seat belt pretensioner has been activated. It is very hot.**
 - **Use gloves and safety glasses when handling an outer belt with a pretensioner that has been activated.**
 - **Always wash your hands with water after completing the operation.**
 - **Do not apply water to a front seat outer belt that has an activated pretensioner.**
 HINT:
When scrapping a vehicle, activate the seat belt pretensioner, and then scrap the vehicle with the activated outer belt still installed.

2. DISPOSE OF FRONT SEAT OUTER BELT ASSEMBLY (When not Installed in Vehicle)

NOTICE:

- **When only disposing of the front seat outer belt (with the seat belt pretensioner), never use the customer's vehicle to activate the seat belt pretensioner.**
- **Be sure to follow the procedures listed below when activating the seat belt pretensioner.**

HINT:

Prepare a battery as the power source to activate the seat belt pretensioner.

- (a) Remove the front seat outer belt (See page [SB-36](#)).

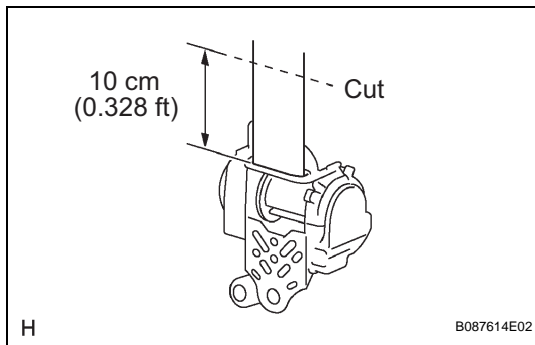

- (b) Wind the seat belt with the retractor.
- (c) When the seat belt is sufficiently wound, cut the seat belt approximately 10 cm (0.328 ft) from the retractor, as shown in the illustration.

HINT:

The retractor resistance increases in correlation with how much the seat belt is wound.

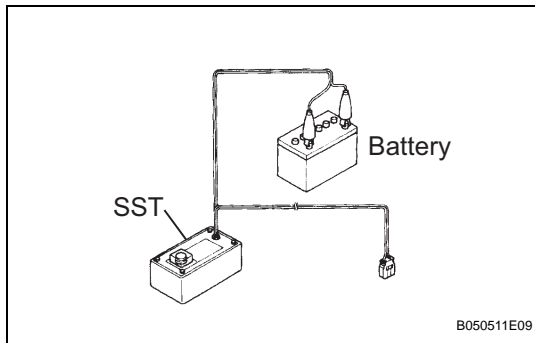

- (d) Check whether SST is functioning (see step 2-(a)).

SST 09082-00700, 09082-00770

CAUTION:

When activating the seat belt pretensioner, always use the specified SST.

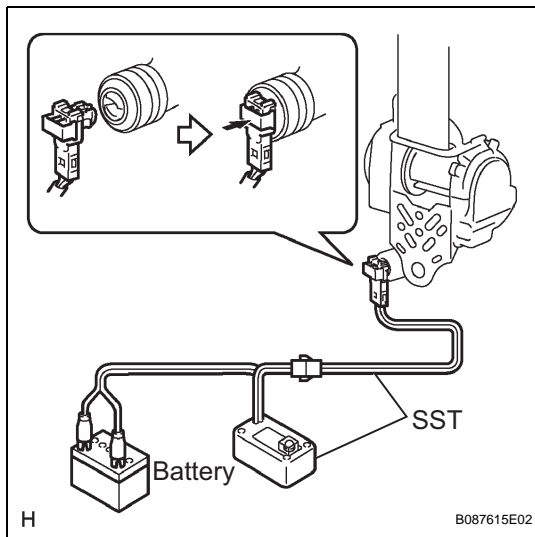

- (e) Connect SST.

- (1) Connect SST, then connect them to the seat belt pretensioner.

NOTICE:

To avoid damaging SST connector and wire harness, do not lock the secondary lock of the twin lock.

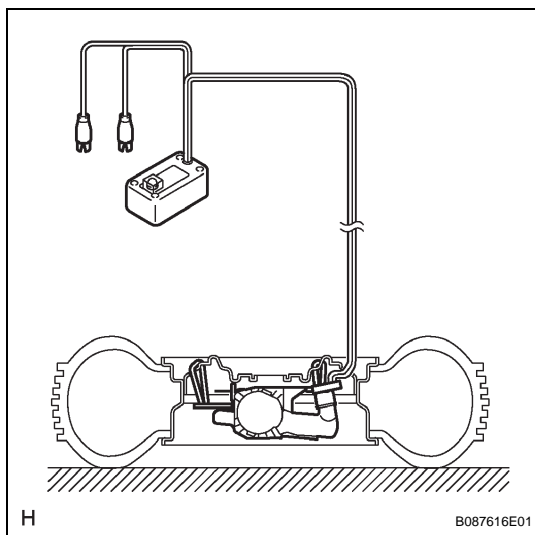

- (2) Place the outer belt on the ground and cover it with a tire with a wheel attached.

NOTICE:

Set up the front seat outer belt assembly as shown in the illustration.

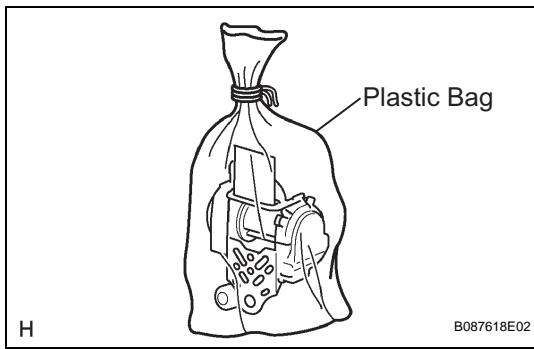
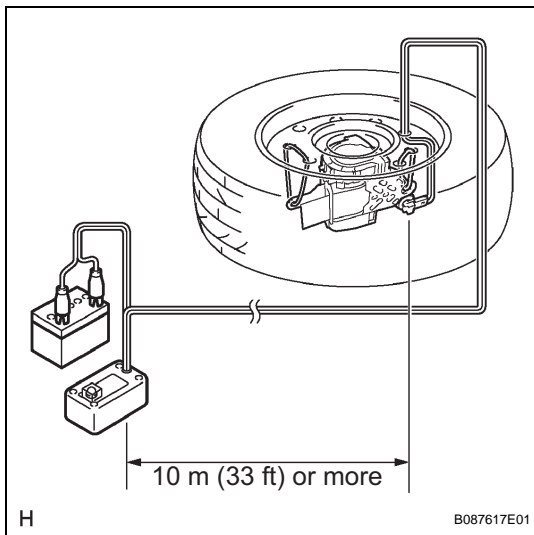

- (3) Move SST at least 10 m (33 ft) away from the wheel.

NOTICE:

Take care not to damage SST wire harness.

- (f) Activate the seat belt pretensioner.
- (1) Connect SST red clip to the battery positive (+) terminal and the black clip to the battery negative (-) terminal.
 - (2) Check that no one is within 10 m (33 ft) of the wheel.
 - (3) Press SST activation switch and activate the seat belt pretensioner.

HINT:

The seat belt pretensioner operates simultaneously with SST activation switch LED light.

- (g) Dispose of the outer belt (with the seat belt pretensioner).

CAUTION:

- **Do not touch the outer belt for at least 30 minutes after the seat belt pretensioner has been activated. It is very hot.**
- **Use gloves and safety glasses when handling an outer belt assembly with a pretensioner that has been activated.**
- **Always wash your hands with water after completing operation.**
- **Do not apply water to an outer belt assembly that has an activated pretensioner.**

- (1) Remove the wheel and SST.
- (2) Place the outer belt in a plastic bag, tie the end tightly and dispose of it in the same way as other general parts.