

REAR SEAT OUTER BELT ASSEMBLY (for Access Cab)

COMPONENTS

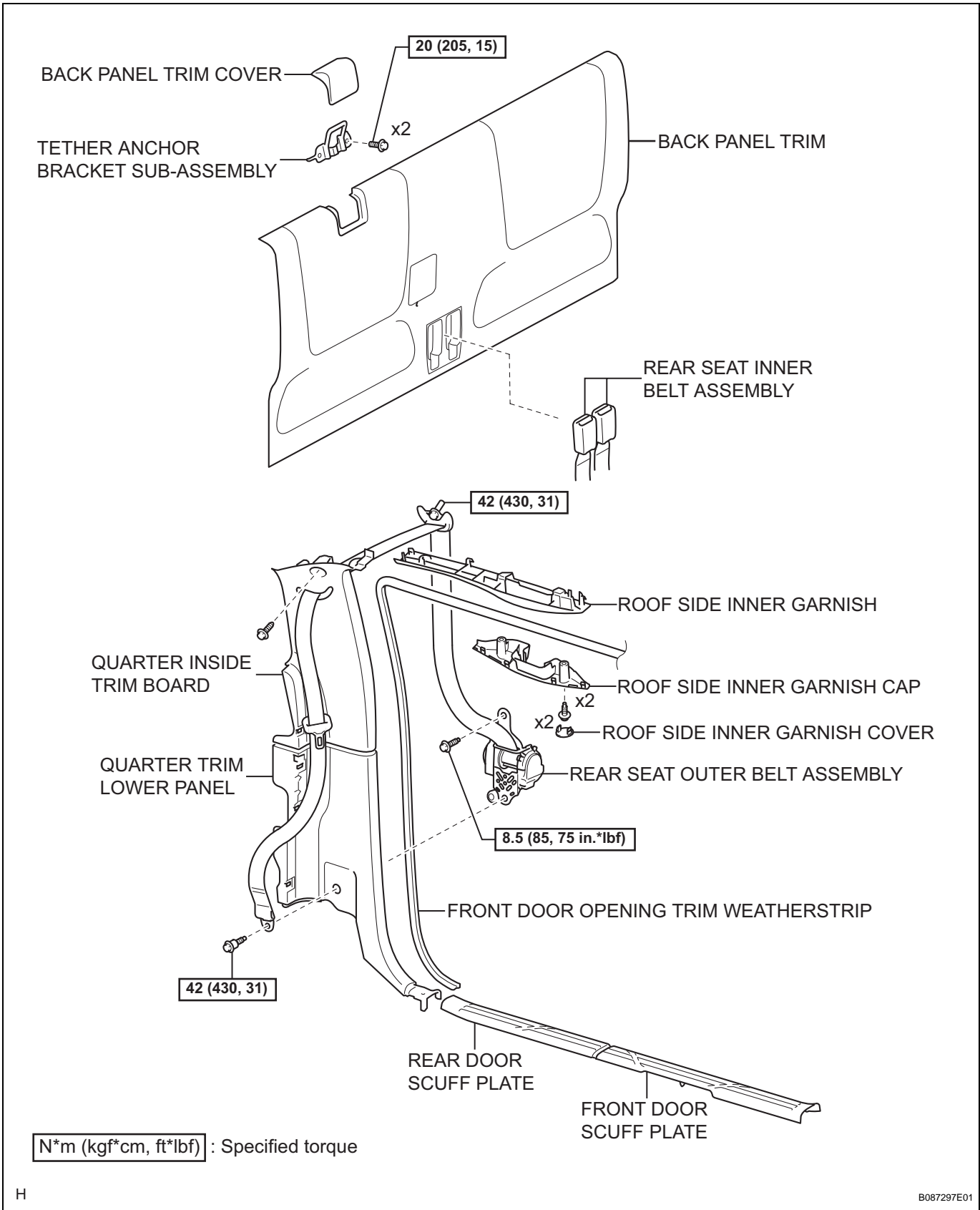

SB

REMOVAL

1. REMOVE FRONT DOOR SCUFF PLATE (See page [IR-61](#))
2. REMOVE REAR DOOR SCUFF PLATE (See page [IR-61](#))
3. REMOVE ROOF SIDE INNER GARNISH COVER (See page [IR-62](#))
4. REMOVE ROOF SIDE INNER GARNISH CAP (See page [IR-62](#))
5. REMOVE FRONT DOOR OPENING TRIM WEATHERSTRIP
 - (a) Separate the front door opening trim weatherstrip to the extent which allows the removal of the roof side garnish inner, quarter trim lower panel and quarter inside trim board.
6. REMOVE BACK PANEL TRIM COVER (See page [IR-64](#))
7. REMOVE REAR SEAT INNER BELT ASSEMBLY (See page [IR-64](#))
8. REMOVE BACK PANEL TRIM (See page [IR-64](#))
9. REMOVE QUARTER TRIM LOWER PANEL (See page [IR-65](#))
10. REMOVE ROOF SIDE INNER GARNISH (See page [IR-65](#))
11. REMOVE QUARTER INSIDE TRIM BOARD (See page [IR-65](#))
12. REMOVE REAR SEAT OUTER BELT ASSEMBLY
 - (a) Remove the bolt and shoulder anchor.

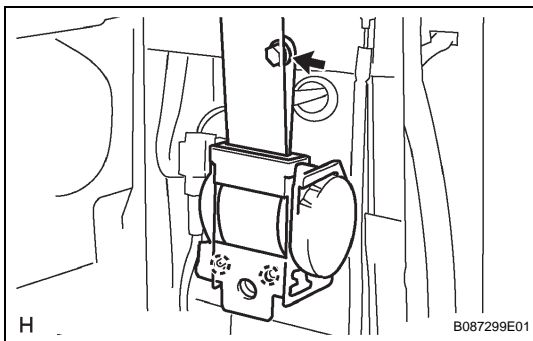
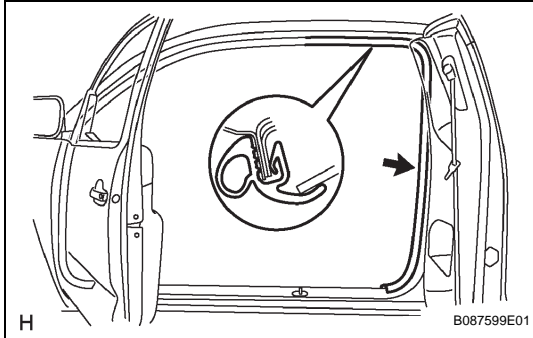

- (b) Remove the bolt and retractor.

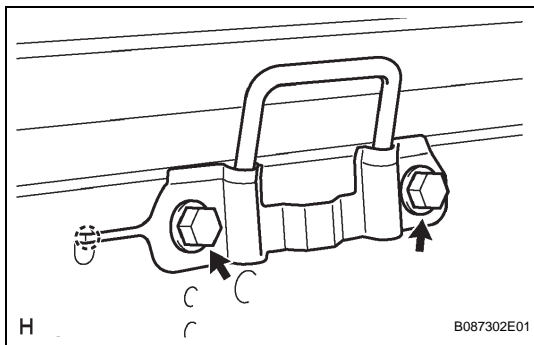

13. REMOVE TETHER ANCHOR BRACKET SUB-ASSEMBLY

- (a) Remove the 2 bolts and tether anchor bracket.

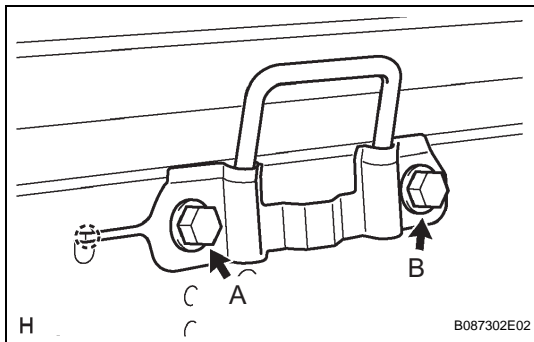

INSTALLATION

1. INSTALL TETHER ANCHOR BRACKET SUB-ASSEMBLY

- (a) Hook the claw of the tether anchor bracket into the body hole.
 (b) Tighten bolt A, and then tighten bolt B.
Torque: 20 N*m (205 kgf*cm, 15 ft.*lbf)

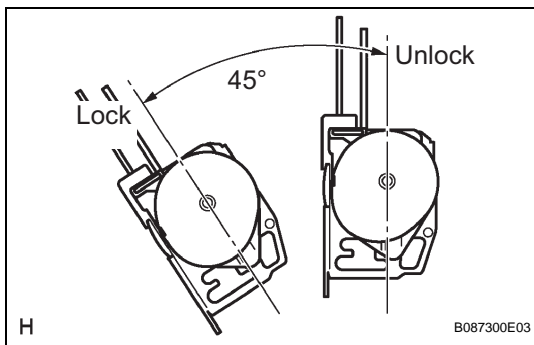

2. INSTALL REAR SEAT OUTER BELT ASSEMBLY

- (a) Check the amount of inclination required to lock the retractor.

- (1) Gently incline the retractor from its initial position. Check that the belt does not lock when the retractor is inclined 15° or less in any directions. Also check the belt locks when the inclination of the retractor is 45° or more.

NOTICE:

Do not disassemble the retractor.

If operation is not as specified, replace the rear seat outer belt.

- (b) Hook the lower stay of the retractor onto the 2 body hooks.

- (c) Tighten the bolt.

Torque: 8.5 N*m (85 kgf*cm, 75 in.*lbf)

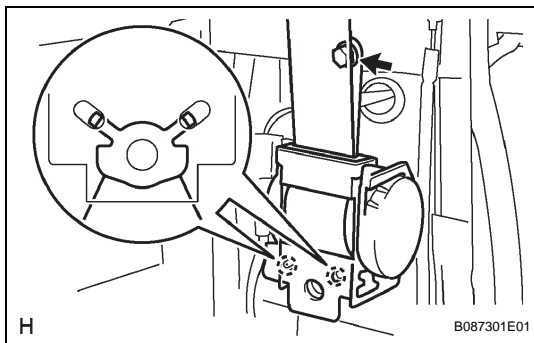

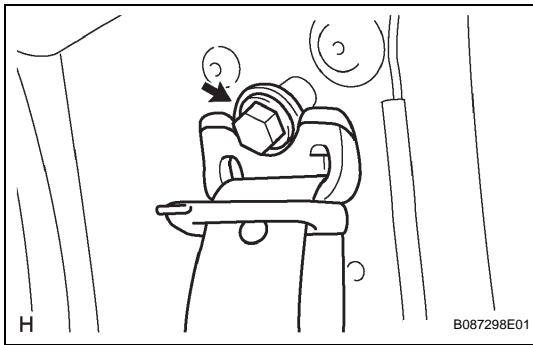

- (d) Install the shoulder anchor with the bolt.
Torque: 42 N*m (430 kgf*cm, 31 ft.*lbf)
 (e) Check that the shoulder anchor rotates smoothly.

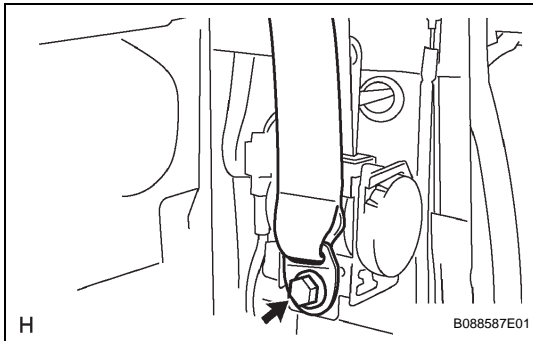

- (f) Install the floor anchor with the bolt.
Torque: 42 N*m (430 kgf*cm, 31 ft.*lbf)
 (g) Check the ELR lock.
NOTICE:
- The check should be performed with the rear seat outer belt installed.
 - Do not allow the anchor part of the rear seat outer belt and the protruding parts of the floor panel to overlap.
- (1) With the belt installed, check that the belt locks when it is pulled out quickly.
 If operation is not as specified, replace the rear seat outer belt.

- (h) Remove the bolt and floor anchor.

3. **INSTALL QUARTER INSIDE TRIM BOARD** (See page [IR-71](#))
4. **INSTALL ROOF SIDE INNER GARNISH** (See page [IR-71](#))
5. **INSTALL QUARTER TRIM LOWER PANEL** (See page [IR-72](#))
6. **INSTALL REAR SEAT INNER BELT ASSEMBLY** (See page [IR-72](#))
7. **INSTALL BACK PANEL TRIM** (See page [IR-72](#))
8. **INSTALL BACK PANEL TRIM COVER** (See page [IR-73](#))
9. **INSTALL FRONT DOOR OPENING TRIM WEATHERSTRIP**
 - (a) Install the front door opening trim weatherstrip.
10. **INSTALL ROOF SIDE INNER GARNISH CAP** (See page [IR-75](#))
11. **INSTALL ROOF SIDE INNER GARNISH COVER** (See page [IR-75](#))
12. **INSTALL REAR DOOR SCUFF PLATE** (See page [IR-75](#))
13. **INSTALL FRONT DOOR SCUFF PLATE** (See page [IR-75](#))

