

CLUTCH SWITCH

COMPONENTS

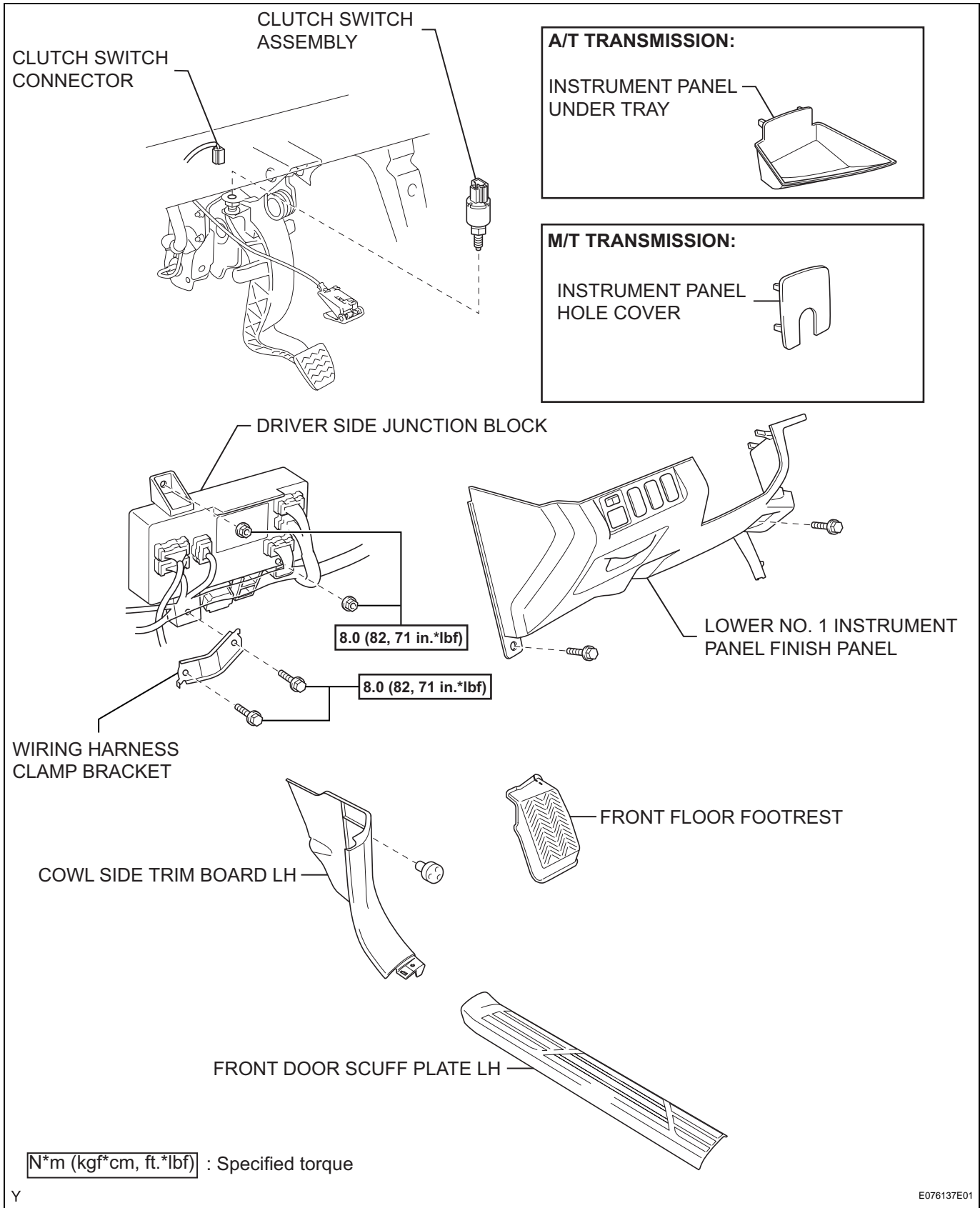

REMOVAL

1. DISCONNECT CABLE FROM NEGATIVE BATTERY TERMINAL
2. REMOVE FRONT FLOOR FOOTREST (See page [IR-1](#))
3. REMOVE FRONT DOOR SCUFF PLATE LH (for Regular Cab) (See page [IR-40](#))
4. REMOVE FRONT DOOR SCUFF PLATE LH (for Access Cab) (See page [IR-61](#))
5. REMOVE FRONT DOOR SCUFF PLATE LH (for Double Cab) (See page [IR-12](#))
6. REMOVE COWL SIDE TRIM BOARD LH (for Regular Cab) (See page [IR-40](#))
7. REMOVE COWL SIDE TRIM BOARD LH (for Access Cab) (See page [IR-61](#))
8. REMOVE COWL SIDE TRIM BOARD LH (for Double Cab) (See page [IR-12](#))
9. REMOVE INSTRUMENT PANEL UNDER TRAY (for Pedal Type Parking Brake) (See page [IP-9](#))
10. REMOVE INSTRUMENT PANEL HOLE COVER (for Lever Type Parking Brake) (See page [IP-9](#))
11. SEPARATE HOOD LOCK CONTROL LEVER SUB-ASSEMBLY (See page [ED-3](#))
12. REMOVE LOWER NO. 1 INSTRUMENT PANEL FINISH PANEL (See page [IP-12](#))
13. SEPARATE DRIVER SIDE JUNCTION BLOCK
 - (a) Remove the 2 bolts and bracket.
 - (b) Remove the 2 nuts and separate the driver side junction block assembly.

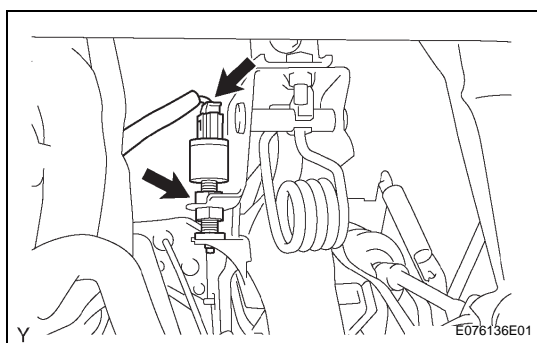
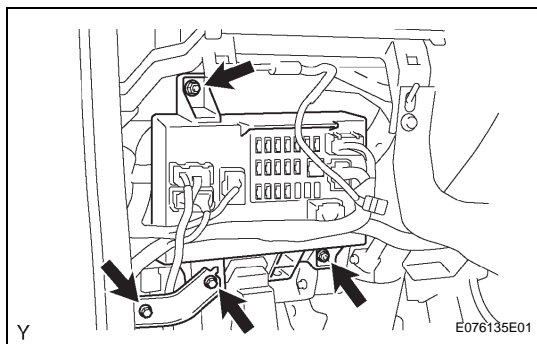

14. REMOVE CLUTCH SWITCH ASSEMBLY
 - (a) Disconnect the connector.
 - (b) Loosen the nut and remove the clutch switch assembly.

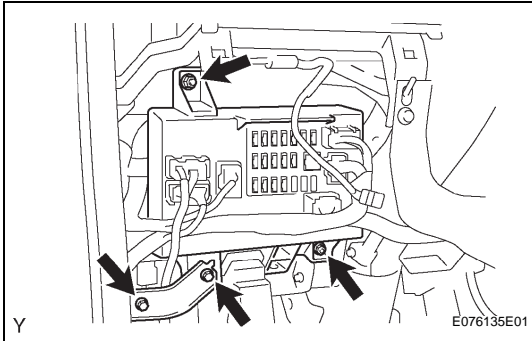
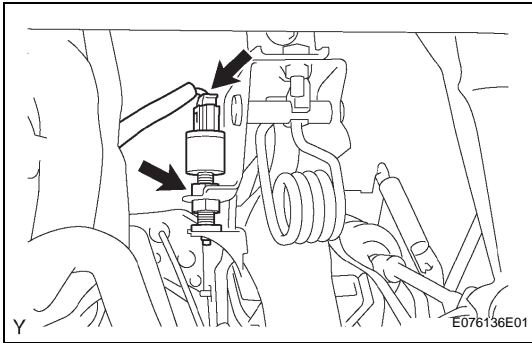

INSTALLATION

1. **INSTALL CLUTCH SWITCH ASSEMBLY**
 - (a) Install the clutch switch assembly and tighten the nut.
 - (b) Connect the connector.
2. **INSTALL DRIVER SIDE JUNCTION BLOCK**
 - (a) Install the driver side junction block assembly with the 2 nuts.
Torque: 8.0 N*m (82 kgf*cm, 71 in.*lbf)
 - (b) Install the bracket with the 2 bolts.
Torque: 8.0 N*m (82 kgf*cm, 71 in.*lbf)
3. **INSTALL LOWER NO. 1 INSTRUMENT PANEL FINISH PANEL** (See page [IP-22](#))
4. **CONNECT HOOD LOCK CONTROL LEVER SUB-ASSEMBLY** (See page [ED-8](#))
5. **INSTALL INSTRUMENT PANEL HOLE COVER** (for Lever Type Parking Brake) (See page [IP-25](#))
6. **INSTALL INSTRUMENT PANEL UNDER TRAY** (for Pedal Type Parking Brake) (See page [IP-25](#))
7. **INSTALL COWL SIDE TRIM BOARD LH** (for Regular Cab) (See page [IR-52](#))
8. **INSTALL COWL SIDE TRIM BOARD LH** (for Access Cab) (See page [IR-75](#))
9. **INSTALL COWL SIDE TRIM BOARD LH** (for Double Cab) (See page [IR-12](#))
10. **INSTALL FRONT DOOR SCUFF PLATE LH** (for Regular Cab) (See page [IR-52](#))
11. **INSTALL FRONT DOOR SCUFF PLATE LH** (for Access Cab) (See page [IR-75](#))
12. **INSTALL FRONT DOOR SCUFF PLATE LH** (for Double Cab) (See page [IR-29](#))
13. **INSTALL FRONT FLOOR FOOTREST** (See page [IR-1](#))
14. **CONNECT CABLE TO NEGATIVE BATTERY TERMINAL**
Torque: 3.9 N*m (40 kgf*cm, 35 in.*lbf)