

# TRAILER SOCKET COMPONENTS

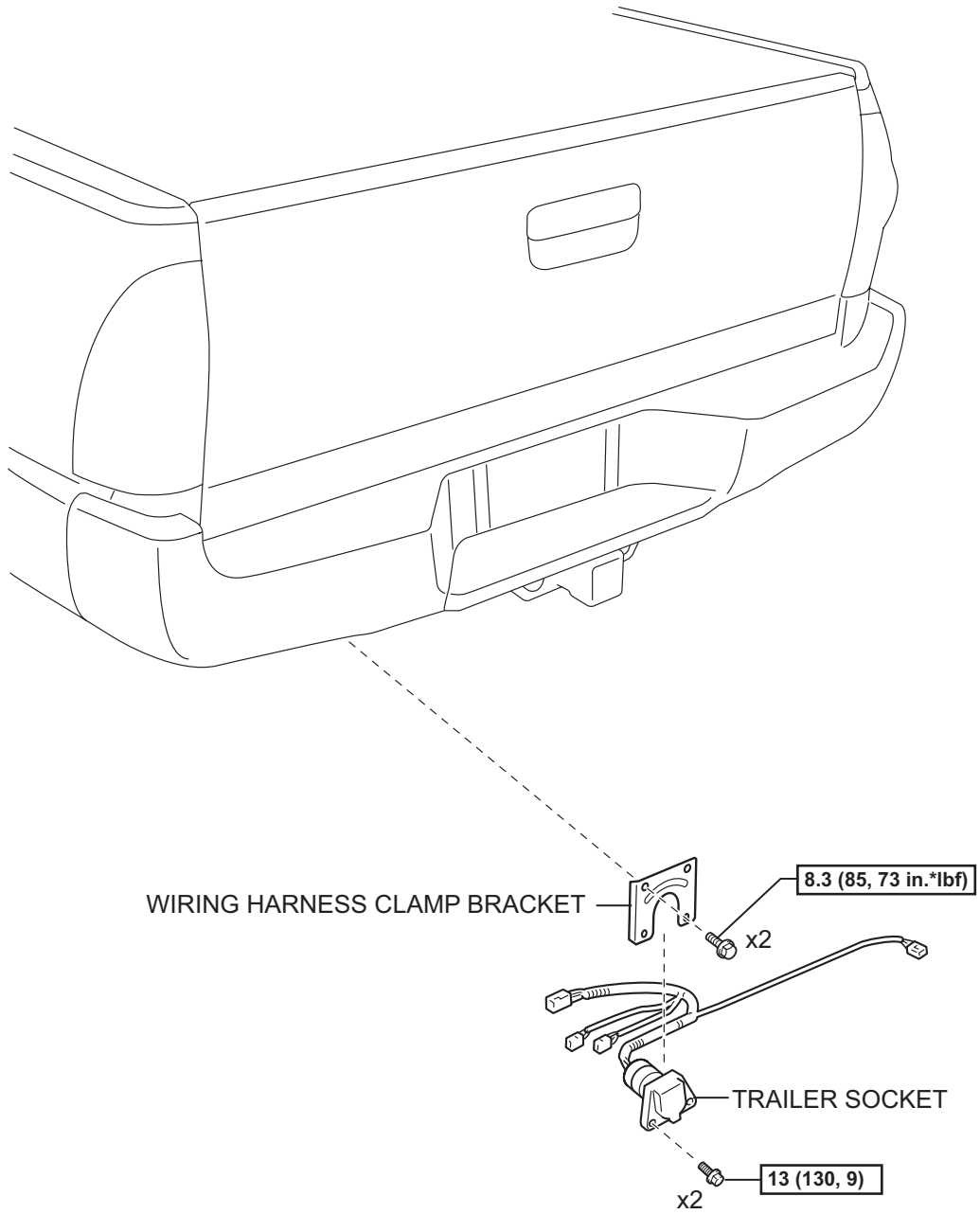

**N\*m (kgf\*cm, ft\*lbf)** : Specified torque



## REMOVAL

### 1. DISCONNECT CABLE FROM NEGATIVE BATTERY TERMINAL

### 2. REMOVE TRAILER SOCKET

- (a) Disconnect the 4 connectors and disengage the 2 clamps.
- (b) Remove the 2 bolts, then remove the No. 3 wire frame.

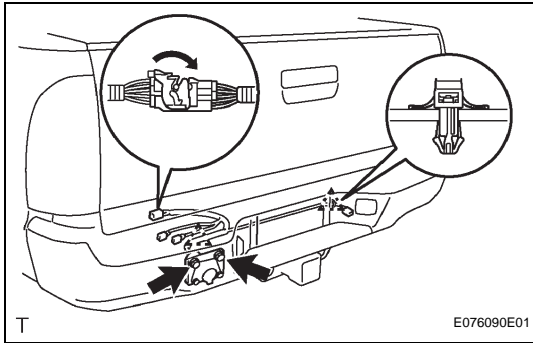

- (c) Remove the 2 bolts, then remove the wiring harness clamp bracket.

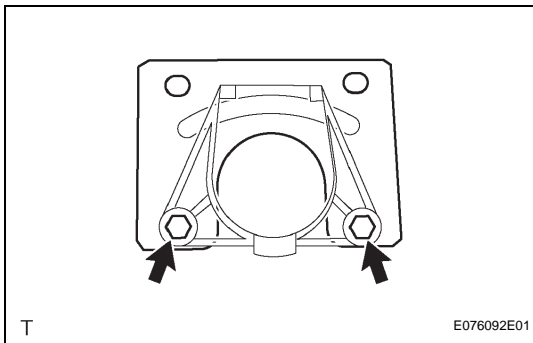

## INSTALLATION

### 1. INSTALL TRAILER SOCKET

- (a) Install the 2 bolts and wiring harness clamp bracket.  
**Torque: 8.3 N\*m (85 kgf\*cm, 73 in.\*lbf)**

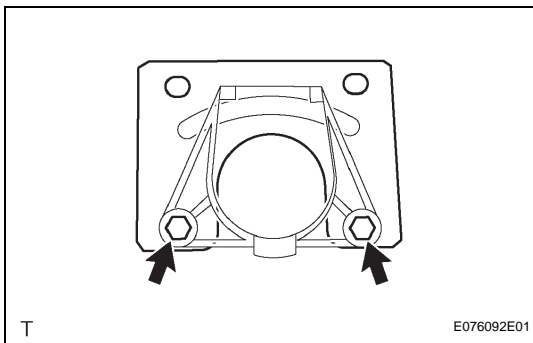

- (b) Install the 2 bolts and No. 3 wire frame.  
**Torque: 13 N\*m (130 kgf\*cm, 9 ft.\*lbf)**
- (c) Connect the 4 connectors and engage the 2 clamps.

### 2. CONNECT CABLE TO NEGATIVE BATTERY TERMINAL

- Torque: 3.9 N\*m (40 kgf\*cm, 35 in.\*lbf)**

