

# FRONT WIPER MOTOR

## COMPONENTS

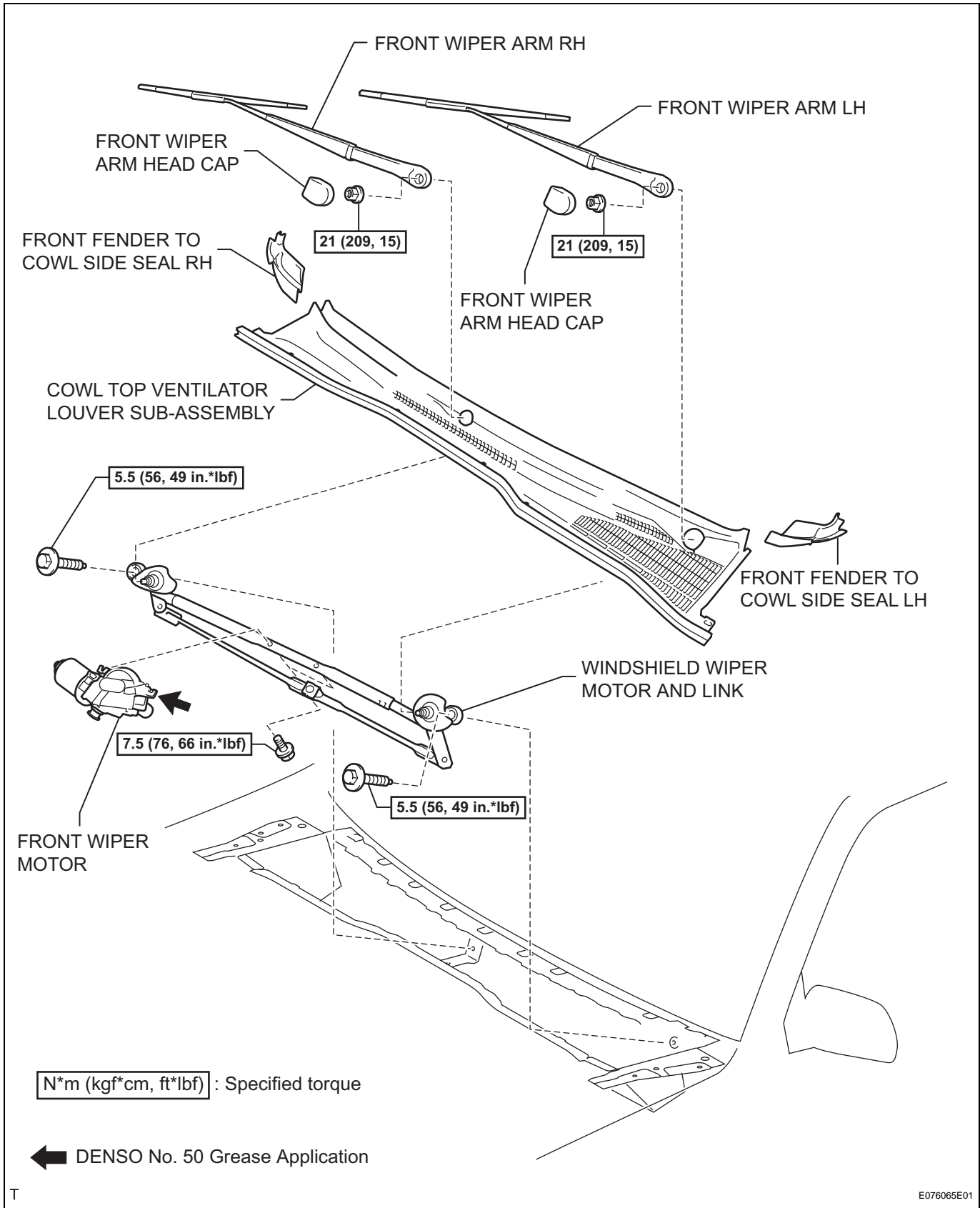

## ON-VEHICLE INSPECTION

### 1. INSPECT FRONT WIPER MOTOR (for Driver Side)

- (a) Check the automatic stop position.
  - (1) Operate the windshield wiper motor assembly, then stop the operation.
  - (2) Check the automatic stop position when stopping the windshield wiper motor assembly operation.

**Standard:**

**Front wiper arm stops at the position shown in the illustration.**

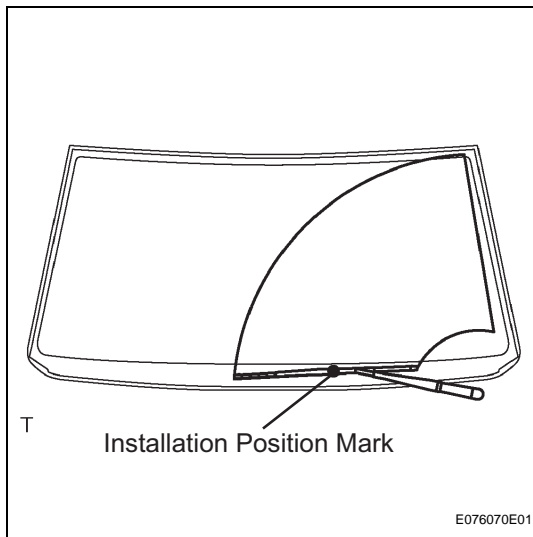

### 2. INSPECT FRONT WIPER MOTOR (for Front Passenger Side)

- (a) Check the automatic stop position.
  - (1) Operate the windshield wiper motor assembly, then stop the operation.
  - (2) Check the automatic stop position when stopping the windshield wiper motor assembly operation.

**Standard:**

**Front wiper arm stops at the position shown in the illustration.**

