

# WASHER NOZZLE

## INSPECTION

### 1. INSPECT WASHER NOZZLE

- (a) With the engine running, check that the washer fluid hits in the range indicated by the hatched lines on the windshield.

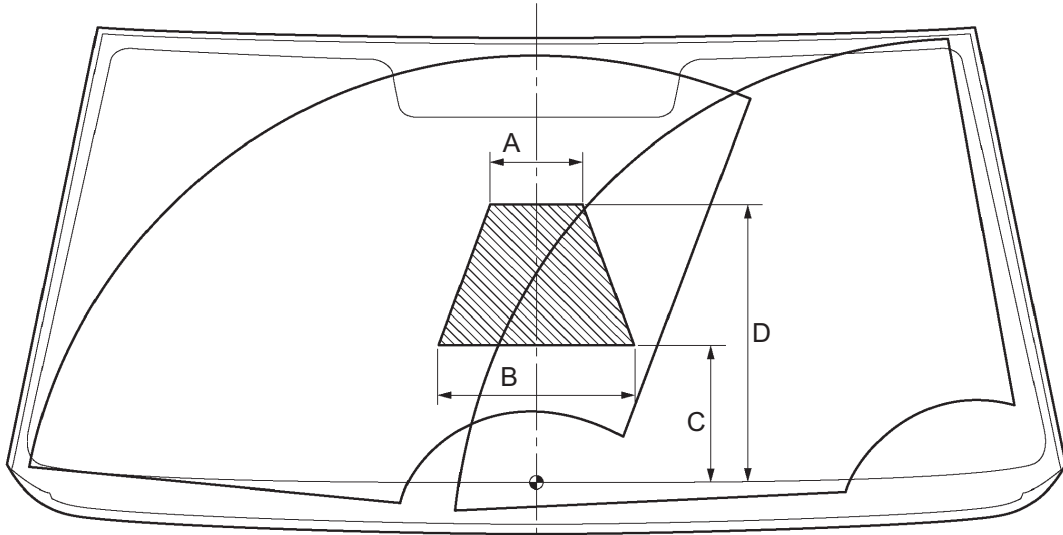

Standard: The washer fluid intersects within the range above.

A: 173.7 mm (6.83 in.)

B: 273 mm (10.75 in.)

C: 191.1 mm (7.52 in.)

D: 397.5 mm (15.65 in.)

T

E076098E01

### HINT:

This washer nozzle does not have an adjustment function because it has a spray type nozzle.