

REASSEMBLY

1. INSTALL HOOD LOCK CONTROL CABLE ASSEMBLY

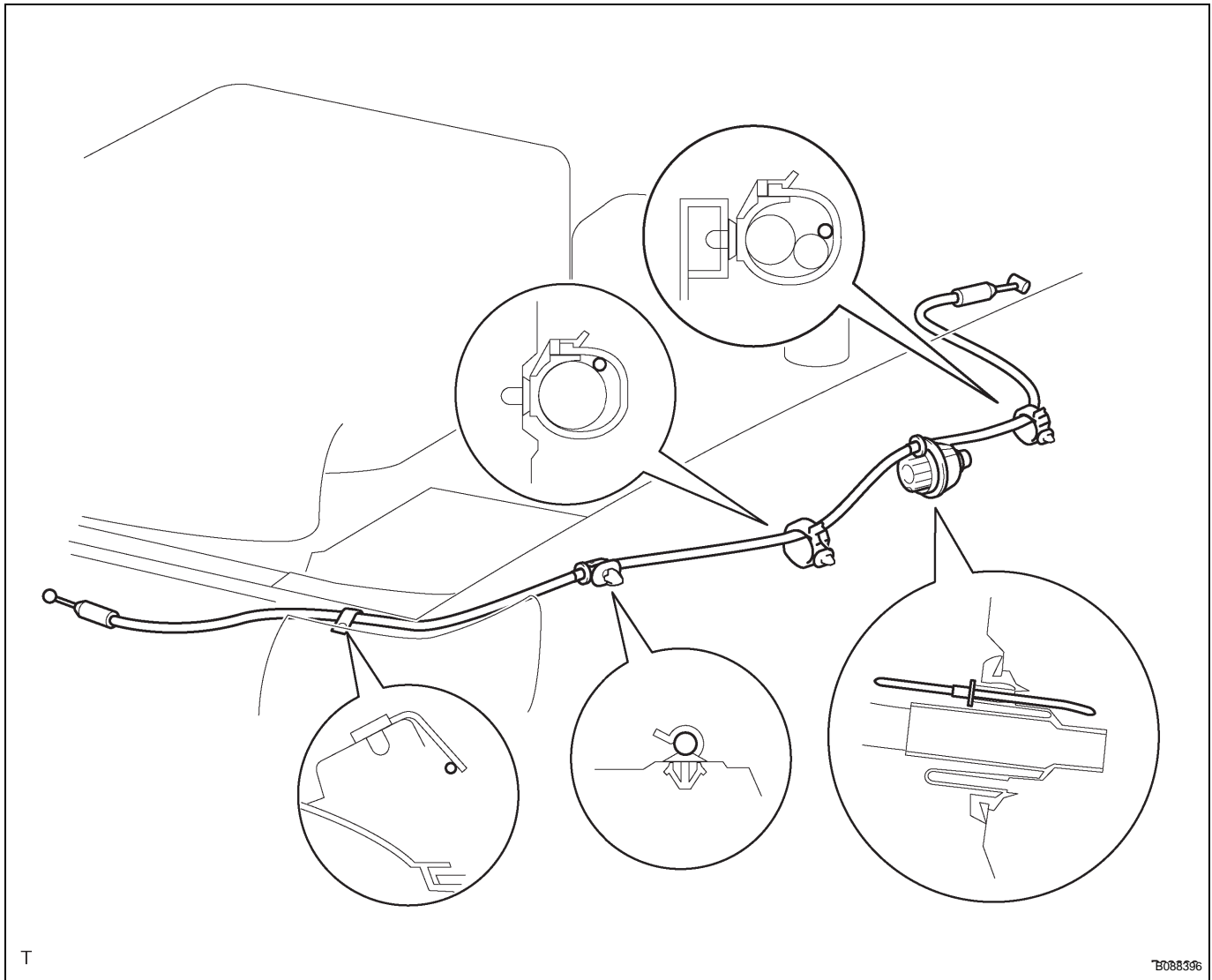

- (a) Tie the string inside the wire harness grommet to the hood lock control cable assembly.
- (b) Using the string, fit the hood lock control cable assembly into the wire harness grommet.

2. INSTALL HOOD LOCK CONTROL LEVER SUB-ASSEMBLY

- (a) Connect the hood lock control cable assembly.

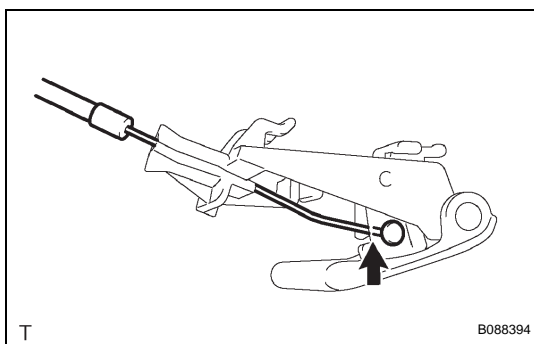

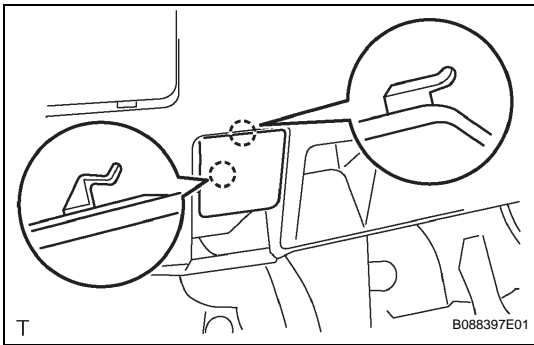

- (b) Engage the 2 claws and install the hood lock control lever sub-assembly.

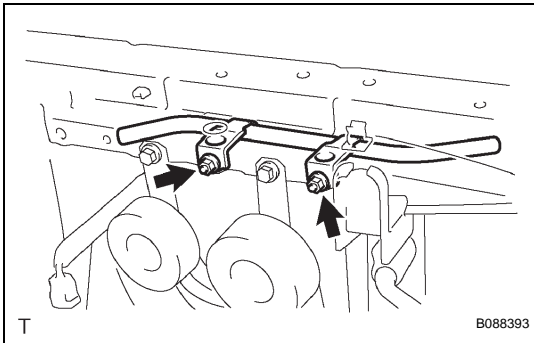

3. INSTALL HOOD LOCK CONTROL CABLE PROTECTOR SUB-ASSEMBLY

- (a) Install the hood lock control cable protector sub-assembly with the 2 nuts.

Torque: 5.5 N*m (56 kgf*cm, 49 in.*lbf)

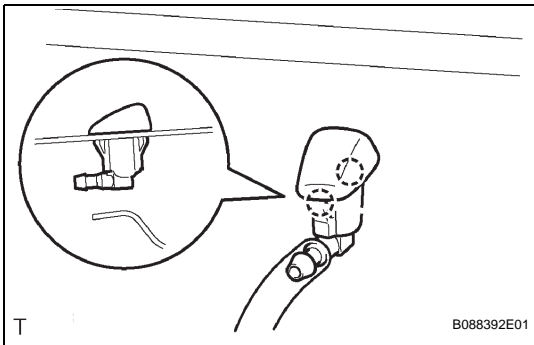

4. INSTALL WASHER NOZZLE SUB-ASSEMBLY

- (a) Connect the washer hose.
 (b) Engage the 2 claws and install the washer nozzle sub-assembly.

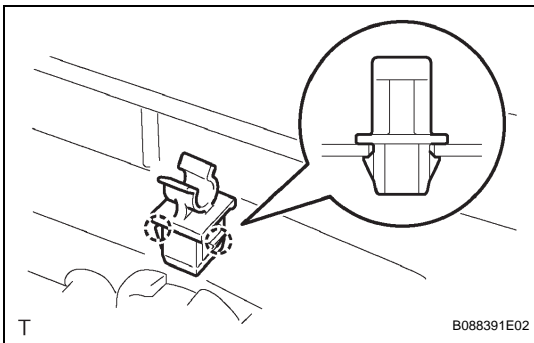

5. INSTALL HOOD SUPPORT

- (a) Engage the 2 claws and install the hood stay holder.

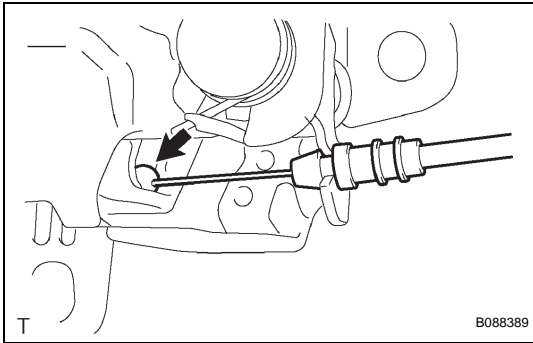

- (b) Install the grommet.
 (c) Install the hood support.

**6. INSTALL HOOD LOCK ASSEMBLY**

(a) Connect the hood lock control cable assembly.

(b) Install the hood lock assembly with the 3 bolts.
Torque: 12 N*m (122 kgf*cm, 9 ft.*lbf)

7. INSTALL NO. 2 HOOD LOCK RELEASE LEVER PROTECTOR (See page [ED-5](#))

8. INSTALL RADIATOR GRILLE (See page [ET-11](#))

