

## REASSEMBLY

### 1. INSTALL REAR DOOR WEATHERSTRIP LH

- (a) Engage the 32 clips and install a new rear door weatherstrip LH.

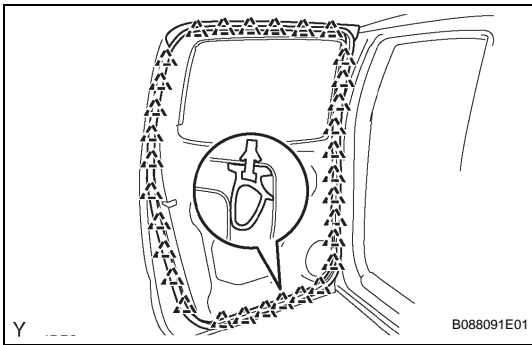

- (b) Engage the 2 clips.
- (c) Remove the tab tape at both ends of 2-sided tape attached to the weather strip, and attach the weather strip to the door panel with the 2-sided tape.

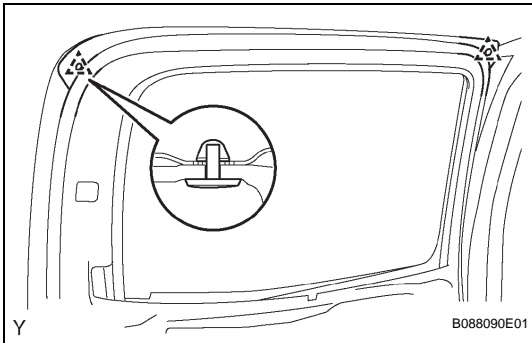

### 2. INSTALL REAR DOOR CHECK ASSEMBLY LH

- (a) Apply MP grease to the sliding areas of the check.
- (b) Install the rear door check assembly onto the door panel with the 2 nuts.

**Torque: 5.5 N\*m (56 kgf\*cm, 49 in.\*lbf)**

- (c) Apply adhesive to the threads of the bolt.

**Adhesive:**

**Part No. 08833-00070, THREE BOND 1324 or equivalent**

- (d) Install the rear door check assembly onto the body panel with the bolt.

**Torque: 30 N\*m (306 kgf\*cm, 22 ft.\*lbf)**

### 3. INSTALL REAR DOOR OUTSIDE HANDLE FRAME SUB-ASSEMBLY LH

- (a) Apply MP grease to the sliding areas of the rear door outside handle frame sub-assembly LH.

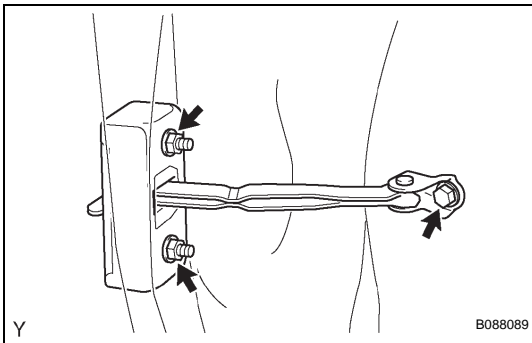

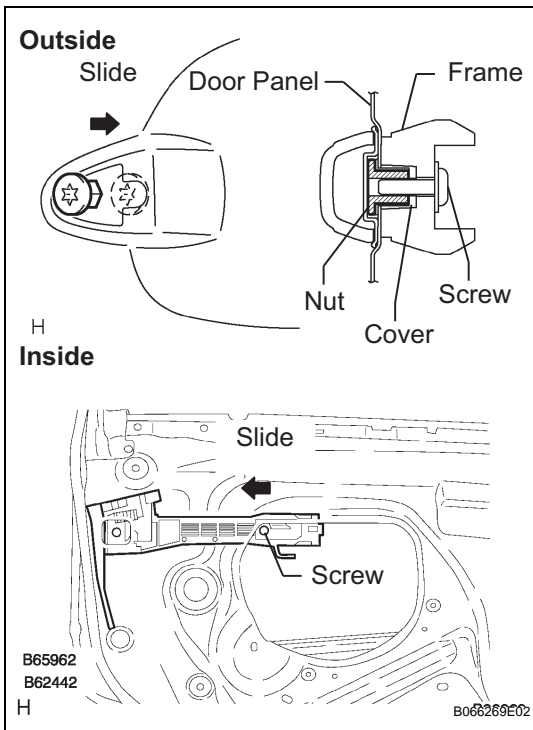

- (b) Using a torx socket wrench T30 , install the handle frame sub-assembly with the screw.  
**Torque: 7.0 N\*m (71 kgf\*cm, 62 in.\*lbf)**  
**NOTICE:**  
**A cover should be inserted between the nut and the door panel.**

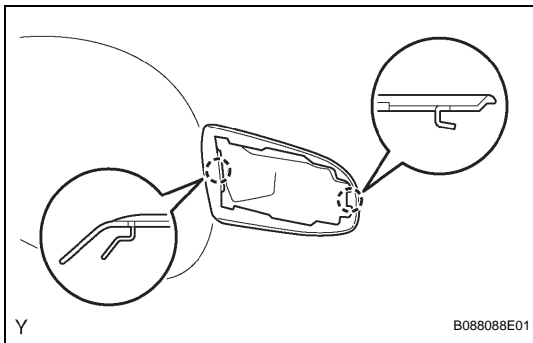

#### 4. INSTALL REAR DOOR OUTSIDE HANDLE ASSEMBLY RH

- (a) Engage the 2 claws and install the outside handle rear pad.

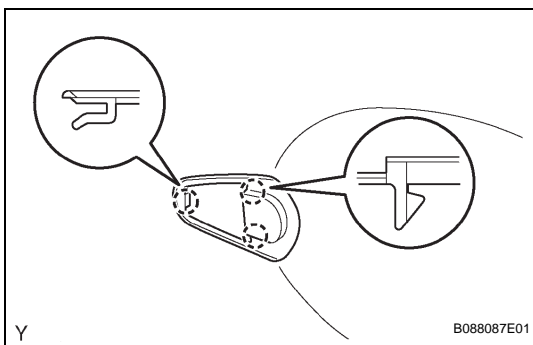

- (b) Engage the 3 claws and install the outside handle front pad.

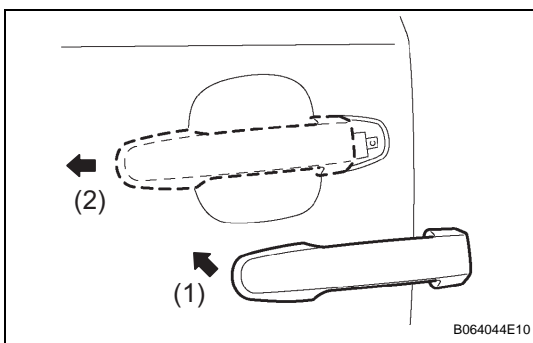

- (c) Pushing the outside handle in the direction of the arrow marks shown in the illustration, install the outside handle.  
**NOTICE:**  
**If the release plate is not pulled and held when installing the outside handle, the release plate will interfere with the outside handle. This will damage the release plate.**

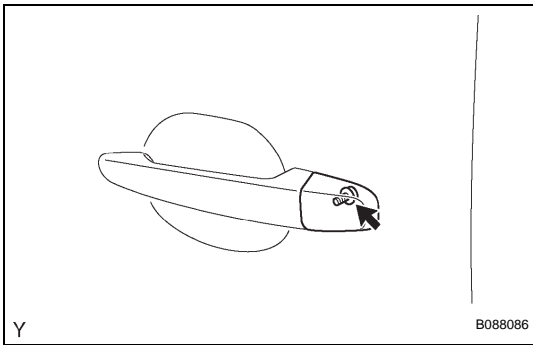

### 5. INSTALL REAR DOOR OUTSIDE HANDLE COVER LH

- (a) Using a torx socket wrench T30 , install the rear door outside handle cover with the screw.  
**Torque: 7.0 N\*m (71 kgf\*cm, 62 in.\*lbf)**

### 6. INSTALL REAR DOOR LOCK ASSEMBLY LH

- (a) Apply MP grease to the sliding and rotating areas of the rear door lock assembly.

- (b) Install a new door lock wire harness packing.

**NOTICE:**

- When reinstalling the door lock, always use a new packing.
- Do not allow grease or dirt to contaminate the gap between the door panel and packing.
- Old packing and damaged packing cannot effectively protect against water, which could damage the door lock.

- (c) Pull and hold the release plate of the outside handle frame, as shown in the illustration.

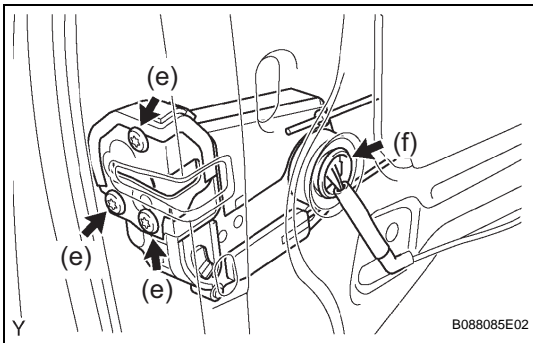
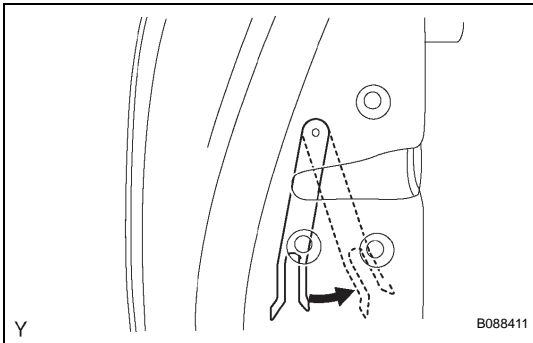

- (d) Apply adhesive to the threads of the 3 screws.

**Adhesive:**

**Part No. 08833-00070, THREE BOND 1324 or equivalent**

- (e) Using a torx socket wrench T30 , install the rear door lock with the 3 screws.

**Torque: 12 N\*m (122 kgf\*cm, 9 ft.\*lbf)**

- (f) Connect the connector.

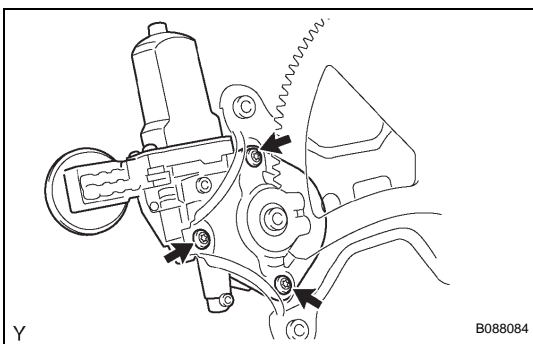

### 7. INSTALL POWER WINDOW REGULATOR MOTOR ASSEMBLY

- (a) Using a torx socket wrench T25 , install the power window regulator motor assembly LH with the 3 screws.

**Torque: 5.4 N\*m (55 kgf\*cm, 48 in.\*lbf)**

### 8. INSTALL REAR DOOR WINDOW REGULATOR SUB-ASSEMBLY LH

- (a) Apply MP grease to the sliding and rotating areas of the rear door window regulator sub-assembly LH.

**NOTICE:**

**Do not apply grease to the window regulator spring.**

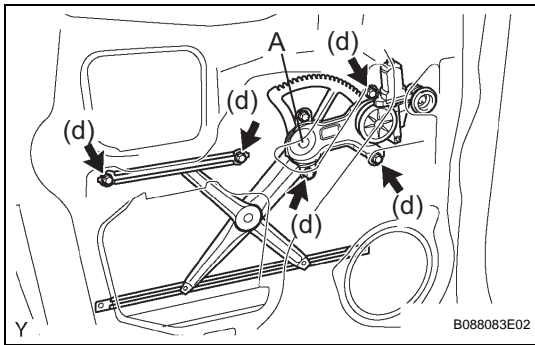

- (b) Loosely screw bolt A onto the rear door window regulator sub-assembly LH.
- (c) Insert the rear door window regulator into the door panel. Use bolt A to hang the rear door window regulator on the door panel.

**NOTICE:**

**Be careful not to drop the window regulator as it may be damaged.**

- (d) Install the rear door window regulator with the 5 bolts, and tighten bolt A.

**Torque: 11 N\*m (112 kgf\*cm, 8 ft.\*lbf)**

#### 9. INSTALL REAR DOOR FRONT WINDOW GUIDE SUB-ASSEMBLY LH

- (a) Install the rear door front window guide sub-assembly LH with the bolt.

**Torque: 8.0 N\*m (82 kgf\*cm, 70 in.\*lbf)**

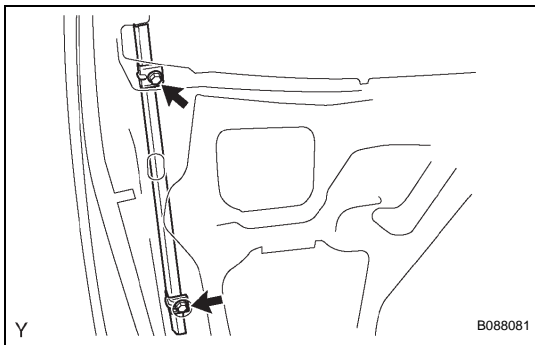
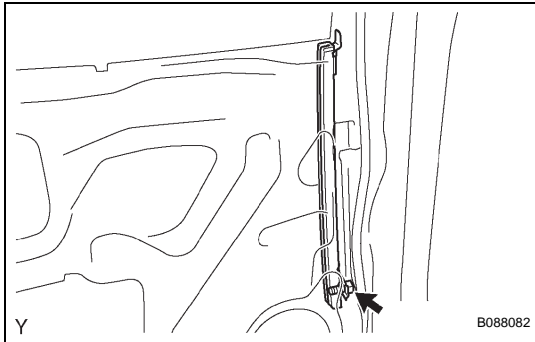

#### 10. INSTALL REAR DOOR REAR LOWER WINDOW FRAME SUB-ASSEMBLY LH

- (a) Install the rear door rear lower window frame sub-assembly LH with the 2 bolts.

**Torque: 8.0 N\*m (82 kgf\*cm, 70 in.\*lbf)**

- (b) Install the hole plug.

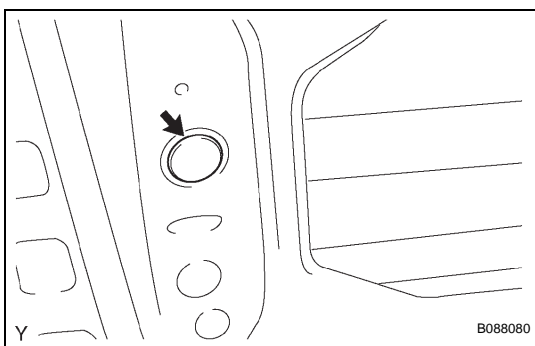

#### 11. INSTALL REAR DOOR GLASS RUN LH

- (a) Install the rear door glass run LH.

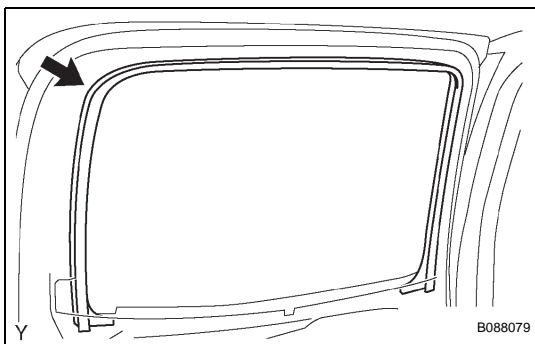

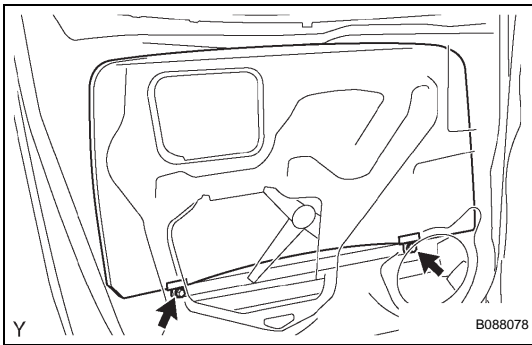

- 12. INSTALL REAR DOOR GLASS SUB-ASSEMBLY LH**  
 (a) Install the rear door glass sub-assembly LH onto the rear door window regulator sub-assembly LH with the 2 bolts.  
**Torque: 8.0 N\*m (82 kgf\*cm, 71 in.\*lbf)**

- 13. INSTALL REAR DOOR BELT MOULDING LH (See page ET-35)**

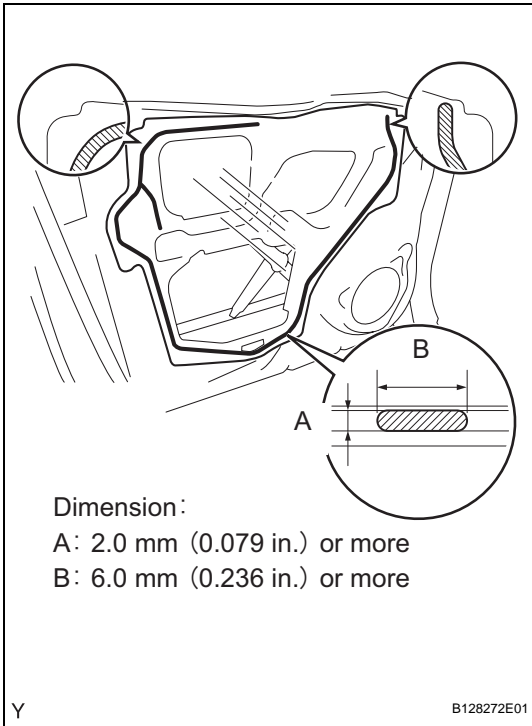

- 14. INSTALL REAR DOOR SERVICE HOLE COVER LH**  
 (a) Apply butyl tape to the door panel, then install the rear door service hole cover LH as shown in the illustration.

**HINT:**

- When installing the service hole cover, pull the links and connectors out through the service hole cover.
- There should be no wrinkles or folds after attaching the service hole cover.
- After attaching the service hole cover, check the quality of the seal.

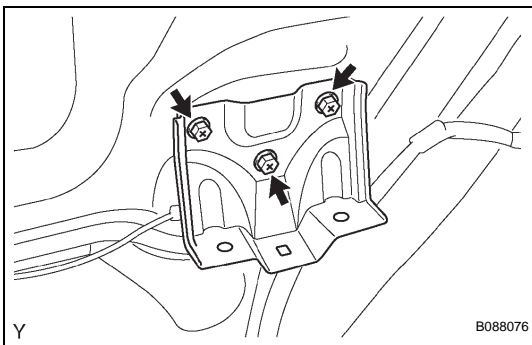

- 15. INSTALL NO. 2 REAR DOOR TRIM BRACKET**  
 (a) Install the No. 2 rear door trim bracket with the 3 screws.

- 16. INSTALL REAR SPEAKER ASSEMBLY**

**HINT:**

- Access cab (See page AV-88)
- Double cab (See page AV-86)

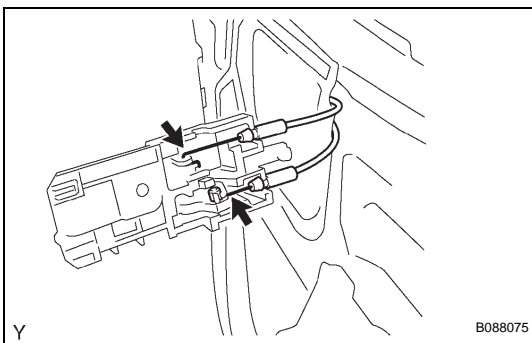

- 17. INSTALL REAR DOOR INSIDE HANDLE SUB-ASSEMBLY LH**  
 (a) Connect the 2 cables to the rear door inside handle sub-assembly LH.

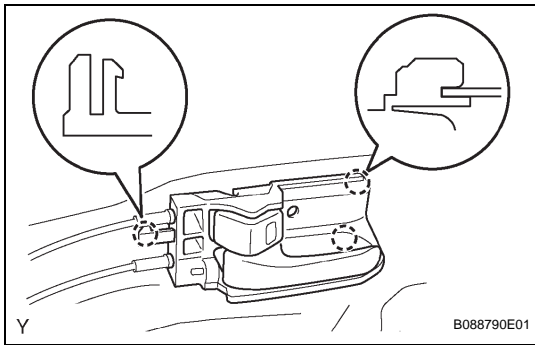

- (b) Engage the 3 claws and install the rear door inside handle sub-assembly LH onto the door panel.

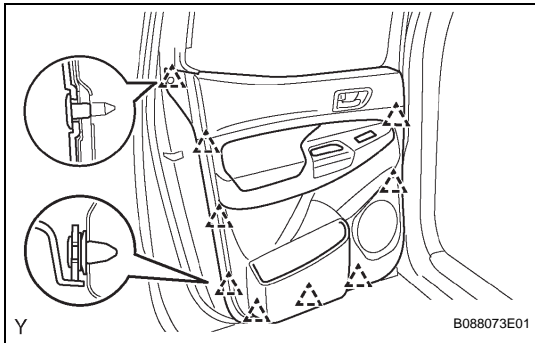

### 18. INSTALL REAR DOOR TRIM PANEL ASSEMBLY LH

- (a) Engage the 9 clips and install the rear door trim panel assembly LH.  
 (b) Install the door assist grip assembly LH with the screw.

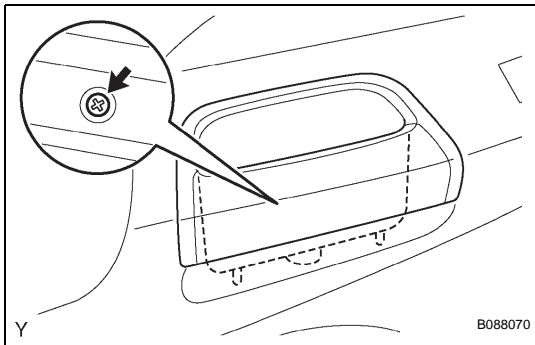

### 19. INSTALL REAR POWER WINDOW REGULATOR SWITCH ASSEMBLY

- (a) Connect the connector.

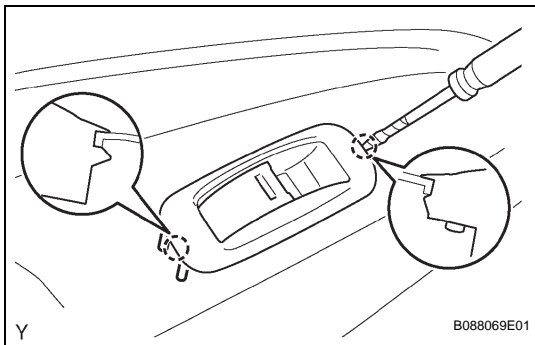

- (b) Engage the 2 claws and install the rear power window regulator switch assembly.

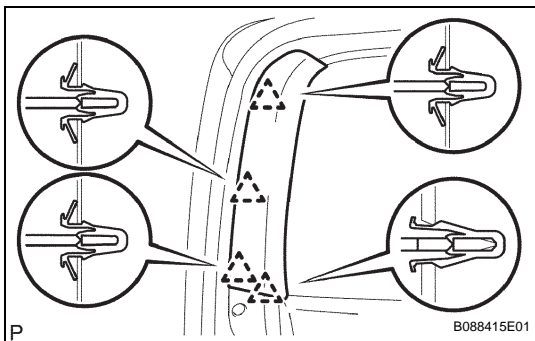

### 20. INSTALL REAR DOOR FRAME GARNISH LH

- (a) Engage the 4 clips and install the rear door frame garnish LH.

**NOTICE:**

Confirm that no clips remain on the door panel before the garnish is installed. Transfer any remaining clips to the garnish side before installing it. Installing the garnish with any clips remaining on the door panel side could cause the clips to drop inside the door panel.

**21. CONNECT CABLE TO NEGATIVE BATTERY  
TERMINAL**

**Torque: 3.9 N\*m (40 kgf\*cm, 35 in.\*lbf)**