

HOOD COMPONENTS

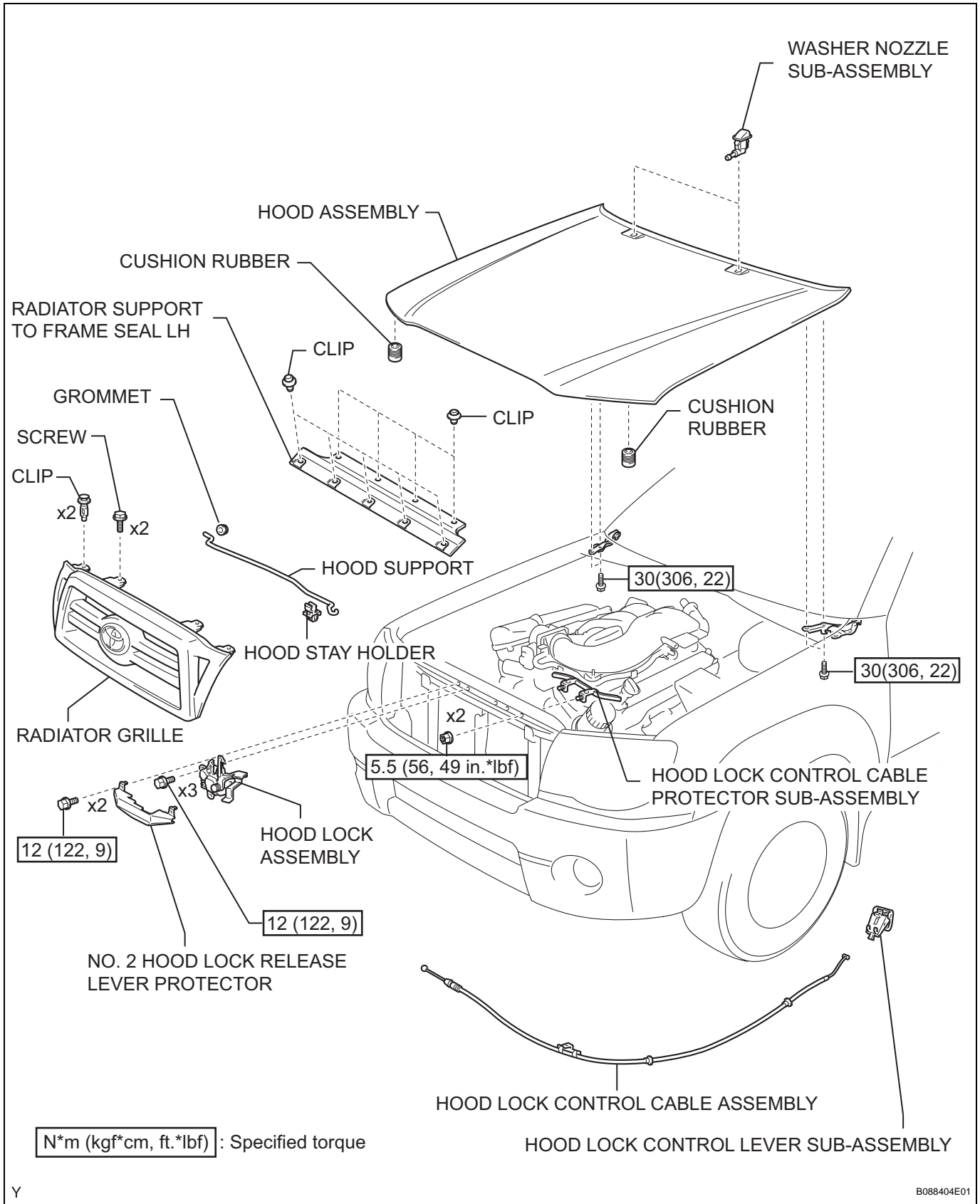

ED

DISASSEMBLY

HINT:

For bolts without torque specifications, check the standard bolt chart (See page [SS-2](#)).

1. REMOVE RADIATOR GRILLE (See page [ET-4](#))
2. REMOVE NO. 2 HOOD LOCK RELEASE LEVER PROTECTOR (See page [ED-5](#))
3. REMOVE HOOD LOCK ASSEMBLY
 - (a) Remove the 3 bolts.

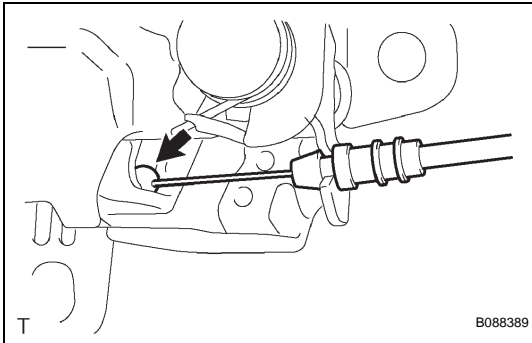
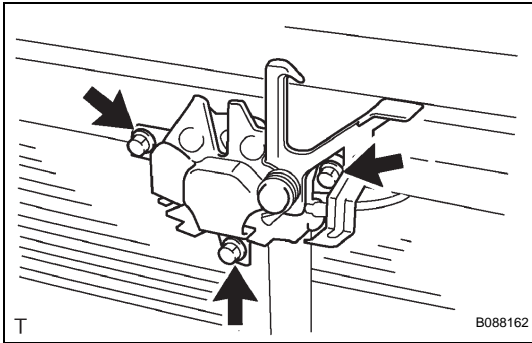

- (b) Disconnect the hood lock control cable assembly, then remove the hood lock assembly.



4. REMOVE HOOD SUPPORT
 - (a) Remove the hood support.
 - (b) Remove the grommet.

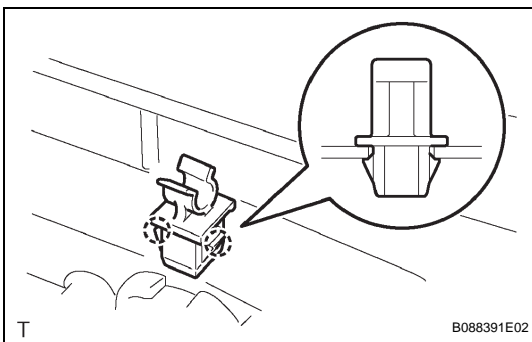

- (c) Using a clip remover, disengage the 2 claws and remove the hood stay holder.

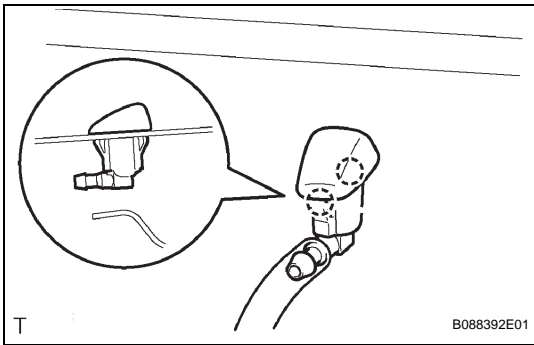
**5. REMOVE WASHER NOZZLE SUB-ASSEMBLY**

- (a) Disengage the 2 claws and remove the washer nozzle sub-assembly.
- (b) Disconnect the washer hose.

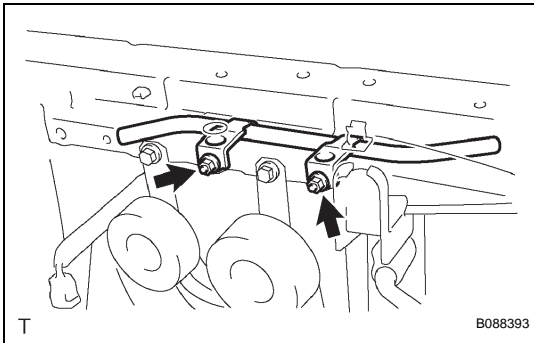
**6. REMOVE HOOD LOCK CONTROL CABLE PROTECTOR SUB-ASSEMBLY**

- (a) Remove the 2 nuts, then remove the hood lock control cable protector sub-assembly.

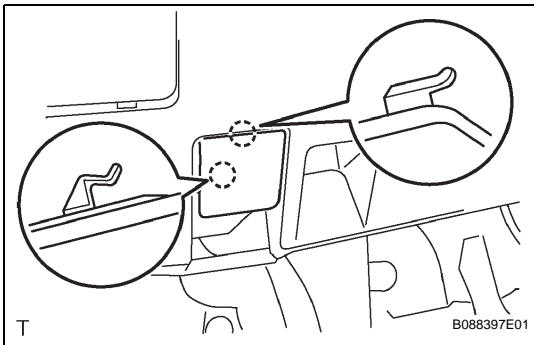
**7. REMOVE HOOD LOCK CONTROL LEVER SUB-ASSEMBLY**

- (a) Disengage the 2 claws.

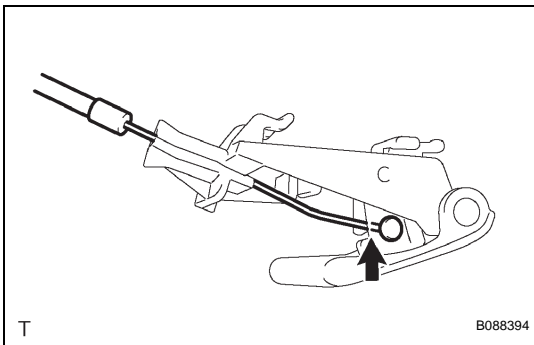

- (b) Disconnect the hood lock control cable assembly and remove the hood lock control lever sub-assembly.

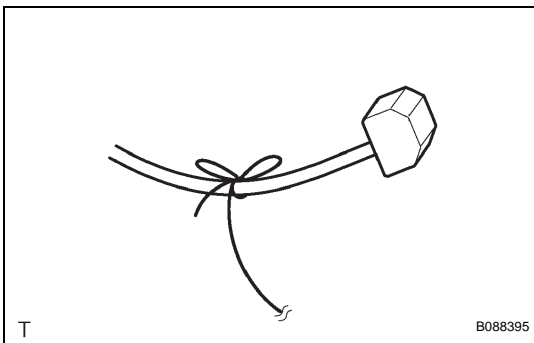
**8. REMOVE HOOD LOCK CONTROL CABLE ASSEMBLY**

- (a) Tie a piece of string to the tip of the hood lock control cable assembly.

HINT:

Use a piece of string which is longer than the hood lock control cable assembly.

- (b) Remove the hood lock control cable assembly referring to the illustration.

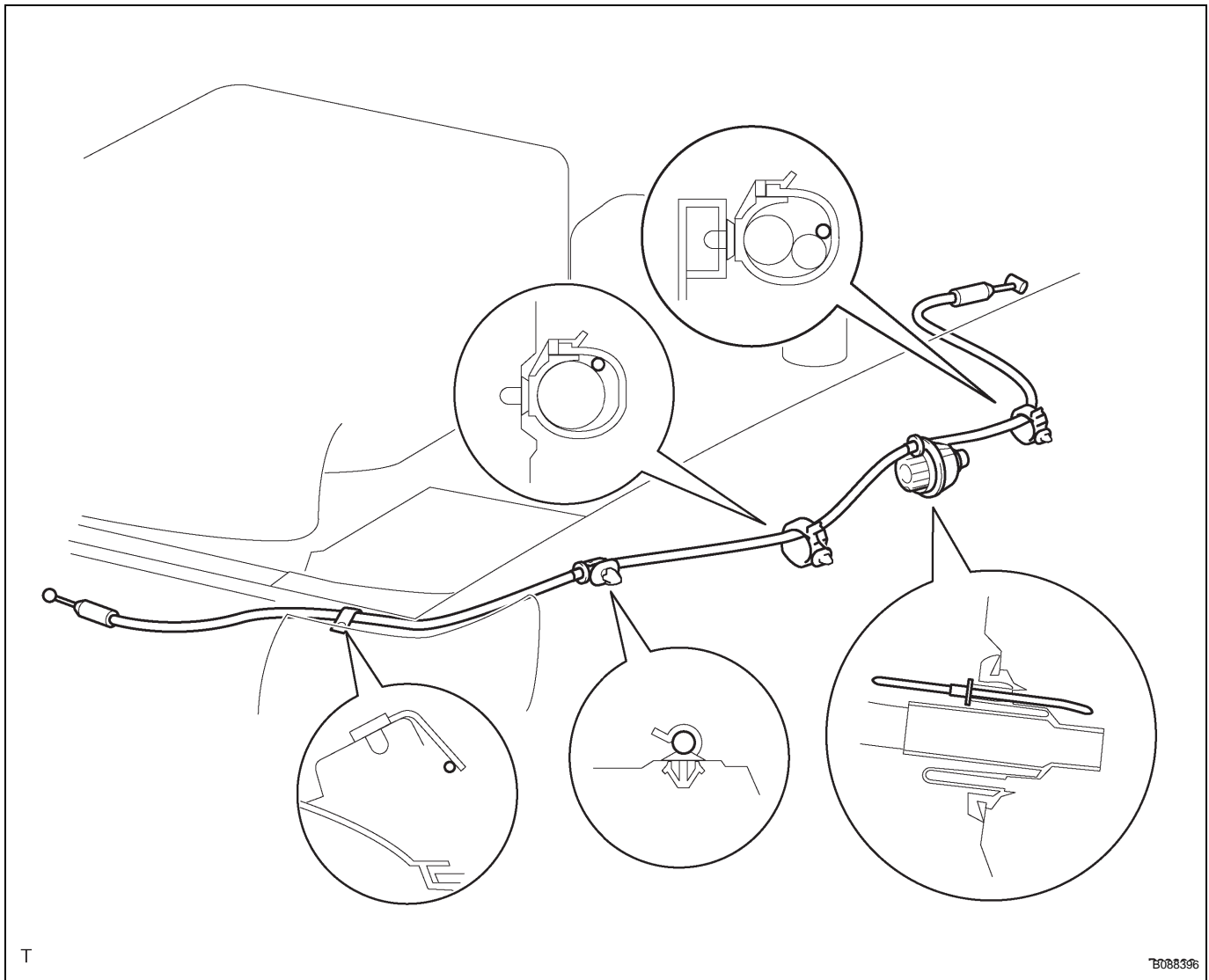
**NOTICE:**

Leave the string inside the wire harness grommet for the installation of the hood lock control cable assembly.

ADJUSTMENT**HINT:**

- Centering bolts are used to mount the hood hinge and hood lock. The hood and hood lock cannot be adjusted with the centering bolts on. Substitute the standard bolts (with washers) for the centering bolts when making adjustments.
- For bolts without torque specifications, check the standard bolt chart (See page [SS-2](#)).

