

- (g) Horizontally and vertically adjust the door by loosening the door side hinge bolts.
- (h) Tighten the door side hinge bolts after the adjustment.
Torque: 26 N*m (265 kgf*cm, 19 ft.*lbf)

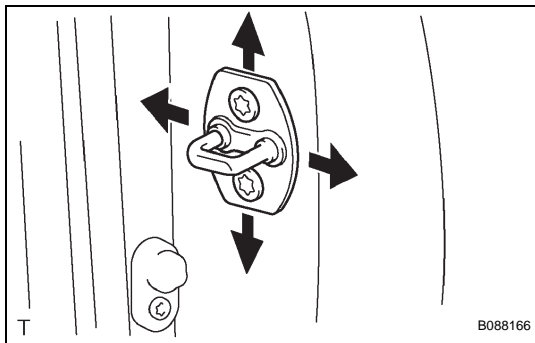

- (i) Adjust the striker position by slightly loosening the striker mounting screws with a torx socket wrench T40 and hitting the striker with a plastic hammer.
- (j) Using a torx socket wrench T40, tighten the striker mounting screws after the adjustment.
Torque: 23 N*m (235 kgf*cm, 17 ft.*lbf)

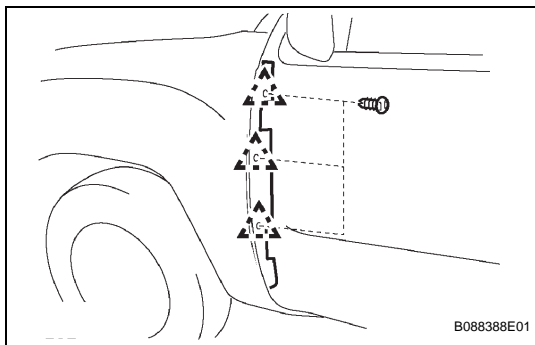

- (k) Install the front fender side panel protector LH with the 3 clips.
- (l) Connect the cable to the negative battery terminal.
Torque: 3.9 N*m (40 kgf*cm, 35 in.*lbf)
- (m) Inspect the SRS warning lamp (See page [RS-28](#)).

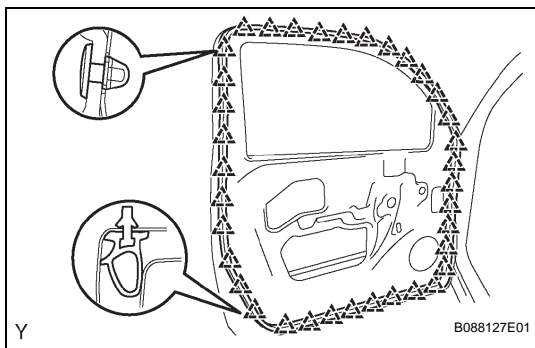

REASSEMBLY

1. INSTALL FRONT DOOR WEATHERSTRIP LH (for Regular Cab)

- (a) Engage the 36 clips and install a new front door weatherstrip LH.
- (b) Remove the tab tape at both ends of 2-sided tape attached to the weather strip, and attach the weather strip to the door panel with the 2-sided tape.

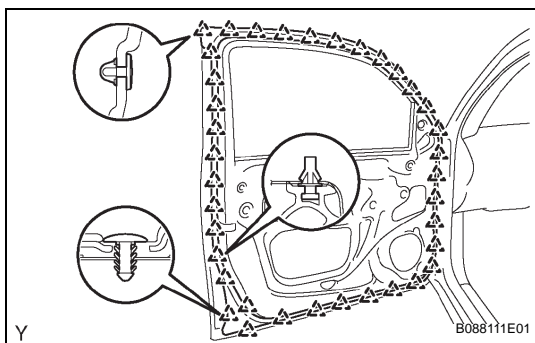

2. INSTALL FRONT DOOR WEATHERSTRIP LH (for Access Cab)

- (a) Engage the 36 clips and install a new front door weatherstrip LH.
- (b) Remove the tab tape at both ends of 2-sided tape attached to the weather strip, and attach the weather strip to the door panel with the 2-sided tape.

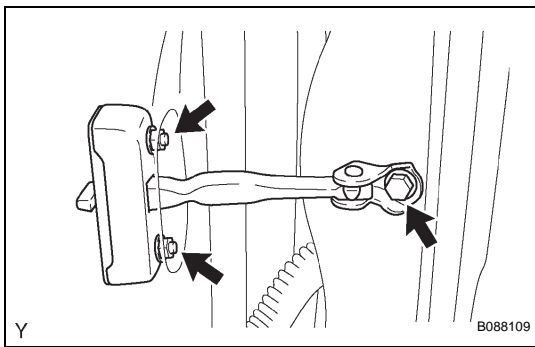

3. INSTALL FRONT DOOR CHECK ASSEMBLY LH

- (a) Apply MP grease to the sliding areas of the check.
- (b) Install the front door check assembly LH onto the door panel with the 2 nuts.

Torque: 5.5 N*m (56 kgf*cm, 49 in.*lbf)

- (c) Apply adhesive to the threads of the bolt.

Adhesive:

Part No. 08833-00070, THREE BOND 1324 or equivalent

- (d) Install the front door check assembly LH onto the body panel with the bolt.

Torque: 30 N*m (306 kgf*cm, 22 ft.*lbf)

4. INSTALL FRONT DOOR OUTSIDE HANDLE FRAME SUB-ASSEMBLY LH

- (a) Using a torx socket wrench T30, install the outside handle frame sub-assembly with the screw.

Torque: 7.0 N*m (71 kgf*cm, 62 in.*lbf)

NOTICE:

A cover should be inserted between the nut and the door panel.

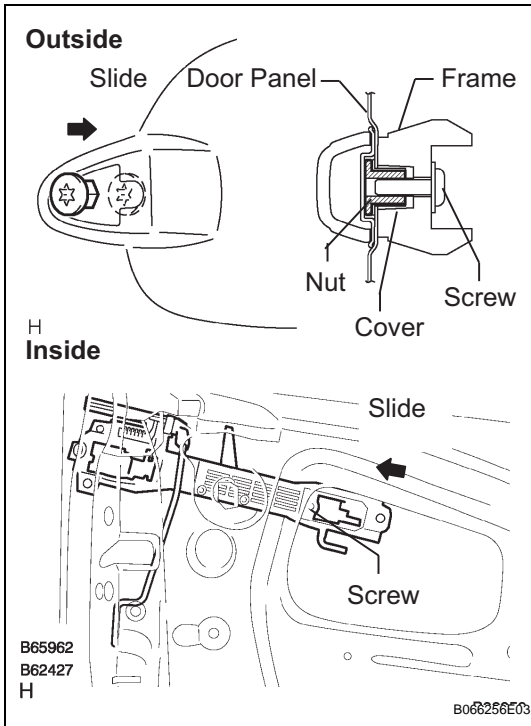

5. INSTALL FRONT DOOR OUTSIDE HANDLE ASSEMBLY LH

- (a) Engage the 3 claws and install the front door outside handle front pad.

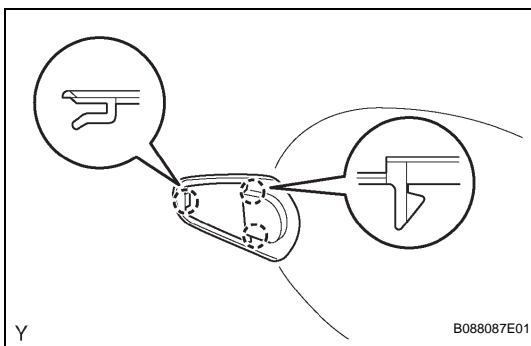

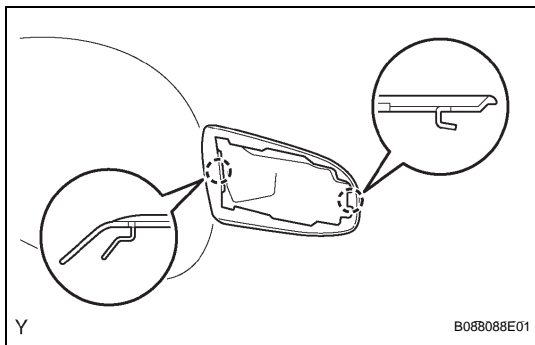

- (b) Engage the 2 claws and install the front door outside handle rear pad.

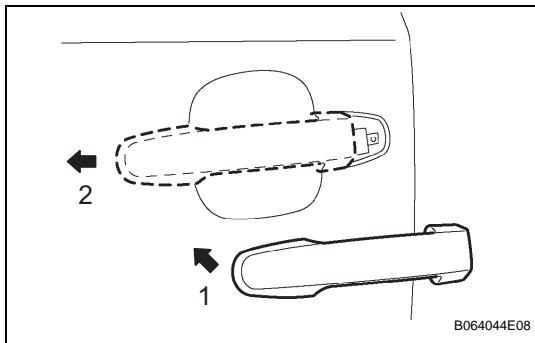

- (c) Pushing the front door outside handle assembly LH in the direction of the arrow marks shown in the illustration, install the front door outside handle assembly LH.

6. INSTALL FRONT DOOR LOCK ASSEMBLY LH

- (a) Apply MP grease to the sliding and rotating parts of the front door lock assembly LH.

NOTICE:

- If reusing a door lock assembly that has been removed, replace the packing in the connecting part with new.
- Make sure that no grease and dirt adheres to the packing surface in the connecting part.

- (b) Insert the door lock open rod into the front door lock assembly, then set it to the door panel.

NOTICE:

Make sure that the outside handle link is securely engaged with the door lock assembly.

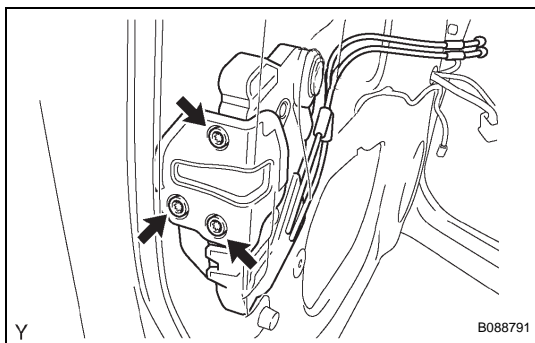
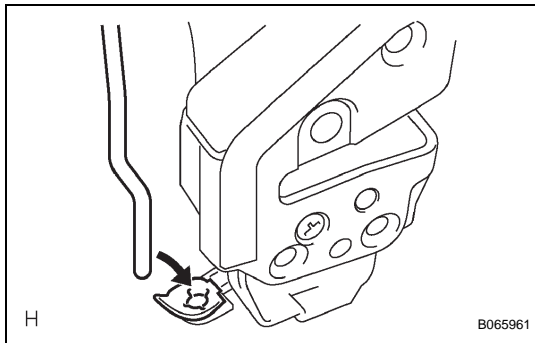

- (c) Apply adhesive to the threads of the screws.

Adhesive:

Part No. 08833-00070, THREE BOND 1324 or equivalent

- (d) Using a torx socket wrench T30, install the front door lock assembly LH with the 3 screws.

Torque: 12 N*m (122 kgf*cm, 9 ft.*lbf)

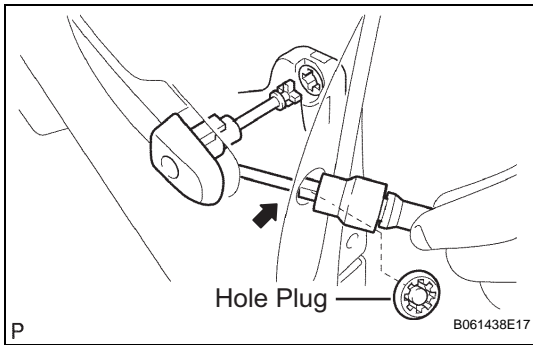

7. INSTALL FRONT DOOR OUTSIDE HANDLE COVER LH

- (a) Using a torx socket wrench T30 , install the front door outside handle cover LH with the screw.
Torque: 7.0 N*m (71 kgf*cm, 62 in.*lbf)
- (b) Install the hole plug.

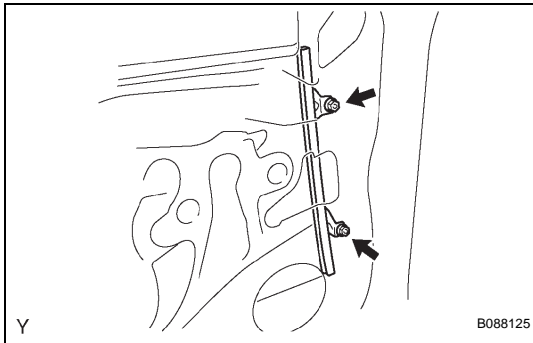

8. INSTALL FRONT DOOR FRONT LOWER FRAME SUB-ASSEMBLY LH

- (a) Install the front door front lower frame sub-assembly LH with the 2 nuts.
Torque: 5.5 N*m (56 kgf*cm, 49 in.*lbf)

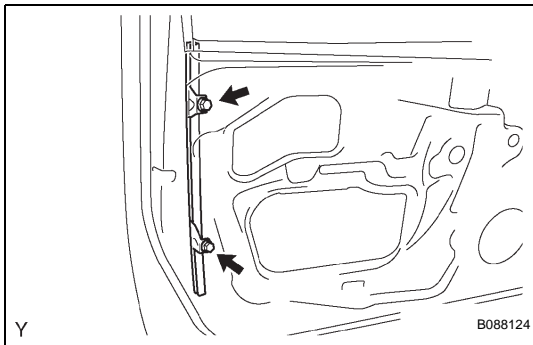

9. INSTALL FRONT DOOR REAR LOWER FRAME SUB-ASSEMBLY LH

- (a) Install the front door rear lower frame sub-assembly LH with the 2 bolts.
Torque: 8.0 N*m (82 kgf*cm, 70 in.*lbf)

10. INSTALL FRONT DOOR WINDOW REGULATOR SUB-ASSEMBLY LH

- (a) Apply MP grease to the sliding and rotating areas of the front door window regulator sub-assembly LH.

NOTICE:

Do not apply grease to the window regulator spring.

- (b) Loosely screw bolt A onto the front door window regulator sub-assembly LH.
- (c) Insert the front door window regulator into the door panel. Use bolt A to hang the front door window regulator on the door panel.

NOTICE:

Be careful not to drop the window regulator as it may be damaged.

- (d) Install the front door window regulator with the 4 bolts, and tighten bolt A.

Torque: 11 N*m (112 kgf*cm, 8 ft.*lbf)

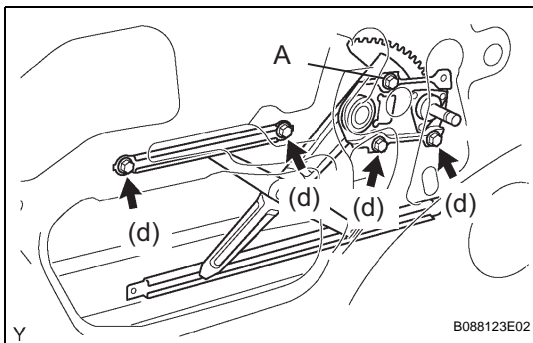

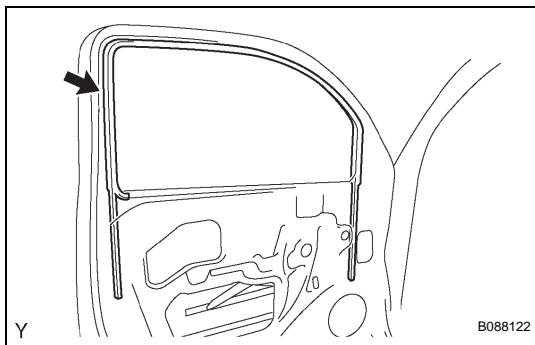

11. INSTALL FRONT DOOR GLASS RUN LH

- (a) Install the front door glass run LH.

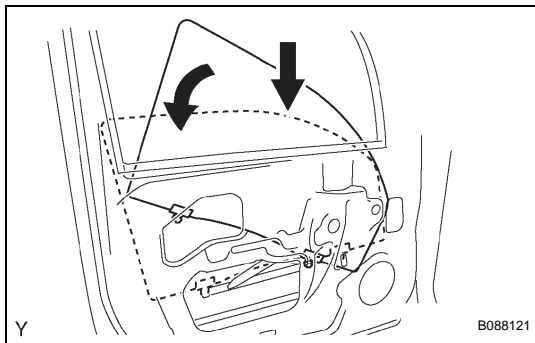

12. INSTALL FRONT DOOR GLASS SUB-ASSEMBLY LH

- (a) Insert the front door glass sub-assembly LH into the door panel along the glass run as indicated by the arrow marks in the illustration.

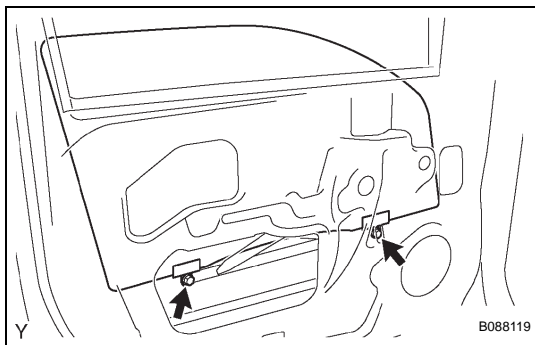

- (b) Install the front door glass sub-assembly LH onto the front door window regulator sub-assembly LH with the 2 bolts.

Torque: 8.0 N*m (82 kgf*cm, 71 in.*lbf)

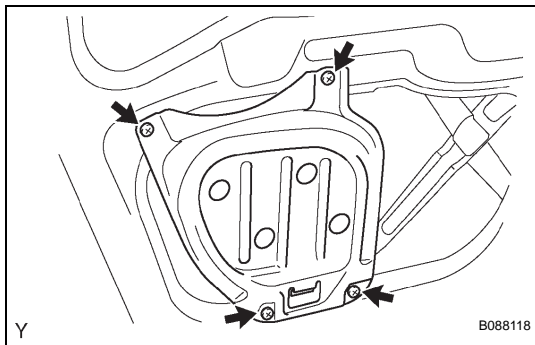

13. INSTALL FRONT DOOR INSIDE PANEL PLATE LH

- (a) Install the front door inside panel plate LH.

14. INSTALL FRONT DOOR BELT MOULDING LH (See page [ET-33](#))

15. INSTALL OUTER REAR VIEW MIRROR ASSEMBLY LH (See page [MI-10](#))

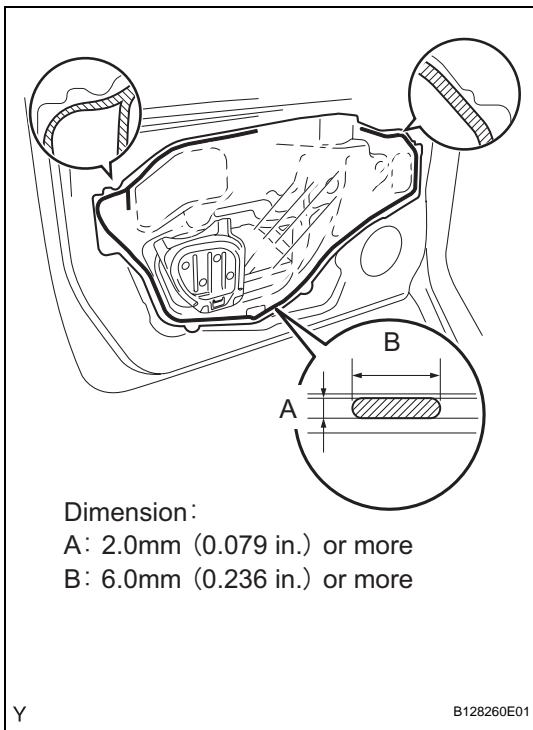
**16. INSTALL FRONT DOOR SERVICE HOLE COVER LH**

- (a) Apply butyl tape to the door panel, and install the front door service hole cover LH as shown in the illustration.

Adhesive:

Part No. 08850-00065, Butyl Tape Set or equivalent

HINT:

- When installing the service hole cover, pull the links and connectors out through the service hole cover.
- There should be no wrinkles or folds after attaching the service hole cover.
- After attaching the service hole cover, check the quality of the seal.

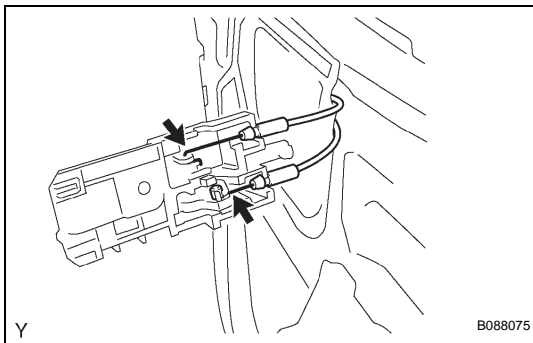
**17. INSTALL FRONT DOOR INSIDE HANDLE SUB-ASSEMBLY LH**

- (a) Connect the 2 cables to the front door inside handle sub-assembly LH.

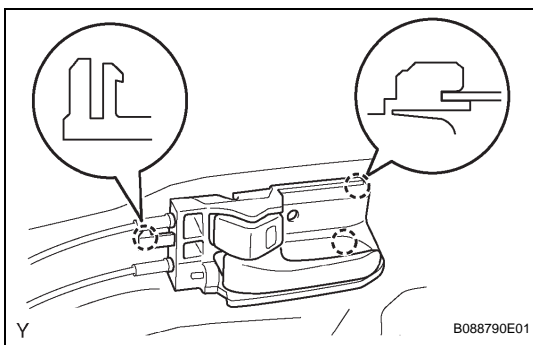

- (b) Engage the 3 claws and install the front door inside handle sub-assembly LH onto the door panel.

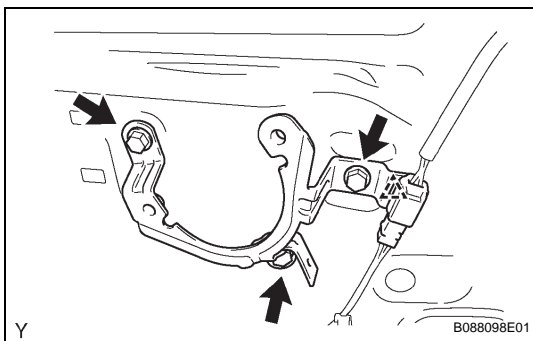
**18. INSTALL FRONT NO. 1 SPEAKER BRACKET**

- (a) Install the front No. 1 speaker bracket with the 3 screws.
(b) Connect the wire harness clamp and connector.

19. INSTALL FRONT NO. 2 SPEAKER ASSEMBLY (See page AV-83)**20. INSTALL FRONT NO. 1 SPEAKER ASSEMBLY****HINT:**

- Regular cab (See page AV-76)
- Except regular cab (See page AV-79)

21. CONNECT CABLE TO NEGATIVE BATTERY TERMINAL

Torque: 3.9 N*m (40 kgf*cm, 35 in.*lbf)

22. INSTALL FRONT DOOR TRIM PANEL ASSEMBLY LH

(a) Engage the 10 clips and install the front door trim panel assembly LH.

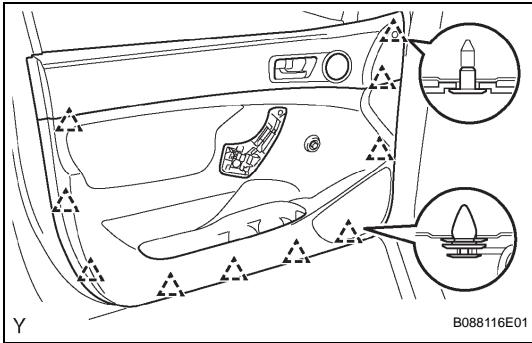

(b) Install the 3 screws.

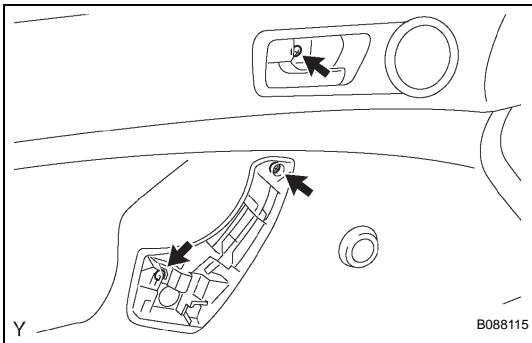

(c) Engage the 8 claws and install the door assist grip cover LH.

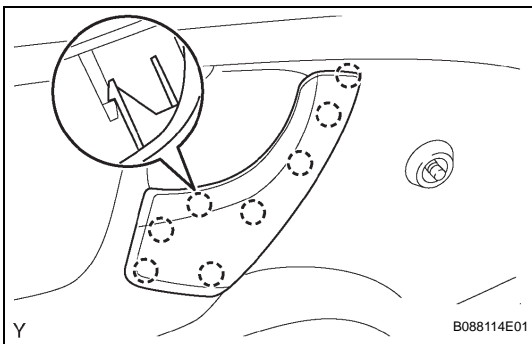

(d) Close the cover.

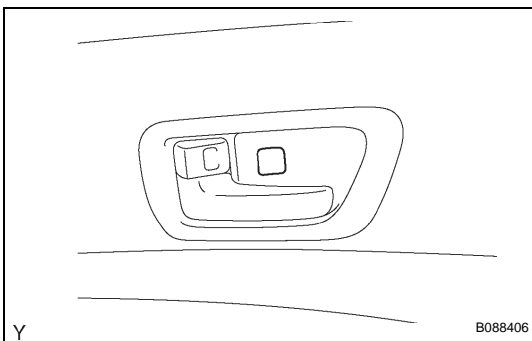

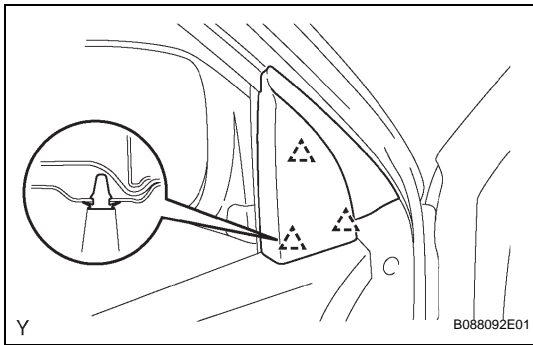

23. INSTALL FRONT DOOR LOWER FRAME BRACKET GARNISH LH

- (a) Engage the 3 clips and install the front door lower frame bracket garnish LH.

NOTICE:

Confirm that no clips remain on the door panel before the garnish is installed. Transfer any remaining clips to the garnish side before installing it. Installing the garnish with any clips remaining on the door panel side could cause the clips to drop inside the door panel.

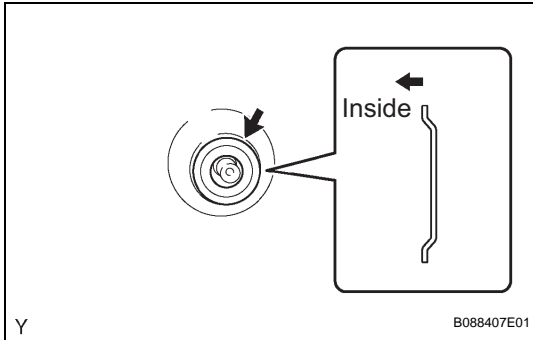

24. INSTALL FRONT DOOR WINDOW REGULATOR HANDLE ASSEMBLY

- (a) Install the window regulator handle plate.

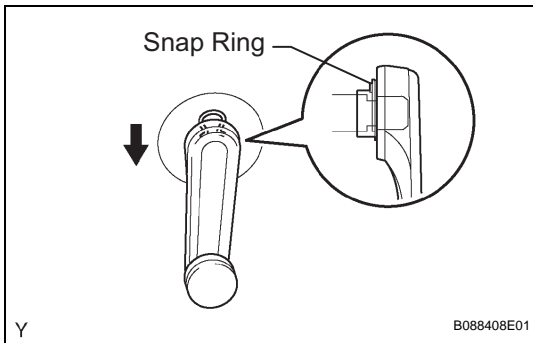

- (b) Install the front door window regulator handle assembly with the snap ring.