

REMOVAL

CAUTION:

Some of these service operations affect the SRS airbag system. Read the precautionary notices concerning the SRS airbag system before servicing (See page RS-1).

1. DISCONNECT CABLE FROM NEGATIVE BATTERY TERMINAL

Wait for at least 90 seconds after disconnecting the cable to prevent the airbag from working.

2. REMOVE FRONT FLOOR FOOTREST (See page IR-1)

3. REMOVE FRONT DOOR SCUFF PLATE LH

(a) Disengage the 8 claws and clip, and remove the front door scuff plate.

4. REMOVE FRONT DOOR SCUFF PLATE RH

HINT:

Follow the same procedures as for the front door scuff plate LH.

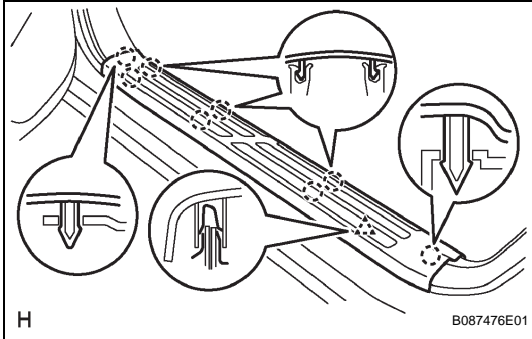

5. REMOVE COWL SIDE TRIM BOARD LH

(a) Remove the clip.

(b) Disengage the 2 clips and remove the cowl side trim board.

6. REMOVE COWL SIDE TRIM BOARD RH

HINT:

Follow the same procedures as for the cowl side trim board LH.

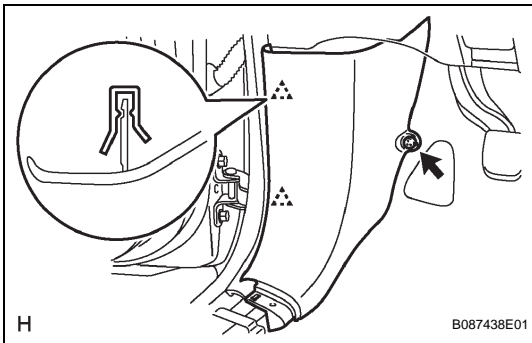

7. REMOVE FRONT DOOR OPENING TRIM WEATHERSTRIP LH

(a) Remove the front door opening trim weatherstrip.

8. REMOVE FRONT DOOR OPENING TRIM WEATHERSTRIP RH

HINT:

Follow the same procedures as for the front door opening trim weatherstrip LH.

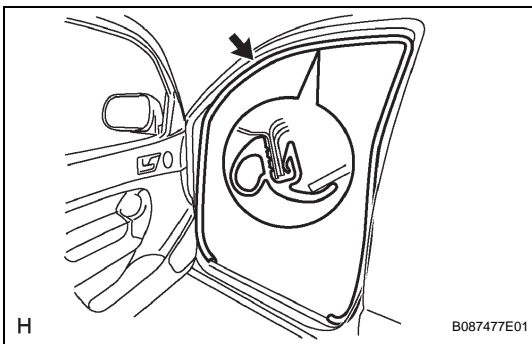

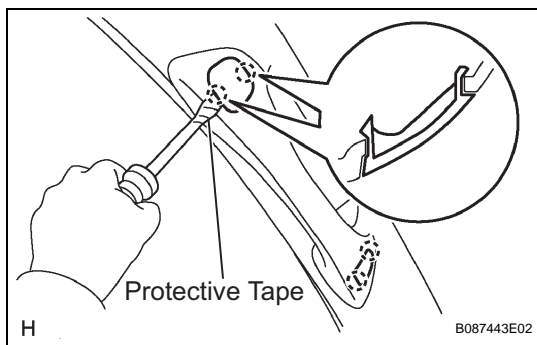

9. REMOVE FRONT PILLAR GARNISH LH

- (a) Using a screwdriver with its tip taped in protective tape, disengage the 2 claws and remove the assist grip plug.

HINT:

Follow the same procedures as for the opposite side.

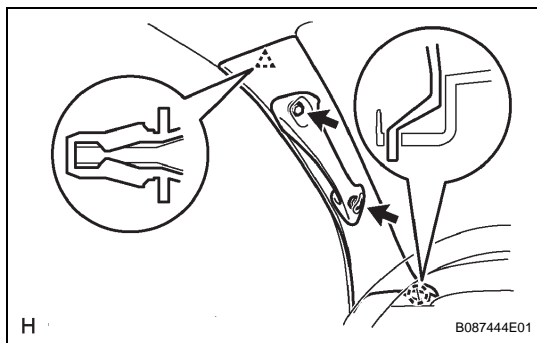

- (b) Remove the 2 screws.
- (c) Disengage the clip and claw and remove the front pillar garnish.

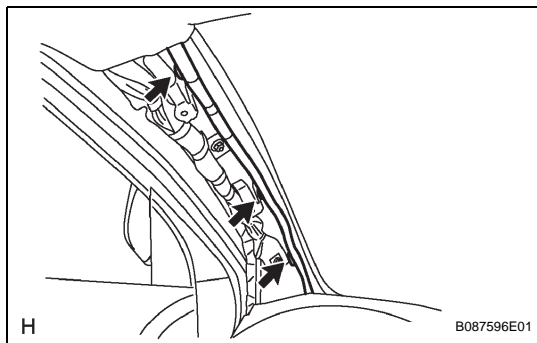

- (d) for LH Side:
 - (1) Using a clip remover, remove the 3 wire harness clamps.

IR

10. REMOVE FRONT PILLAR GARNISH RH

HINT:

Follow the same procedures as for the front pillar garnish LH.

11. REMOVE INSTRUMENT PANEL UNDER TRAY (for Pedal Type Parking Brake) (See page IP-9)

12. REMOVE INSTRUMENT PANEL HOLE COVER (for Lever Type Parking Brake) (See page IP-9)

13. REMOVE REAR CONSOLE UPPER PANEL SUB-ASSEMBLY

- (a) for Automatic Transmission on Separate Seat Type:
 - (1) Remove the rear console upper panel sub-assembly (See page IP-9).
- (b) for Manual Transmission on Separate Seat Type:
 - (1) Remove the rear console upper panel sub-assembly (See page IP-9).

14. REMOVE REAR CONSOLE BOX ASSEMBLY (for Separate Seat Type) (See page IP-10)

15. REMOVE INSTRUMENT PANEL CUP HOLDER TRAY (for Automatic Transmission on Separate Seat Type) (See page IP-10)

16. REMOVE FRONT CONSOLE BOX

- (a) for Automatic Transmission on Separate Seat Type:
 - (1) Remove the front console box (See page IP-10).

- (b) for Manual Transmission on Separate Seat Type:
 - (1) Remove the front console box (See page [IP-11](#)).
- (c) for Automatic Transmission on Bench Seat Type:
 - (1) Remove the front console box (See page [IP-11](#)).
- (d) for Manual Transmission on Bench Seat Type:
 - (1) Remove the front console box (See page [IP-11](#)).

17. REMOVE AIR CONDITIONING CONTROL ASSEMBLY (See page [IP-12](#))

18. REMOVE RADIO RECEIVER ASSEMBLY (See page [AV-69](#))

19. SEPARATE HOOD LOCK CONTROL LEVER SUB-ASSEMBLY (See page [ED-3](#))

20. REMOVE INSTRUMENT LOWER PANEL FINISH PANEL (See page [IP-12](#))

21. REMOVE INSTRUMENT CLUSTER FINISH PANEL SUB-ASSEMBLY (See page [IP-12](#))

22. REMOVE COMBINATION METER ASSEMBLY (See page [IP-13](#))

23. REMOVE INSTRUMENT CENTER CLUSTER FINISH PANEL SUB-ASSEMBLY (See page [IP-13](#))

24. REMOVE GLOVE COMPARTMENT DOOR ASSEMBLY (See page [IP-13](#))

25. REMOVE INSTRUMENT LOWER PANEL FINISH PANEL SUB-ASSEMBLY (See page [IP-14](#))

26. REMOVE INSTRUMENT LOWER PANEL (See page [IP-14](#))

27. REMOVE INSTRUMENT LOWER COVER SUB-ASSEMBLY (See page [IP-14](#))

28. REMOVE INSTRUMENT SIDE PANEL (See page [IP-14](#))

29. DISCONNECT PASSENGER AIRBAG CONNECTOR (See page [RS-576](#))

30. REMOVE INSTRUMENT PANEL SUB-ASSEMBLY (See page [IP-14](#))

31. REMOVE BACK PANEL TRIM COVER

- (a) for Separate Seat Type and Bench Seat Type:

HINT:
Follow the same procedures as for the opposite side (for Bench Seat Type).

 - (1) Disengage the 6 claws and remove the back panel trim cover.

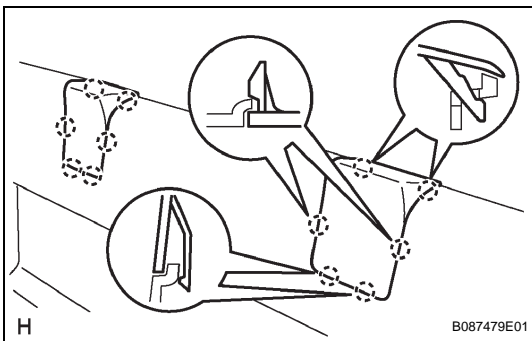

H

B087479E01

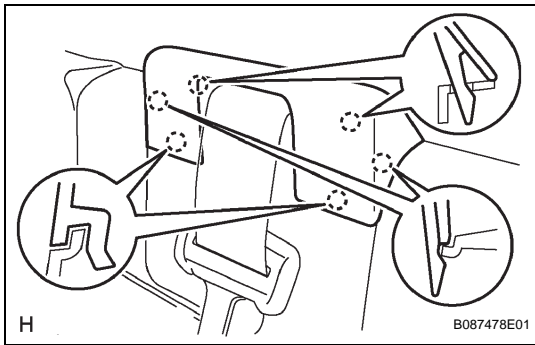

- (b) for Bench Seat Type:
 (1) Disengage the 6 claws and remove the back panel trim cover.

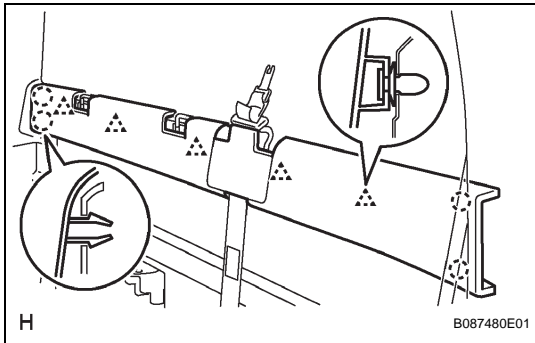

32. REMOVE BACK PANEL UPPER GARNISH

- (a) Disengage the 4 claws and 5 clips, and remove the back panel upper garnish.

33. REMOVE JACK ASSEMBLY (for Separate Seat Type)

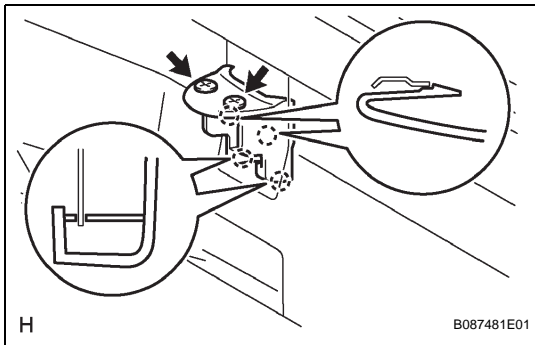

34. REMOVE BACK PANEL TRIM COVER (for Separate Seat Type)

- (a) Remove the 2 clips.
 (b) Disengage the 4 claws and remove the back panel trim cover.

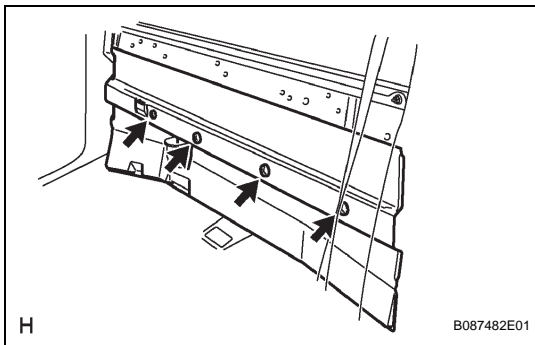

35. REMOVE BACK PANEL TRIM (for Separate Seat Type)

- (a) Remove the 4 clips and back panel trim.

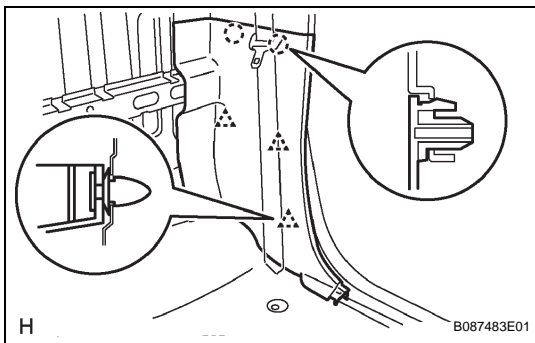

36. REMOVE QUARTER TRIM LOWER PANEL LH

- (a) Disengage the 2 claws and 3 clips, and remove the quarter trim lower panel.

37. REMOVE QUARTER TRIM LOWER PANEL RH

- HINT:
 Follow the same procedures as for the quarter trim lower panel LH.

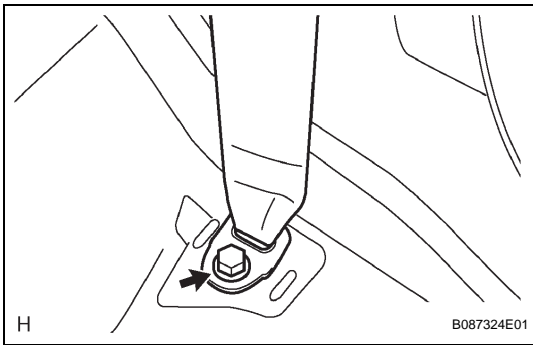

38. REMOVE QUARTER INSIDE TRIM BOARD LH

- (a) for LH Side and Separate Seat Type RH side:
 - (1) Remove the bolt and the floor anchor of the front seat outer belt.

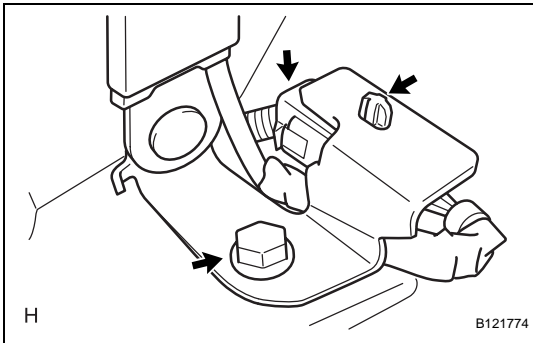

- (b) for Bench Seat Type RH Side:
 - (1) Remove the bolt and the floor anchor of the front seat outer belt.
 - (2) Disconnect the belt tension sensor connector.
 - (3) Remove the wiring harness clamp.

IR

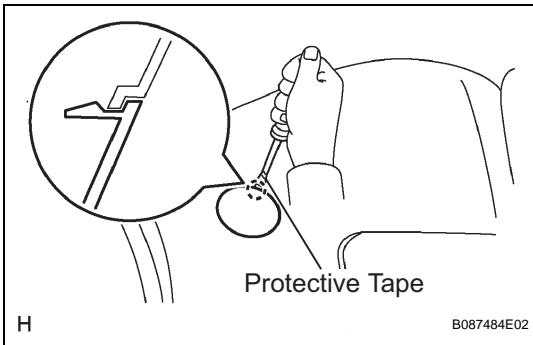

- (c) Using a screwdriver with its tip taped in protective tape, disengage the claw and open the cover.

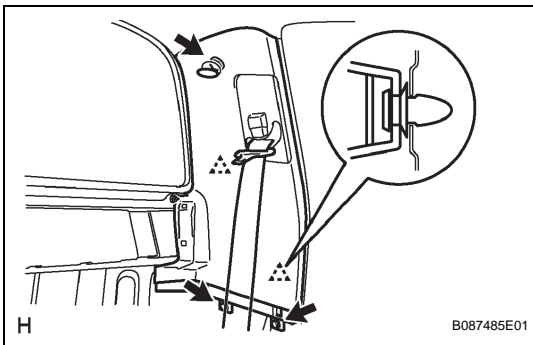

- (d) Remove the 3 screws.
- (e) Disengage the 2 clips and remove the quarter trim board.

39. REMOVE QUARTER INSIDE TRIM BOARD RH

HINT:
Follow the same procedures as for the quarter trim board LH.

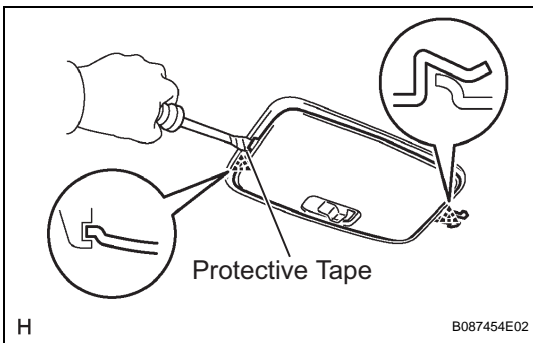

40. REMOVE ROOM LIGHT ASSEMBLY

- (a) Using a screwdriver with its tip taped in protective tape, disengage the 2 claws and remove the room light lens.

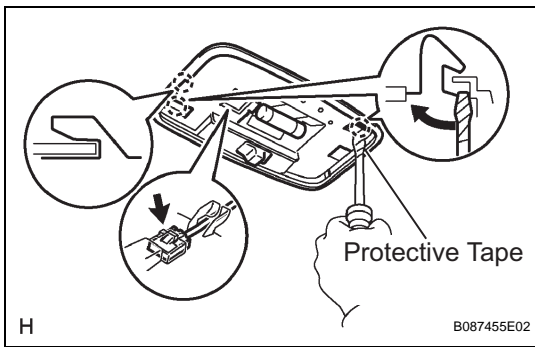

- (b) Using a screwdriver with its tip taped in protective tape, disengage the 3 claws.
- (c) Disconnect the room light connector and remove the room light.

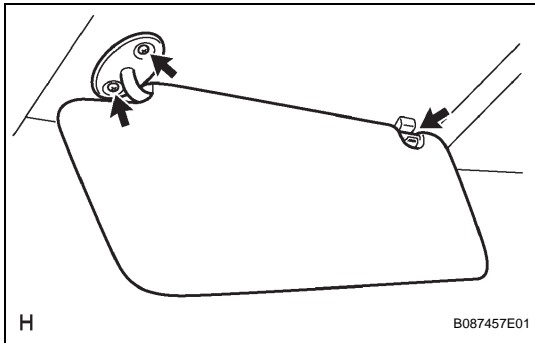

41. REMOVE VISOR ASSEMBLY LH

- (a) Remove the 2 screws.
- (b) Remove the visor from the visor holder.

42. REMOVE VISOR ASSEMBLY RH

- HINT:
Follow the same procedures as for the visor assembly LH.

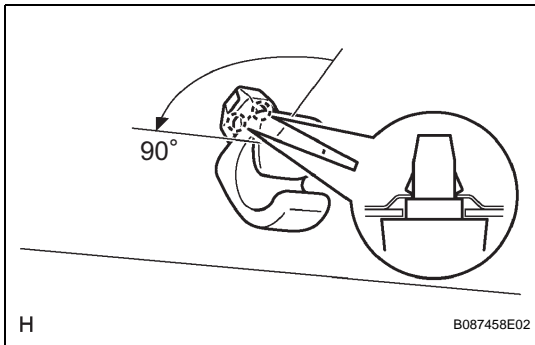

43. REMOVE VISOR HOLDER

- HINT:
Follow the same procedures as for the opposite side.
- (a) Turn the visor holder 90° counterclockwise and remove it.

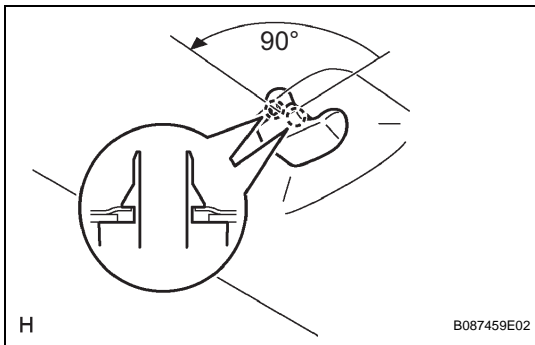

44. REMOVE COAT HOOK

- HINT:
Follow the same procedures as for the opposite side.
- (a) Turn the coat hook 90° counterclockwise and remove it.

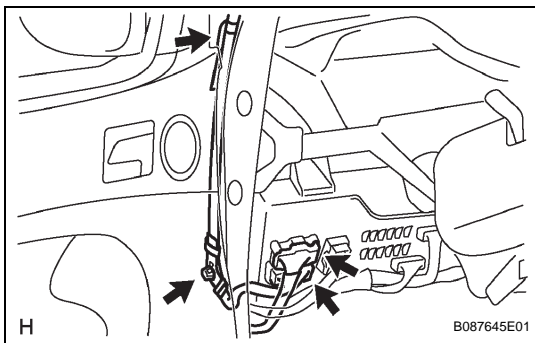

45. REMOVE ROOF HEADLINING ASSEMBLY

- (a) Disconnect the frame wire connector.
- (b) Disconnect the roof wire connector.
- (c) Using a clip remover, remove the 2 wire harness clamps.

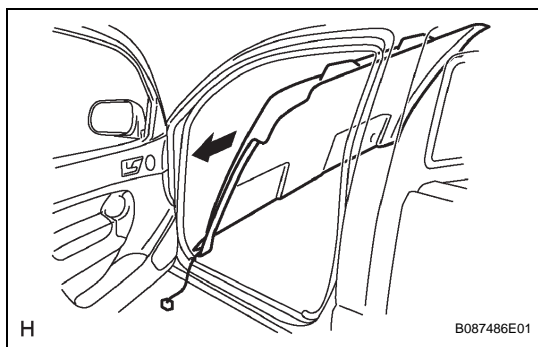

(d) Remove the roof headlining from the vehicle.

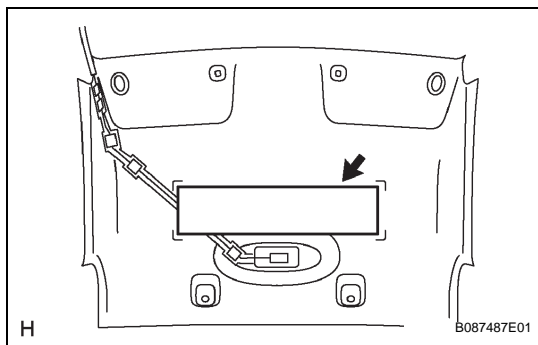

46. REMOVE ROOF HEADLINING PAD

(a) Remove the roof headlining pad from the roof headlining.

IR

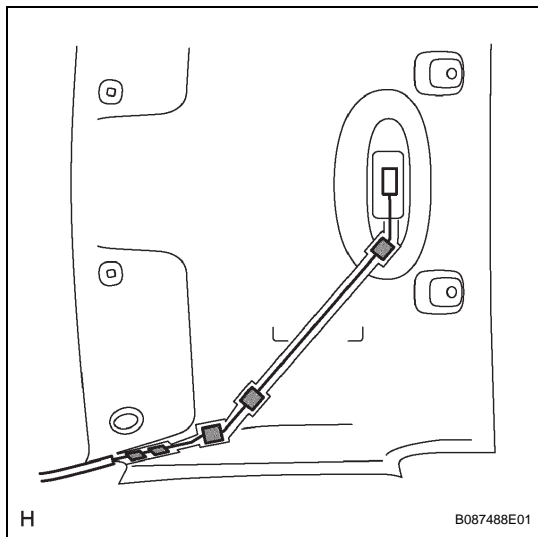

47. REMOVE ROOF WIRE

(a) Remove the 5 adhesive tapes and roof wire.