

# PLACE VERTU

## DESCRIPTION

Located in the Montreal borough of St-Laurent, Place Vertu is a premier shopping destination. Anchored by Sears, Canadian Tire, Adonis and Winners, this centre offers 135 stores and services to its 11.5 Million annual visitors.

**OPENING DATE:**  
1975

**EXPANSION / RENOVATION:**  
1984, 1987, 1990, 2007-2010

## MANAGEMENT

20 VIC MANAGEMENT INC.  
1 Queen Street East  
Suite 300, Box #88  
Toronto, Ontario  
M5C 2W5

Tel: (416) 955-0595  
Fax: (416) 955-0569

## CENTRE ADDRESS

3131 de la Côte-Vertu Blvd.  
Saint-Laurent,  
Montreal, QC H4R 1Y8  
Tel: (514) 331-5213  
Fax: (514) 331-1014  
[www.placevertu.com](http://www.placevertu.com)

Place Vertu is located at the northeast corner of Côte-Vertu and Cavendish intersection (Exit 62 of Highway 40 West or East)

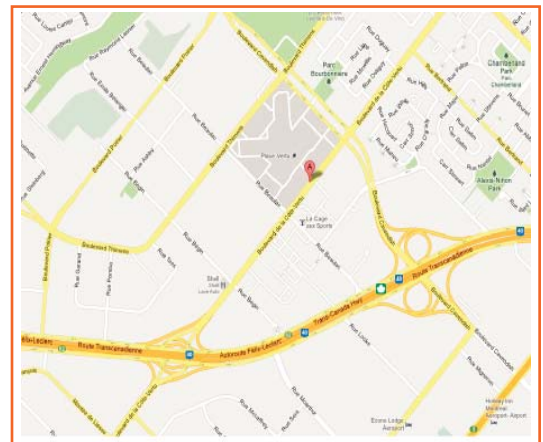
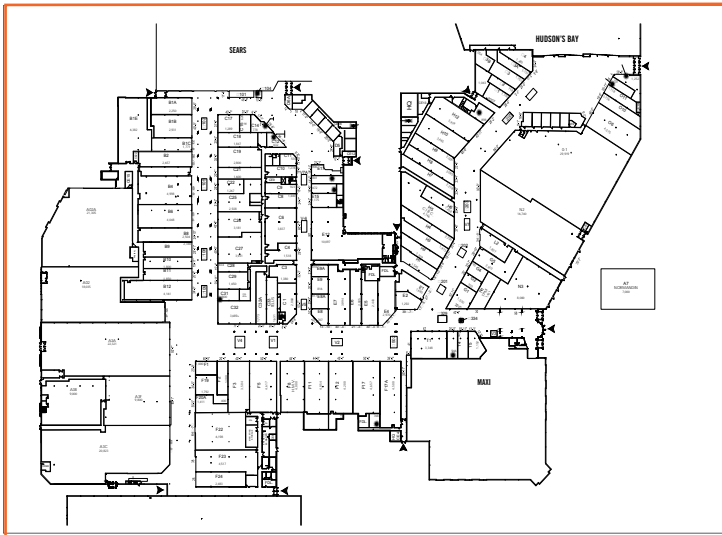

## PLACE VERTU

### SIZE, TENANTS, AMENITIES

**G.L.A.:** 838,089 sq ft

**RETAIL STORES:** 135

**FOOD COURT SEATING:** 1,035

**PARKING SPACES:** 4,168

### MAJOR RETAILERS:

Sears*	196,448 sq ft
Former Target	123,975 sq ft
Canadian Tire	105,086 sq ft
Adonis	42,147 sq ft
Gold's Gym	32,954 sq ft
Winners	24,238 sq ft

---

**Total C.R.U.:** 313,241 sq ft

---

\*Sears is a shadow anchor and is not included in CRU measurement

**OFFICE BUILDING:** 102,147 sq ft

### MARKET

### DEMOGRAPHIC PROFILE

**Primary:** 170,699  
**No. of Households:** 67,679  
**Average Household Income:**  
\$70,018

### Pedestrian Traffic Counts:

11.5 Million annually

**Secondary:** 472,674  
**No. of Households:** 208,942  
**Average Household Income:**  
\$75,654

---

### Centre Sales Productivity:

\$333 per sq ft

---

### HOURS OF OPERATION

Monday – Tuesday: 10:00 a.m. – 6:00 p.m.  
Wednesday - Friday: 10:00 a.m. - 9:00 p.m.  
Saturday: 9:00 a.m. – 5:00 p.m.  
Sunday: 10:00 a.m. - 5:00 p.m.

### CONTACTS

#### General Manager:

Tony Viola (514) 331-5213 Fax: (514) 331-1014

---

#### Marketing Manager:

Annick Libersan (514) 331-5213 Fax: (514) 331-1014

---

#### Vice President, Leasing

Nat Weinstein (514) 331-5213 Fax: (514) 331-1014  
email: nweinstein@20vic.com

<http://www.20vic.com>

FOOD COURT		
UNIT	TENANT NAME	SQ.FT.
FCG23	VIE & NAM	347
FCG24	VALENTINE	377
FCK45	MASAKO SUSHI BAR	104
FCM01	TERIAYKI EXPERIENCE	374
FCM2B	KABAB	485
FCM06	KOJAX	369
FCM07	A & W	368
FCM08	TIKI MING	403
FCM09	TIM HORTON'S	500
FCM22	CAFE DEPOT	189
FCM42	KIMCHI	372
FCM44	AQUALUNCH	381
1C01	GRILLADES TORINO	400
FCN39	SUBWAY	408
FCN41	LOS DIAS	358
FCN43	PLACE TEVERE	513
FCN45	THAI EXPRESS	329
FCN47	CHOP CRAZY	263
FCN49	CULTURES	423



PLACE VERTU