

Chartrand Twp.

Q.P.  
9684  
78-79  
GLPCo.

THE TOWNSHIP OF  
OF  
**CORMAN**

DISTRICT OF  
KENORA

KENORA  
MINING DIVISION

SCALE: 1-INCH=40 CHAINS

LEGEND

PATENTED LAND	⊙
CROWN LAND SALE	C.S.
LEASES	⊕
LOCATED LAND	⊙
LICENSE OF OCCUPATION	L.O.
MINING RIGHTS ONLY	M.R.O.
SURFACE RIGHTS ONLY	S.R.O.
ROADS	—
IMPROVED ROADS	—
KING'S HIGHWAYS	—
RAILWAYS	—
POWER LINES	—
MARSH OR MUSKEG	—
MINES	—
CANCELLED	—
PATENTED S.R.O.	—

NOTES

400' Reserve around all lakes & rivers to  
Dept. of Lands & Forest.

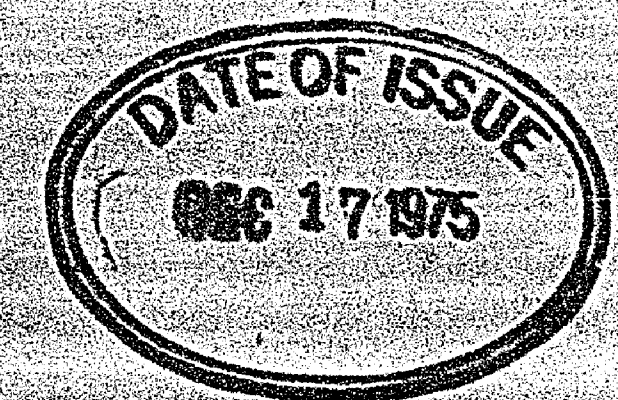
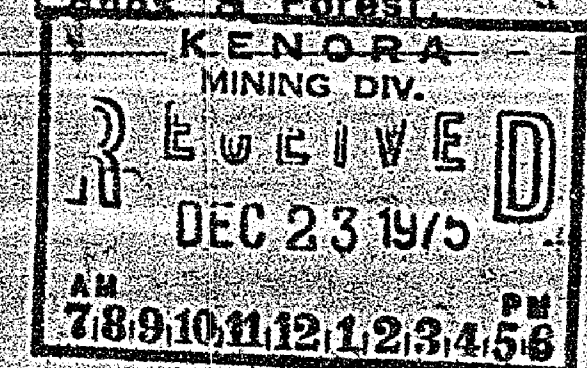

PLAN NO. **M.1805**

MINISTRY OF NATURAL RESOURCES  
SURVEYS AND MAPPING BRANCH

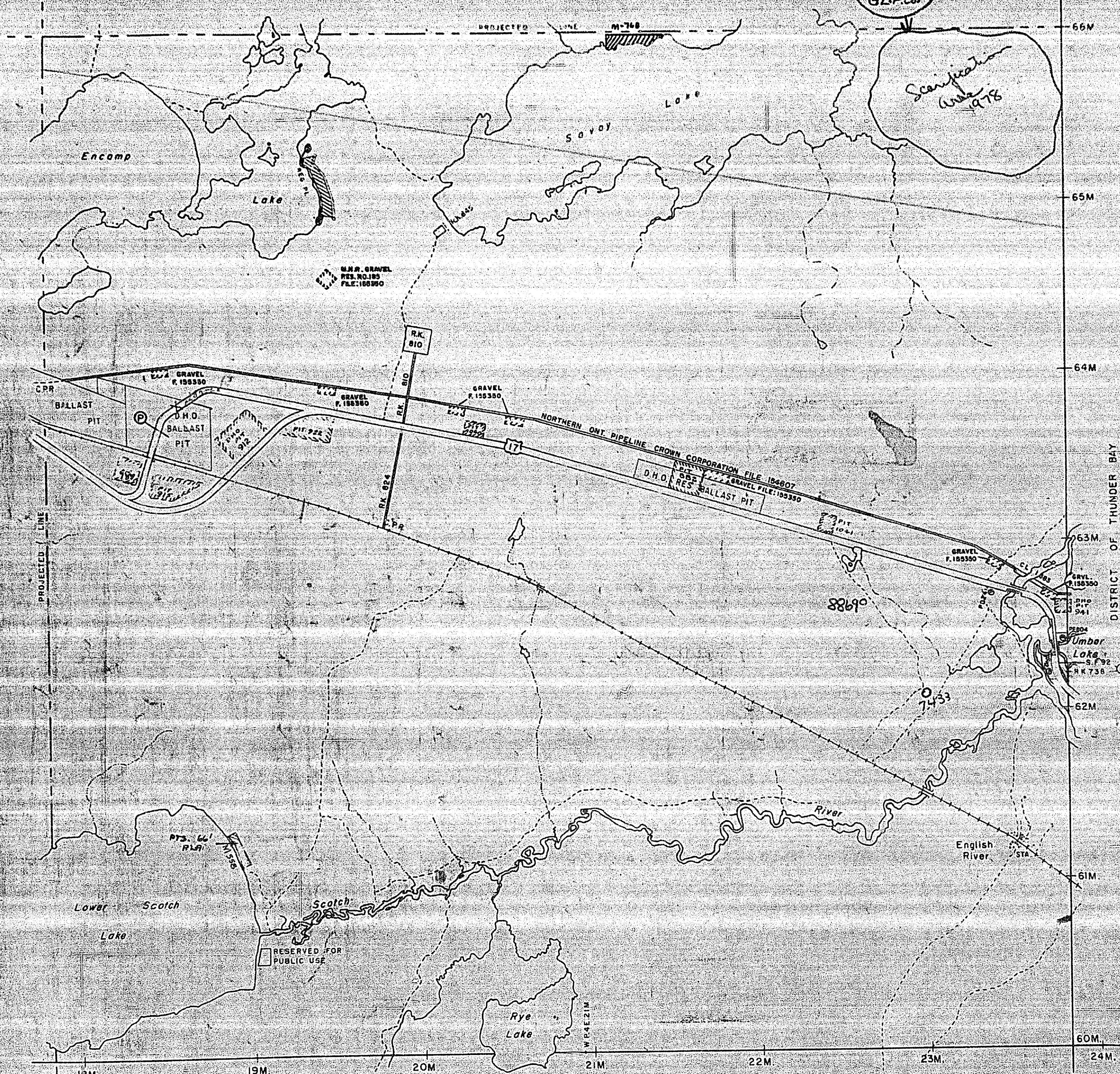

McNevin Twp.

DISTRICT OF THUNDER BAY



Chartrand Twp. G1307

THE TOWNSHIP OF  
OF

**CORMAN**

DISTRICT OF  
KENORA

KENORA  
MINING DIVISION

SCALE: 1-INCH=40 CHAINS

LEGEND

PATENTED LAND	Ⓟ
CROWN LAND SALE	C.S.
LEASES	Ⓛ
LOCATED LAND	Loc.
LICENSE OF OCCUPATION	L.O.
MINING RIGHTS ONLY	M.R.O.
SURFACE RIGHTS ONLY	S.R.O.
ROADS	
IMPROVED ROADS	
KING'S HIGHWAYS	
RAILWAYS	
POWER LINES	
MARSH OR MUSKEG	
MINES	
CANCELLED	C.
PATENTED S.R.O.	Ⓟ

NOTES

400' Surface Rights Reservation along the shores of all lakes and rivers.

SAND & GRAVEL

①	MNR GRAVEL RES. No. 185	FILE 155350	Effective as
②	GRAVEL	FILE 155350	liner
③	GRAVEL PIT No. 987		Aug 24, 1964
④	GRAVEL PIT No. 915		
⑤	GRAVEL PIT No. 912		
⑥	GRAVEL PIT No. 922		
⑦	GRAVEL PIT No. 1040		
⑧	GRAVEL PIT No. 882		
⑨	GRAVEL PIT No. 1041		
⑩	GRAVEL PIT No. 941		

G-1308

PLAN NO.- **M.1805**

ONTARIO  
MINISTRY OF NATURAL RESOURCES  
SURVEYS AND MAPPING BRANCH

McNevin Twp. G1319

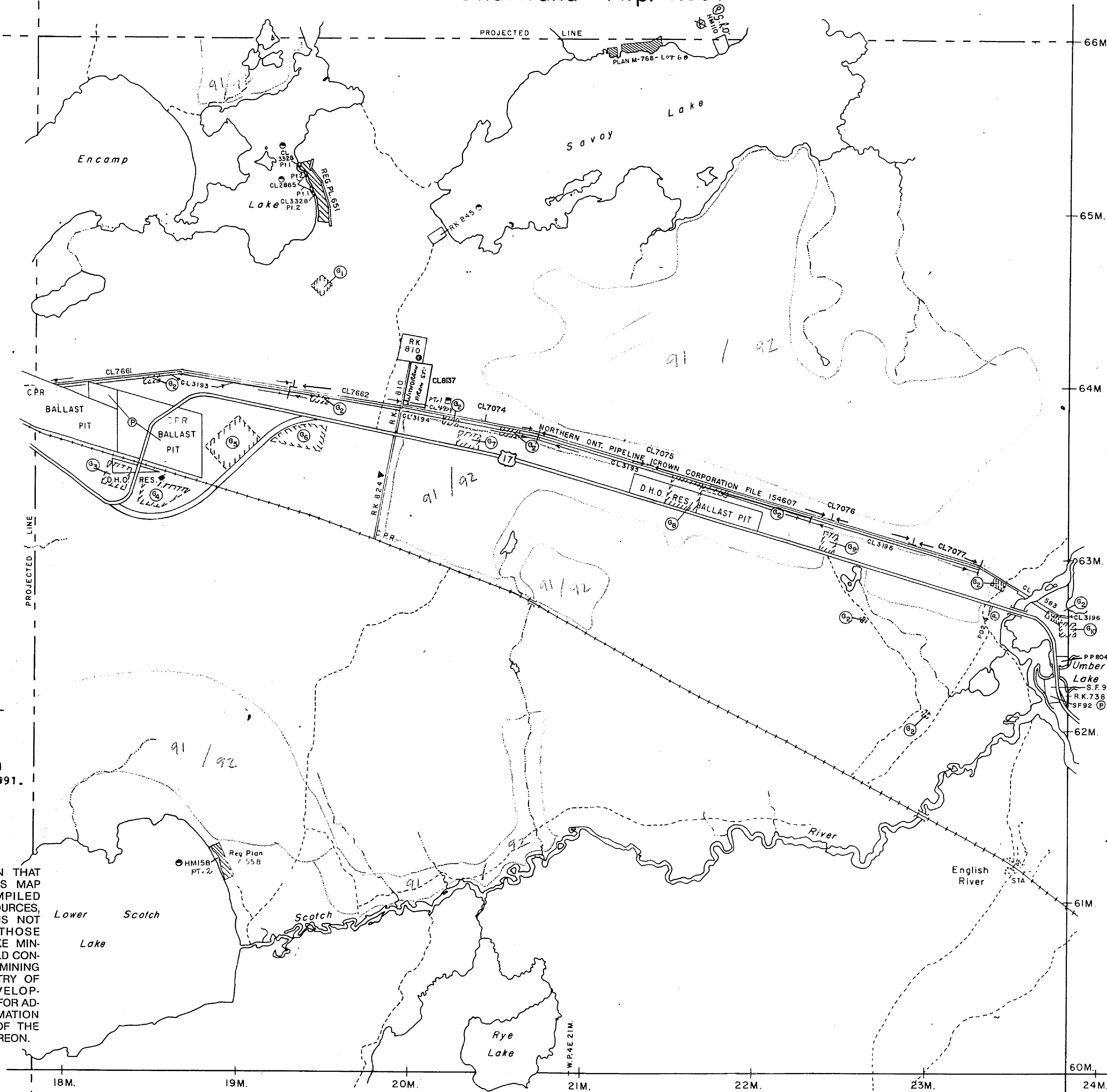

G563 UPPER SCOTCH LK.

NOTICE: THE SURFACE RIGHTS LYING WITHIN 40.25m OF THE CENTRE-LINE OF THE TRANS-CANADA PIPELINE RIGHT-OF-WAY ARE WITHDRAWN FROM STAKING OUT, PROSPECTING, SALE OR LEASE BY ORDER W-01-91 ONT. DATED SEPT. 30, 1991. SECTION 112 OF THE NATIONAL ENERGY BOARD ACT APPLIES.

THE INFORMATION THAT APPEARS ON THIS MAP HAS BEEN COMPILED FROM VARIOUS SOURCES, AND ACCURACY IS NOT GUARANTEED. THOSE WISHING TO STAKE MINING CLAIMS SHOULD CONSULT WITH THE MINING RECORDER, MINISTRY OF NORTHERN DEVELOPMENT AND MINES, FOR ADDITIONAL INFORMATION ON THE STATUS OF THE LANDS SHOWN HEREON.



AREAS WITHDRAWN FROM DISPOSITION

- M.R.O. - MINING RIGHTS ONLY
- S.R.O. - SURFACE RIGHTS ONLY
- M.+S. - MINING AND SURFACE RIGHTS

Description	Order No.	Date	Disposition	File

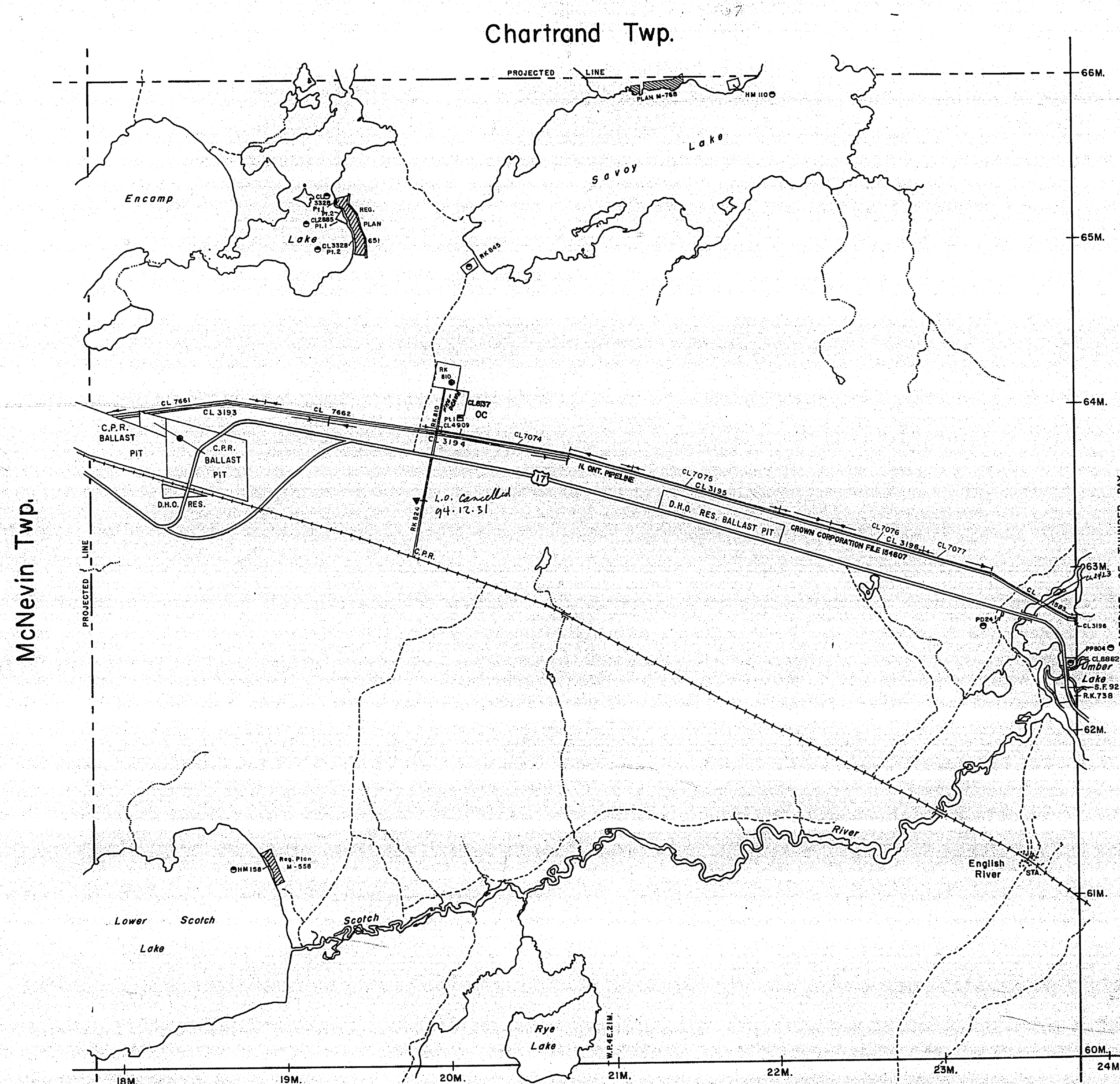

LEGEND

- HIGHWAY AND ROUTE No.
- OTHER ROADS
- TRAILS
- SURVEYED LINES:
  - TOWNSHIPS, BASE LINES, ETC.
  - LOTS, MINING CLAIMS, PARCELS, ETC.
- UNSURVEYED LINES:
  - LOT LINES
  - PARCEL BOUNDARY
  - MINING CLAIMS ETC.
- RAILWAY AND RIGHT OF WAY
- UTILITY LINES
- NON-PERENNIAL STREAM
- FLOODING OR FLOODING RIGHTS
- SUBDIVISION OR COMPOSITE PLAN
- RESERVATIONS
- ORIGINAL SHORELINE
- MARSH OR MUSKEG
- MINES
- TRAVERSE MONUMENT

DISPOSITION OF CROWN LANDS

TYPE OF DOCUMENT	SYMBOL
PATENT, SURFACE & MINING RIGHTS	
" SURFACE RIGHTS ONLY	
" MINING RIGHTS ONLY	
LEASE, SURFACE & MINING RIGHTS	
" SURFACE RIGHTS ONLY	
" MINING RIGHTS ONLY	
LICENCE OF OCCUPATION	
ORDER-IN-COUNCIL	
RESERVATION	
CANCELLED	
SAND & GRAVEL	

SCALE: 1 INCH = 40 CHAINS

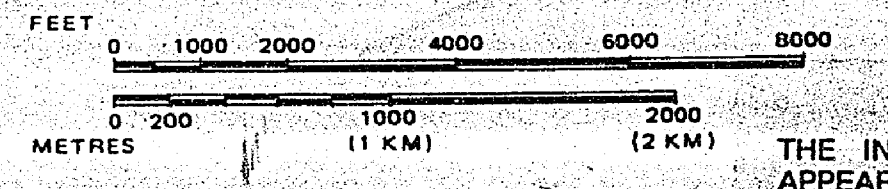

THE INFORMATION THAT APPEARS ON THIS MAP HAS BEEN COMPILED FROM VARIOUS SOURCES, AND ACCURACY IS NOT GUARANTEED. THOSE WISHING TO STAKE MINING CLAIMS SHOULD CONSULT WITH THE MINING RECORDER, MINISTRY OF NORTHERN DEVELOPMENT AND MINES, FOR ADDITIONAL INFORMATION ON THE STATUS OF THE LANDS SHOWN HEREON.

TOWNSHIP

CORMAN

M.N.R. ADMINISTRATIVE DISTRICT

DRYDEN

MINING DIVISION

KENORA

LAND TITLES / REGISTRY DIVISION

KENORA

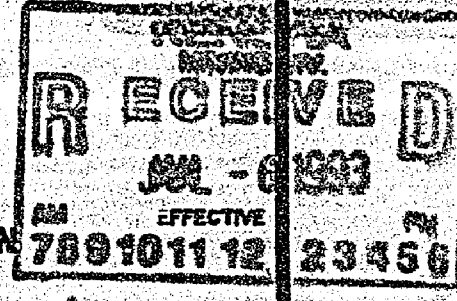

Ministry of Natural Resources

Ministry of Northern Development and Mines

Date NOVEMBER /92

Number G-1308



Chartrand Twp.

McNevin Twp.

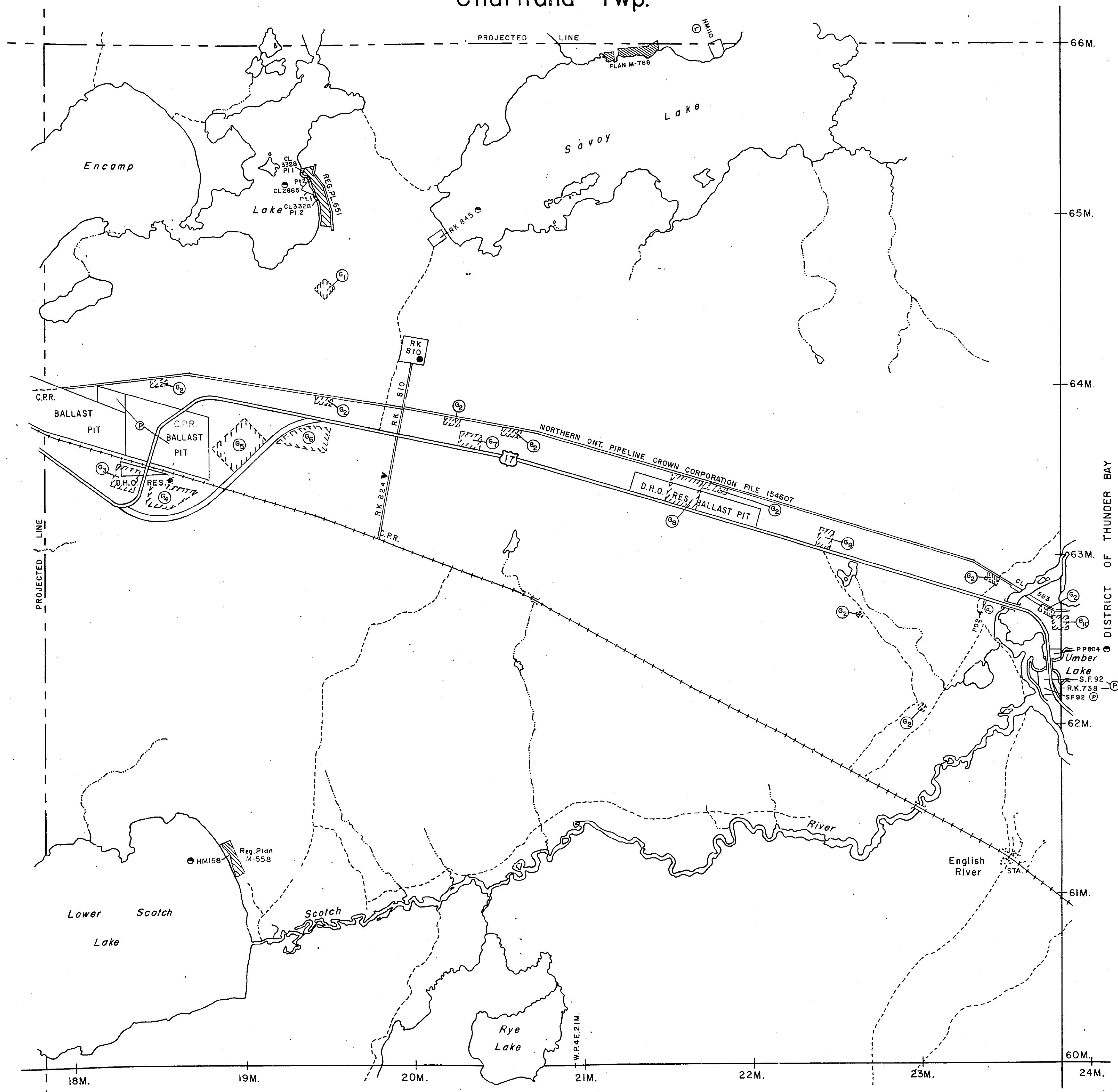

THE TOWNSHIP OF  
OF  
**CORMAN**

DISTRICT OF  
KENORA

KENORA  
MINING DIVISION

SCALE: 1-INCH=40 CHAINS

LEGEND

- |                       |        |
|-----------------------|--------|
| PATENTED LAND         | Ⓟ      |
| CROWN LAND SALE       | C.S.   |
| LEASES                | Ⓞ      |
| LOCATED LAND          | Loc.   |
| LICENSE OF OCCUPATION | L.O.   |
| MINING RIGHTS ONLY    | M.R.O. |
| SURFACE RIGHTS ONLY   | S.R.O. |
| ROADS                 | —      |
| IMPROVED ROADS        | —      |
| KING'S HIGHWAYS       | —      |
| RAILWAYS              | —      |
| POWER LINES           | —      |
| MARSH OR MUSKEG       | * *    |
| MINES                 | Ⓜ      |
| CANCELLED             | C.     |
| PATENTED S.R.O.       | Ⓞ      |

NOTES

400' Surface Rights Reservation along the shores of all lakes and rivers.

DATE OF ISSUE  
MAY 30 1983  
Ministry of Natural Resources  
TORONTO

SAND & GRAVEL

- |   |                         |             |
|---|-------------------------|-------------|
| ① | MNR GRAVEL RES. No. 185 | FILE 155350 |
| ② | GRAVEL                  | FILE 155350 |
| ③ | GRAVEL PIT No. 987      |             |
| ④ | GRAVEL PIT No. 915      |             |
| ⑤ | GRAVEL PIT No. 912      |             |
| ⑥ | GRAVEL PIT No. 922      |             |
| ⑦ | GRAVEL PIT No. 1040     |             |
| ⑧ | GRAVEL PIT No. 882      |             |
| ⑨ | GRAVEL PIT No. 1041     |             |
| ⑩ | GRAVEL PIT No. 941      |             |

MINING D.V.  
JUN 9 1983  
AM 7:89  
PH 12:12 1:23 4:58  
Effective as Lined

*Obsolete Aug. 24/84*

PLAN NO.- **M.1805**

ONTARIO  
MINISTRY OF NATURAL RESOURCES  
SURVEYS AND MAPPING BRANCH