

North Sherbrooke Twp.

Dalhousie Twp.

THE TOWNSHIP OF SOUTH SHERBROOKE COUNTY OF LANARK

SOUTHERN ONTARIO MINING DIVISION

SCALE 1-INCH = 40 CHAINS

LEGEND

- PATENTED LAND
- CROWN LAND SALE
- LEASES
- LOCATED LAND
- LICENSE OF OCCUPATION
- MINING RIGHTS ONLY
- SURFACE RIGHTS ONLY
- ROADS
- IMPROVED ROADS
- KINGS HIGHWAYS
- RAILWAYS
- POWER LINES
- MARSH OR MUSKEG
- MINES

NOTES

This Map is Not To Be Used FOR SURVEY PURPOSES

Original shoreline shown thus: F.R.I. shoreline shown thus:

Lot 1, 2, 3, 4, 5 in the GORE affected by SOUTH SHERBROOKE by Proclamation 1st May 1865. See P.L.S.W. Beatty's plan of this GORE.

For status of Islands in please contact Dept of Lands & Forests.

DATE OF ISSUE AUG 18 1995 SOUTHERN ONTARIO MINING DIVISION

THE INFORMATION THAT APPEARS ON THIS MAP HAS BEEN COMPILED FROM VARIOUS SOURCES, AND ACCURACY IS NOT GUARANTEED. THOSE WISHING TO STAKE MINING CLAIMS SHOULD CONSULT WITH THE MINING RECORDER, MINISTRY OF NORTHERN DEVELOPMENT AND MINES, FOR ADDITIONAL INFORMATION ON THE STATUS OF THE LANDS SHOWN HEREON.

PLAN NO. - M. 151

ONTARIO MINISTRY OF NATURAL RESOURCES SURVEY BRANCH

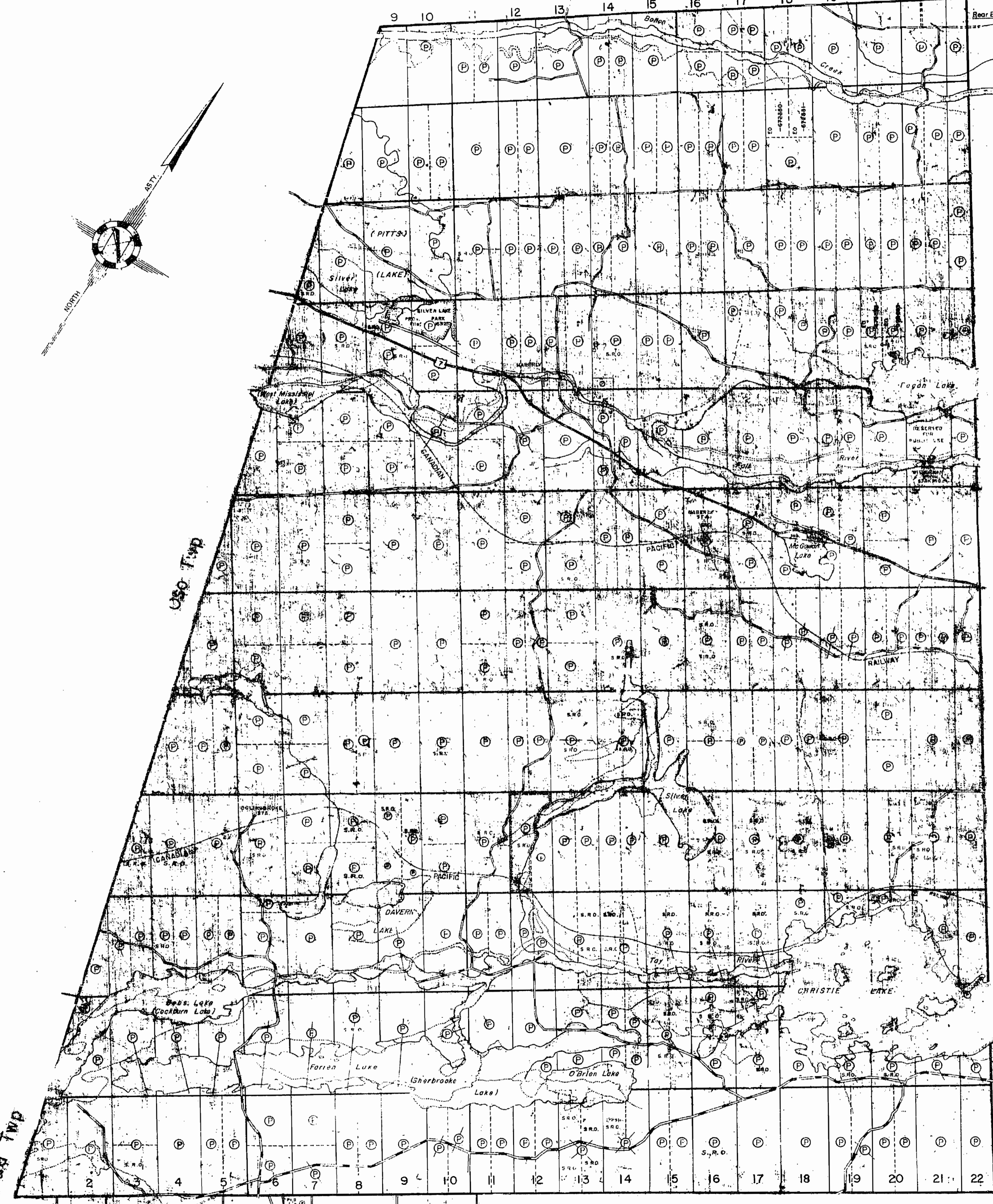
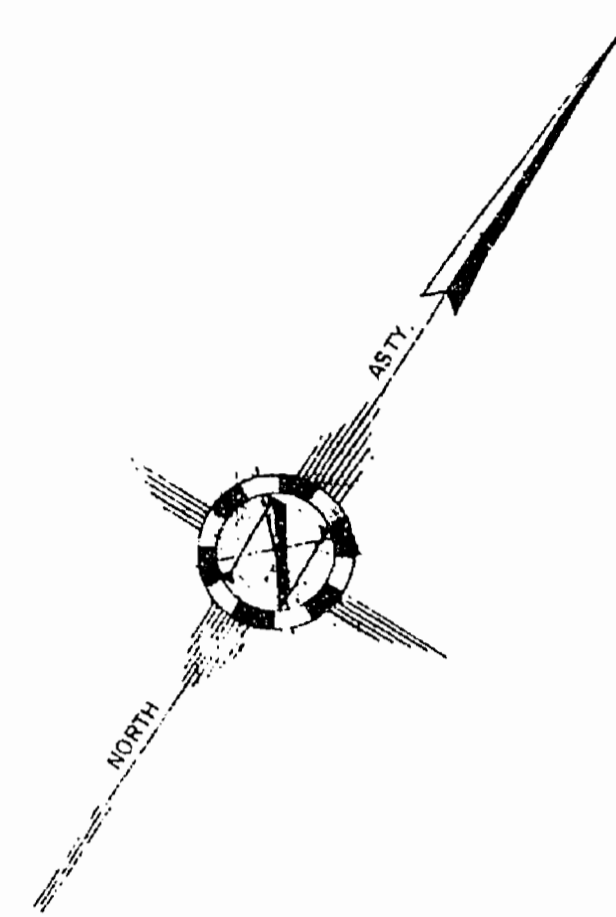

XII XI X IX VIII VII VI V IV III II I

U.S.O. Twp

Bathurst Twp

Bedford Twp

North Crosby Twp.

North Sherbrooke Twp.

Dalhousie Twp.

THE TOWNSHIP
OF
SOUTH SHERBROOKE
COUNTY OF
LANARK

SOUTHERN ONTARIO
MINING DIVISION

SCALE 1-INCH = 40 CHAINS

LEGEND

- PATENTED LAND
- CROWN LAND SALE
- LEASES
- LOCATED LAND
- LICENSE OF OCCUPATION
- MINING RIGHTS ONLY
- SURFACE RIGHTS ONLY
- ROADS
- IMPROVED ROADS
- KINGS, HIGHWAYS
- RAILWAYS
- POWER LINES
- MARSH OR MUSKEG
- MINES

NOTES

This Map is Not to be Used
FOR SURVEY PURPOSES

Original shoreline shown thus
F.R.I. shoreline shown thus

Lots 1, 2, 3, 4, 5 in the GORE attached to
SOUTH SHERBROOKE by Proclamation 1st May
1865. See P.L.S.W. Beatty's plan of this GORE

For status of Islands in ... please
contact Dept. of Lands & Forests

DATE OF ISSUE
MAR - 5 1997
SOUTHERN ONTARIO
MINING DIVISION

THE INFORMATION THAT
APPEARS ON THIS MAP
HAS BEEN COMPILED
FROM VARIOUS SOURCES,
AND ACCURACY IS NOT
GUARANTEED. THOSE
WISHING TO STAKE MINING
CLAIMS SHOULD CONSULT
WITH THE MINING
RECORDER, MINISTRY OF
NORTHERN DEVELOPMENT
AND MINES, FOR ADDITIONAL
INFORMATION ON THE
STATUS OF THE
LANDS SHOWN HEREON.

PLAN NO. - M. 151

ONTARIO
MINISTRY OF NATURAL RESOURCES
SURVEY BRANCH

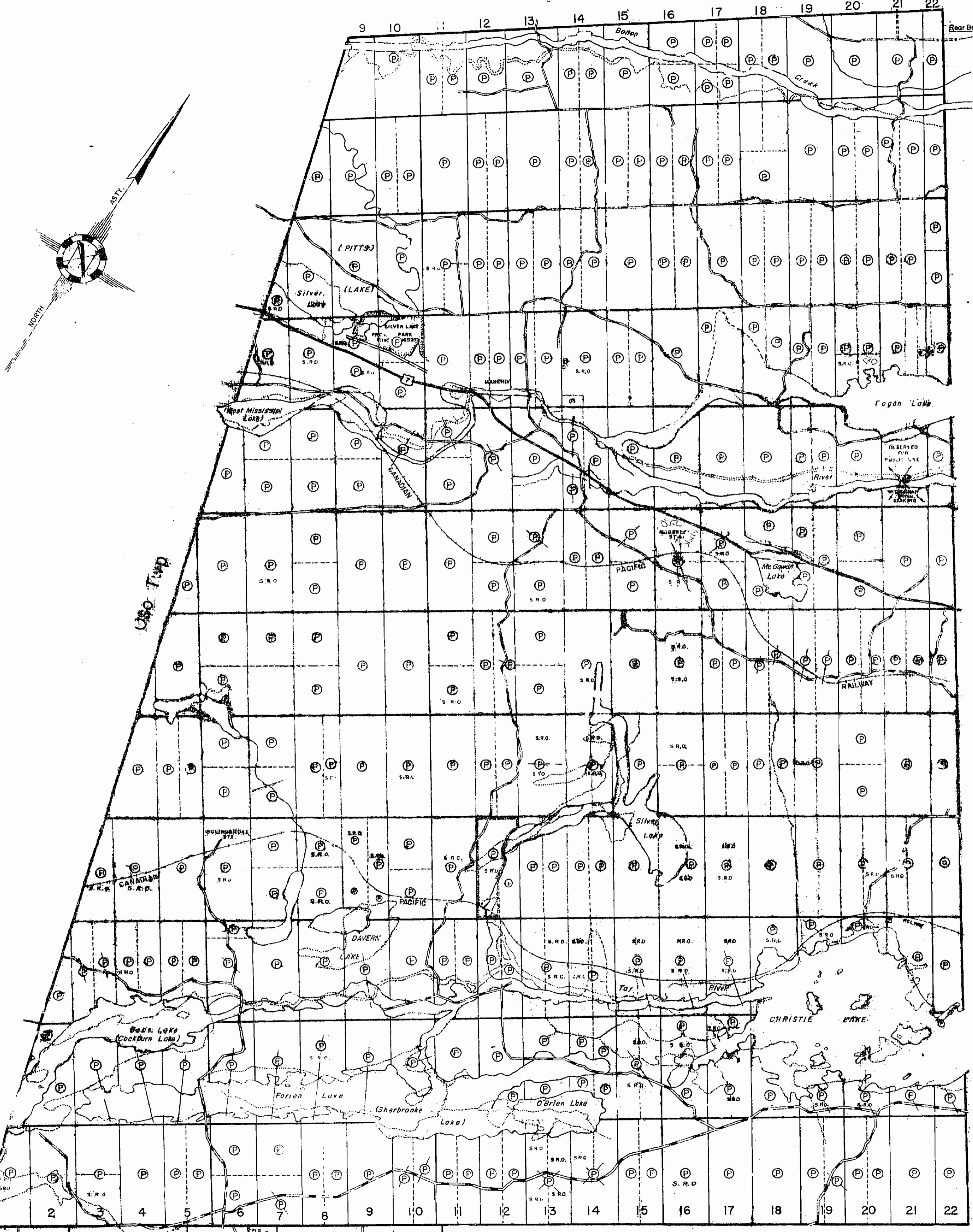

XII
XI
X
IX
VIII
VII
VI
V
IV
III
II
I

Bathurst Twp.

M 2

SOUTH SHERBROOKE TWP.

M 2

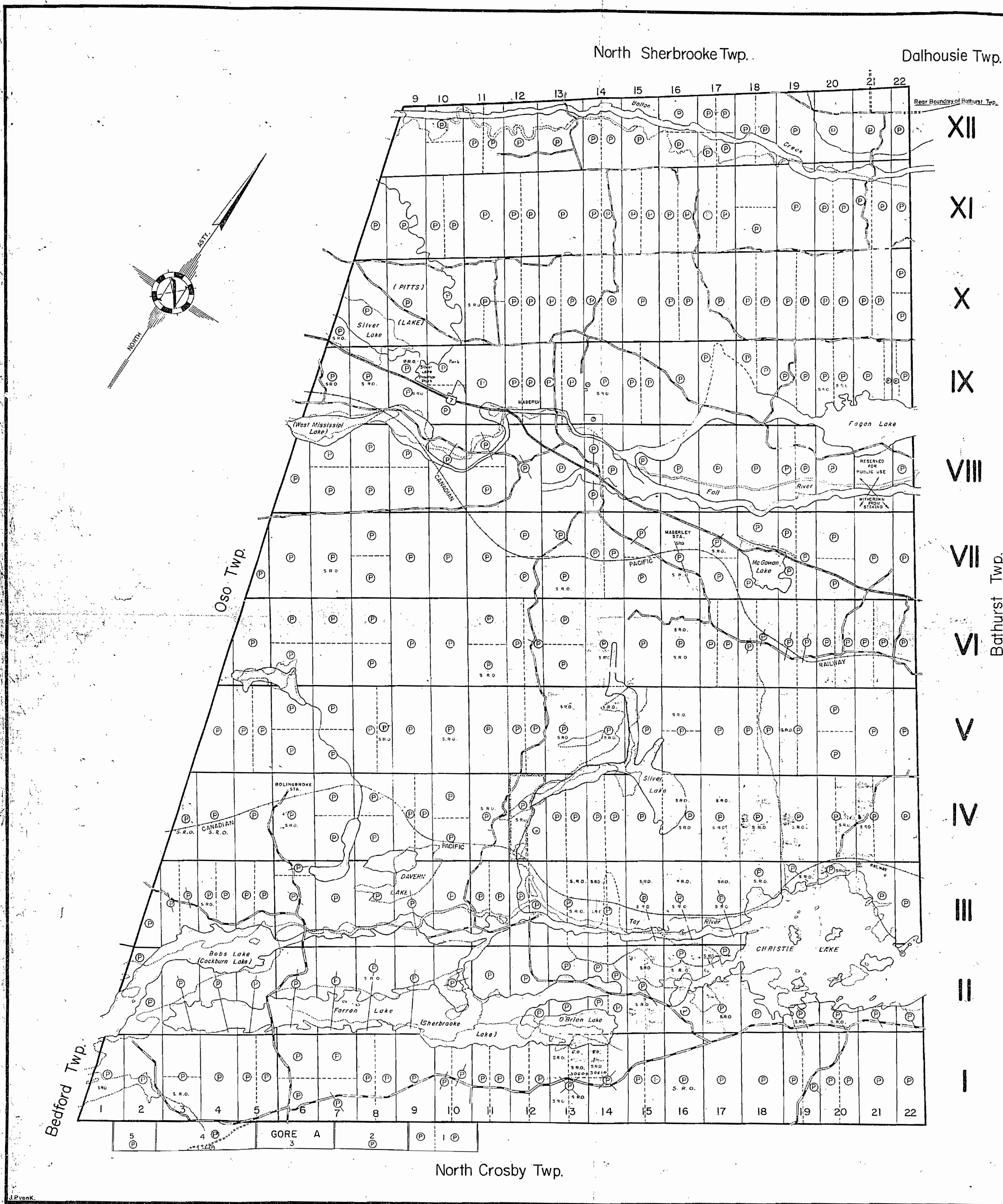

THE TOWNSHIP
OF
SOUTH SHERBROOKE
COUNTY OF
LANARK

EASTERN ONTARIO
MINING DIVISION
SCALE: 1-INCH = 40 CHAINS

LEGEND

PATENTED LAND	⊙
CROWN LAND SALE	⊙
LEASES	⊙
LOCATED LAND	⊙
LICENSE OF OCCUPATION	L.O.
MINING RIGHTS ONLY	M.R.O.
SURFACE RIGHTS ONLY	S.R.O.
ROADS	—
IMPROVED ROADS	—
KING'S HIGHWAYS	—
RAILWAYS	—
POWER LINES	—
MARSH OR MUSKEG	—
M.NES	✕

NOTES

This Map Is Not To Be Used
FOR SURVEY PURPOSES.

400' Surface rights reservation around all lakes & rivers.

Original shoreline shown thus: —
F.R.I. shoreline shown thus: —

Lots 1,2,3,4,5 in the GORE attached to
SOUTH SHERBROOKE by Proclamation 1st May
1865. See P.L.S.W. Beattys plan of this GORE.

For status of Islands in this Township please
contact Dept. of Lands & Forests.

XII
XI
X
IX
VIII
VII
VI
V
IV
III
II
I

Bathurst Twp.

ONT. DEPT. OF MINES
MINING LANDS BR.
THIS MAP FOR CHECKING
PURPOSES ONLY - MUST
NOT BE SOLD.

DATE OF ISSUE
JUL 1 6 1953
ONTARIO DEPT. OF MINES

PLAN NO. - **M. 151**
DEPARTMENT OF MINES
— ONTARIO —

SOUTH SHERBROOKE TWP.

M 2

North Sherbrooke Twp.

Dalhousie Twp.

THE TOWNSHIP
 'E' OF M-151
SOUTH SHERBROOKE
 COUNTY OF LANARK
D.M. CARLETON PLACE
 EASTERN ONTARIO
 MINING DIVISION

SCALE: 1-INCH = 40 CHAINS

LEGEND

- PATENTED LAND (P)
- CROWN LAND SALE (C.S.)
- LEASES (L)
- LOCATED LAND (Loc.)
- LICENSE OF OCCUPATION (L.O.)
- MINING RIGHTS ONLY (M.R.O.)
- SURFACE RIGHTS ONLY (S.R.O.)
- ROADS (—)
- IMPROVED ROADS (—)
- KING'S HIGHWAYS (—)
- RAILWAYS (—)
- POWER LINES (—)
- MARSH OR MUSKEG (—)
- MINES (—)

NOTES

This Map Is Not To Be Used
 FOR SURVEY PURPOSES

400' S.W. 1/4 of this reservation around all lakes
 & rivers

Original shoreline shown thus: —
 F.R.I. shoreline shown thus: —

Lots 1, 2, 3, 4, 5 in the GORE attached to
 SOUTH SHERBROOKE by Proclamation 1st May
 1865. See P.L.S.W. Beatty's plan of this GORE

For status of Islands in this map please
 contact Dept. of Lands & Forests.

DATE OF ISSUE
JUL 21 1983
 Ministry of Natural Resources
 TORONTO

PLAN NO. - **M. 151**
 ONTARIO
 MINISTRY OF NATURAL RESOURCES
 SURVEYS AND MAPPING BRANCH

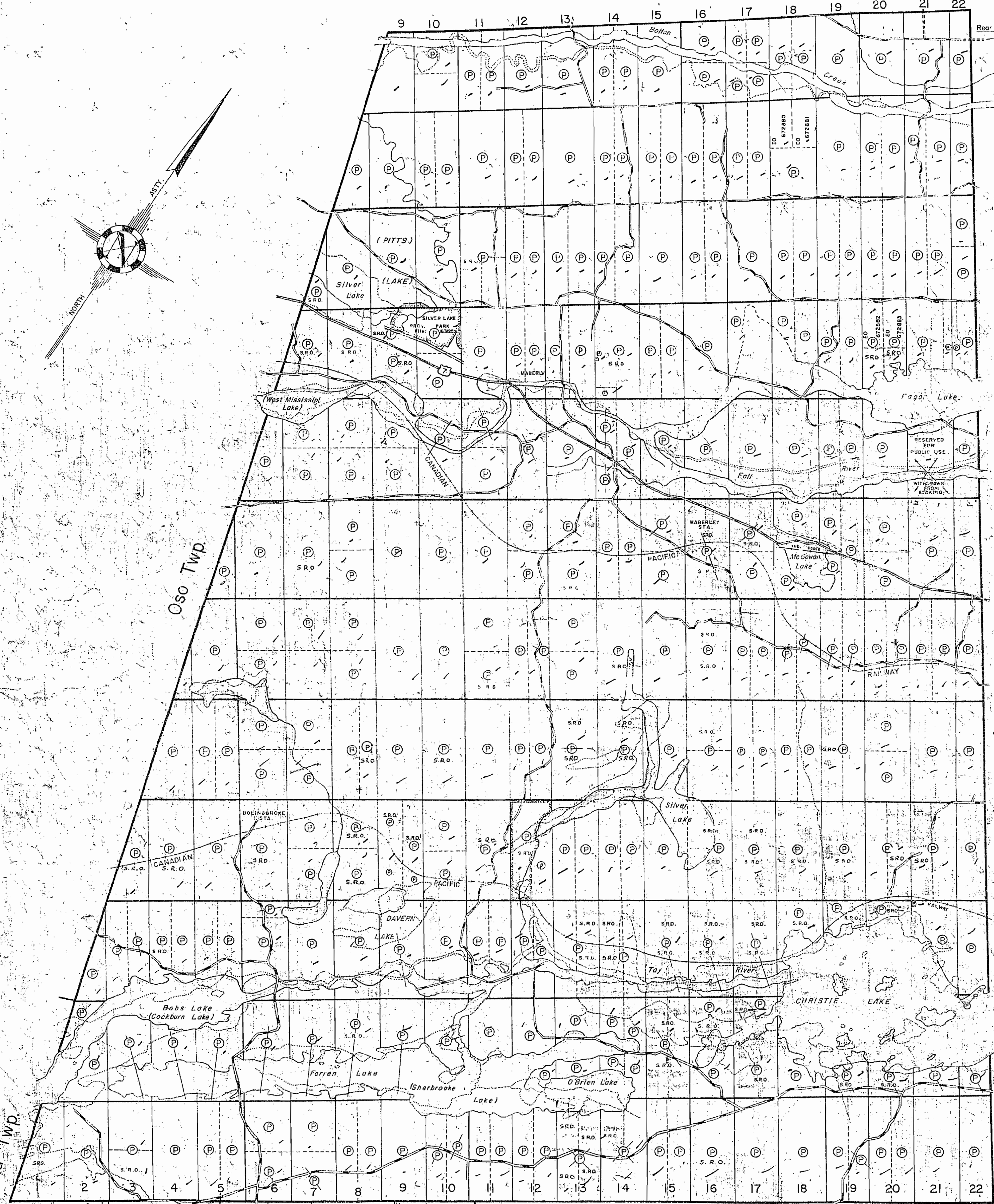
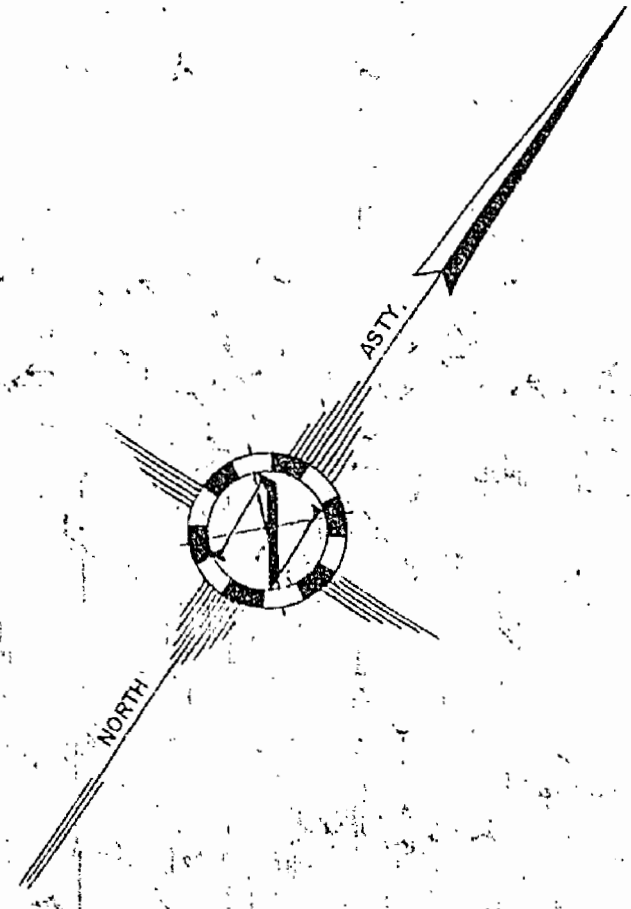

XII
 XI
 X
 IX
 VIII
 VII
 VI
 V
 IV
 III
 II
 I

Oso Twp.

Bathurst Twp.

Bedford Twp.

North Crosby Twp.

9 10 11 12 13 14 15 16 17 18 19 20 21 22

5 4 3 2 1

GORE A

North Sherbrooke Twp.

Dalhousie Twp.

THE TOWNSHIP
E OF M. 151
SOUTH
SHERBROOKE
COUNTY OF
LANARK

CARLETON PLACE DISTRICT

SOUTHERN ONTARIO
MINING DIVISION

RESIDENT GEOLOGIST-TWEED
SCALE: 1-INCH = 40 CHAINS

LEGEND

PATENTED LAND	(P)
CROWN LAND SALE	(CS)
LEASES	(L)
LOCATED LAND	(L.C.)
LICENSE OF OCCUPATION	(L.O.)
MINING RIGHTS ONLY	(M.R.O.)
SURFACE RIGHTS ONLY	(S.R.O.)
ROADS	(R)
IMPROVED ROADS	(R.I.)
KING'S HIGHWAYS	(K.H.)
RAILWAYS	(R.L.)
POWER LINES	(P.L.)
MARSH OR MUSKOG	(M)
MINES	(M.N.)

NOTES

This Map Is Not To Be Used
FOR SURVEY PURPOSES

400' SW 1/4 of lots reserved for and on rivers
& rivers

Original shoreline shown thus: _____
F.R.I. shoreline shown thus: _____

Lots 1,2,3,4,5 in the GORE attached to
SOUTH SHERBROOKE by Proclamation 1st May
1865. See P.L.S.W. Beattys plan of this GORE.

For status of Islands in _____ please
contact Dept. of Lands & Forests.

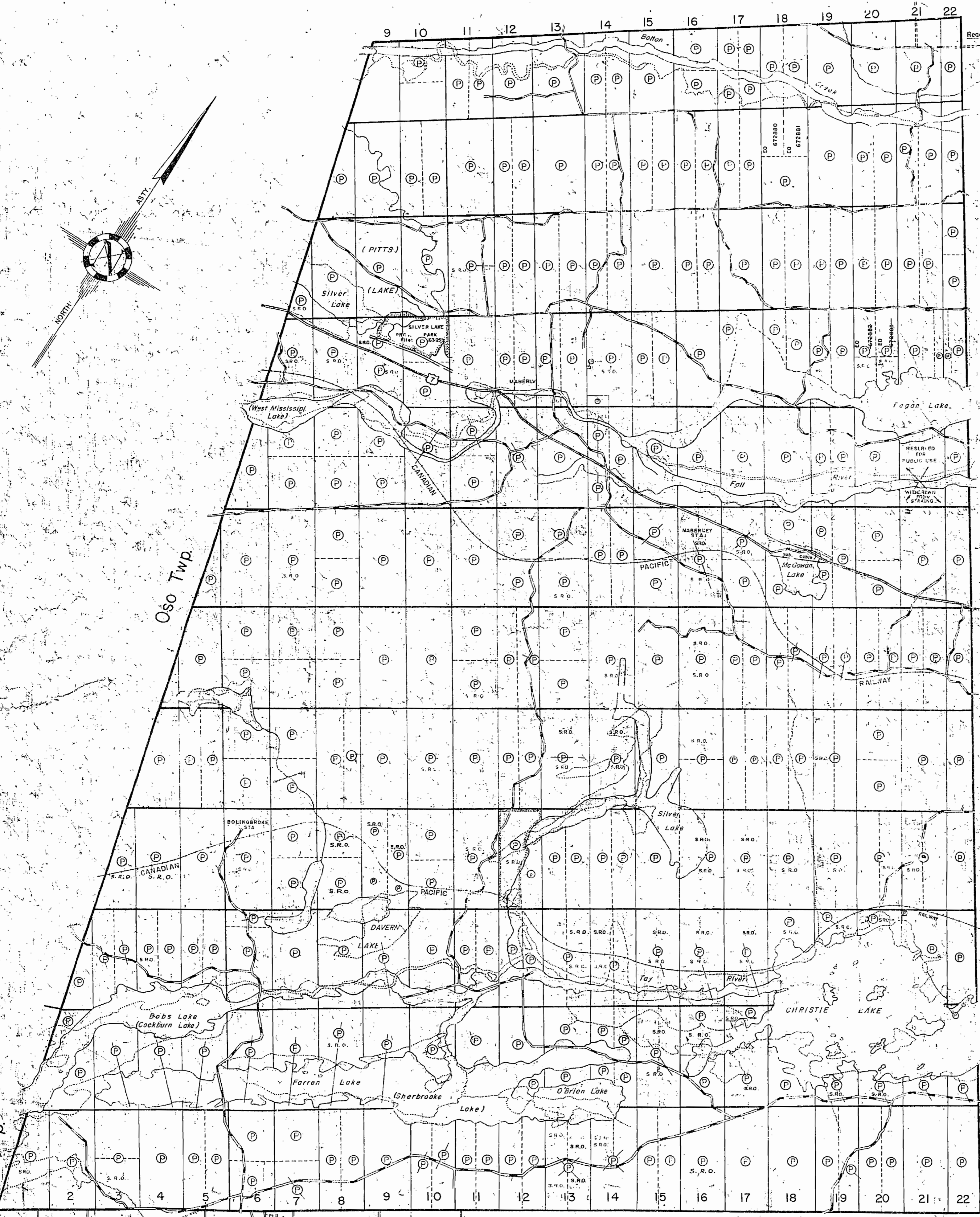
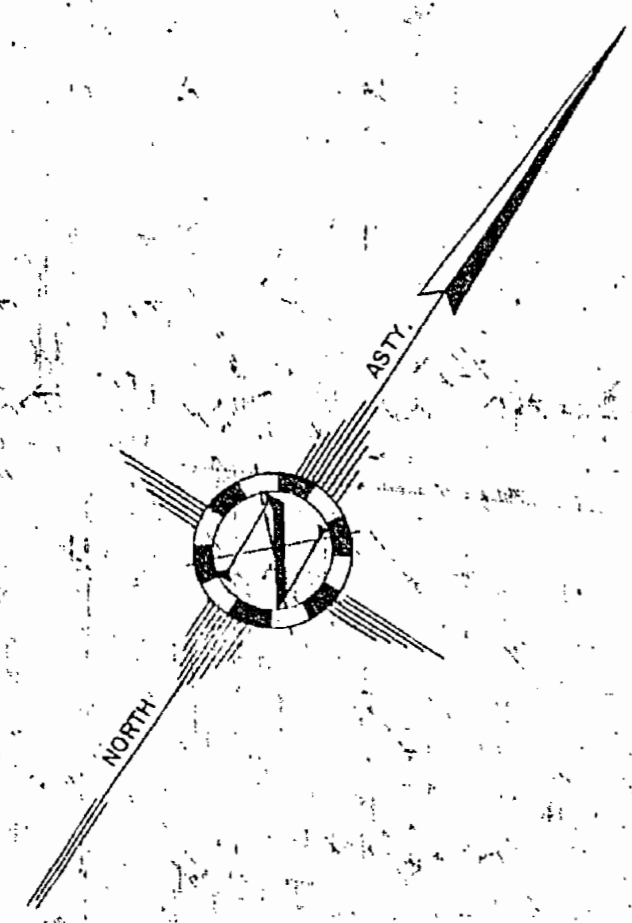

XII
XI
X
IX
VIII
VII
VI
V
IV
III
II
I

Oso Twp.

Bathurst Twp.

Bedford Twp.

North Crosby Twp.

PLAN NO. - M. 151

ONTARIO
MINISTRY OF NATURAL RESOURCES
SURVEY AND MAPPING BRANCH

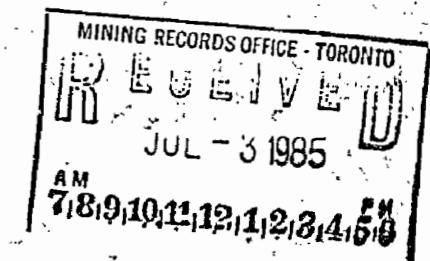

North Sherbrooke Twp.

Dalhousie Twp.

THE TOWNSHIP
OF
SOUTH SHERBROOKE
COUNTY OF
LANARK

EASTERN ONTARIO
MINING DIVISION

SCALE: 1-INCH = 40 CHAINS

LEGEND

PATENTED LAND	Ⓟ
CROWN LAND SALE	C.S.
LEASES	Ⓛ
LOCATED LAND	L.C.
LICENSE OF OCCUPATION	L.O.
MINING RIGHTS ONLY	M.R.O.
SURFACE RIGHTS ONLY	S.R.O.
ROADS	—
IMPROVED ROADS	—
KING'S HIGHWAYS	—
RAILWAYS	—
POWER LINES	—
MARSH OR MUSKEG	—
M.N.E.S.	—

NOTES

This Map Is Not To Be Used
FOR SURVEY PURPOSES

400' Surface rights reservation around all lakes
& rivers

Original shoreline shown thus: —
F.R.I. shoreline shown thus: —

Lots 1,2,3,4,5 in the GORE attached to
SOUTH SHERBROOKE by Proclamation 1st May
1865. See P.L.S.W. Beattys plan of this GORE.

For status of Islands in this Township please
contact Dept. of Lands & Forests.

ONT. DEPT. OF MINES
MINING LANDS BR.
THIS MAP FOR CHECKING
PURPOSES ONLY - MUST
NOT BE SOLD.

DATE OF ISSUE
NOV 25 1963
ONTARIO DEPT. OF MINES

PLAN NO. - **M. 151**

DEPARTMENT OF MINES
— ONTARIO —

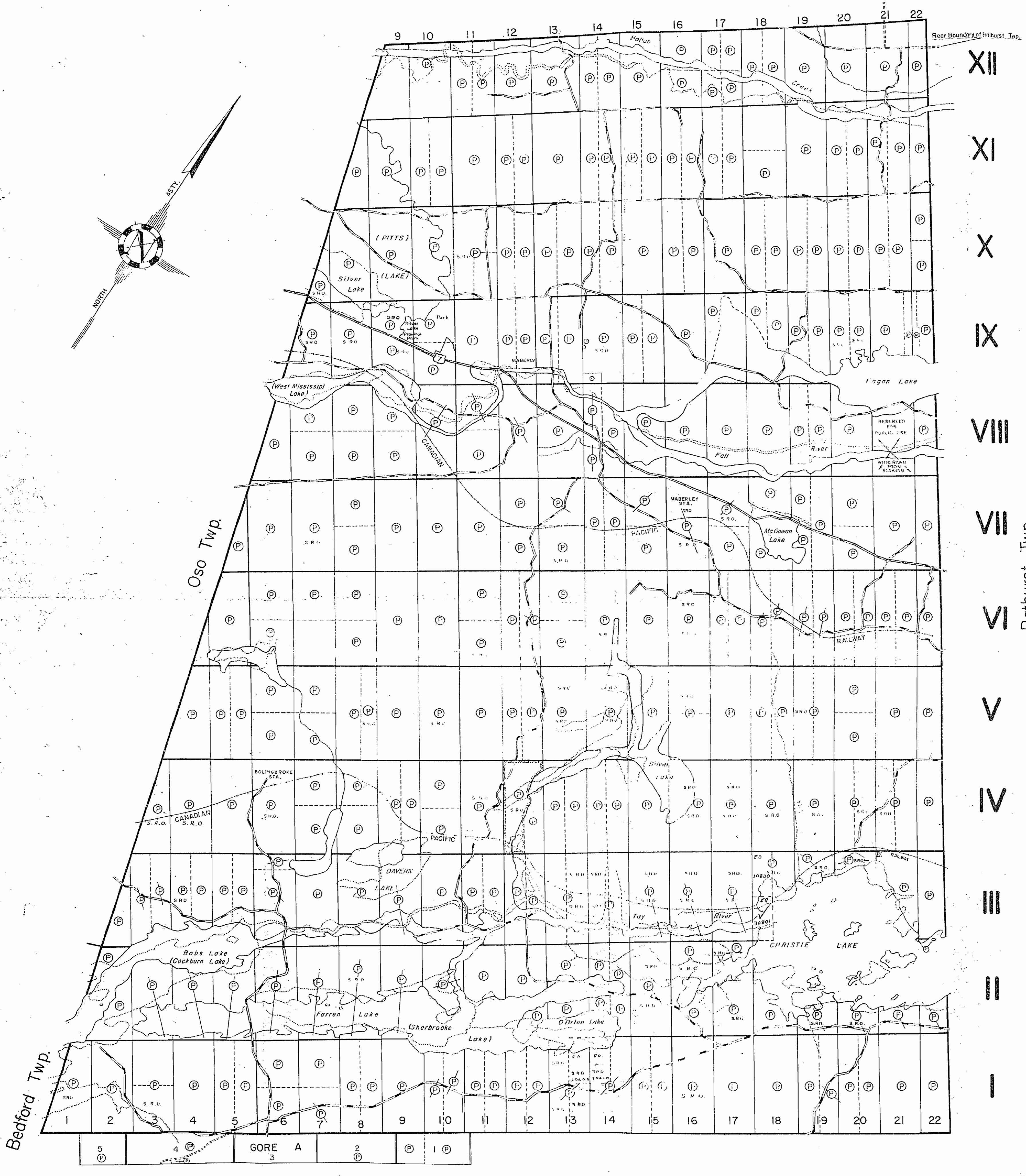
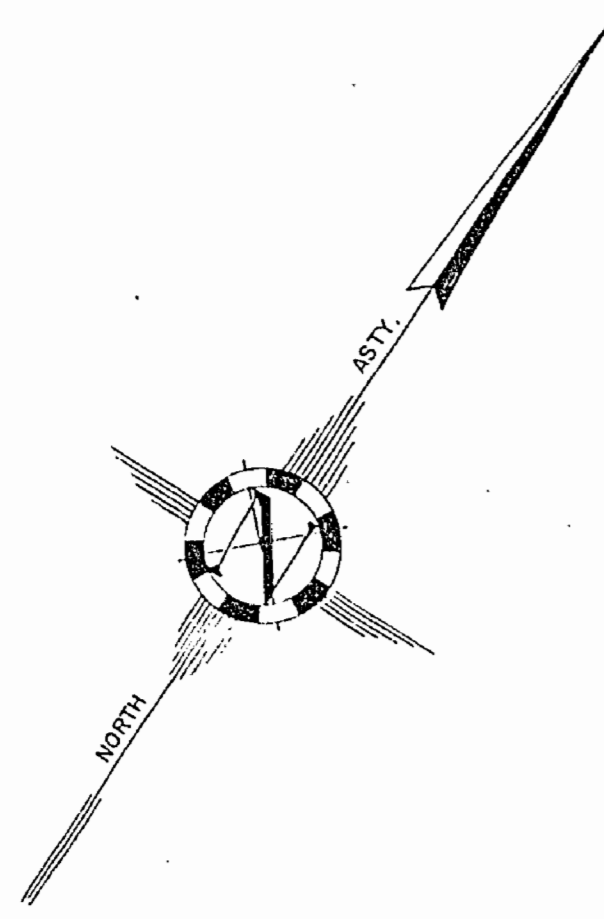

North Sherbrooke Twp.

Dalhousie Twp.

THE TOWNSHIP
OF
SOUTH SHERBROOKE
COUNTY OF
LANARK

EASTERN ONTARIO
MINING DIVISION

SCALE: 1-INCH = 40 CHAINS

LEGEND

PATENTED LAND	⊙
CROWN LAND SALE	⊙
LEASES	⊙
LOCATED LAND	⊙
LICENSE OF OCCUPATION	⊙
MINING RIGHTS ONLY	⊙
SURFACE RIGHTS ONLY	⊙
ROADS	—
IMPROVED ROADS	—
KING'S HIGHWAYS	—
RAILWAYS	—
POWER LINES	—
MARSH OR MUSKEG	—
M.N.E.S.	⊙

NOTES

This Map is Not To Be Used
FOR SURVEY PURPOSES

400' Surface rights reservation around all lakes & rivers

Original shoreline shown thus: —
F.R.I. shoreline shown thus: —

Lots 1,2,3,4,5 in the GORE attached to
SOUTH SHERBROOKE by Proclamation 1st May
1865. See P.L.S.W. Beattys plan of this GORE

For status of Islands in this Township please
contact Dept. of Lands & Forests

DATE OF ISSUE
OCT - 6 1969
ONTARIO DEPT. OF MINES

PLAN NO. - **M. 151**

DEPARTMENT OF MINES
— ONTARIO —

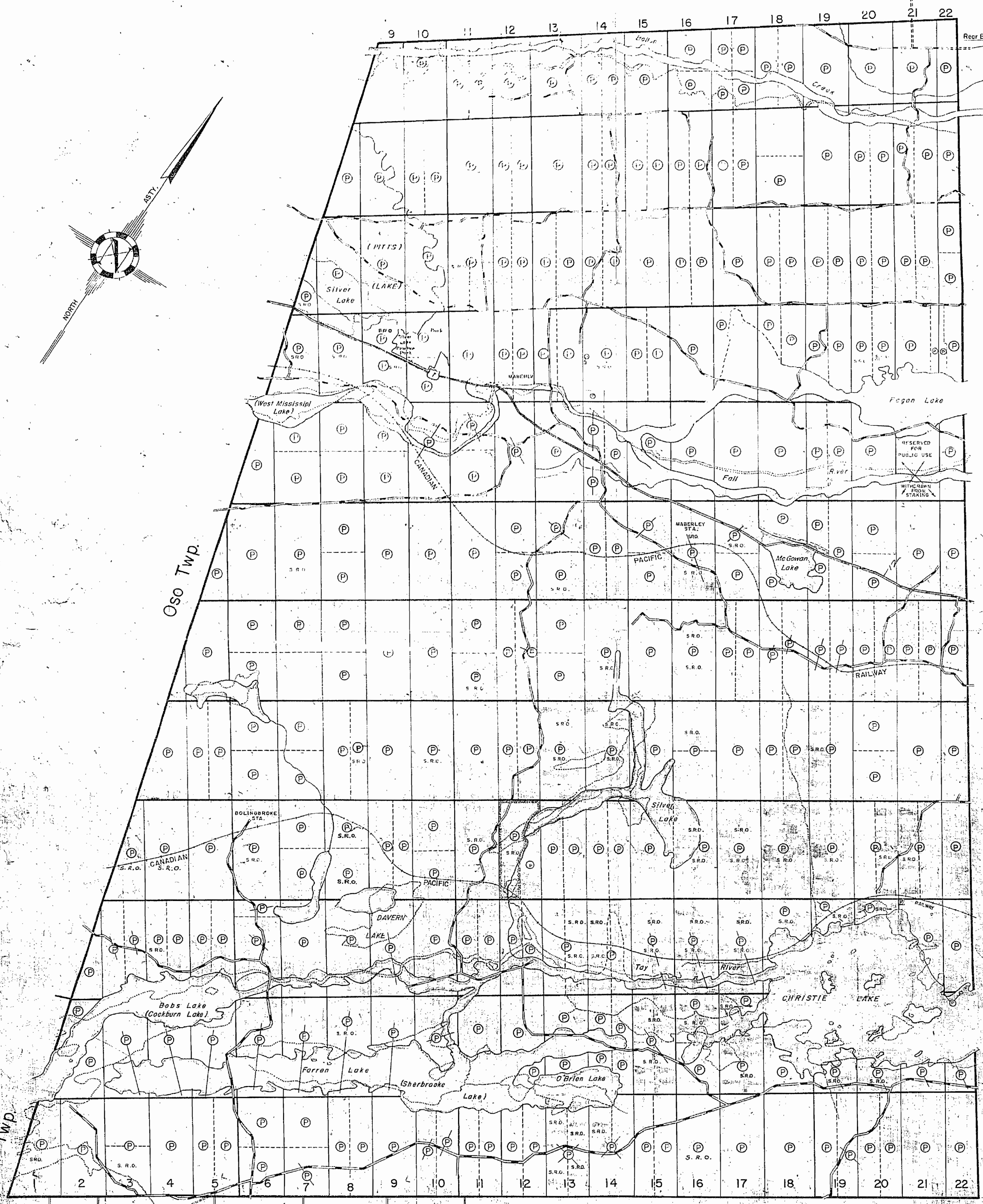
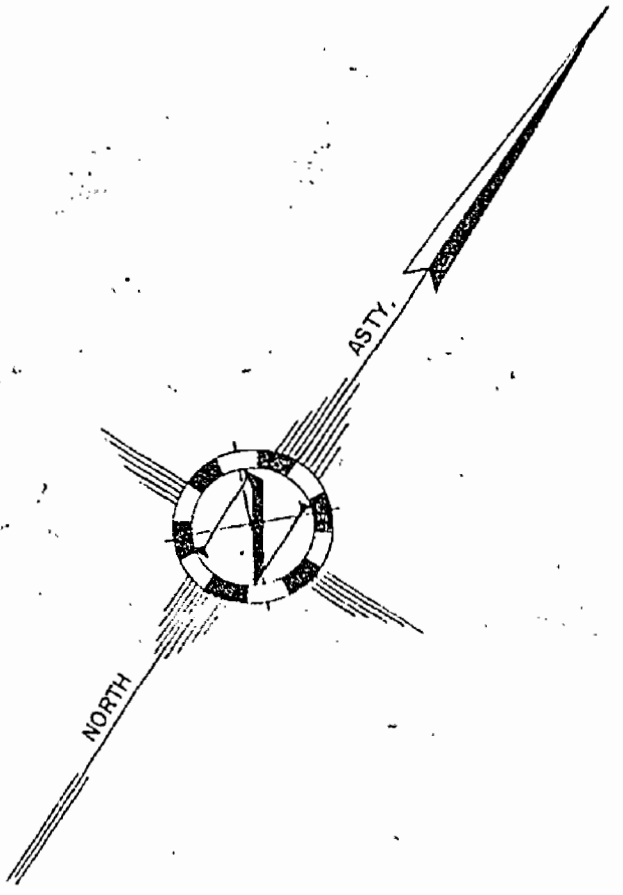

XII
XI
X
IX
VIII
VII
VI
V
IV
III
II
I

Bedford Twp.

Oso Twp.

Bathurst Twp.

North Crosby Twp.

GORE A
3 2 1

North Sherbrooke Twp.

Dalhousie Twp.

THE TOWNSHIP
OF
SOUTH SHERBROOKE
COUNTY OF
LANARK

EASTERN ONTARIO
MINING DIVISION

SCALE: 1-INCH = 40 CHAINS

LEGEND

PATENTED LAND	⊙
CROWN LAND SALE	⊙
LEASES	⊙
LOCATED LAND	⊙
LICENSE OF OCCUPATION	⊙
MINING RIGHTS ONLY	M.R.O.
SURFACE RIGHTS ONLY	S.R.O.
ROADS	—
IMPROVED ROADS	—
KING'S HIGHWAYS	—
RAILWAYS	—
POWER LINES	—
MARSH OR MUSKEG	—
MINES	⊙

NOTES

This Map Is Not To Be Used
FOR SURVEY PURPOSES

400' Surface rights reservation around all lakes
& rivers.

Original shoreline shown thus: —
F.R.I. shoreline shown thus: —

Lots 1,2,3,4,5 in the GORE attached to
SOUTH SHERBROOKE by Proclamation 1st May
1865. See P.L.S.W. Beattys' plan of this GORE

For status of Islands in this Township please
contact Dept. of Lands & Forests

DATE OF ISSUE

JUL 13 1972

ONT. DEPT. OF MINES
AND NORTHERN AFFAIRS

PLAN NO. - **M. 151**

ONTARIO
DEPARTMENT OF MINES
AND NORTHERN AFFAIRS

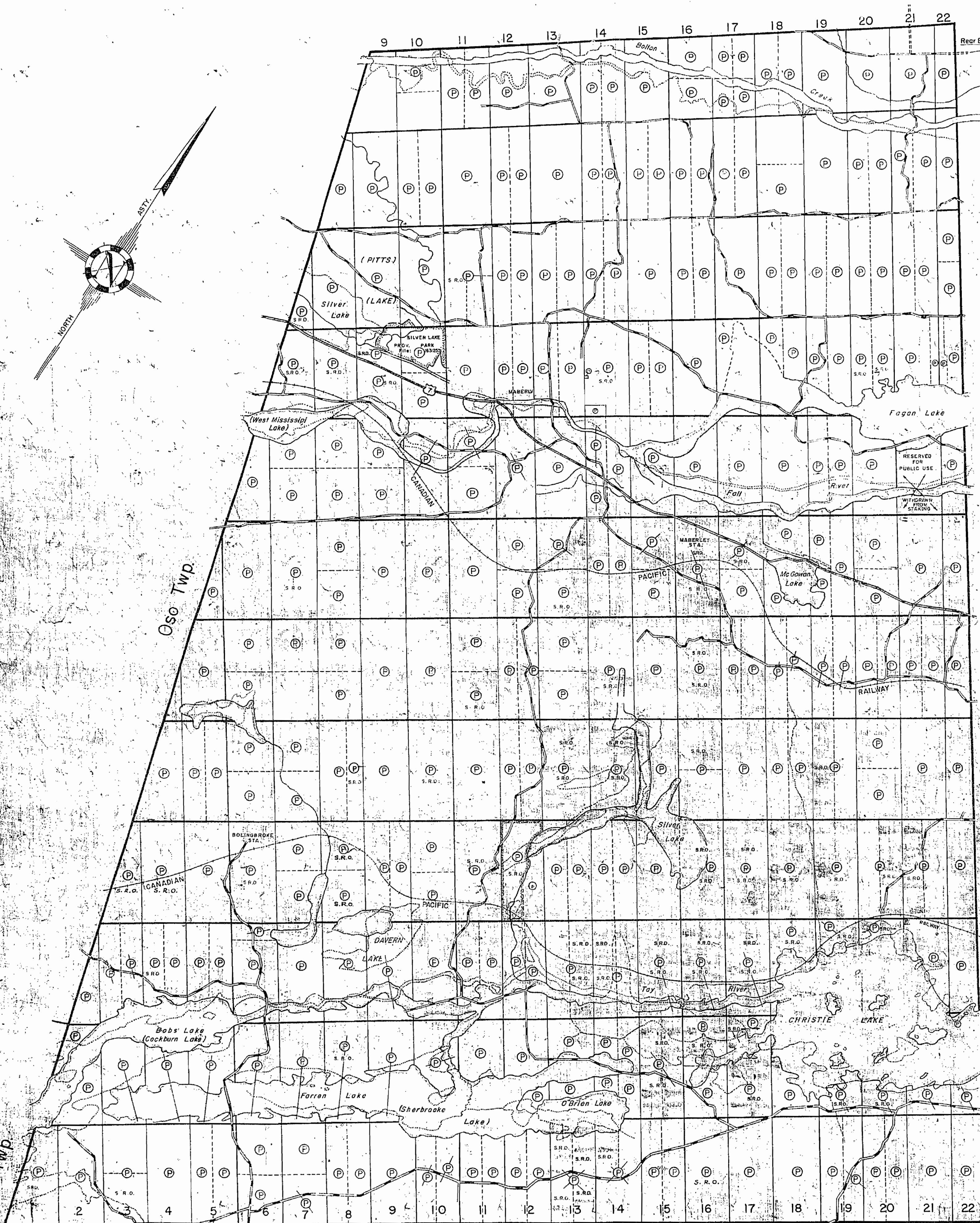
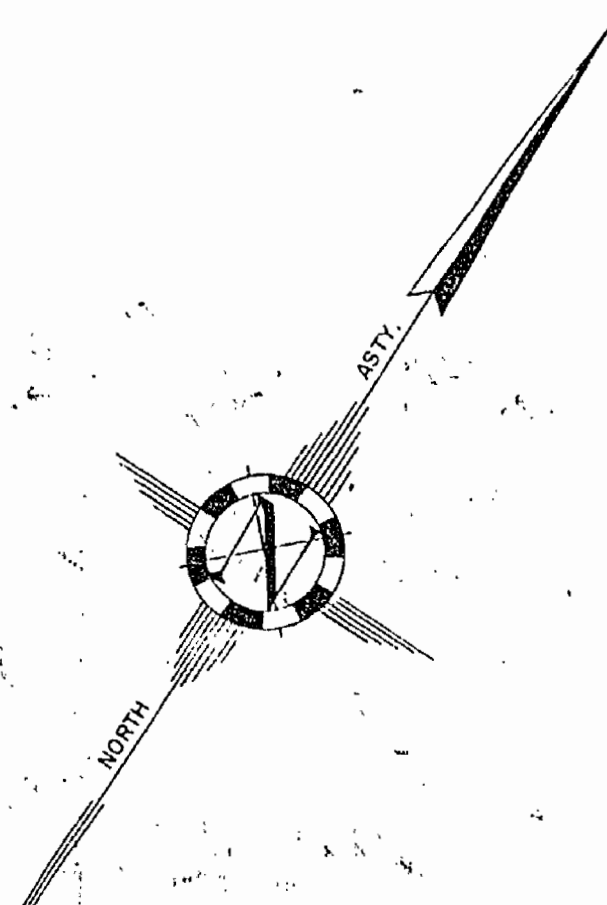

5 4 3 2 1 GORE A 2 1 2 3 4 5 6 7 8 9 10 11 12 13 14 15 16 17 18 19 20 21 22

North Crosby Twp.

Bedford Twp.

Oso Twp.

Bathurst Twp.

XII

XI

X

IX

VIII

VII

VI

V

IV

III

II

I

North Sherbrooke Twp.











Dalhousie Twp.

THE TOWNSHIP
OF
SOUTH SHERBROOKE
COUNTY OF
LANARK

EASTERN ONTARIO
MINING DIVISION

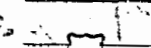
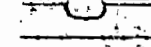
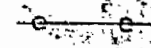
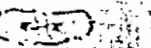
SCALE: 1-INCH = 40 CHAINS

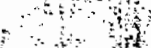
LEGEND

- PATENTED LAND 
- CROWN LAND SALE 
- LEASES 
- LOCATED LAND 
- LICENSE OF OCCUPATION 
- MINING RIGHTS ONLY 
- SURFACE RIGHTS ONLY 
- ROADS 
- IMPROVED ROADS 
- KINGS HIGHWAYS 
- RAILWAYS 
- POWER LINES 
- MARSH OR MUSKEG 
- MINES 

NOTES

This Map Is Not To Be Used
FOR SURVEY PURPOSES

400' Surface rights reservation around all lakes
& rivers

Original shoreline shown thus:
F.R.I. shoreline shown thus:

Lots 1, 2, 3, 4, 5 in the GORE attached to
SOUTH SHERBROOKE by Proclamation 1st May
1865. See P.L.S. W. Beatty's plan of this GORE.

For status of Islands in this Township please
contact Dept. of Lands & Forests

MINING LANDS
DATE OF ISSUE
NOV 19 1975
MINISTRY
OF NATURAL RESOURCES

PLAN NO. M. 151

ONTARIO
MINISTRY OF NATURAL RESOURCES
SURVEYS AND MAPPING BRANCH

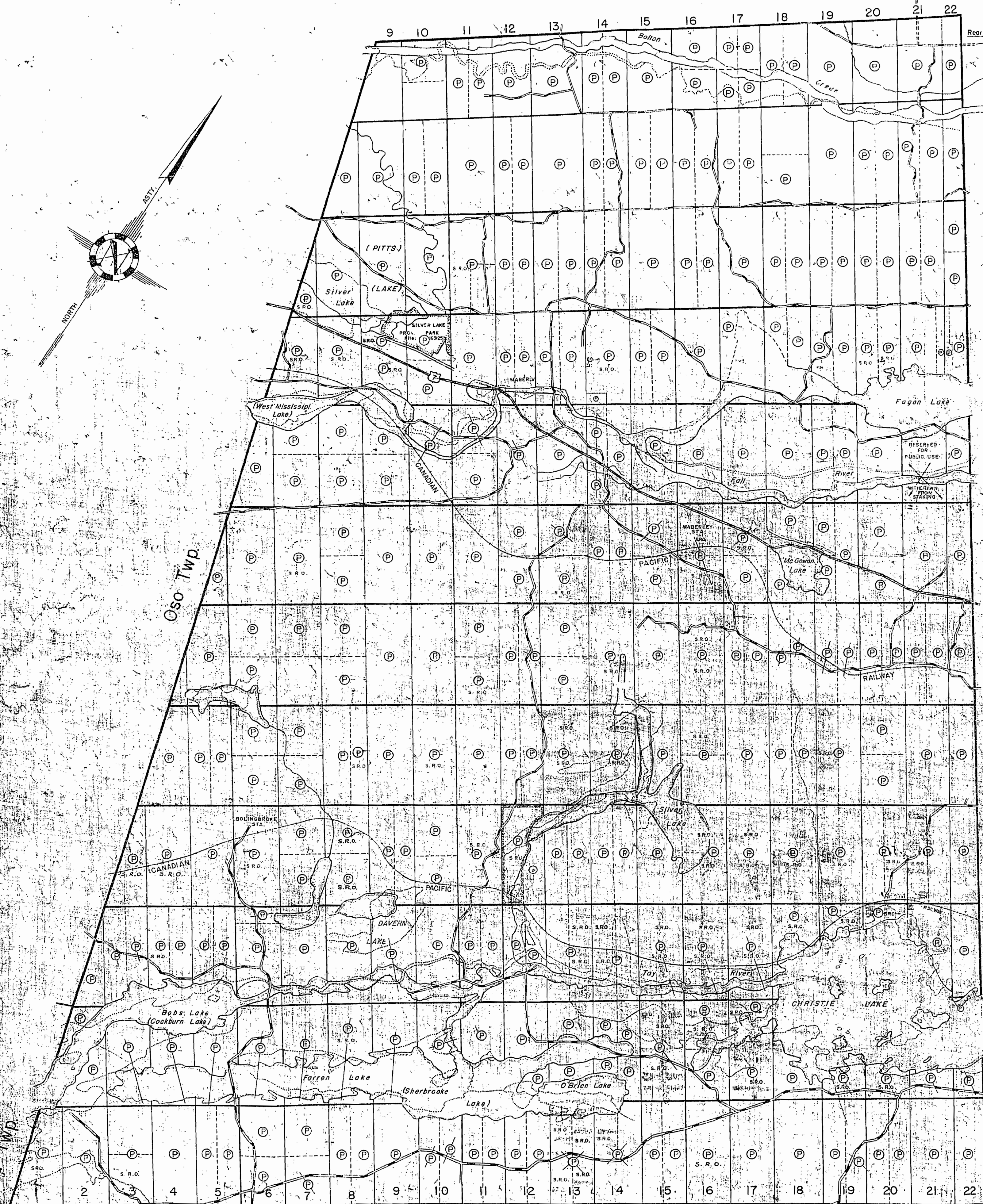
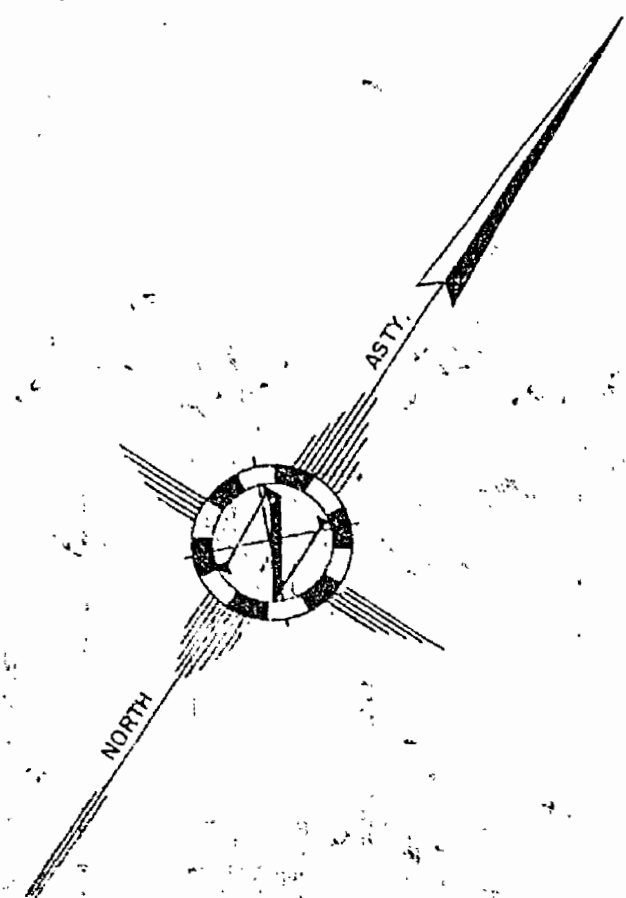

XII
XI
X
IX
VIII
VII
VI
V
IV
III
II
I

5 4 3 2 1
GORE A
3 2 1

North Crosby Twp.

Bedford Twp.

Oso Twp.

Bathurst Twp.

North Sherbrooke Twp.

Dalhousie Twp.

THE TOWNSHIP
OF
SOUTH SHERBROOKE
COUNTY OF
LANARK

EASTERN ONTARIO
MINING DIVISION

SCALE: 1-INCH = 40 CHAINS

LEGEND

PATENTED LAND	⊙
CROWN LAND SALE	⊙
LEASES	⊙
LOCATED LAND	⊙
LICENSE OF OCCUPATION	⊙
MINING RIGHTS ONLY	⊙
SURFACE RIGHTS ONLY	⊙
ROADS	—
IMPROVED ROADS	—
KING'S HIGHWAYS	—
RAILWAYS	—
POWER LINES	—
MARSH OR MUSKES	—
MINES	—

NOTES

This Map is Not To Be Used
FOR SURVEY PURPOSES

400' Surface rights reservation around all lakes
& rivers

Original shoreline shown thus:
F.R.I. shoreline shown thus:

Lots 1, 2, 3, 4, 5 in the GORE attached to
SOUTH SHERBROOKE by Proclamation 1st May
1865. See P.L.S.W. Beatty's plan of this GORE.

For status of Islands in this Township please
contact Dept. of Lands & Forests.

DATE OF ISSUE

MAR - 4 1976

SURVEYS AND MAPPING
BRANCH

PLAN NO. M. 151

ONTARIO
MINISTRY OF NATURAL RESOURCES
SURVEYS AND MAPPING BRANCH

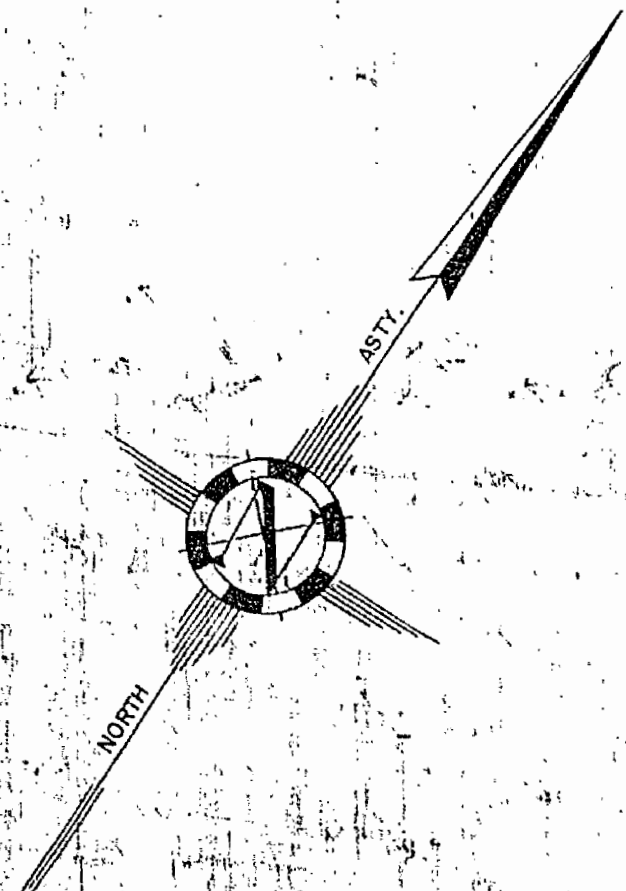

XII

XI

X

IX

VIII

VII

VI

V

IV

III

II

I

Bathurst Twp.

Gso Twp.

Bedford Twp.

North Crosby Twp.

5 4 3 2 1 2 3 4 5 6 7 8 9 10 11 12 13 14 15 16 17 18 19 20 21 22

GORE A 2 1 0

North Sherbrooke Twp.

Dalhousie Twp.

THE TOWNSHIP
OF
SOUTH SHERBROOKE
COUNTY OF
LANARK
M-151
EASTERN ONTARIO
MINING DIVISION

SCALE: 1-INCH = 40 CHAINS

LEGEND

PATENTED LAND	⊙
CROWN LAND SALE	⊙
LEASES	⊙
LOCATED LAND	⊙
LICENSE OF OCCUPATION	L.O.
MINING RIGHTS ONLY	M.R.O.
SURFACE RIGHTS ONLY	S.R.O.
ROADS	—
IMPROVED ROADS	—
KING'S HIGHWAYS	—
RAILWAYS	—
POWER LINES	—
MARSH OR MUSKEG	—
MINES	x

NOTES

This Map Is Not To Be Used FOR SURVEY PURPOSES

400' S.W. Corner of this reservation around all lakes & rivers

Original shoreline shown thus: —
F.R.I. shoreline shown thus: —

Lots 1, 2, 3, 4, 5 in the GORE attached to SOUTH SHERBROOKE by Proclamation 1st May 1865. See P.L.S.W. Beatty's plan of this GORE.

For status of Islands in this Township please contact Dept. of Lands & Forests.

DATE OF ISSUE

SEP 25 1981

SURVEYS AND MAPPING
BRANCH

PLAN NO. - **M. 151**

ONTARIO
MINISTRY OF NATURAL RESOURCES
SURVEYS AND MAPPING BRANCH

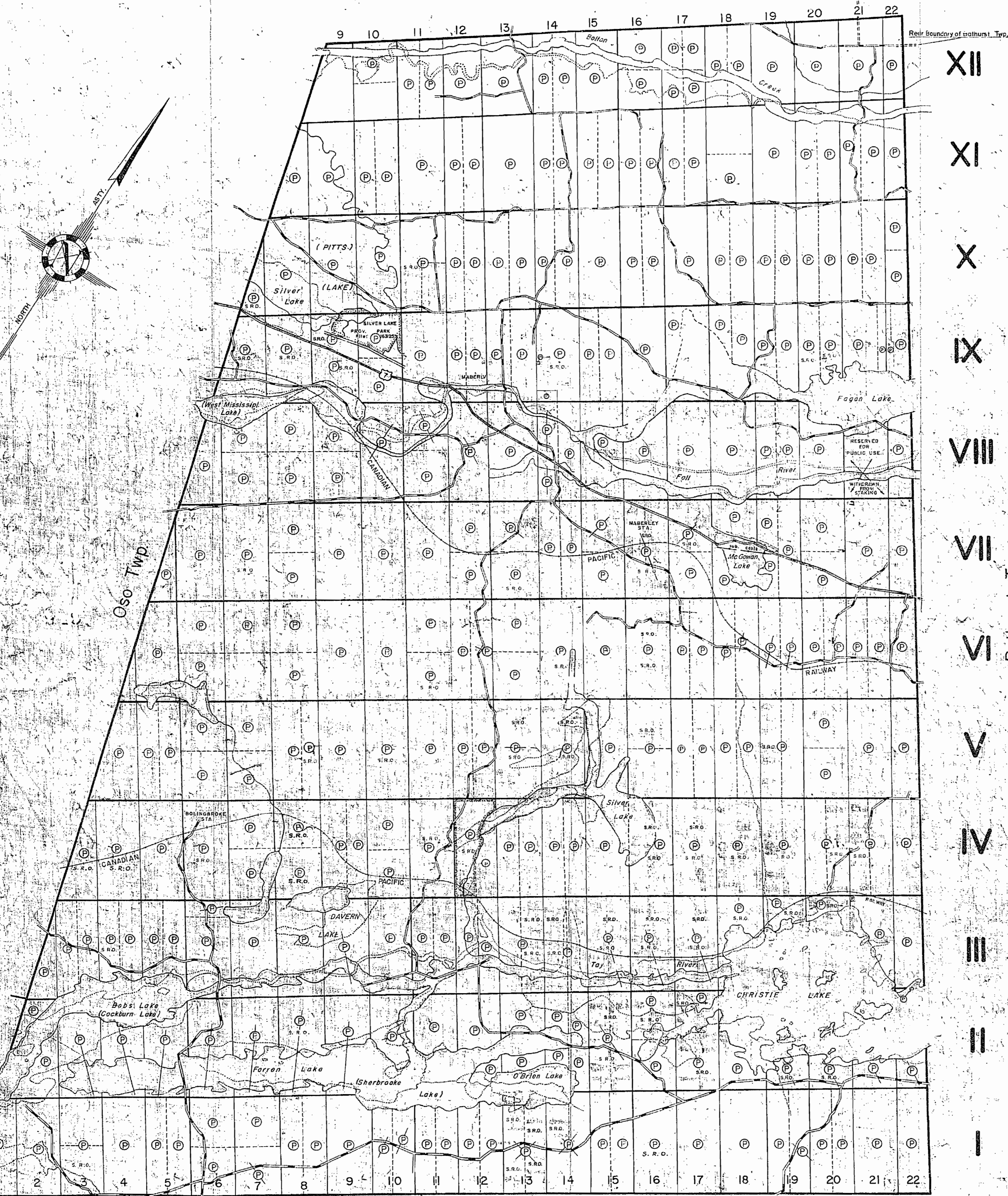
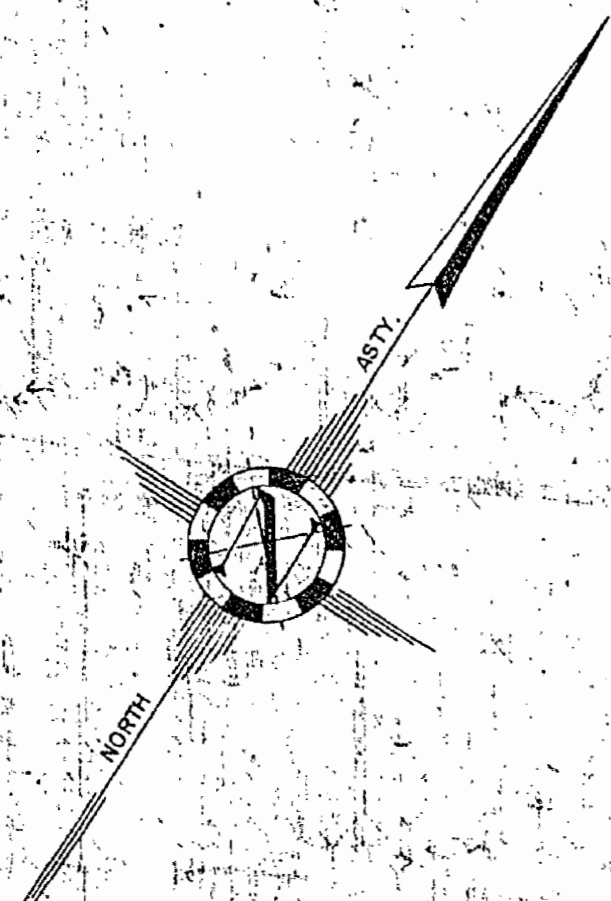

Bedford Twp.

Oso Twp.

Bathurst Twp.

North Crosby Twp.

GORE A

5 4 3 2 1

5 4 3 2 1

North Sherbrooke Twp.

Dalhousie Twp.

D.M. THE TOWNSHIP OF
LANARK OF M-151
SOUTH SHERBROOKE
COUNTY OF LANARK

EASTERN ONTARIO
MINING DIVISION

SCALE: 1-INCH = 40 CHAINS

LEGEND

PATENTED LAND	Ⓟ
CROWN LAND SALE	C.S.
LEASES	Ⓛ
LOCATED LAND	Ⓛ
LICENSE OF OCCUPATION	L.O.
MINING RIGHTS ONLY	M.R.O.
SURFACE RIGHTS ONLY	S.R.O.
ROADS	—
IMPROVED ROADS	—
KING'S HIGHWAYS	—
RAILWAYS	—
POWER LINES	—
MARSH OR MUSKOG	—
MINES	—

NOTES

This Map is Not To Be Used
FOR SURVEY PURPOSES

400' Surface rights reservation around all lakes & rivers

Original shoreline shown thus: —
F.R.I. shoreline shown thus: —

Lots 1, 2, 3, 4, 5 in the GORE attached to
SOUTH SHERBROOKE by Proclamation 1st May
1865. See P.L.S.W. Beatty's plan of this GORE.

For status of islands in this township please
contact Dept. of Lands & Forests.

DATE OF ISSUE
JUL 26 1982
Ministry of Natural Resources
TORONTO

PLAN NO. M. 151

ONTARIO
MINISTRY OF NATURAL RESOURCES
SURVEYS AND MINING BRANCH

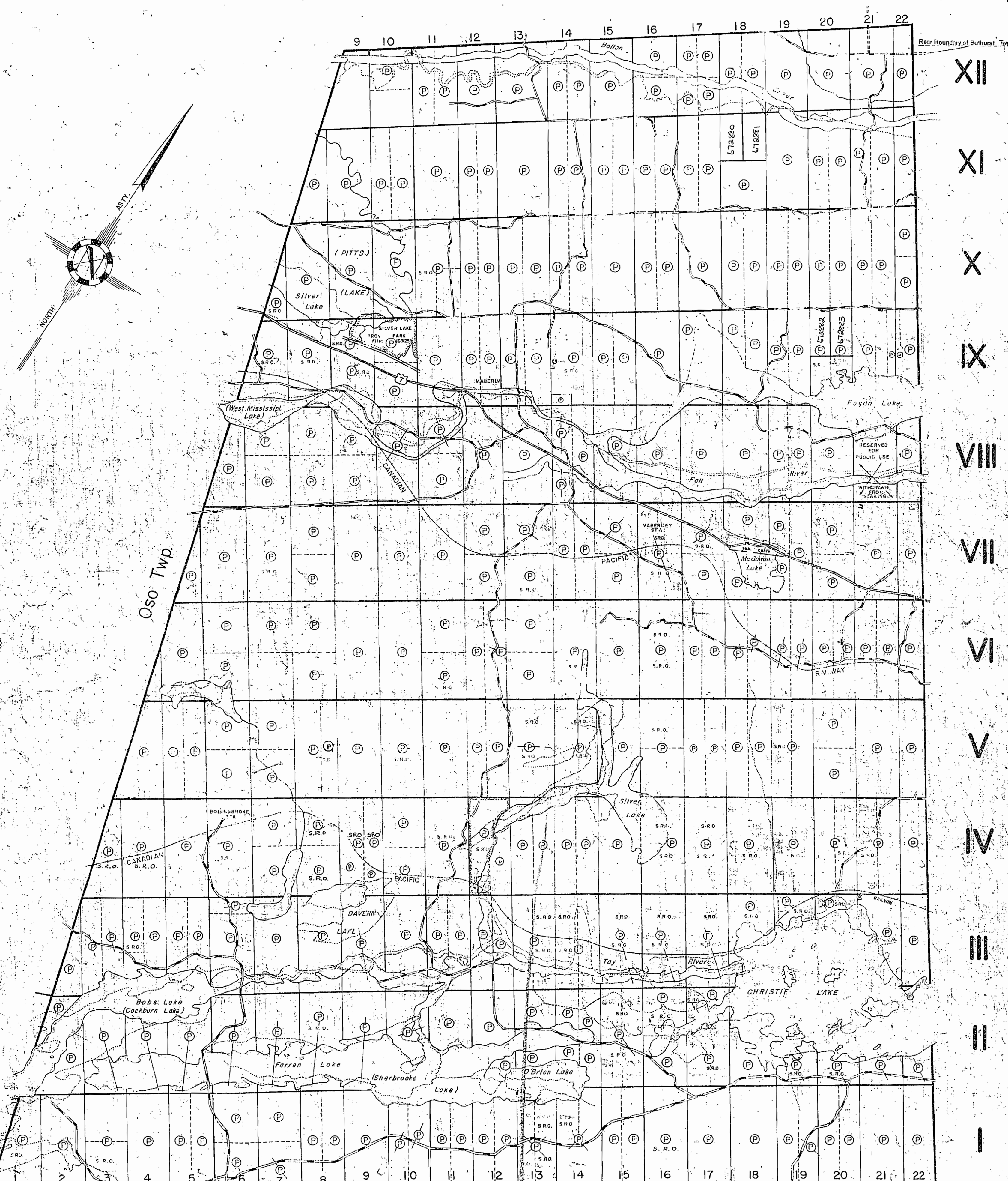

Beaford Twp.

Oso Twp.

Bathurst Twp.

North Crosby Twp.

121.M

SOUTH SHERBROOKE TWP.

121.M

121.M

SOUTH SHERBROOKE TWP.

121.M

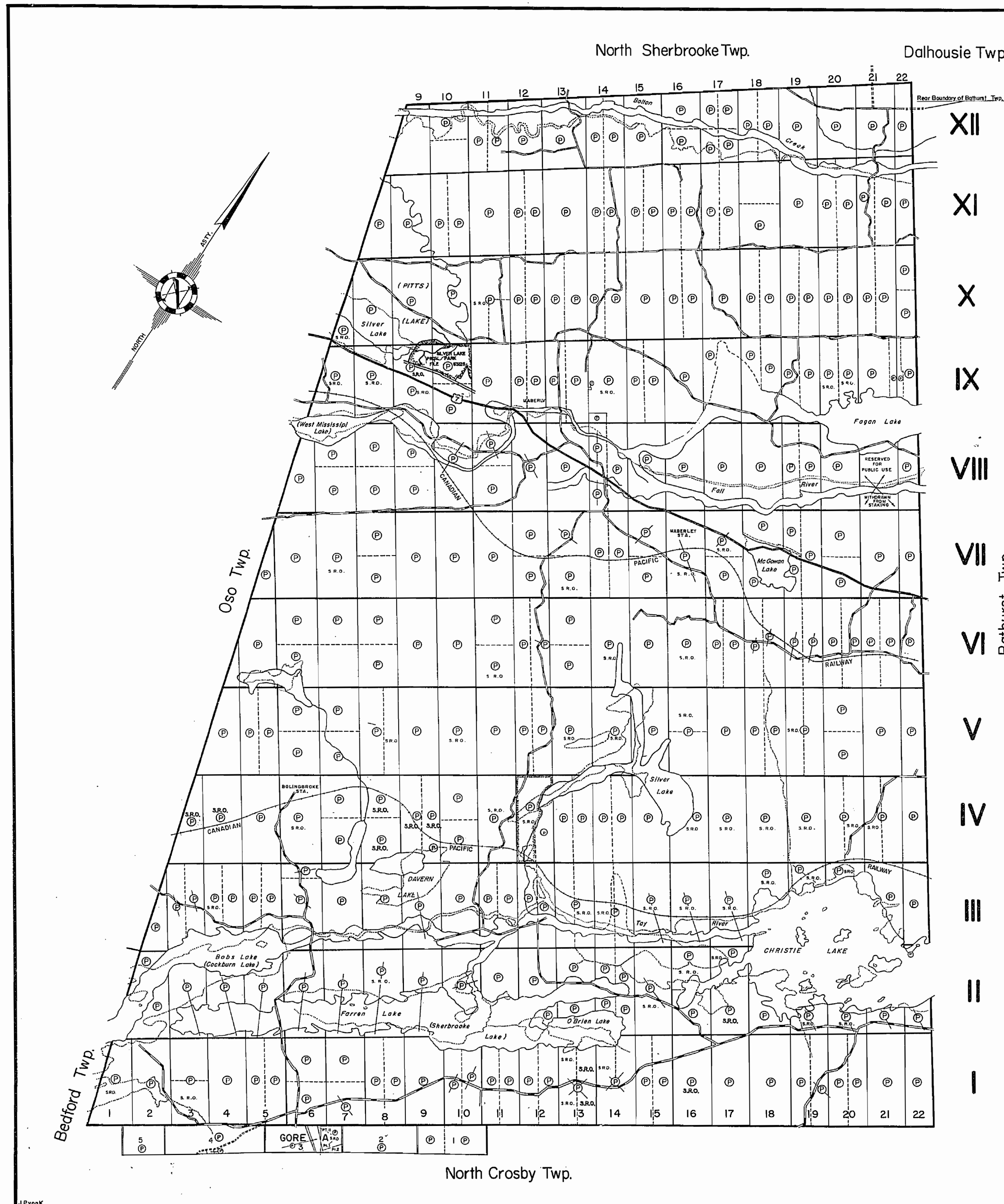

THE TOWNSHIP
OF
SOUTH SHERBROOKE
COUNTY OF
LANARK

EASTERN ONTARIO
MINING DIVISION
SCALE: 1-INCH = 40 CHAINS

LEGEND

PATENTED LAND	⊙
CROWN LAND SALE	C.S.
LEASES	⊙
LOCATED LAND	Loc.
LICENSE OF OCCUPATION	L.O.
MINING RIGHTS ONLY	M.R.O.
SURFACE RIGHTS ONLY	S.R.O.
ROADS	—
IMPROVED ROADS	—
KING'S HIGHWAYS	—
RAILWAYS	—
POWER LINES	—
MARSH OR MUSKEG	—
MINES	—

NOTES

This Map is Not To Be Used
FOR SURVEY PURPOSES

400' Reserve around all Lakes and Rivers
to Dept. of Lands & Forests.

Original shoreline shown thus: —
F.R.I. shoreline shown thus: —

Lots 1,2,3,4,5 in the GORE attached to
SOUTH SHERBROOKE by Proclamation 1st May
1865. See P.L.S. W. Beattys plan of this GORE.

For status of Islands in Christie Lake please
contact Dept. of Lands & Forests.

THE INFORMATION THAT
APPEARS ON THIS MAP
HAS BEEN COMPILED
FROM VARIOUS SOURCES,
AND ACCURACY IS NOT
GUARANTEED. THOSE
WISHING TO MAKE MINING
CLAIMS SHOULD CONSULT
WITH THE MINING
RECORDER, MINISTRY OF
NORTHERN DEVELOPMENT
AND MINES, FOR ADDITIONAL
INFORMATION ON THE STATUS OF THE
LANDS SHOWN HEREON.

RES. GEO. TWEED

PLAN NO. **M. 151**

DEPARTMENT OF MINES
— ONTARIO —