

INGRAM TWP

INGRAM TWP

EVANTRIJEL

Replaced July 21, 1961

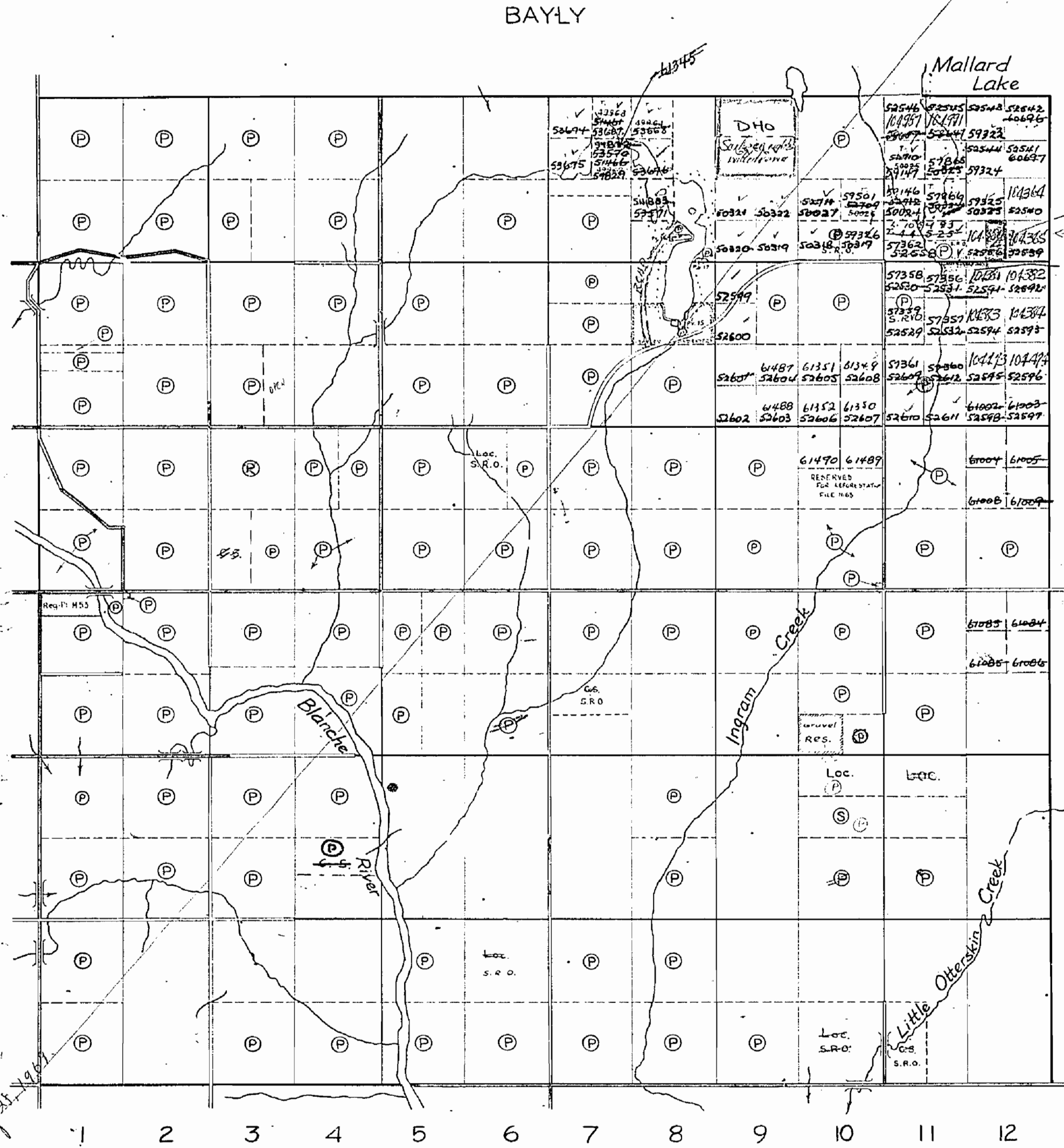

VI
V
IV
III
II
I

PENSE

THE TOWNSHIP
OF
INGRAM
DISTRICT OF TIMISKAMING
TIMISKAMING MINING
DIVISION
SCALE: 1 INCH TO 40 CHAINS

LEGEND

PATENTED LAND	Ⓟ
CROWN LAND SALE	C.S. or Ⓞ
LOCATED LAND	Loc.
LICENSE OF OCCUPATION	L.O.
IMPROVED ROADS	—
ROADS	—
RESERVED FOR GRAVEL	RES.
LEASES	L
MINING RIGHTS ONLY	M.R.O.
SURFACE RIGHTS ONLY	S.R.O.
CANCELLED	C

NOTES

100' Rsvd to Dept. of L.R.A.
shown thus: —

AREA SHOWN "SURFACE RIGHTS ONLY
RESERVED" Sec. 39(d) of the Mining Act.
File: 15730.

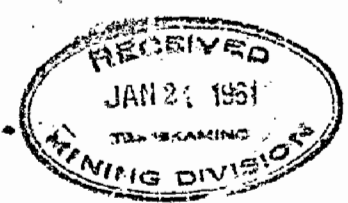

M-511

DEPARTMENT OF MINES
— ONTARIO —

INGRAM TWP

BAYLY

Mallard Lake

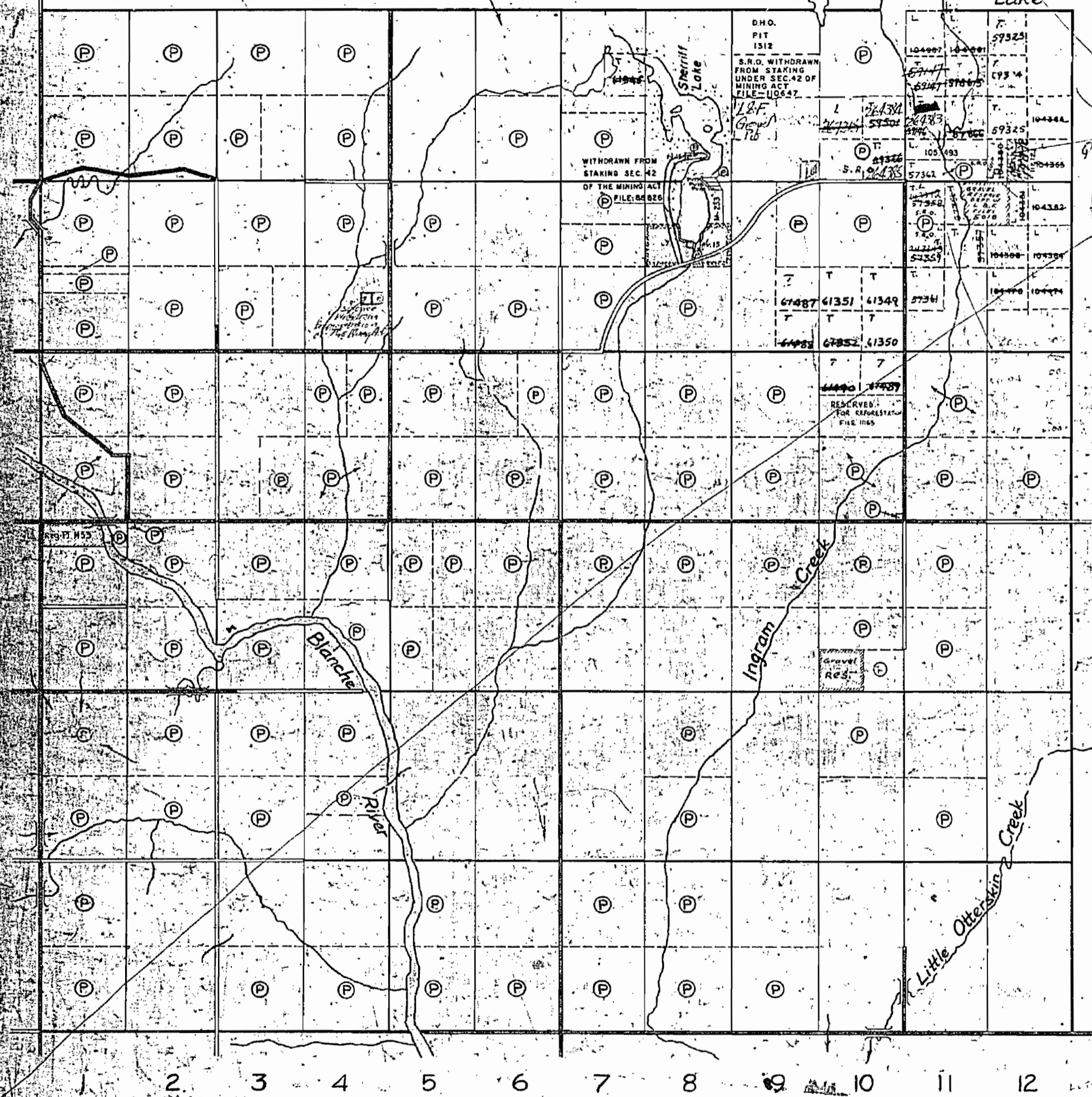

THE TOWNSHIP
OF
INGRAM
DISTRICT OF TIMISKAMING
LARDER LAKE MINING
DIVISION
SCALE: 1 INCH TO 40 CHAINS

LEGEND

- PATENTED LAND (P)
- CROWN LAND SALE C.S. or (S)
- LOCATED LAND Loc.
- LICENSE OF OCCUPATION L.O.
- IMPROVED ROADS ———
- ROADS ———
- RESERVED FOR GRAVEL RES.
- LEASES (L)
- MINING RIGHTS ONLY M.R.O.
- SURFACE RIGHTS ONLY S.R.O.
- CANCELLED C.

NOTES

400' Surface - Rights' Reservation around all Lakes and Rivers.

AREA SHOWN SURFACE RIGHTS ONLY RESERVED Sec. 39(d) of the Mining Act File: 15730.

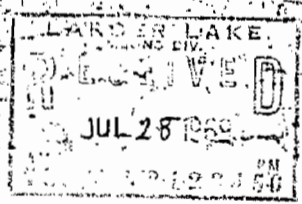

M 511

DEPARTMENT OF MINES
— ONTARIO —

EVANTRUDEL

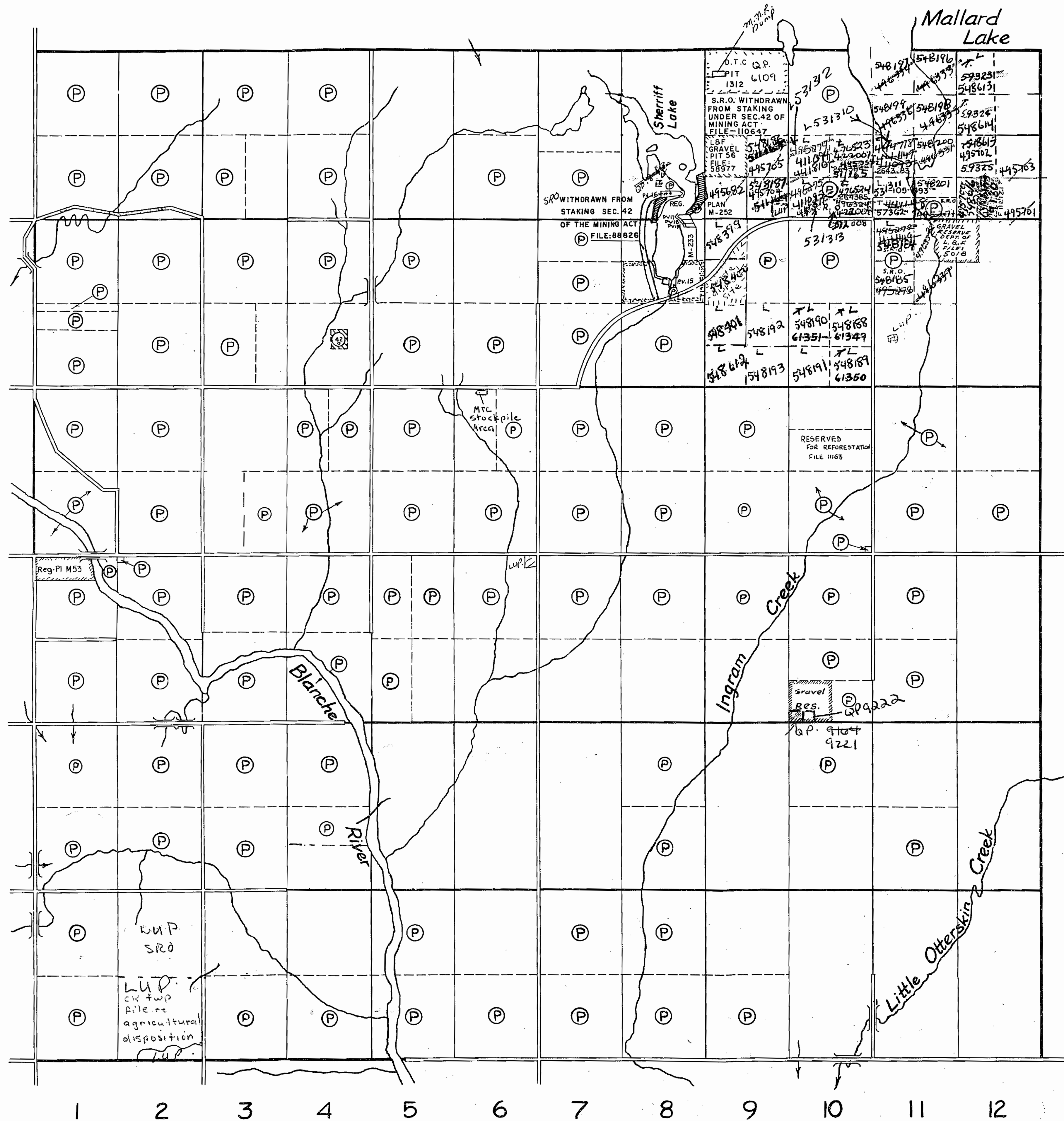

BAYLY

HILLIARD

VI

V

IV

III

II

I

PENSE

THE TOWNSHIP
OF
INGRAM
M511
DISTRICT OF TIMISKAMING
LARDER LAKE MINING
DIVISION
SCALE: 1 INCH TO 40 CHAINS

LEGEND

PATENTED LAND	Ⓟ
CROWN LAND SALE	C.S. or Ⓞ
LOCATED LAND	Loc.
LICENSE OF OCCUPATION	L.O.
IMPROVED ROADS	==
ROADS	---
RESERVED FOR GRAVEL	RES.
LEASES	L
MINING RIGHTS ONLY	M.R.O.
SURFACE RIGHTS ONLY	S.R.O.
CANCELLED	C.

NOTES

400' Surface Rights Reservation around all Lakes and Rivers.

AREA SHOWN "SURFACE RIGHTS ONLY RESERVED" Sec. 39(d) of the Mining Act. File: 15730.

Areas withdrawn from staking under Section 42 of the Mining Act.

File	Date	Disposition
②	1970	S.R.O.

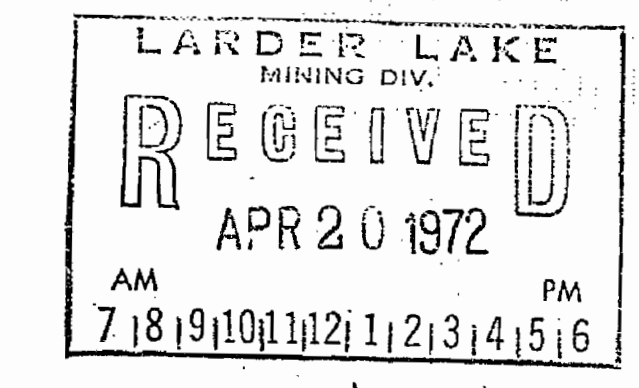

SRO - withdrawn waste disposal site - NRWIS/79

*Revised by Msh
Feb 7/80*

M.511 #1

**ONTARIO
DEPARTMENT OF MINES
AND NORTHERN AFFAIRS**

W.211

9WT
MARBNI

W.211

W.211

INGRAM
LWR

W.211

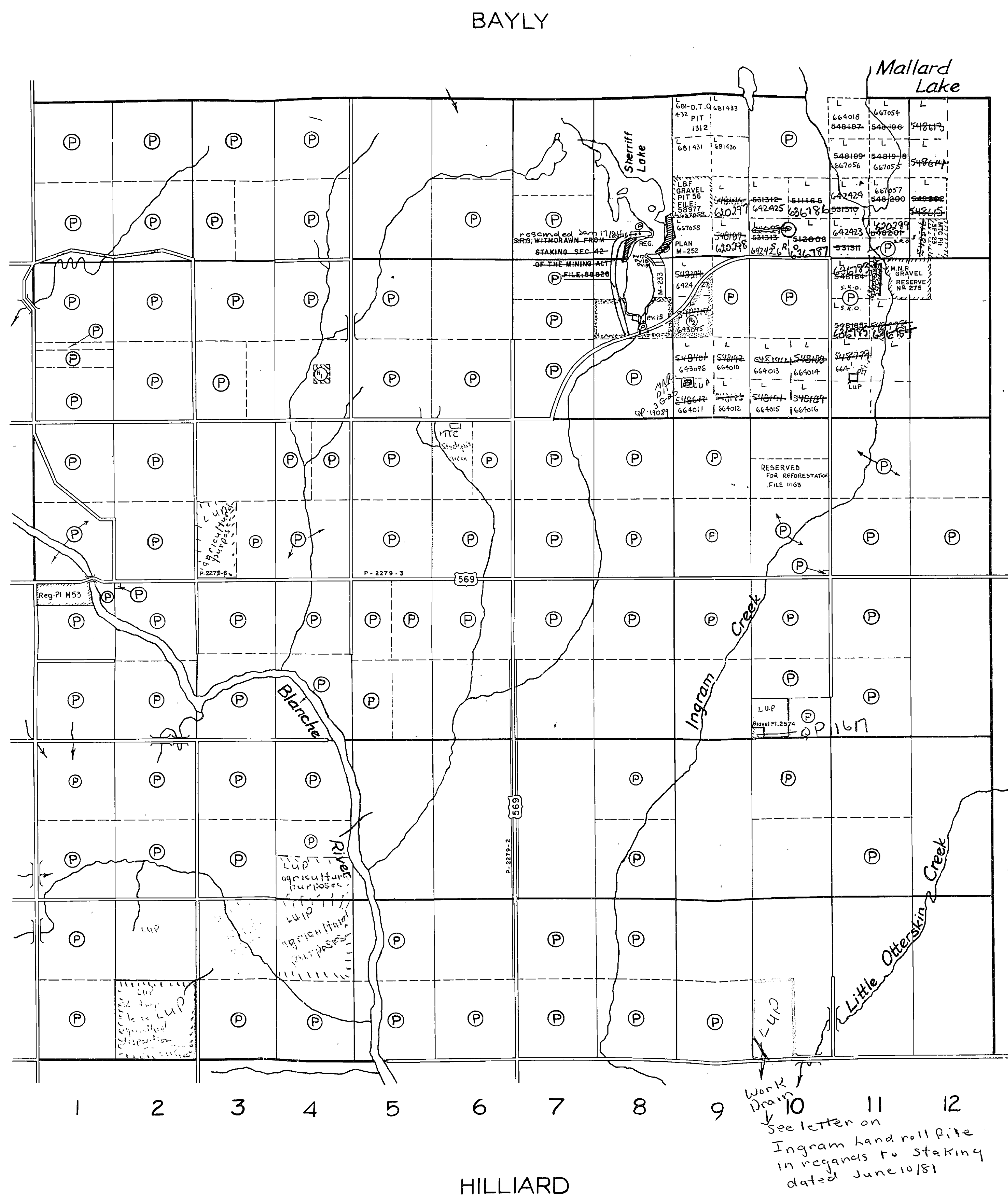

THE TOWNSHIP
OF
INGRAM
DISTRICT OF TIMISKAMING
LARDER LAKE MINING
DIVISION
SCALE: 1 INCH TO 40 CHAINS

LEGEND

PATENTED LAND.....	Ⓟ
CROWN LAND SALE.....	C.S. or Ⓢ
LOCATED LAND.....	Loc.
LICENSE OF OCCUPATION.....	L.O.
IMPROVED ROADS.....	==
ROADS.....	---
RESERVED FOR GRAVEL.....	RES.
LEASES.....	Ⓛ
MINING RIGHTS ONLY.....	M.R.O.
SURFACE RIGHTS ONLY.....	S.R.O.
CANCELLED.....	C.

NOTES

400' Surface Rights Reservation around all Lakes and Rivers.

AREA SHOWN "SURFACE RIGHTS ONLY RESERVED" Sec 39(d) of the Mining Act. File 18730. Rescinded Feb 10/84

Areas withdrawn from staking under Section 43 of the Mining Act. (R.S.O. 1970).

Order No.	File	Date	Disposition
NR.W.18/79	23162	1970	S.R.O.
		20/2/79	S.R.O.

Replaced July 30/84

M.511

ONTARIO #1
MINISTRY OF NATURAL RESOURCES
SURVEYS AND MAPPING BRANCH

JH

BAYLY

Mallard Lake

EVANTRUJEL

PENSE

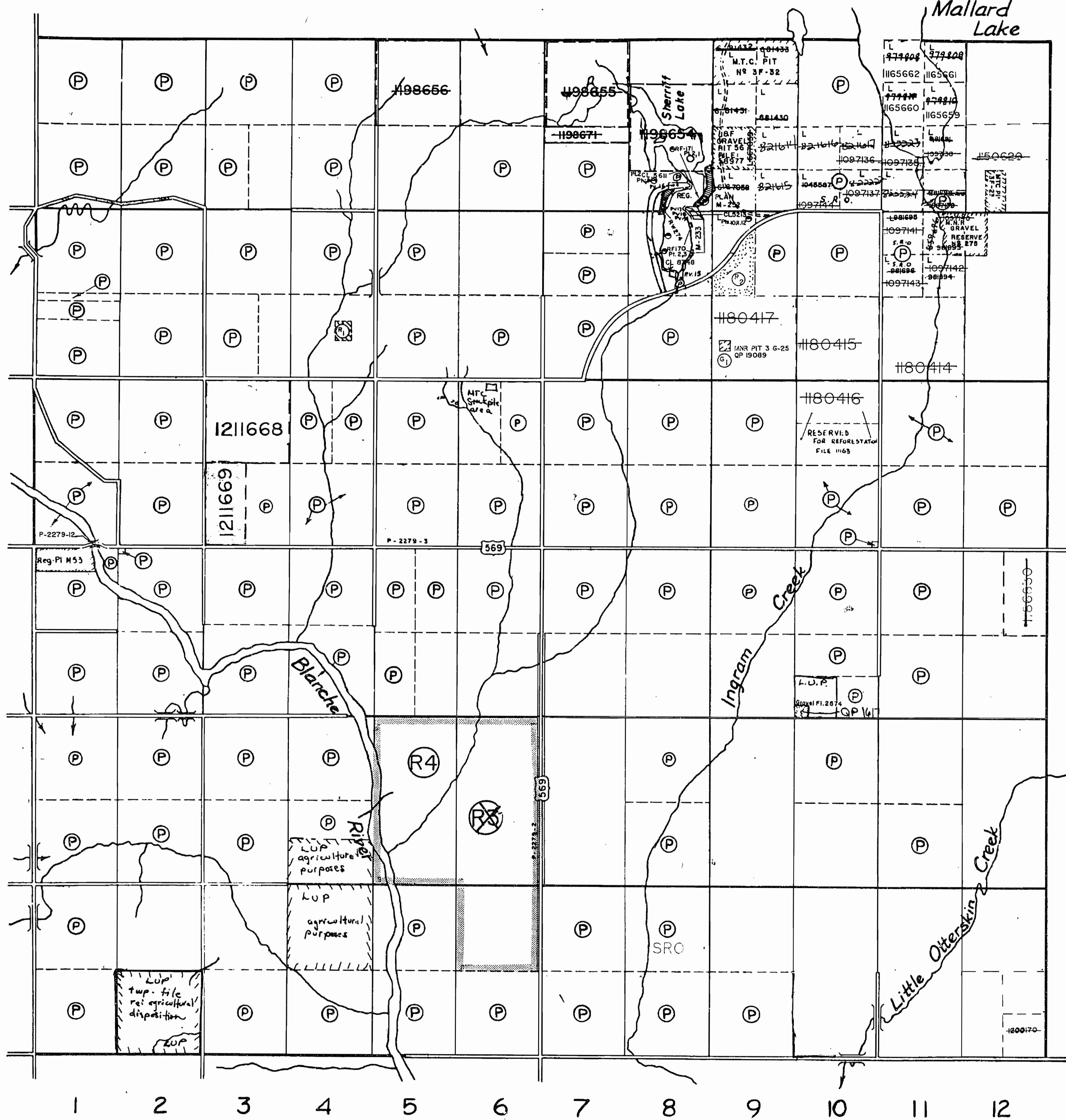

NOTICE OF FORESTRY ACTIVITY
 THIS TOWNSHIP / AREA FALLS WITHIN THE _____
 TIMISKAMING MANAGEMENT UNIT
 AND MAY BE SUBJECT TO FORESTRY OPERATIONS.
 THE MNR UNIT FORESTER FOR THIS AREA CAN BE
 CONTACTED AT: P.O. BOX 129
 SWASTIKA, ONT.
 POK ITO
 705-642-3222

HILLIARD

CIRCULATED AUG. 12, 1992 B.R.B.

LEGEND

- HIGHWAY AND ROUTE No.
- OTHER ROADS
- TRAILS
- SURVEYED LINES:
 TOWNSHIPS, BASE LINES, ETC.
- LOTS, MINING CLAIMS, PARCELS, ETC.
- UNSURVEYED LINES:
 LOT LINES
- PARCEL BOUNDARY
- MINING CLAIMS ETC.
- RAILWAY AND RIGHT OF WAY
- UTILITY LINES
- NON-PERENNIAL STREAM
- FLOODING OR FLOODING RIGHTS
- SUBDIVISION OR COMPOSITE PLAN
- RESERVATIONS
- ORIGINAL SHORELINE
- MARSH OR MUSKEG
- MINES
- TRAVERSE MONUMENT

DISPOSITION OF CROWN LANDS

TYPE OF DOCUMENT	SYMBOL
PATENT, SURFACE & MINING RIGHTS	
" SURFACE RIGHTS ONLY	
" MINING RIGHTS ONLY	
LEASE, SURFACE & MINING RIGHTS	
" SURFACE RIGHTS ONLY	
" MINING RIGHTS ONLY	
LICENCE OF OCCUPATION	
ORDER-IN-COUNCIL	
RESERVATION	
CANCELLED	
SAND & GRAVEL	

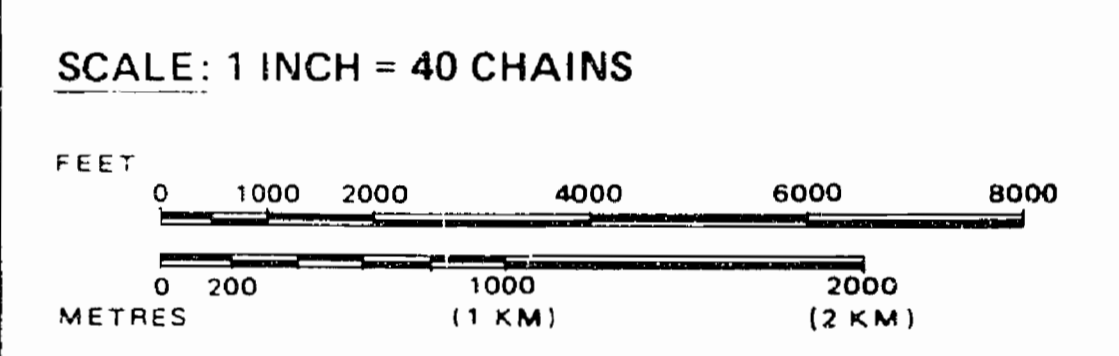

AREAS WITHDRAWN FROM DISPOSITION

M.R.O. - MINING RIGHTS ONLY
 S.R.O. - SURFACE RIGHTS ONLY
 M.+S. - MINING AND SURFACE RIGHTS

Description	Order No.	Date	Disposition	File
(1)		1970	S.R.O.	
(2)	NR.W.18/79	20/2/79	S.R.O.	
(3)	W.L. 46/95 NER	06/04/98	M.S.	
(4)	O-L-15/95 NER	95/06/27	REOPENS W-L-16/95 NER	
	W-L. 46/95 NER	95/06/27	S.R.O.	
SAND and GRAVEL				
(5)	MNR GRAVEL RESERVE 3 G-25			

TOWNSHIP
INGRAM
 DATE OF ISSUE
 APR 23 1998
 M.N.R. ADMINISTRATIVE DISTRICT
 TIMISKAMING
 MINING DIVISION
 LARDER LAKE
 LAND TITLES / REGISTRY DIVISION
 TIMISKAMING

Ministry of Natural Resources Ontario
 Ministry of Northern Development and Mines

Date _____ Number **G-3653**

THE INFORMATION THAT APPEARS ON THIS MAP HAS BEEN COMPILED FROM VARIOUS SOURCES, AND ACCURACY IS NOT GUARANTEED. THOSE WISHING TO STAKE MINING CLAIMS SHOULD CONSULT WITH THE MINING RECORDER, MINISTRY OF NORTHERN DEVELOPMENT AND MINES, FOR ADDITIONAL INFORMATION ON THE STATUS OF THE LANDS SHOWN HEREON.

geology reference-COBALT

RESIDENT GEO.

BAYLY

Mallard Lake

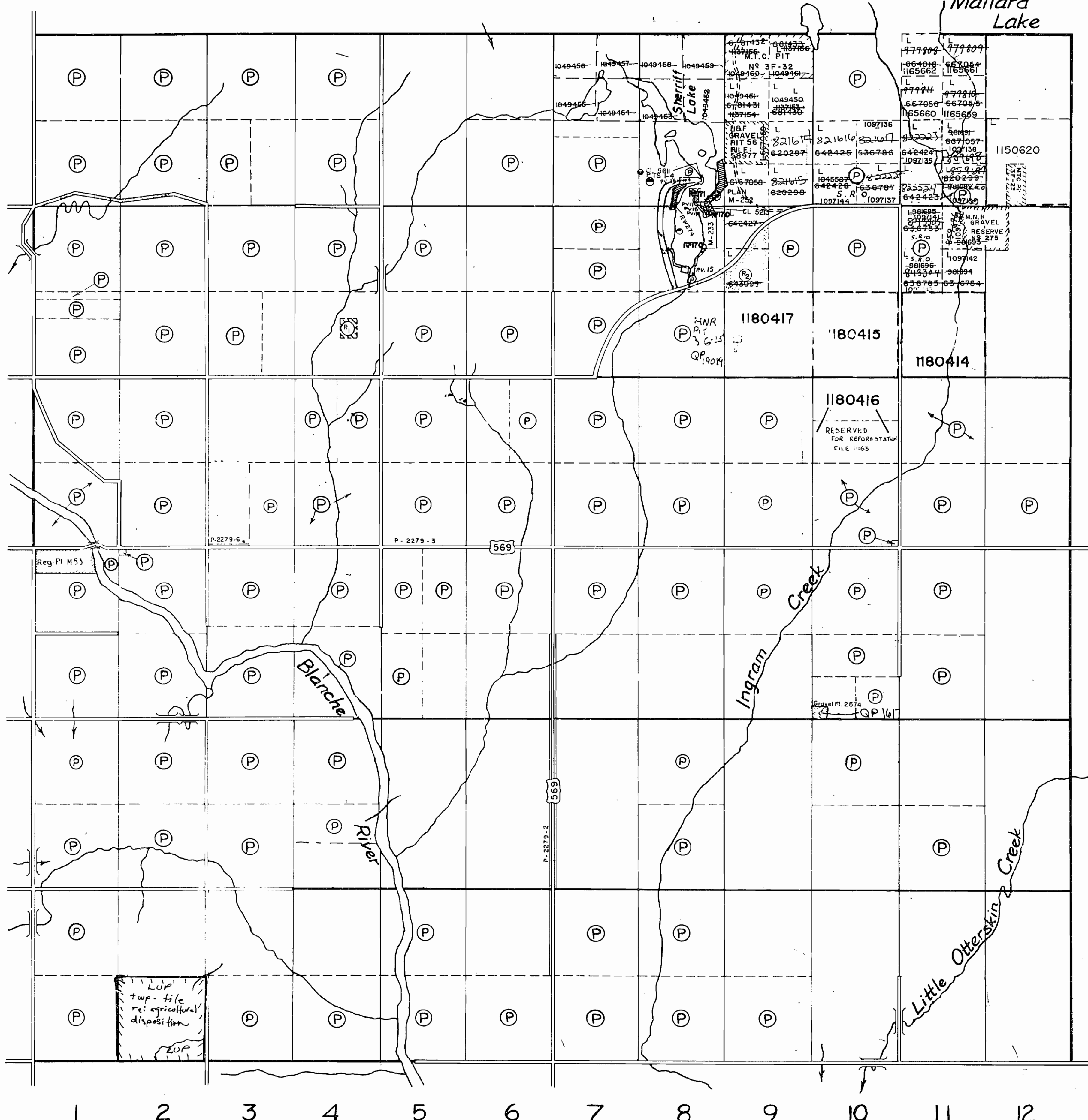

EVANTRUEL

VI
V
IV
III
II
I

PENSE

HILLIARD

REMOVED FROM CIRCULATION
JUNE 1, 1992

THE INFORMATION THAT APPEARS ON THIS MAP HAS BEEN COMPILED FROM VARIOUS SOURCES, AND ACCURACY IS NOT GUARANTEED. THOSE WISHING TO STAKE MINING CLAIMS SHOULD CONSULT WITH THE MINING RECORDER, MINISTRY OF NORTHERN DEVELOPMENT AND MINES, FOR ADDITIONAL INFORMATION ON THE STATUS OF THE LANDS SHOWN HEREON.

THE TOWNSHIP OF

INGRAM

DISTRICT OF TIMISKAMING
LARDER LAKE MINING
DIVISION

SCALE: 1 INCH TO 40 CHAINS

LEGEND

PATENTED LAND.....	(P)
CROWN LAND SALE.....	C.S. (S)
LOCATED LAND.....	Loc.
LICENSE OF OCCUPATION.....	L.O.
IMPROVED ROADS.....	==
ROADS.....	---
RESERVED FOR GRAVEL.....	RES.
LEASES.....	(L)
MINING RIGHTS ONLY.....	M.R.O.
SURFACE RIGHTS ONLY.....	S.R.O.
CANCELLED.....	C.

NOTES

400' Surface Rights Reservation around all Lakes and Rivers.

Areas withdrawn from staking under Section 43 of the Mining Act. (R.S.O. 1970).

Order No.	File	Date	Disposition
(1) NR.W.18/79	23162	20/2/79	S.R.O.
(2)			S.R.O.

SAND and GRAVEL

(1) MNR GRAVEL RESERVE 3 G 25

NOTICE OF FORESTRY ACTIVITY
THIS TOWNSHIP / AREA FALLS WITHIN THE _____
TIMISKAMING MANAGEMENT UNIT
AND MAY BE SUBJECT TO FORESTRY OPERATIONS.
THE MNR UNIT FORESTER FOR THIS AREA CAN BE CONTACTED AT: P.O. BOX 129
SWASTIKA, ONT.
POK ITO
705-642-3222

M.511 #1

ONTARIO
MINISTRY OF NATURAL RESOURCES
SURVEYS AND MAPPING BRANCH

INGRAM
M-511
June 1/92

BAYLY

Mallard Lake

EVANTRUJEL

PENSE

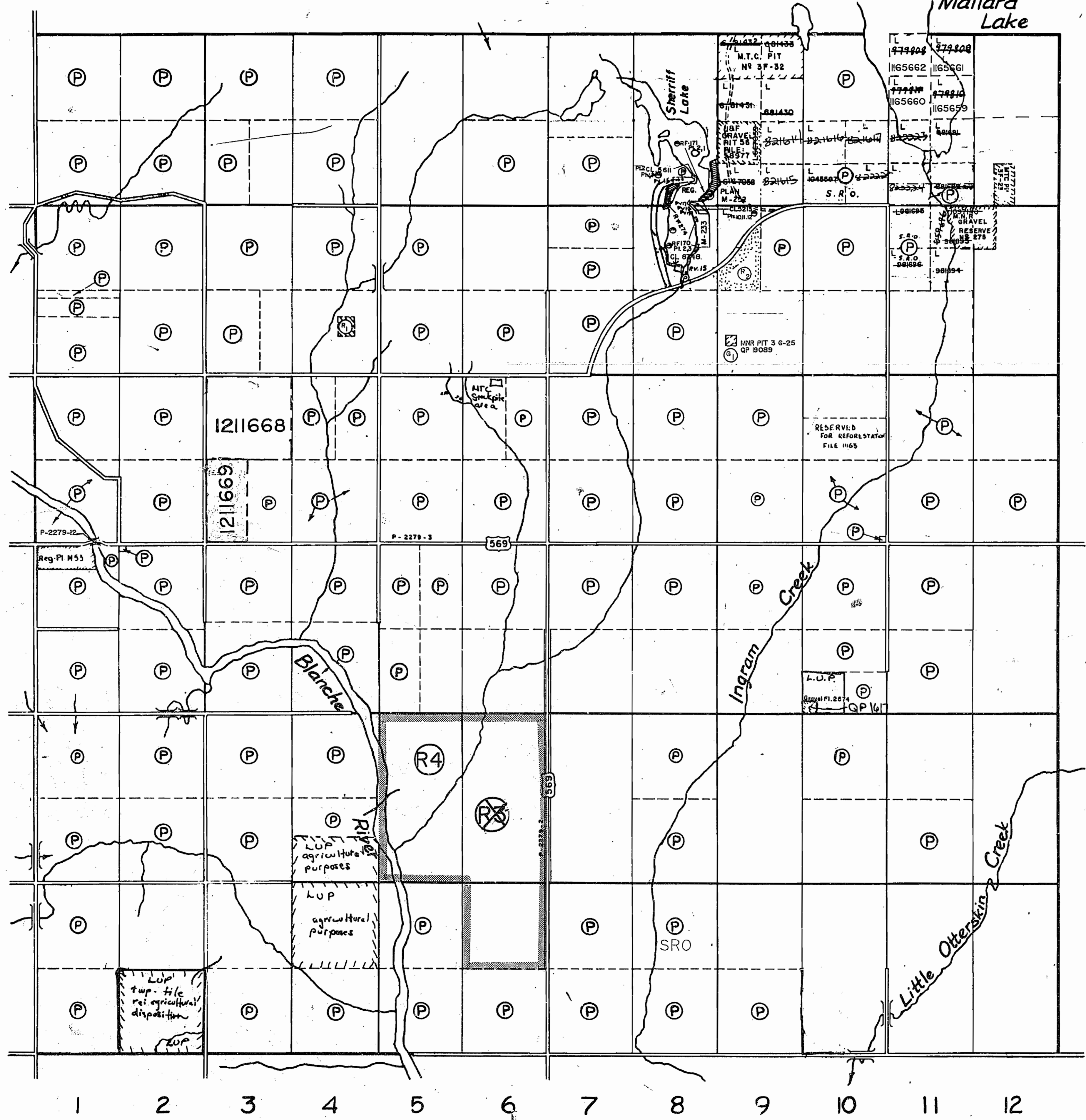

VI

V

IV

III

II

I

HILLIARD

NOTICE OF FORESTRY ACTIVITY
 THIS TOWNSHIP / AREA FALLS WITHIN THE _____
 TIMISKAMING MANAGEMENT UNIT
 AND MAY BE SUBJECT TO FORESTRY OPERATIONS.
 THE MNR UNIT FORESTER FOR THIS AREA CAN BE
 CONTACTED AT: P.O. BOX 129
 SWASTIKA, ONT.
 POK ITO
 705-642-3222

CIRCULATED AUG. 12, 1992 B.R.B.

THE INFORMATION THAT APPEARS ON THIS MAP HAS BEEN COMPILED FROM VARIOUS SOURCES, AND ACCURACY IS NOT GUARANTEED. THOSE WISHING TO STAKE MINING CLAIMS SHOULD CONSULT WITH THE MINING RECORDER, MINISTRY OF NORTHERN DEVELOPMENT AND MINES, FOR ADDITIONAL INFORMATION ON THE STATUS OF THE LANDS SHOWN HEREON.

LEGEND

- HIGHWAY AND ROUTE No.
- OTHER ROADS
- TRAILS
- SURVEYED LINES:
 TOWNSHIPS, BASE LINES, ETC.
- LOTS, MINING CLAIMS, PARCELS, ETC.
- UNSURVEYED LINES:
 LOT LINES
- PARCEL BOUNDARY
- MINING CLAIMS ETC.
- RAILWAY AND RIGHT OF WAY
- UTILITY LINES
- NON-PERENNIAL STREAM
- FLOODING OR FLOODING RIGHTS
- SUBDIVISION OR COMPOSITE PLAN RESERVATIONS
- ORIGINAL SHORELINE
- MARSH OR MUSKEG
- MINES
- TRAVERSE MONUMENT

DISPOSITION OF CROWN LANDS

TYPE OF DOCUMENT	SYMBOL
PATENT, SURFACE & MINING RIGHTS	Ⓟ or ●
" SURFACE RIGHTS ONLY	S.R.O. or ○
" MINING RIGHTS ONLY	Ⓞ
LEASE, SURFACE & MINING RIGHTS	■
" SURFACE RIGHTS ONLY	□
" MINING RIGHTS ONLY	▣
LICENCE OF OCCUPATION	▼
ORDER-IN-COUNCIL	OC
RESERVATION	Ⓢ
CANCELLED	Ⓣ
SAND & GRAVEL	Ⓜ

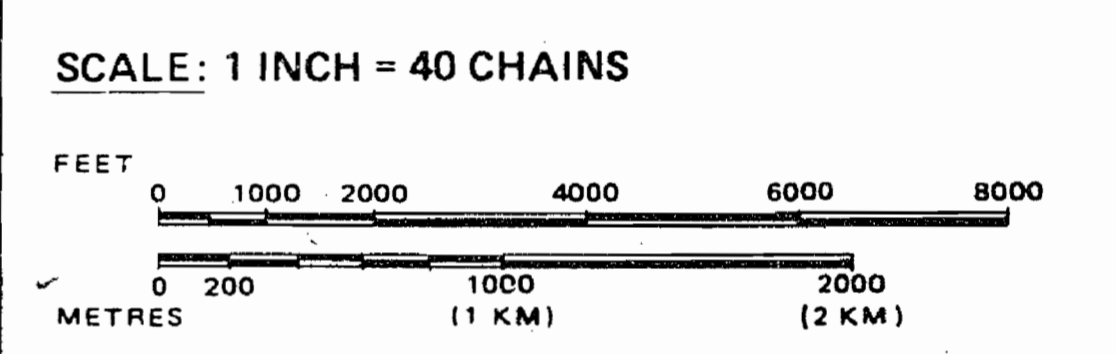

AREAS WITHDRAWN FROM DISPOSITION

M.R.O. - MINING RIGHTS ONLY
 S.R.O. - SURFACE RIGHTS ONLY
 M+S. - MINING AND SURFACE RIGHTS

Description	Order No.	Date	Disposition	File
Ⓢ		1970	S.R.O.	
Ⓞ	NR.W18/79	20/2/79	S.R.O.	
Ⓢ	W-L 16/95 NER 95/06/27		M.S.	
Ⓢ	O-L-15/95 NER 95/06/27		REOPENS W-L-16/95 NER	
Ⓢ	W-L-46/95 NER 95/06/27		S.R.O.	
SAND and GRAVEL				
Ⓜ	MNR GRAVEL RESERVE 3 G-25			

TOWNSHIP
INGRAM
 M.N.R. ADMINISTRATIVE DISTRICT
 TIMISKAMING
 MINING DIVISION
 LARDER LAKE
 LAND TITLES / REGISTRY DIVISION
 TIMISKAMING

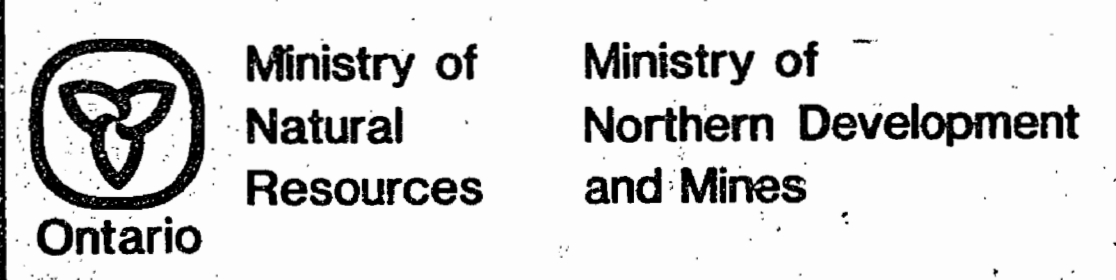

Date _____ Number **G-3653**

W.211

INGRAM MARGUI

112.M

geology reference-COBALT

RESIDENT GEO.

BAYLY

Mallard Lake

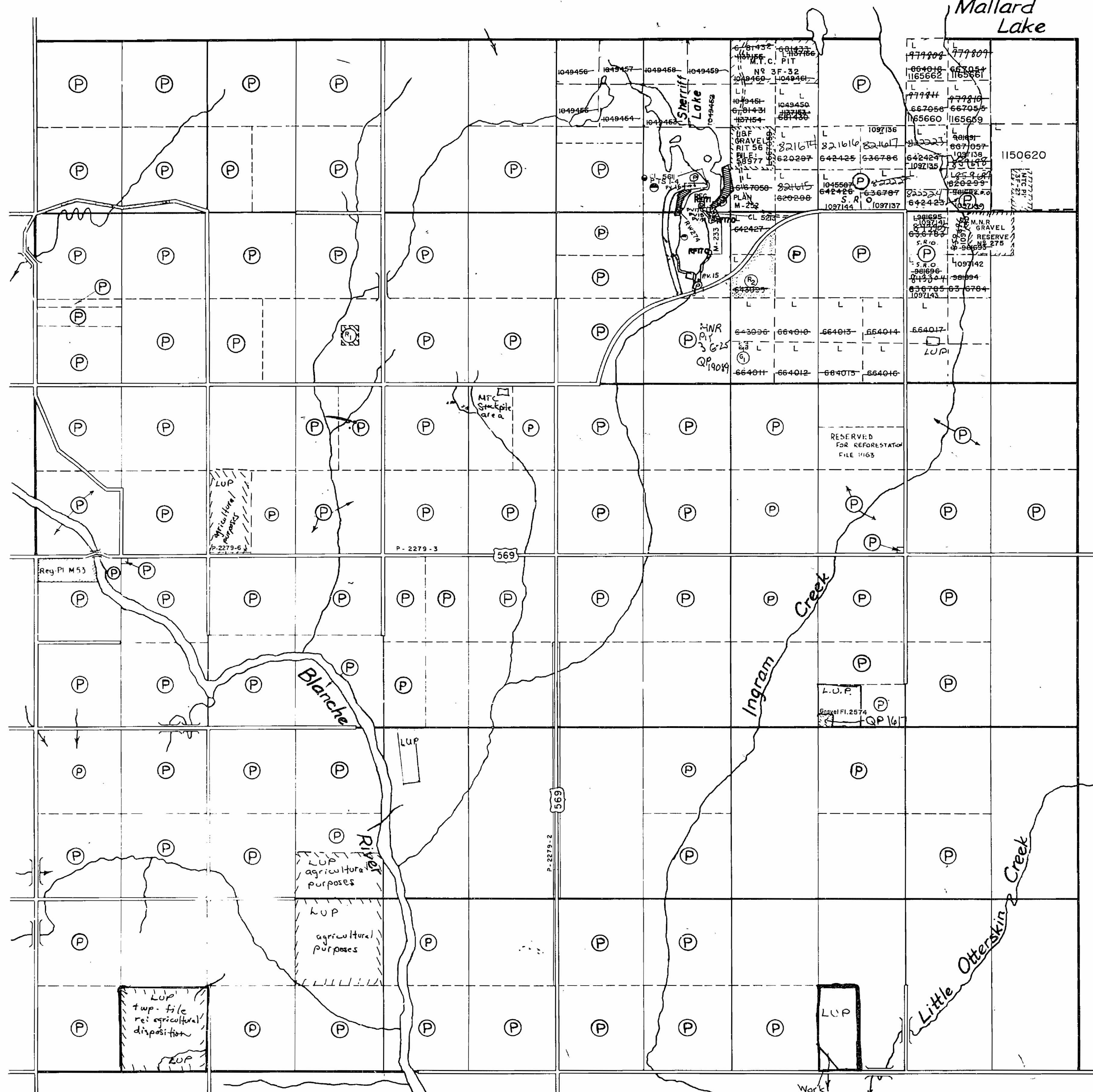

VI

V

IV

III

II

I

PENSE

THE TOWNSHIP
OF
INGRAM
DISTRICT OF TIMISKAMING
LARDER LAKE MINING
DIVISION
SCALE: 1 INCH TO 40 CHAINS

LEGEND

PATENTED LAND	Ⓟ
CROWN LAND SALE	C.S.O. Ⓞ
LOCATED LAND	Loc.
LICENSE OF OCCUPATION	L.O.
IMPROVED ROADS	==
ROADS	---
RESERVED FOR GRAVEL	RES.
LEASES	Ⓛ
MINING RIGHTS ONLY	M.R.O.
SURFACE RIGHTS ONLY	S.R.O.
CANCELLED	C.

NOTES

400' Surface Rights Reservation around all Lakes and Rivers.

Areas withdrawn from staking under Section 43 of the Mining Act. (R.S.O. 1970).

Order No.	File	Date	Disposition
NR. W.18/79	23162	20/2/79	S.R.O.

SAND and GRAVEL

MNR GRAVEL RESERVE 3625

NOTICE OF FORESTRY ACTIVITY
THIS TOWNSHIP / AREA FALLS WITHIN THE _____
TIMISKAMING MANAGEMENT UNIT
AND MAY BE SUBJECT TO FORESTRY OPERATIONS.
THE MNR UNIT FORESTER FOR THIS AREA CAN BE CONTACTED AT: P.O. BOX 129
SWASTIKA, ONT.
POK ITO
705-642-3222

M.511 #1
ONTARIO
MINISTRY OF NATURAL RESOURCES
SURVEYS AND MAPPING BRANCH

See letter 10 on Ingram Land roll file in regards to staking dated June 10/81

REMOVED FROM CIRCULATION AND ARCHIVED ON APR.13/92

THE INFORMATION THAT APPEARS ON THIS-MAP HAS BEEN COMPILED FROM VARIOUS SOURCES, AND ACCURACY IS NOT GUARANTEED. THOSE WISHING TO STAKE MINING CLAIMS SHOULD CONSULT WITH THE MINING RECORDER, MINISTRY OF NORTHERN DEVELOPMENT AND MINES, FOR ADDITIONAL INFORMATION ON THE STATUS OF THE LANDS SHOWN HEREON.

INGRAM M-511 Apr. 13/92

511

INGRAM

TIMISKAMING DISTRICT

SCALE 40 CHAINS = 1 INCH

M-511



BAILY

EVANTUREL

PENSE

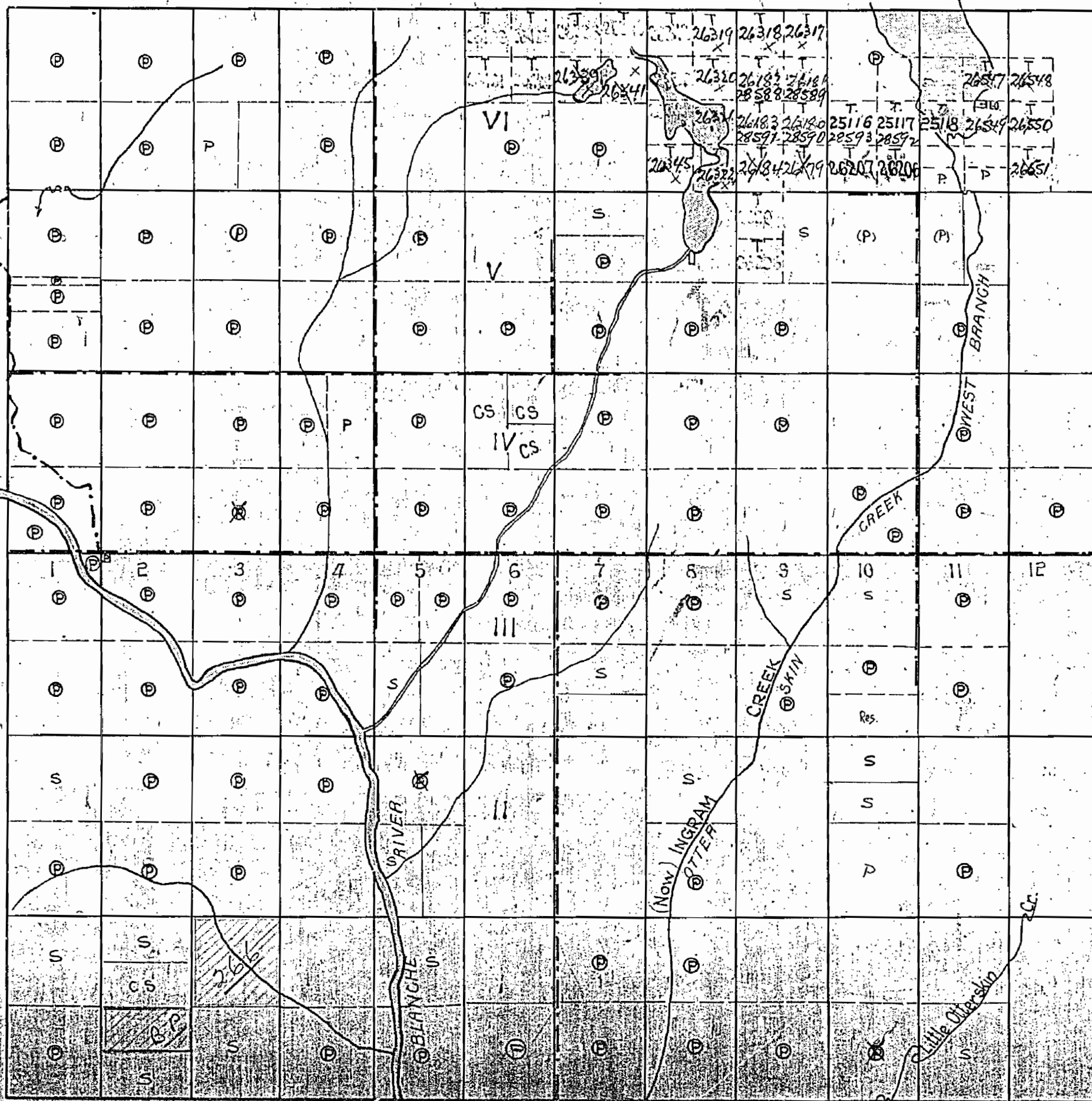

HILLIARD

Map of the Ingram Timiskaming District, M-511, showing the Baily section. The map is bounded by Evanturel to the west and Pense to the east. It features a grid of sections, with sections 1 through 12 labeled at the top. The map shows the Blangre River, the (Now) Ingram Otter Creek, the Skin Creek, the West Branch, and the Little Ojibwa Cr. The map is dated July 18, 1946, and is received by the Timiskaming Mining Division. The map is drawn by Hilliard.