



EXAMPLE: Italian Alder trees further south on Victoria Street opposite the library.

Victoria Street Transformation Project

Wellington City Council and the Memorial Park Alliance held a series of open days in September to discuss the concept plans for street improvements in Victoria Street. Thank you to those who attended or emailed their views.

Your views are being taken into account and are part of the ongoing considerations before the detailed design is finalised. Meanwhile you will notice some preparatory work taking place in November. We will keep you updated as planning and works progress.

→ What's it all about?

- Providing a premier street within the Victoria/Cuba Street Precinct
- Creating a vibrant inner city neighbourhood that encourages commercial and residential development
- Improving efficiency for cars, buses, cyclists, and pedestrians
- Enhancing the pedestrian experience, with public spaces and wider footpaths

Exciting developments are planned for south Victoria Street, including new apartment complexes and the redevelopment of the Farmers/Deka site fronting Cuba, Dixon and Victoria Streets which includes a new Whitireia and WelTec campus for more than 1000 students.

→ Selection of tree species

In response to submissions, Italian Alder (*Alnus cordata*) has been chosen for the street trees as its track record shows it is one of the best at successfully establishing and developing a good form in a challenging and exposed streetscape.

Features of Italian Alder are:

- Forms an upright conical tree whose crown can be regularly pruned to achieve the required clearance over roads and footpaths
- Proven in Wellington, even in unfavourable situations
- Deciduous, allowing sun through in winter.
- Grows well in all soils
- Handles cold, wet or dry sites
- Fast-growing and quick to establish
- Salt and wind tolerant
- Handles a degree of vandalism and bark damage

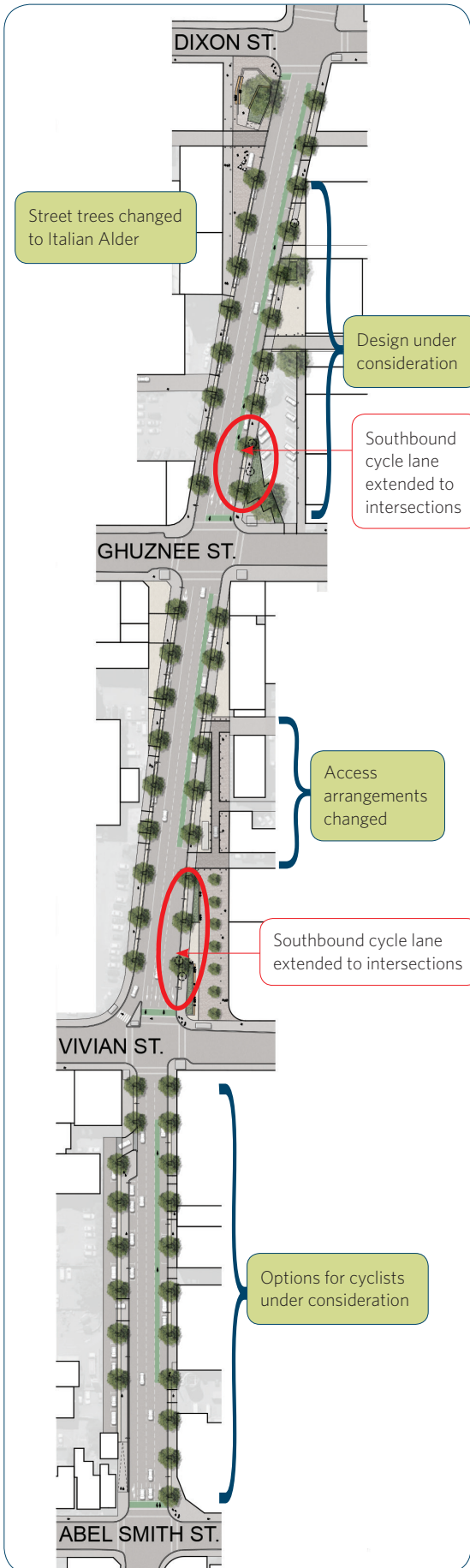

→ Concept design

The plan shows the concept design for the improvements planned in Victoria Street, but does not reflect all the changes being made as a result of feedback. An updated version will be supplied once the detailed design work is complete. The changes being made are described in the boxes.

→ Cycling

As a result of submissions received regarding cycle lanes, the lanes will be extended right up to the intersections from Dixon Street to Vivian Street. Options for cyclists between Vivian and Abel Smith Streets are still being considered.

→ Site preparation

Some of the preparatory enabling works will be noisy but we will minimise this as much as possible. Work hours will generally be 7.00am - 6.00pm, Mon - Fri. We will notify nearby residents and businesses when we plan works outside these hours.

Between Dixon and Abel Smith Streets **Early November**

Inspection of underground services will require digging up pavement and jet-vaccing (hosing and vacuuming soil from around underground ducts).

Between Vivian and Abel Smith Streets **Early November**

Poles for the trolley bus and lights will be relocated.

Retaining walls and planter boxes will be removed.

Between Ghuznee and Vivian Streets **Mid-November**

Carparks will be removed from the east side parking area.

On-street carparks will be removed.

Contact us

To comment or inquire about the project or to register for emailed updates, please contact info@memorialpark.co.nz

More information is available on Wellington City Council's website:

www.wellington.govt.nz/your-council/projects/victoria-street-transformation-project

0800 020 086

