

# GLADMAN

1201

DISTRICT OF NIPISSING  
LARDER LAKE MINING DIVISION

Scale 40 Chains = 1 Inch

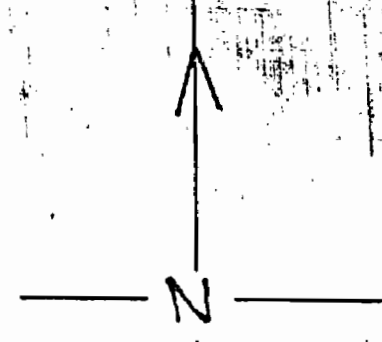

LARDER LAKE  
MINING DIV.  
**RECEIVED**  
NOV 20 1968  
AM 9 10 11 12 1 2 3 4 5 6 PM

BLANKET QUARRY PERMIT No. 6330  
COVERS PARTS OF GLADMAN TWP.  
SURFACE RIGHTS ONLY - RE-OPENED - LETTER NOVEMBER 5/74

42  
a

KENNY

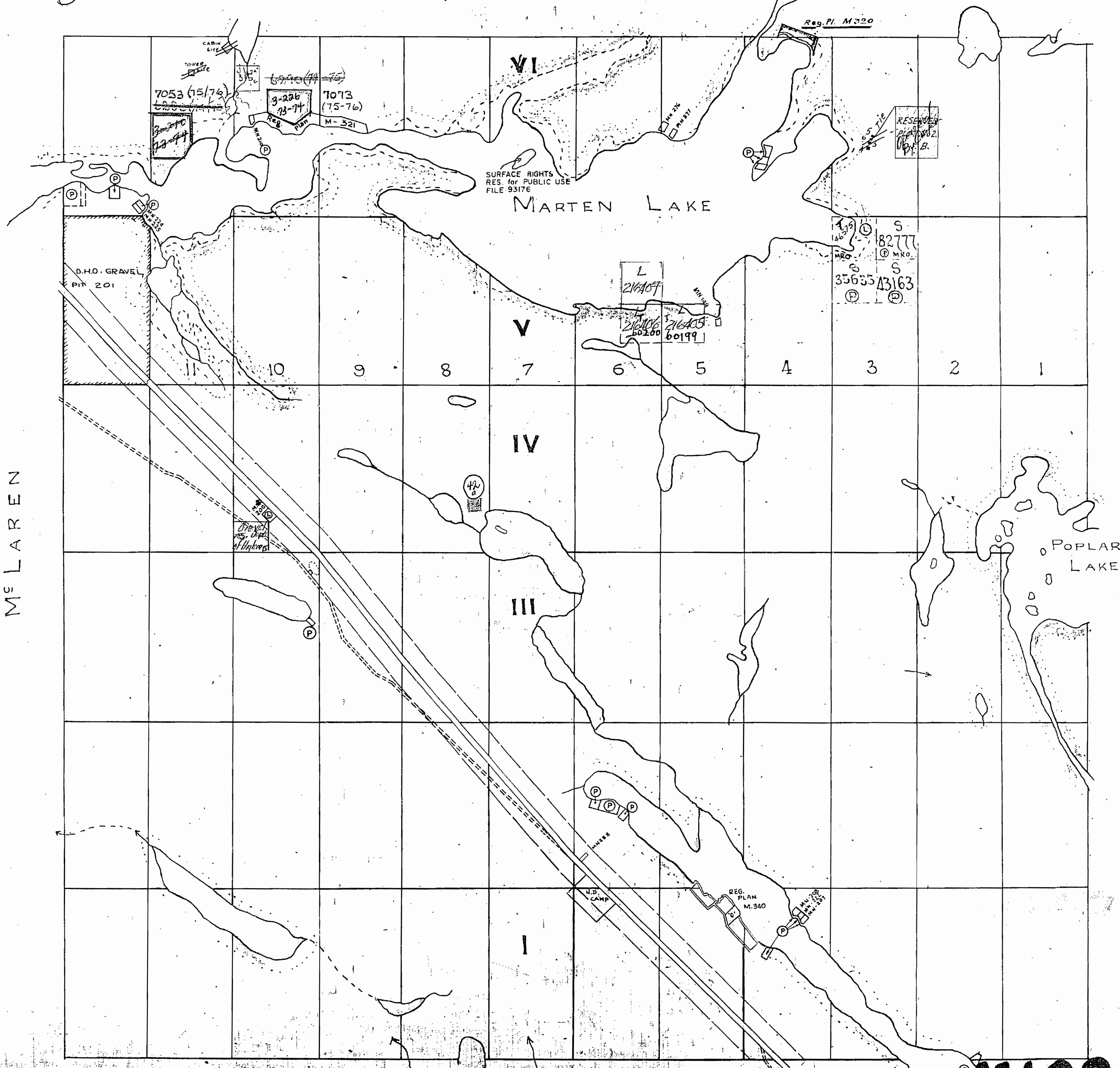

McLAREN

HAMMELL

LYMAN

Note: Plot Nos. 2, 3, 4, 5 in Lots 2 & 3 Reserved for O.F.B.

400' surface rights reservation  
around all lakes and rivers.

1201

GLADMAN

6 4 2 2 4 6

**NOTES**

400' surface rights reservation along the shores of all lakes and rivers.

**FLOODING**  
 Ontario Hydro flooding of Wicksteed Lake to dam elevation 100' - L0.6065, File: 46189.  
 Wicksteed Lake—Lands subject to flooding.  
 Withdrawn from disposition July, 20, 1970  
 File: 160707, vol. 2

**RESERVED**  
 S.R. - SURFACE RIGHTS      M.R. - MINING RIGHTS  
 Designation      Date      Disposition File  
 (N) PUBLIC RESERVE      SEPT. 13/67      S.R. 93176

**SAND and GRAVEL**

(G) Gravel Reserve      File: 46189

(G) Gravel File: 116311  
 (G) Gravel File: 91677  
 (M) M.T.C. Pit 4C-32

Township closed to staking effective  
 May 8 '78. Sec. 38(f) of Mining Act.

See File 210-7 P. Proposed  
 Prescribed Burn Data

\* IN SERVICE 1983 to 91 - Jm

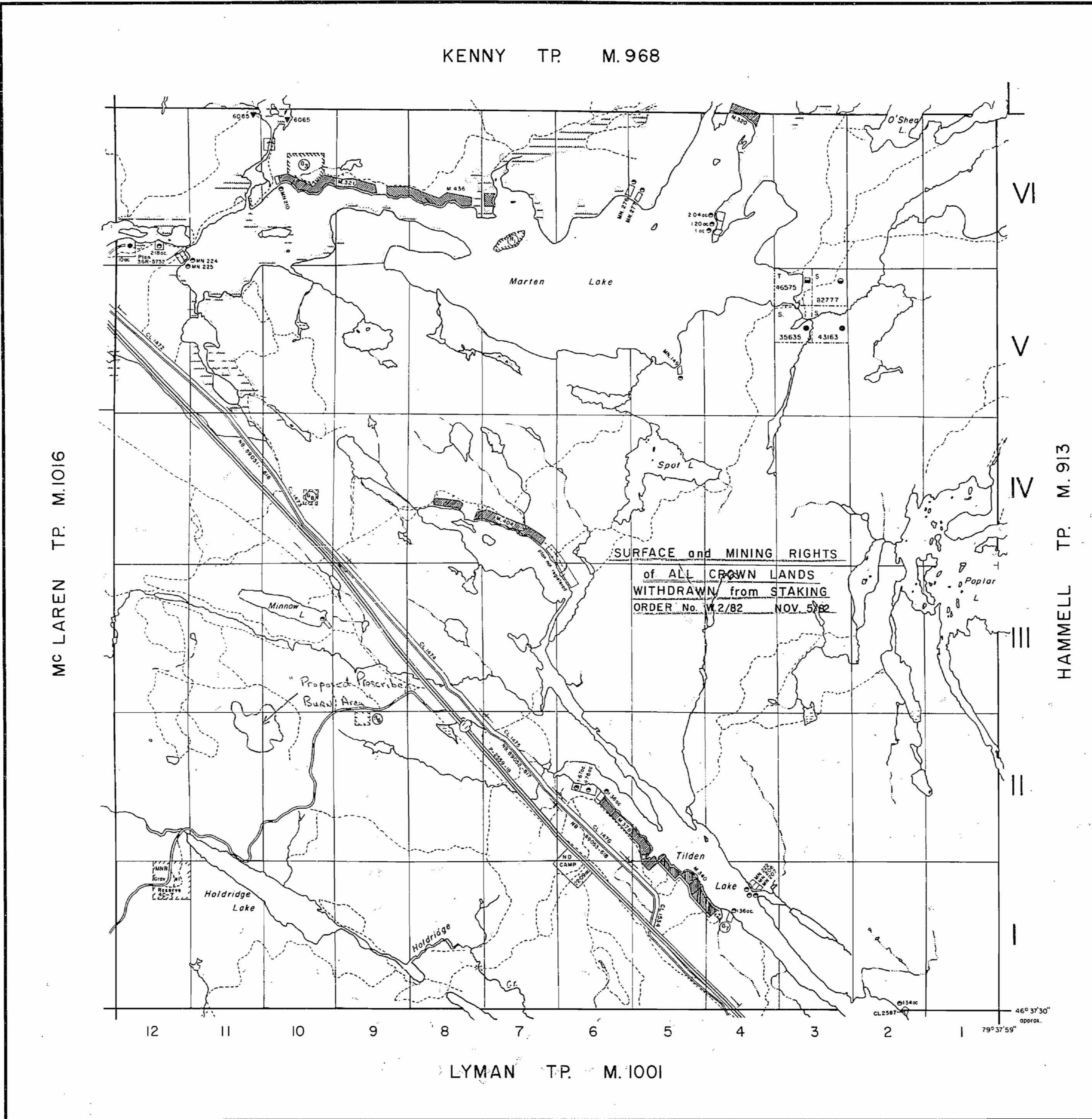

**LEGEND**

HIGHWAY AND ROUTE No.

OTHER ROADS

TRAILS

SURVEYED LINES:  
 TOWNSHIPS, BASE LINES, ETC.

LOTS, MINING CLAIMS, PARCELS, ETC.

UNSURVEYED LINES:  
 LOT LINES

PARCEL BOUNDARY

MINING CLAIMS ETC.

RAILWAY AND RIGHT OF WAY

UTILITY LINES

NON-PERENNIAL STREAM

FLOODING OR FLOODING RIGHTS

SUBDIVISION

ORIGINAL SHORELINE

MARSH OR MUSKEG

MINES

**DISPOSITION OF CROWN LANDS**

TYPE OF DOCUMENT	SYMBOL
PATENT, SURFACE & MINING RIGHTS	●
" SURFACE RIGHTS ONLY	○
" MINING RIGHTS ONLY	◐
LEASE, SURFACE & MINING RIGHTS	■
" SURFACE RIGHTS ONLY	◼
" MINING RIGHTS ONLY	◻
LICENCE OF OCCUPATION	◄
CROWN LAND SALE	C.S.
ORDER-IN-COUNCIL	OC
RESERVATION	◎
CANCELLED	⊙
SAND & GRAVEL	⊙

SCALE: 1 INCH = 40 CHAINS

FEET: 0 500 1000 2000 4000 8000

METRES: 0 200 400 600 800 1.6M

ACRES: 40

HECTARES: 16

TOWNSHIP  
**GLADMAN**  
 DISTRICT  
 NIPISSING  
 MINING DIVISION  
 SUDBURY

Ministry of Natural Resources  
 Ontario Surveys and Mapping Branch

Date: Oct. 17, 75      Plan No. M.1021  
 Whitney Block  
 Queen's Park, Toronto



G-158

9WT NAMDAJG

G-158

MAP SYMBOLOGY

Aerial Cowlway	Pipeline (above ground)
Borndery	Railroad
Impassable	Single Track
Obstacle	Double Track
Station, Township	Abandoned
Lotus Reserve	Turnpike
Approach	Road
Lot, Concession	Highway, County
Appurtenance	Tramway
Park Boundary	Section Line (of unoccupied)
Bridge	Highway, County
Road, Railroad	Trails, Bush Road (topographic)
Building	Roadway
Chimney	Roadway
Cliff, Pit, Pile	Section Line (river with multiple rapids)
Contours	Section Line (river with multiple rapids)
Intersected	Reservoir
Approximate	River, Stream, Canal
Depression	Roadway
Control Points	Approximate
Horizontal	Disruption of File
Vertical	Rock
Culvert	Wharf
Falls	Shoal
Dead-end river	Spot Elevation (tree elevation)
Fence, Hedge, Wall	Tower
Feature Outline (topographic features, etc.)	Transmission Line
Flooded Land	Power
Leak	Pyrite
Mud or Swamp	Tunnel
Moat	Utility Pole
Nice Head Frame	Wharf, Dock, Pier
Outcrop	Wooded Area

AREAS WITHDRAWN FROM DISPOSITION

Description	Order No.	Date	Disposition	File
<b>M.R.O. - MINING RIGHTS ONLY</b>				
<b>S.R.O. - SURFACE RIGHTS ONLY</b>				
<b>M.R. - MINING AND SURFACE RIGHTS</b>				
(1) PUBLIC RESERVE	SEPT. 13/87	S.R.	93176	
(2) SEC. 36/80	W.2/82	NOV. 5/82	M.S.	
Part of order W 2182 REPEALED by order O.M. QUISO NER effective April 3, 1990 at 7:00 AM E.S.T.				
(13) W-018108T S.R.O.	SEP. 20/91	L.R. FILE		

SAND AND GRAVEL	
(1) GRAVEL RESERVE	46129
(2) GRAVEL FILE	116311
(3) GRAVEL FILE	91677
(4) M.T.C. PH 4C-32	
(5) MNR GRAVEL RESERVE 4C-7	

See File 210-2 for Proposed RECEIVED BURN DATA

NOTE: "THIS MAP SHOWS THE APPROXIMATE LOCATION OF THE BOUNDARIES OF THE AREA WHICH IS THE SUBJECT OF CURRENT LITIGATION. THE EXACT LOCATION WILL BE SHOWN FOLLOWING CONFIRMATION BY THE PARTIES TO THE ACTION"

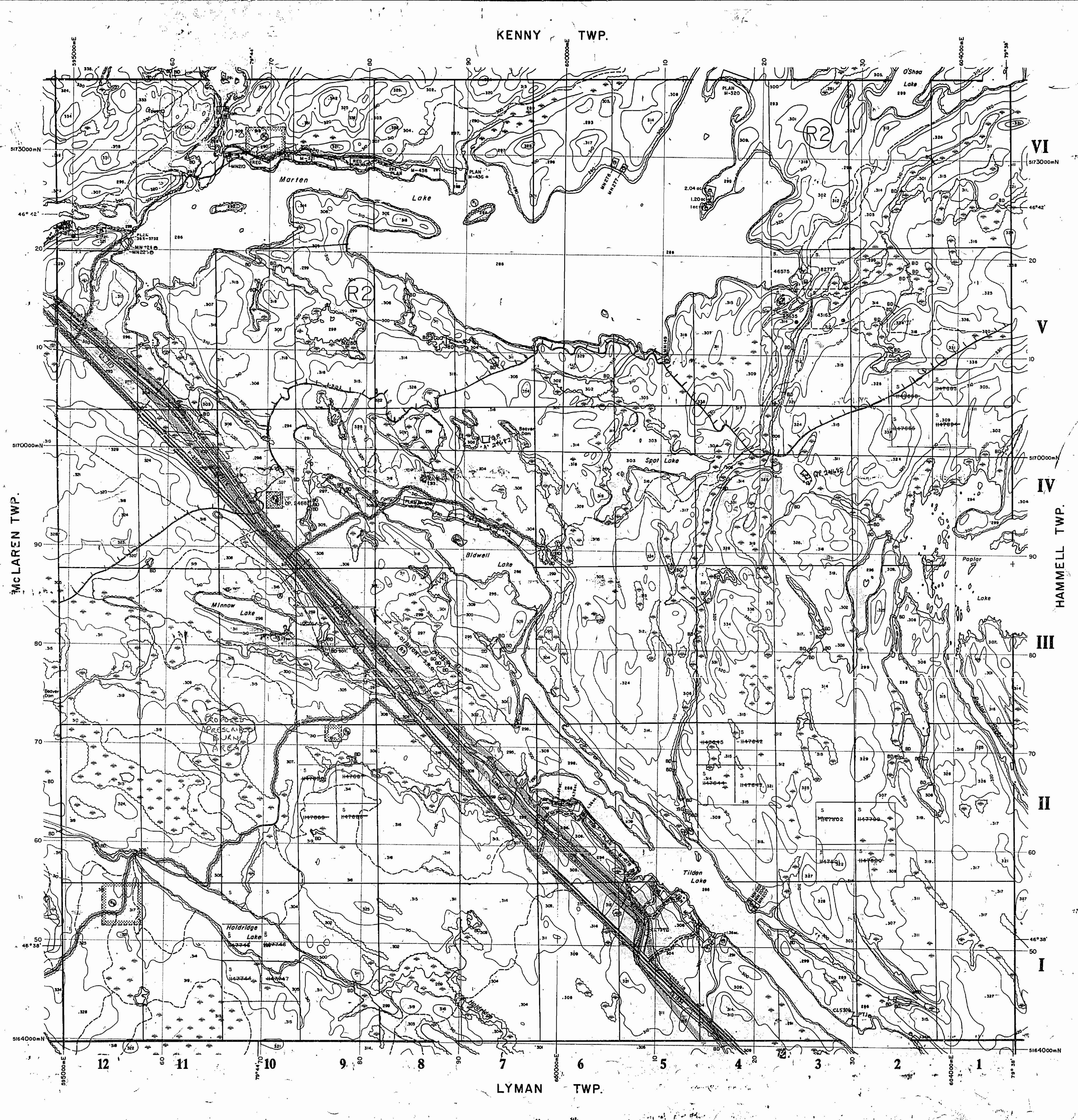

LEGEND

HIGHWAY AND ROUTE No.	---
OTHER ROADS	---
TRAILS	---
SURVEYED LINES: TOWNSHIPS, BASE LINES, ETC.	---
LOTS, MINING CLAIMS, PARCELS, ETC.	---
UNSURVEYED LINES: LOT LINES	---
PARCEL BOUNDARY	---
MINING CLAIMS ETC.	---
RAILWAY AND RIGHT OF WAY	---
UTILITY LINES	---
NON-PERENNIAL STREAM	---
FLOODING OR FLOODING RIGHTS	---
SUBDIVISION OR COMPOSITE PLAN	---
RESERVATIONS	---
ORIGINAL SHORELINE	---
MARSH OR MUSKOG	---
MINES	---
TRAVERSE MONUMENT	---

DISPOSITION OF CROWN LANDS

TYPE OF DOCUMENT	SYMBOL
PATENT, SURFACE & MINING RIGHTS	⊙
" SURFACE RIGHTS ONLY	⊙
" MINING RIGHTS ONLY	⊙
LEASE, SURFACE & MINING RIGHTS	⊙
" SURFACE RIGHTS ONLY	⊙
" MINING RIGHTS ONLY	⊙
LICENCE OF OCCUPATION	⊙
ORDER-IN-COUNCIL	⊙
RESERVATION	⊙
CANCELLED	⊙
SAND & GRAVEL	⊙

NOTE: MINING RIGHTS IN PARCELS PATENTED PRIOR TO MAY 6, 1913, VESTED IN ORIGINAL PATENTEE BY THE PUBLIC LANDS ACT, R.S.O. 1970, CHAP. 325, SEC. 63, SUBSEC. 1.

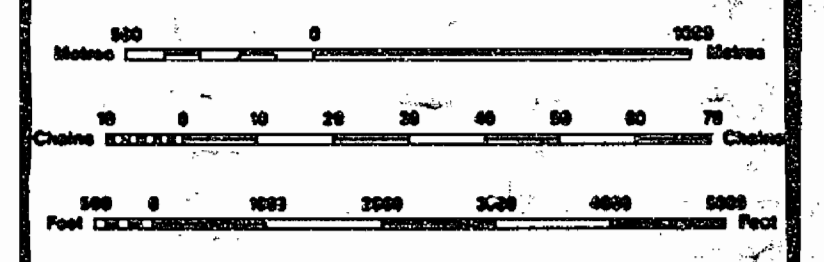

SCALE 1:20 000  
GRID ZONE: 17

THE INFORMATION THAT APPEARS ON THIS MAP HAS BEEN COMPILED FROM VARIOUS SOURCES, AND ACCURACY IS NOT GUARANTEED. THOSE WISHING TO STAKE MINING CLAIMS SHOULD CONSULT WITH THE MINING RECORDER, MINISTRY OF NORTHERN DEVELOPMENT AND MINES, FOR ADDITIONAL INFORMATION ON THE STATUS OF THE LANDS SHOWN HEREON.

TOWNSHIP  
**GLADMAN**

M.N.R. ADMINISTRATIVE DISTRICT  
**NORTH BAY**  
MINING DIVISION  
**SUDBURY**  
LAND TITLES / REGISTRY DIVISION  
**NIPISSING**

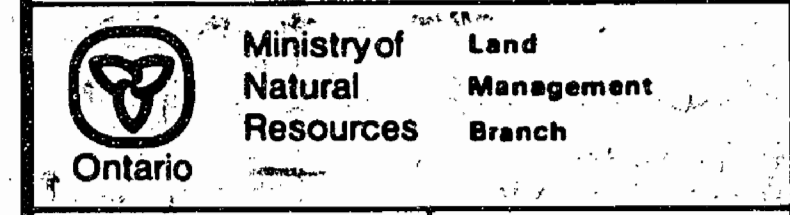

Original Compilation: JUNE 1985  
Revised:  
Number:  
**G-1728**

G-158

9WT NAMDAJG

G-158



**MAP SYMBOLOLOGY**

<b>Aerial Cableway</b>	<b>Pipeline</b> (above ground)
<b>Boundary</b>	<b>Railroad</b>
International	Single Track
Imperialist	Double Track
Diagonal, recently	Abandoned
Under	Footpath
Approximate	<b>Road</b>
Lot, Concession	Highway, County
Approval	Trunk
<b>Park Boundary</b>	Access (lead of dogleg)
<b>Bridge</b>	Access (lead of dogleg)
Beam, Railroad	Trestle, Base Road
<b>Building</b>	(overhead, utility)
Chimney	<b>Rapids</b>
Cliff, Pit, Pile	Double line river
<b>Contours</b>	with multiple rapids
Interpretated	Double line river
Approximate	with multiple rapids
Depression	<b>Reservoir</b>
<b>Control Points</b>	River, Stream, Canal
Horizontal	Approximate
Vertical	seasonal
<b>Culvert</b>	Direction of flow
<b>Falls</b>	Rock
Deep line river	Vegetation
<b>Fence, Hedge, Wall</b>	Shoal
<b>Feature Outline</b>	<b>Spot Elevation</b> (true elevation)
Construction features, etc.	Tower
<b>Flooded Land</b>	Transmission Line
<b>Lock</b>	Pylon
<b>Marsh or Swamp</b>	Utility Pole
<b>Moat</b>	Wharf, Dock, Pier
<b>Mine Head Frame</b>	Wooded Area
<b>Outcrop</b>	

**AREAS WITHDRAWN FROM DISPOSITION**

- M.R.O. - MINING RIGHTS ONLY
- S.R.O. - SURFACE RIGHTS ONLY
- M.+S. - MINING AND SURFACE RIGHTS

Description	Order No.	Date	Disposition	File
Public Reserve	SEC.31/90	0-3-22/94	SEPT. 13/67 S.R.	93176
	SEC.31/90	0-3-22/94	01/05/98 M.S.S.	121510
	SEC.36/90	0-6-7/30	NOV. 5/83 M.S.S.	

Part of order W 2/82 REOPENED by order  
O.M. 01/90 NER effective Apr 3 1990 at 7:00 AM E.S.T.  
SEC.35/90 0-3-22/94 01/05/98 340 121510  
W-01/01/90 W-2/82 01/05/98 340 121510

**SAND AND GRAVEL**

Gravel Reserve	46189
Gravel File	116311
Gravel File	91677
M.T.C. P11 4C-32	
MNR Gravel Reserve 4C-7	

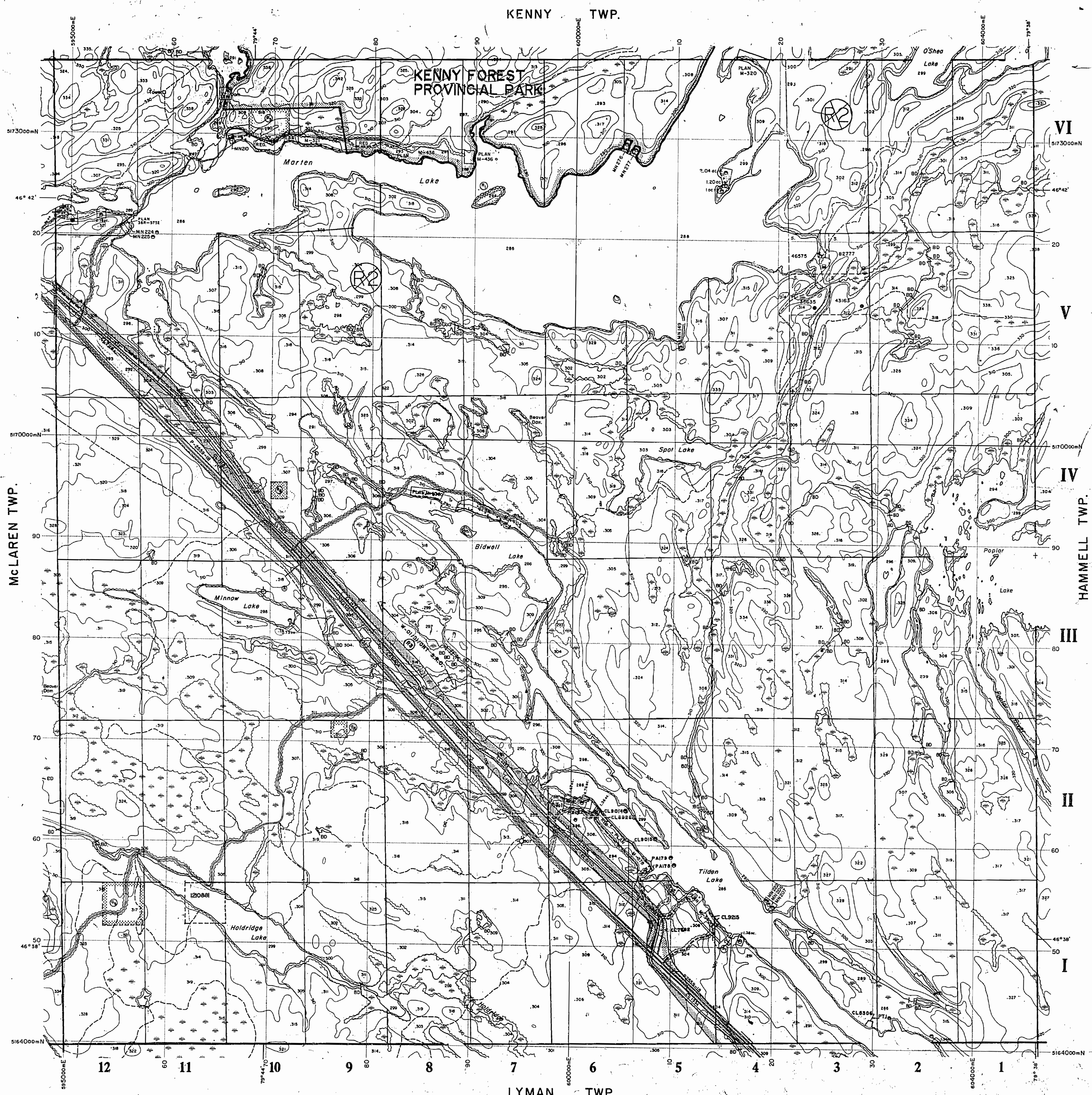

**LEGEND**

HIGHWAY AND ROUTE No.	
OTHER ROADS	
TRAILS	
SURVEYED LINES:	
TOWNSHIPS, BASE LINES, ETC.	
LOTS, MINING CLAIMS, PARCELS, ETC.	
UNSURVEYED LINES:	
LOT LINES	
PARCEL BOUNDARY	
MINING CLAIMS ETC.	
RAILWAY AND RIGHT OF WAY	
UTILITY LINES	
NON-PERENNIAL STREAM	
FLOODING OR FLOODING RIGHTS	
SUBDIVISION OR COMPOSITE PLAN	
RESERVATIONS	
ORIGINAL SHORELINE	
MARSH OR MUSKEG	
MINES	
TRAVERSE MONUMENT	

**DISPOSITION OF CROWN LANDS**

TYPE OF DOCUMENT	SYMBOL
PATENT, SURFACE & MINING RIGHTS	
" SURFACE RIGHTS ONLY	
" MINING RIGHTS ONLY	
LEASE, SURFACE & MINING RIGHTS	
" SURFACE RIGHTS ONLY	
" MINING RIGHTS ONLY	
LICENCE OF OCCUPATION	
ORDER-IN-COUNCIL	
RESERVATION	
CANCELLED	
SAND & GRAVEL	
LAND USE PERMIT	

NOTE: MINING RIGHTS IN PARCELS PATENTED PRIOR TO MAY 8, 1912, VESTED IN ORIGINAL PATENTEE BY THE PUBLIC LANDS ACT, R.S.O. 1910, CHAP. 200, SEC. 63, SUBSEC. 1.

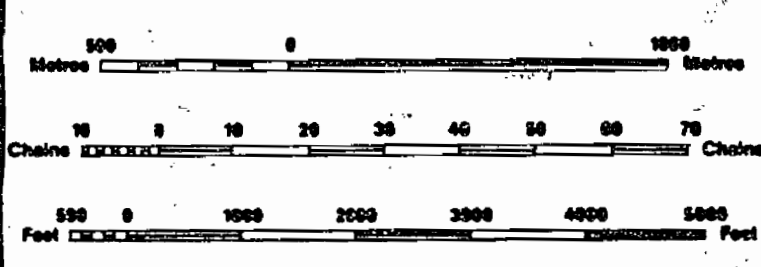

THE INFORMATION THAT APPEARS ON THIS MAP HAS BEEN COMPILED FROM VARIOUS SOURCES, AND ACCURACY IS NOT GUARANTEED. THOSE WISHING TO STAKE MINING CLAIMS SHOULD CONSULT WITH THE MINING RECORDER, MINISTRY OF NORTHERN DEVELOPMENT AND MINES, FOR ADDITIONAL INFORMATION ON THE STATUS OF THE LANDS SHOWN HEREON.

**TOWNSHIP**  
**GLADMAN**  
M.N.R. ADMINISTRATIVE DISTRICT  
NORTH BAY  
MINING DIVISION  
SUDBURY  
LAND TITLES / REGISTRY DIVISION  
NIPISSING

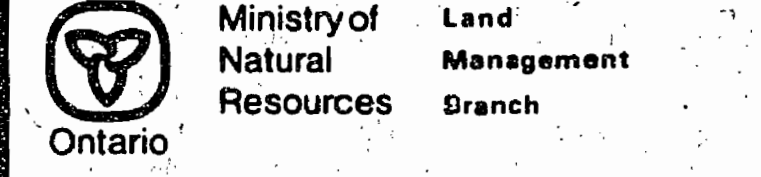

Original Compilation: JUNE 1985  
Revised:  
Number: **G-1728**



1021

# GLADMAN

DISTRICT OF NIPISSING  
LARDER LAKE MINING DIVISION  
Scale 40 Chains = 1 Inch

LARDER LAKE  
MINING DIV.  
**RECEIVED**  
NOV 20 1968  
AM 7:0 9:10 11:12 1:2 3:4 5:6

BLANKET QUARRY PERMIT No. 6330

COVERS PARTS OF GLADMAN TWP.

42  
A SURFACE RIGHTS ONLY - RE-OPENED - LETTER NOVEMBER 5/74.

KENNY

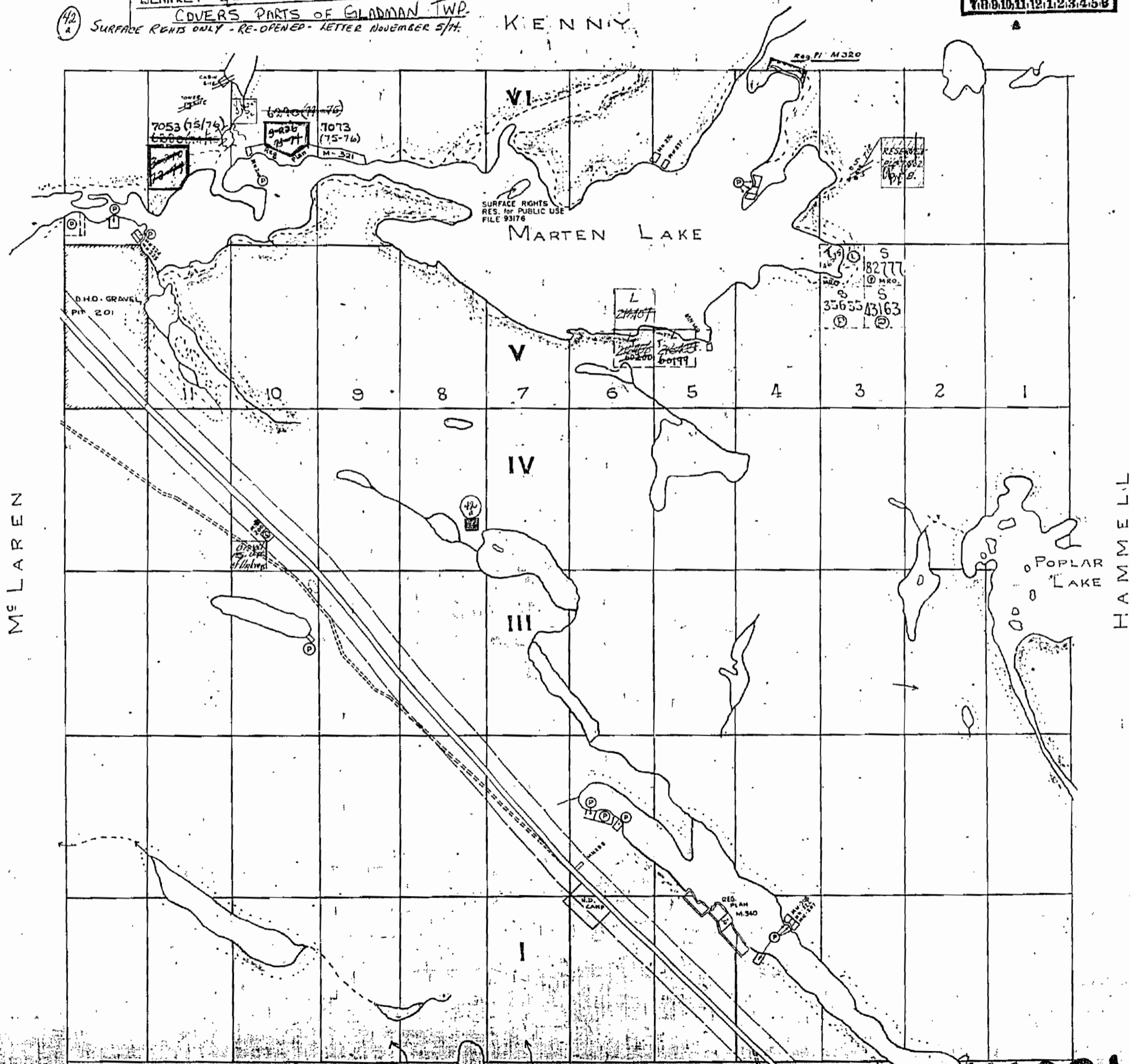

Note: Plot No. 33456 in Lots 2 & 3 Reserved for O.P.E.

400' surface rights reservation  
around all lakes and rivers.

**M1021**  
GLADMAN



1021

# GLADMAN

DISTRICT OF NIPISSING

Scale 40 Chains = 1 Inch

M 1021

CARDS



400' Res

KENNY

VI

MARTEN LAKE

IV

Poplar Nov 20/68

Proposed Natural Gas Line  
L.U.P. 21-31

McLAREN

HAMMILL

POPLAR LAKE

GLADMAN

Note: Plot Nos. 2 & 3 Reserved for ...

Proposed Natural Gas Line ... 400' wide

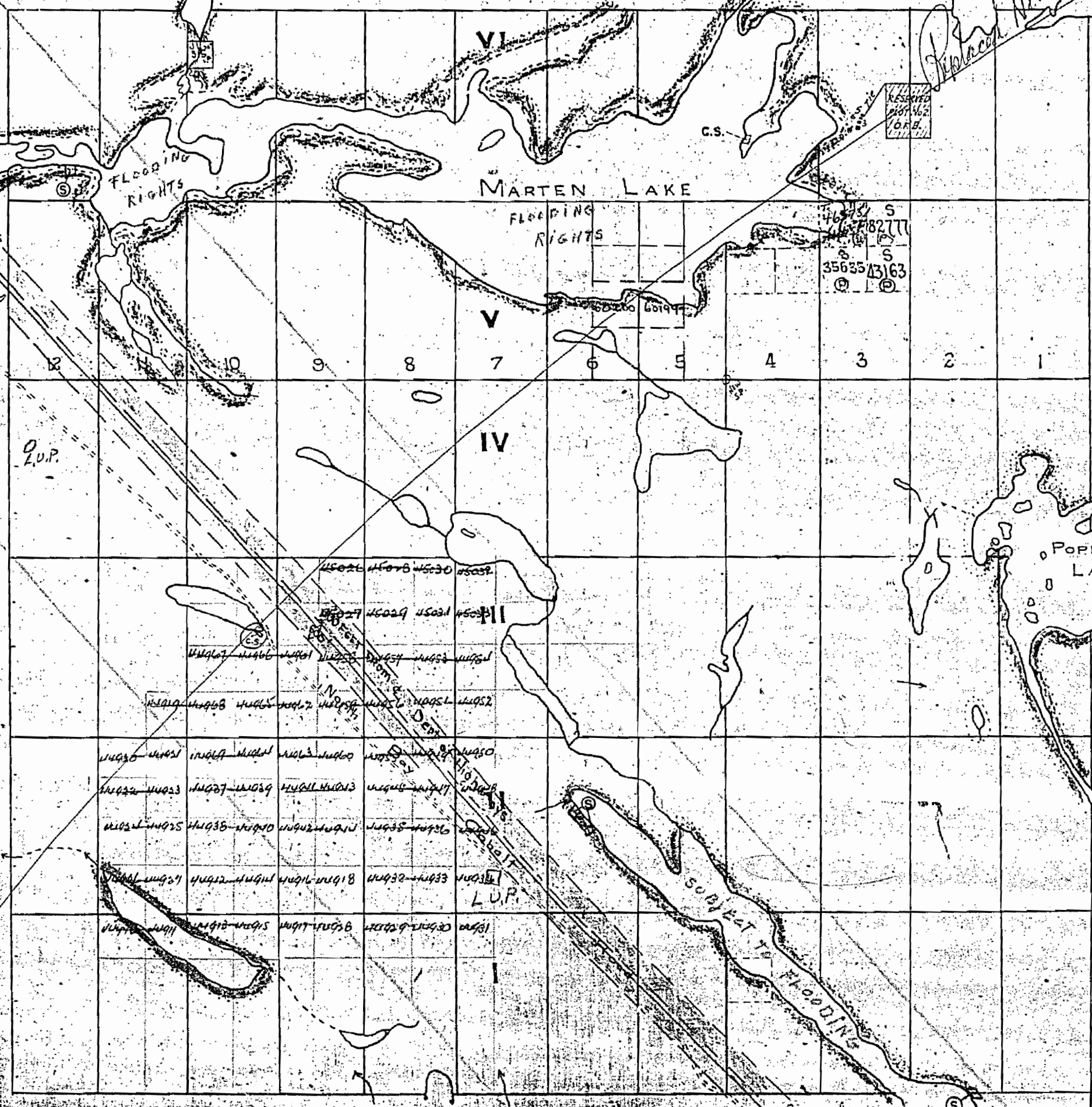



1021

17

Order in Council June 9-1927  
withdrawing strip one-mile wide  
on either side of  
North Bay - Cobalt Road

# GLADMAN

Scale 40 Chains to an Inch.

Carleton

241/2 Res.

Wind. ...  
Area ...

Section  
1291  
90040  
Oct 2/31

LV 25-31

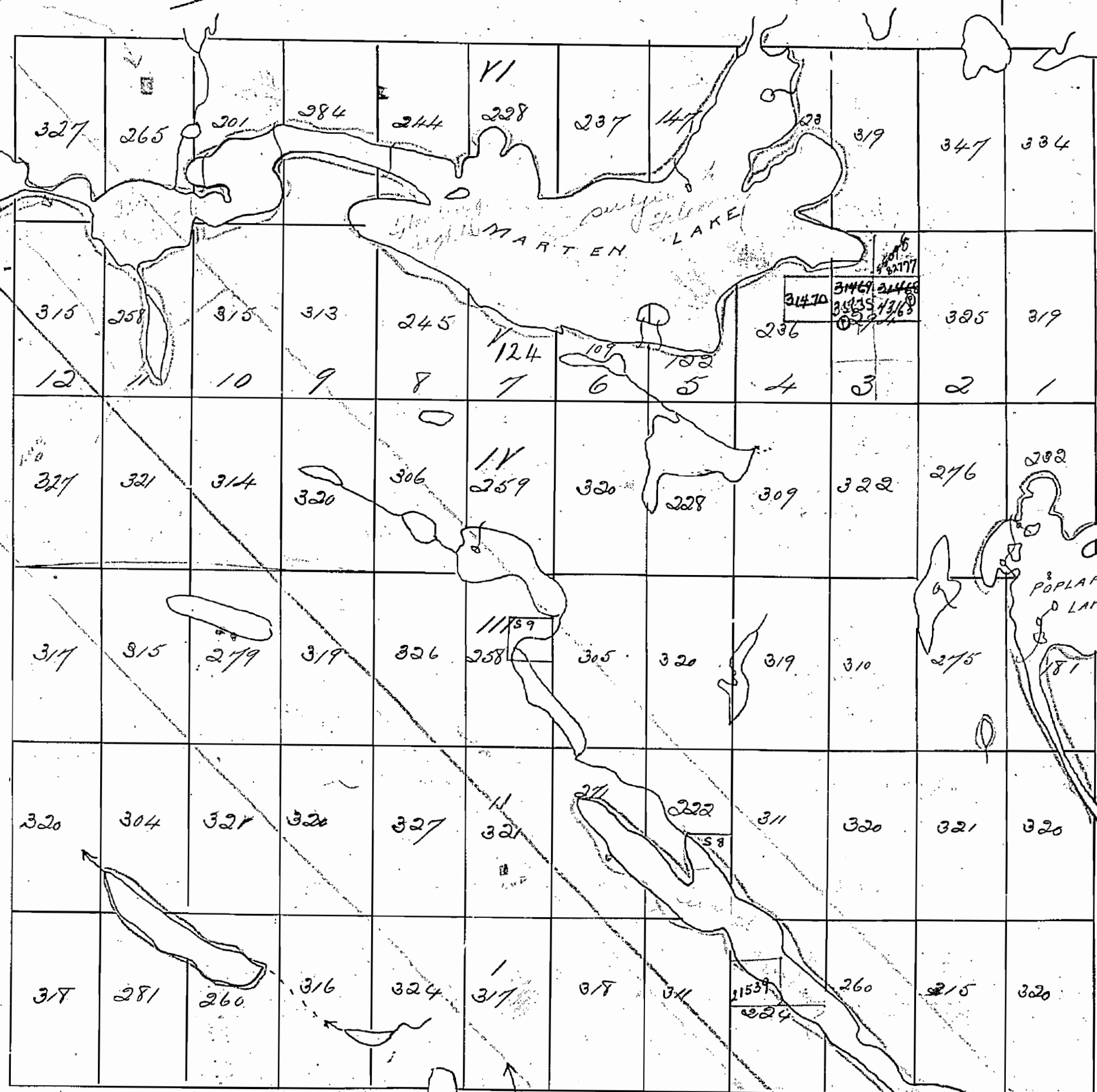

Road allowance marked red

Proposed Natural Area  
1 mile Right of Way reserved on each  
side of each bridge of Natural Area  
June 9, 1927 - Sept 24/28

M1021



85T1-G

G1WT 1AMDAJ3

85T1-G

85T1-G

G1WT 1AMDAJ3

85T1-G

**MAP SYMBOLOLOGY**

Aerial Cableway	Pipeline (above ground)	--- ---
Boundary	Railroad	---+---+---
Intersected	Single Track	---+---
Intersected	Double Track	---+---+---
District, Township, Indian Reserve	Abandoned	---+---+---
Approach	Terraced	---+---+---
Lot, Concession	Road	---+---+---
Approach	Highway, County	---+---+---
Park Boundary	Terraced	---+---+---
Bridge	Access (road of doubtful maintenance or significant driveway)	---+---+---
Road, Railroad	Trail, Back Road (roadway, etc.)	---+---+---
Building	Rapids	---+---+---
Chimney	Double line river with multiple rapids	---+---+---
Cliff, Pier, Pile	Double line river with multiple rapids	---+---+---
Contours	Reservoir	---+---+---
Intersected	River, Stream, Canal	---+---+---
Approach	Approach	---+---+---
Control Points	Approach	---+---+---
Horizontal	Direction of flow	---+---+---
Vertical	Rock	---+---+---
Culvert	Spot Elevation (true elevations)	---+---+---
Falls	Tower	---+---+---
Double line river	Transmission Line	---+---+---
Fence, Hedge, Wall	Pole	---+---+---
Feature Outline (Construction features, etc.)	Pylon	---+---+---
Flooded Land	Tunnel	---+---+---
Lock	Utility Poles	---+---+---
Marsh or Swamp	Wharf, Dock, Pier	---+---+---
Moat	Wooded Area	---+---+---
Mine Head Frame		
Outcrop		

**AREAS WITHDRAWN FROM DISPOSITION**

**M.R.O. - MINING RIGHTS ONLY**

**S.R.O. - SURFACE RIGHTS ONLY**

**M.+S. - MINING AND SURFACE RIGHTS**

Description	Order No.	Date	Disposition	File	
PUBLIC RESERVE	SEC.35/90	0-5-22/96	SEPT.13/87	S.R.	33176
	65C-36/90	W-2/92	07/05/96	M.S.	19650
Part of order W 2/92 REPEALED by order					
0-ML OUSO NER effective April 3/890 at 7:00 AM E.S.T.	SEC.35/90	W-2/92	07/05/96	M.S.	19650
W-01/91/92	W-2/92	07/05/96	M.S.		

**SAND AND GRAVEL**

GRAVEL RESERVE	46189
GRAVEL FILE	16311
GRAVEL FILE	91677
M.T.C. P14 4C-32	
MNR GRAVEL RESERVE 4C-7	

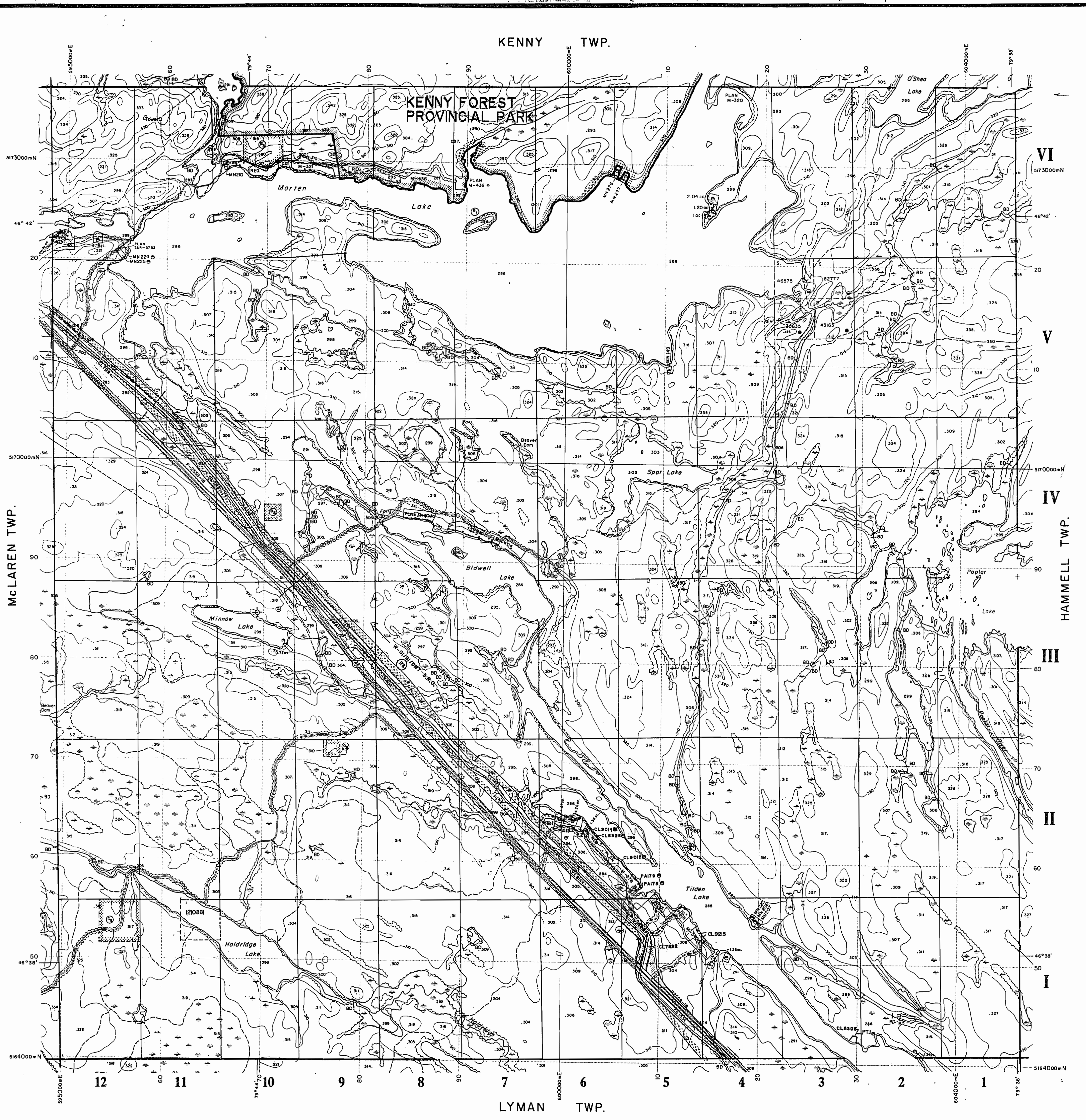

**LEGEND**

HIGHWAY AND ROUTE No.	---
OTHER ROADS	---
TRAILS	---
SURVEYED LINES:	---
TOWNSHIPS, BASE LINES, ETC.	---
LOTS, MINING CLAIMS, PARCELS, ETC.	---
UNSURVEYED LINES:	---
LOT LINES	---
PARCEL BOUNDARY	---
MINING CLAIMS ETC.	---
RAILWAY AND RIGHT OF WAY	---
UTILITY LINES	---
NON-PERENNIAL STREAM	---
FLOODING OR FLOODING RIGHTS	---
SUBDIVISION OR COMPOSITE PLAN	---
RESERVATION	---
ORIGINAL SHORELINE	---
MARSH OR MUSKEG	---
MINES	---
TRAVERSE MONUMENT	---

**DISPOSITION OF CROWN LANDS**

TYPE OF DOCUMENT	SYMBOL
PATENT, SURFACE & MINING RIGHTS	○
" SURFACE RIGHTS ONLY	○
" MINING RIGHTS ONLY	○
LEASE, SURFACE & MINING RIGHTS	□
" SURFACE RIGHTS ONLY	□
" MINING RIGHTS ONLY	□
LICENCE OF OCCUPATION	○
ORDER-IN-COUNCIL	○
RESERVATION	○
CANCELLED	○
SAND & GRAVEL	○
LAND USE PERMIT	○

NOTE: MINING RIGHTS IN PARCELS PATENTED PRIOR TO MAY 6, 1915, VESTED IN ORIGINAL PATENTEES BY THE PUBLIC LANDS ACT, R.S.O. 1970, CHAP. 290, SEC. 81, SUBSEC. 1.

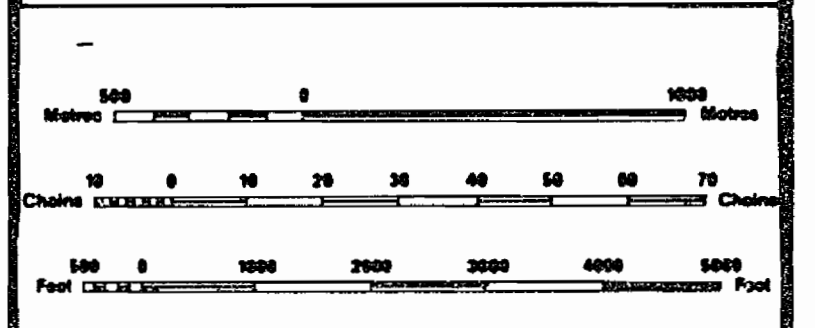

SCALE 1:20 000  
GRID ZONE 17

THE INFORMATION THAT APPEARS ON THIS MAP HAS BEEN COMPILED FROM VARIOUS SOURCES, AND ACCURACY IS NOT GUARANTEED. THOSE WISHING TO STAKE MINING CLAIMS SHOULD CONSULT WITH THE MINING RECORDER, MINISTRY OF NORTHERN DEVELOPMENT AND MINES, FOR ADDITIONAL INFORMATION ON THE STATUS OF THE LANDS SHOWN HEREON.

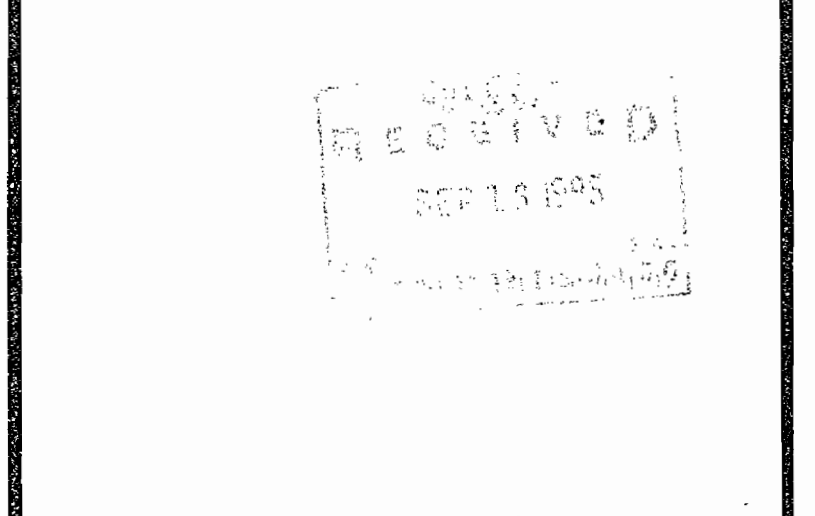

**TOWNSHIP**

**GLADMAN**

M.N.R. ADMINISTRATIVE DISTRICT  
NORTH BAY  
MINING DIVISION  
SUDBURY  
LAND TITLES / REGISTRY DIVISION  
NIPISSING

Ministry of Natural Resources  
Land Management Branch  
Ontario

Original Compilation: JUNE 1985  
Revised: **G-1728**



# GLADMAN #1

DISTRICT OF NIPISSING

Scale 40 Chains = 1 Inch

M-1021

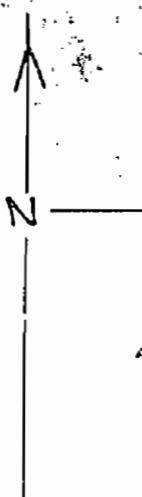

400' Res

KENNY

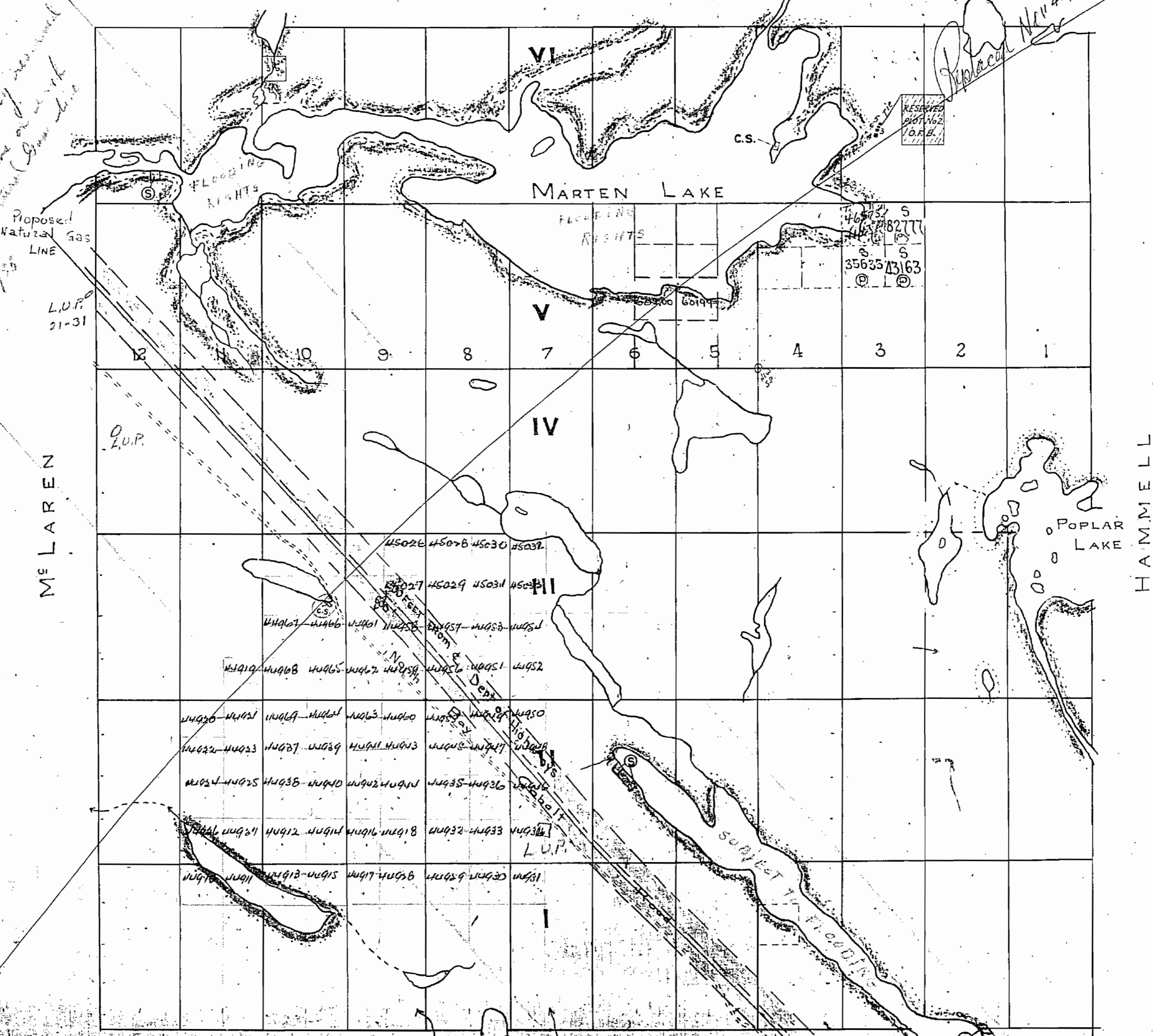

Note: Plot Nos 2456 in Lots 2 & 3 Reserved for C.F.B.

Proposed Natural Gas Line

1021



1021

17

Order in Council June 9, 1927  
withdrawing strip one-mile wide  
on either side of  
North Bay - Poplar Road

# GLADMAN

Scale 40 Chains to an Inch.

Caribou

Wind  
1291  
90010  
Oct 2/31

2110' Res.

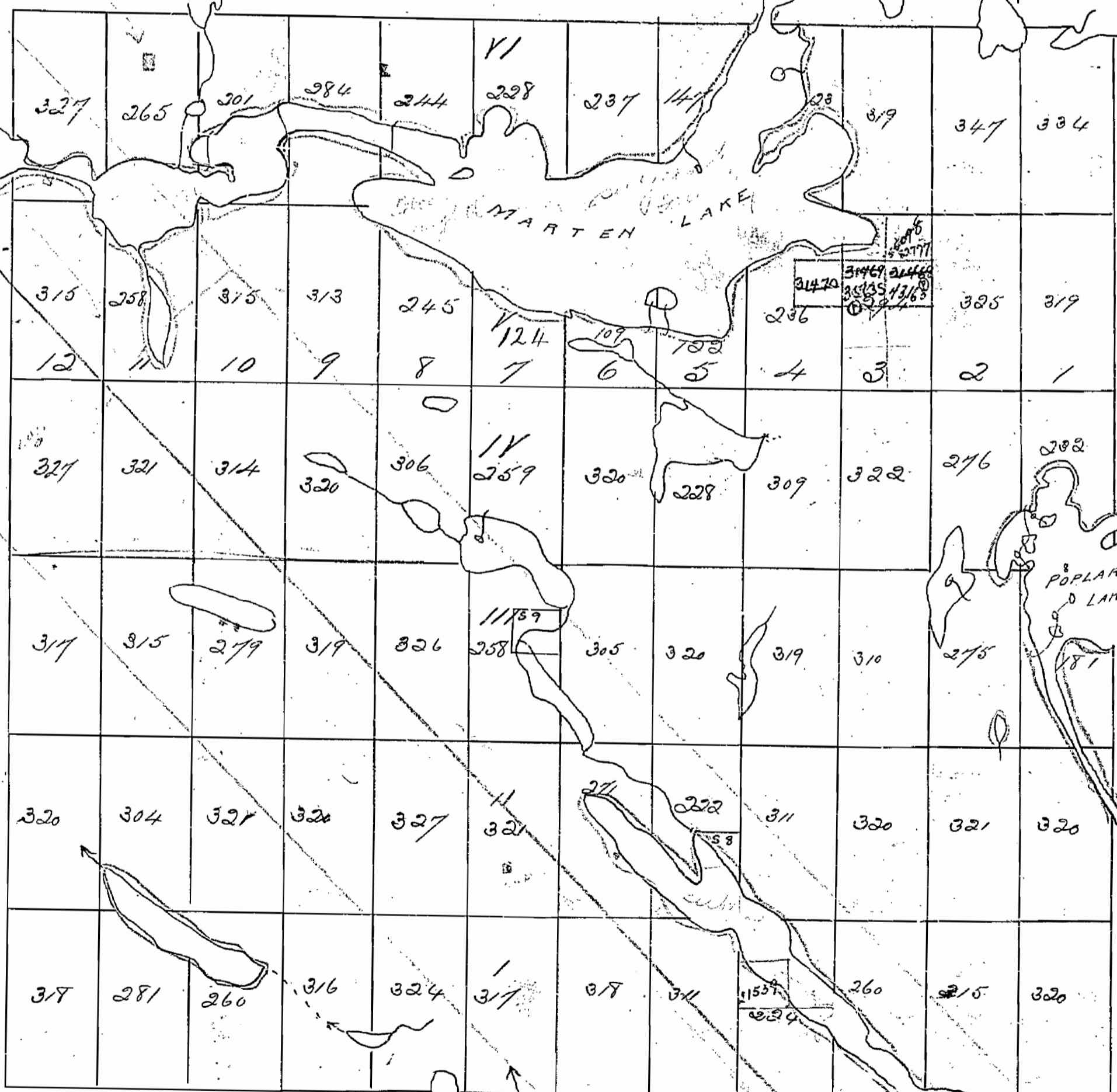

Road allowance marked red

Proposed National  
Park  
1 mile strip of strip reserved on all  
claims to both sides of National Hwy  
line 2.F.M. Sept 24/28

M1021



1021

# GLADMAN

DISTRICT OF NIPISSING  
LARDER LAKE MINING DIVISION  
Scale 40 Chains = 1 Inch

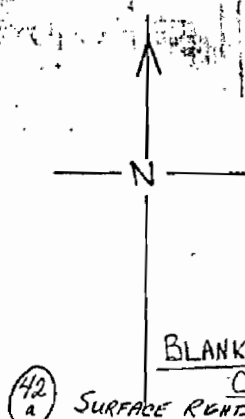

LARDER LAKE  
MINING DIV.  
**RECEIVED**  
NOV 20 1968  
AM 10 11 12 1 2 3 4 5 6

BLANKET QUARRY PERMIT NO. 6330  
COVERS PARTS OF GLADMAN TWP.  
SURFACE RIGHTS ONLY - RE-OPENED - LETTER NOVEMBER 5/74. KENNY

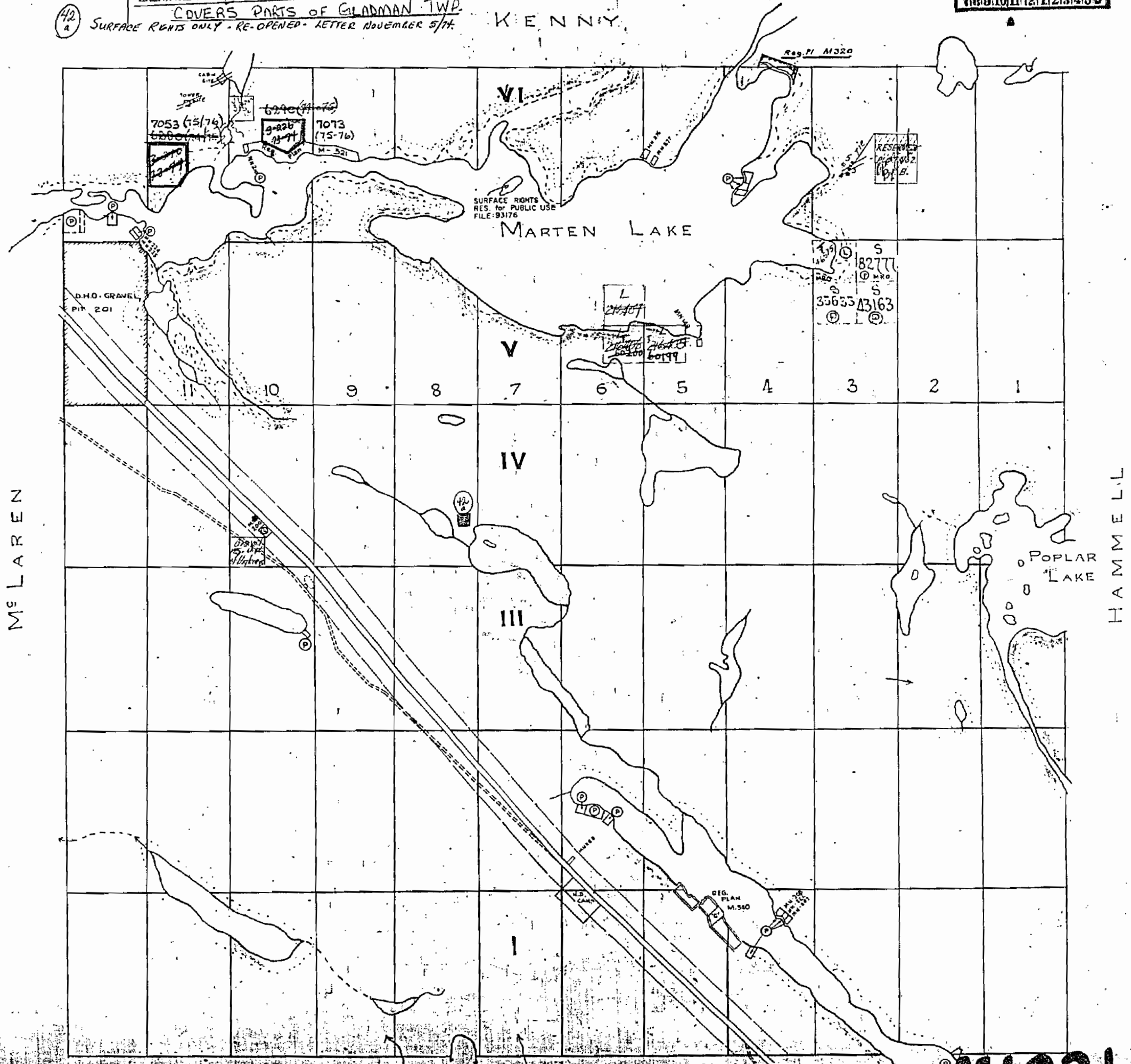

Note: Plot No. 23456 in Lots 2 & 3 Reserved for G.F.B.

400' surface rights reservation  
around all lakes and rivers.

**GLADMAN**

**M1021**

1021



**NOTES**

400' surface rights reservation along the shores of all lakes and rivers.

**FLOODING**

Ontario Hydro flooding of Wicksteed Lake to dam elevation 100' - LO 6065, File 46189  
 Wicksteed Lake—Lands subject to flooding  
 Withdrawn from disposition July, 20, 1970  
 File 160707, vol 2

**RESERVED**

S.R - SURFACE RIGHTS      MR - MINING RIGHTS  
 Designation      Date      Disposition File  
 PUBLIC RESERVE      SEPT 13/67      S.R      93176

**SAND and GRAVEL**

① Gravel Reserve	File 90030
② MNR Gravel Reserve	File 123633
③ Gravel Reserve	File 46189
④ Gravel Reserve	Files 189961 123633 92209
⑤ MTC Gravel Reserve Pt-201	File 123637

BLANKET QUARRY PERMIT 6330<sup>c</sup>  
COVERS PART OF ORIGINAL PLAN

TOWNSHIP CLOSED TO STAKING  
 EFFECTIVE MAY 8, 1978  
 SECTION 38(f) THE MINING ACT

\* Parts 1 & 2 Plan 36R-5752

Township Closed to Staking  
 Effective Nov. 5, 1982,  
 Section 36(1) (a) The Mining Act.

KENNY TP. M. 968 **OFFICE USE ONLY**

MC LAREN TP. M. 1016

HAMMELL TP. M. 913

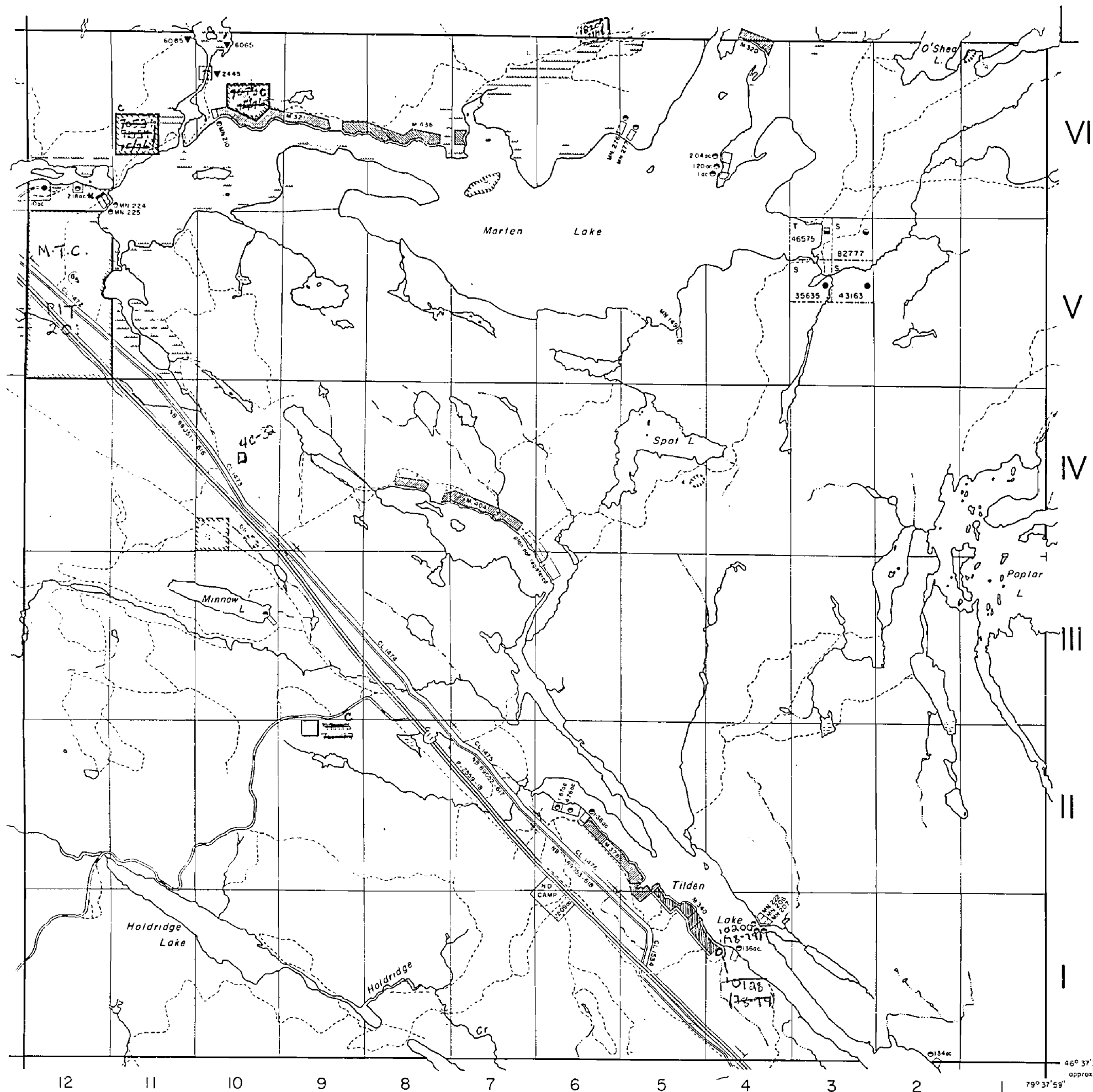

- HIGHWAY AND ROUTE No.
- OTHER ROADS
- TRAILS
- SURVEYED LINES:  
 TOWNSHIPS, BASE LINES, ETC.
- LOTS, MINING CLAIMS, PARCELS, ETC.
- UNSURVEYED LINES:  
 LOT LINES
- PARCEL BOUNDARY
- MINING CLAIMS ETC.
- RAILWAY AND RIGHT OF WAY
- UTILITY LINES
- NON-PERENNIAL STREAM
- FLOODING OR FLOODING RIGHTS
- SUBDIVISION
- ORIGINAL SHORELINE
- MARSH OR MUSKEG
- MINES

**DISPOSITION OF CROWN LANDS**

- | TYPE OF DOCUMENT                | SYMBOL |
|---------------------------------|--------|
| PATENT, SURFACE & MINING RIGHTS |        |
| " SURFACE RIGHTS ONLY           |        |
| " MINING RIGHTS ONLY            |        |
| LEASE, SURFACE & MINING RIGHTS  |        |
| " SURFACE RIGHTS ONLY           |        |
| " MINING RIGHTS ONLY            |        |
| LICENCE OF OCCUPATION           |        |
| CROWN LAND SALE                 |        |
| ORDER-IN-COUNCIL                |        |
| RESERVATION                     |        |
| CANCELLED                       |        |
| SAND & GRAVEL                   |        |

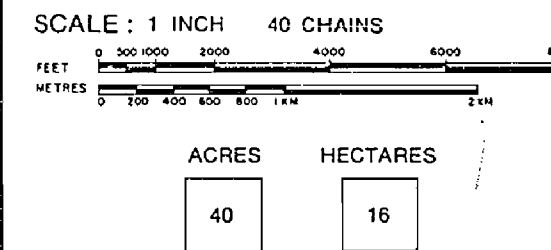

TOWNSHIP  
**GLADMAN**  
 DISTRICT  
 NIPISSING  
 MINING DIVISION  
 SUDBURY

Ministry of Natural Resources  
 Ontario Surveys and Mapping Branch  
 Date Oct. 17, 75      Plan No. M.1021  
 Whitney Block  
 Queen's Park, Toronto

LYMAN TP. M. 1001

46° 37' 30" approx.



**NOTES**

400' surface rights reservation along the shores of all lakes and rivers.

**FLOODING**

Ontario Hydro flooding of Wicksteed Lake to dam elevation 100' - L.O.6065, File:46189.  
Wicksteed Lake—Lands subject to flooding.  
Withdrawn from disposition July,20,1970  
File:160707, vol. 2

**RESERVED**

S.R. - SURFACE RIGHTS		M.R. - MINING RIGHTS	
Designation	Date	Disposition	File
Ⓟ PUBLIC RESERVE	SEPT.13/67	S.R.	93176

**SAND and GRAVEL**

Ⓟ Gravel Reserve File:46189

- Ⓟ Gravel File: 116311
- Ⓟ Gravel File 91677
- Ⓟ M.T.C. Pit 4C-32

Township closed to staking effective May 8 '78. Sec.38(f) of Mining Act.

See File 210-2 for Proposed Prescribed Burn Data

\* IN SERVICE 1983 to 01 - Jc

KENNY TP. M. 968

MC LAREN TP. M.1016

HAMMELL TP. M. 913

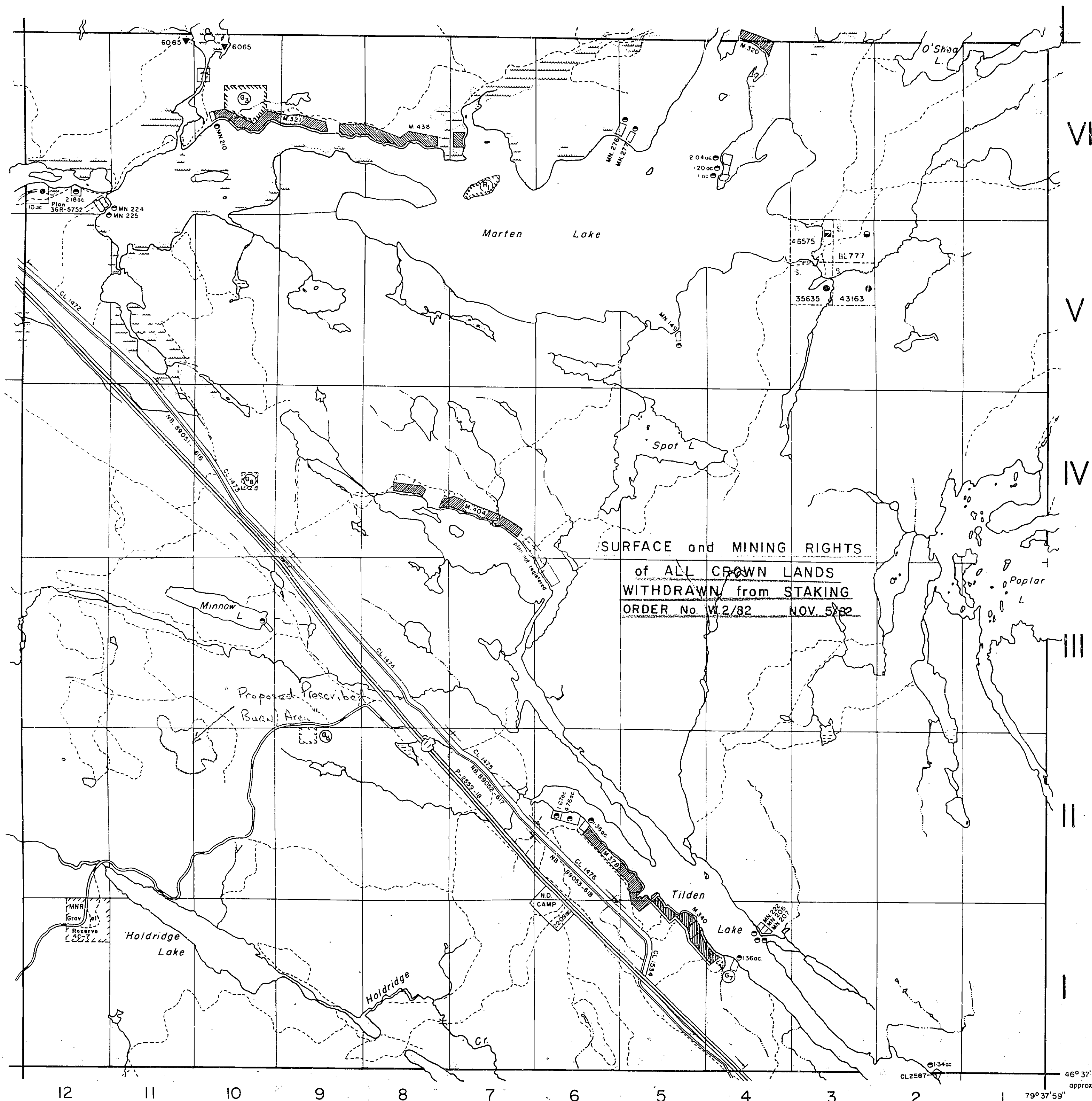

LYMAN TP. M. 1001

**LEGEND**

- HIGHWAY AND ROUTE No.
- OTHER ROADS
- TRAILS
- SURVEYED LINES:
  - TOWNSHIPS, BASE LINES, ETC.
  - LOTS, MINING CLAIMS, PARCELS, ETC.
- UNSURVEYED LINES:
  - LOT LINES
  - PARCEL BOUNDARY
  - MINING CLAIMS ETC.
- RAILWAY AND RIGHT OF WAY
- UTILITY LINES
- NON-PERENNIAL STREAM
- FLOODING OR FLOODING RIGHTS
- SUBDIVISION
- ORIGINAL SHORELINE
- MARSH OR MUSKEG
- MINES

**DISPOSITION OF CROWN LANDS**

TYPE OF DOCUMENT	SYMBOL
PATENT, SURFACE & MINING RIGHTS	●
" SURFACE RIGHTS ONLY	○
" MINING RIGHTS ONLY	◐
LEASE, SURFACE & MINING RIGHTS	◑
" SURFACE RIGHTS ONLY	◒
" MINING RIGHTS ONLY	◓
LICENCE OF OCCUPATION	◔
CROWN LAND SALE	◕
ORDER-IN-COUNCIL	◖
RESERVATION	◗
CANCELLED	◘
SAND & GRAVEL	◙

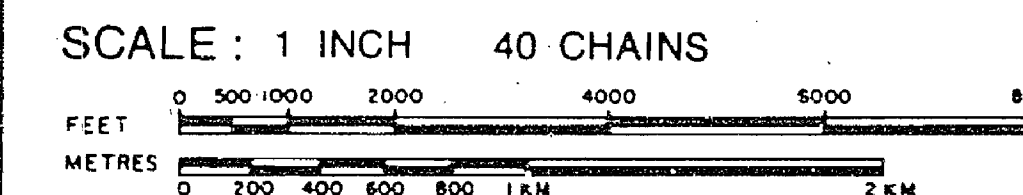

ACRES	HECTARES
40	16

TOWNSHIP

**GLADMAN**

DISTRICT

NIPISSING

MINING DIVISION

SUDBURY



Ministry of Natural Resources

Ontario Surveys and Mapping Branch

Date Oct. 17, 75  
Whitney Block  
Queen's Park, Toronto

Plan No. **M.1021**