

**Terms of Use:** NOTICE: This is a dated, archived document that does not represent current mining claim activity in Ontario. This archived document is provided for information purposes only and MNDM and the Government of Ontario accept no liability and make no warranty or any representation regarding the use, accuracy, applicability, completeness, performance, availability, security or reliability of the information. \*This archive "Historical Claim Map" does not meet provincial accessibility standards. If you need accessible formats, communication support or would like information about this map please contact the Provincial Recording Office @ 1-888-415-9845 Ext 5784. For current mining claim status, please use the MNDM online claim maps website at: <http://www.mndm.gov.on.ca/en/mines-and-minerals/applications/claimaps>

PLAN OF  
**KIRK WALL TWP.** M-972  
SUDBURY MINING DIVISION.  
DISTRICT OF ALGOMA.

NOTE  
400' Surface Rights Reservation  
around all Lakes and Rivers.

Scale, 40 chains to an inch

**STEFANSSON TWP.**

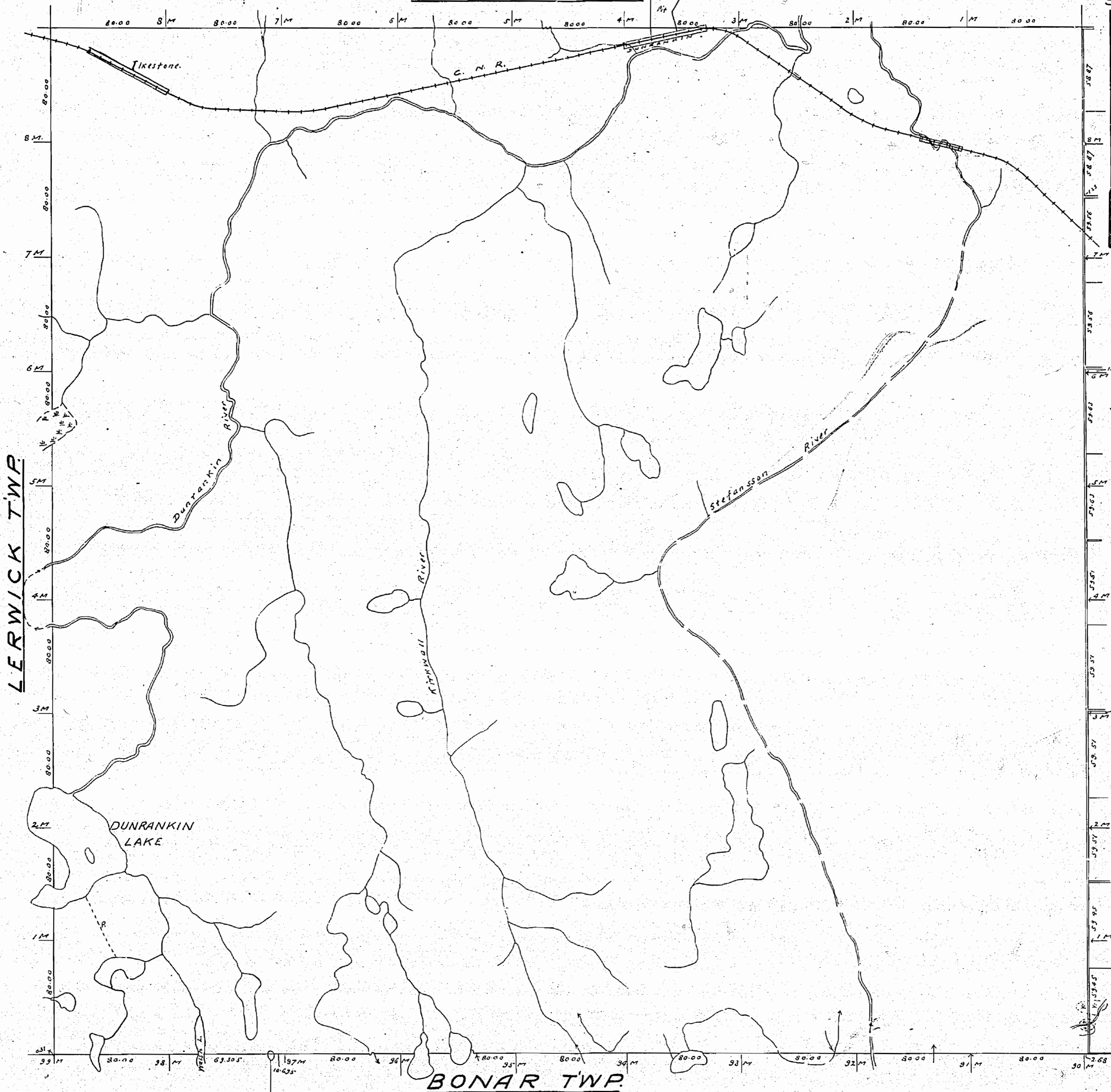

**LERWICK TWP.**

**KAPUSKASING TWP.**

**BONAR TWP.**

**NOTES.**

Railways shown thus	Non-perennial streams
Paved Highways	Bridges
Gravel	Buildings
Other Roads	Swamps
Highway Route Nos.	Areas marked (P) are Patented
Trails & Paths	(L) are Leased
Telephone & Telegraph Lines	(L.O) are held under License of Occupation
Electric Power Lines	

THE INFORMATION THAT APPEARS ON THIS MAP HAS BEEN COMPILED FROM VARIOUS SOURCES AND ACCURACY IS NOT GUARANTEED. THOSE WISHING TO STAKE CLAIMS WITH THE MINING RECORDER, MINISTRY OF NORTHERN DEVELOPMENT AND MINES FOR ADDITIONAL INFORMATION ON THE STATUS OF THE LANDS SHOWN HEREON.

# PLAN OF KIRKWALL TWP.

## MINING DIVISION

### DISTRICT OF ALGOMA.

NOTE  
400' Surface Rights Reservation  
around all Lakes and Rivers.

Scale 40 chains to an inch

STEFFANSSON TWP.

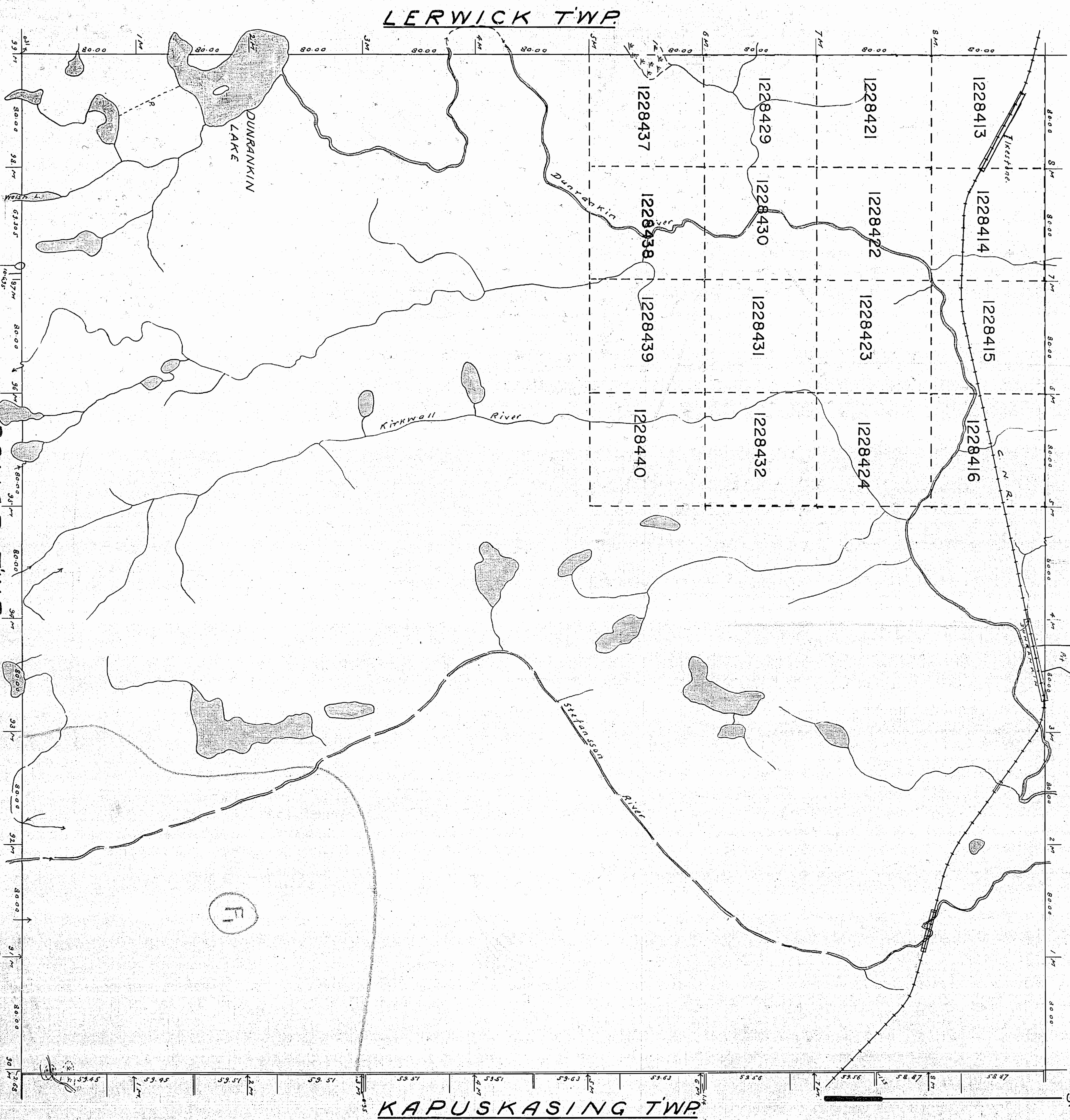

**NOTES**

- Railways shown thus: [Symbol]
- Gravel [Symbol]
- Other Roads [Symbol]
- Highway Route No. [Symbol]
- Electric Power Lines [Symbol]
- Non-perennial streams [Symbol]
- Bridges [Symbol]
- Swamps [Symbol]
- Road marked [Symbol]
- Leases [Symbol]
- ore [Symbol]
- ore patented [Symbol]
- License of Occupation [Symbol]

(F) This Twp is subject to Forest Act in 1958  
Further information available on file.

**RECEIVED**  
OCT 9 1958  
788011212128413

226

M. 25  
912

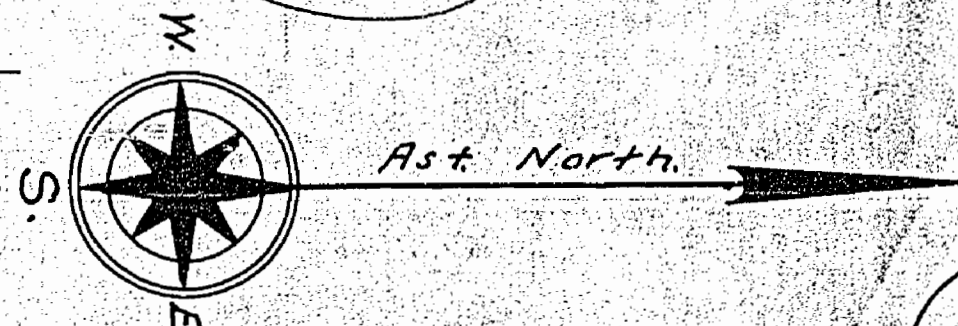

KAPUSKASING TWP.

BONNAR TWP.

LERWICK TWP.

972

PLAN OF  
**KIRK WALL TWP.** M-972  
 SUDBURY MINING DIVISION.  
 DISTRICT OF ALGOMA.

NOTE  
 400' Surface Rights Reservation  
 around all Lakes and Rivers.

Scale, 40 chains to an inch

STEFANSSON TWP.

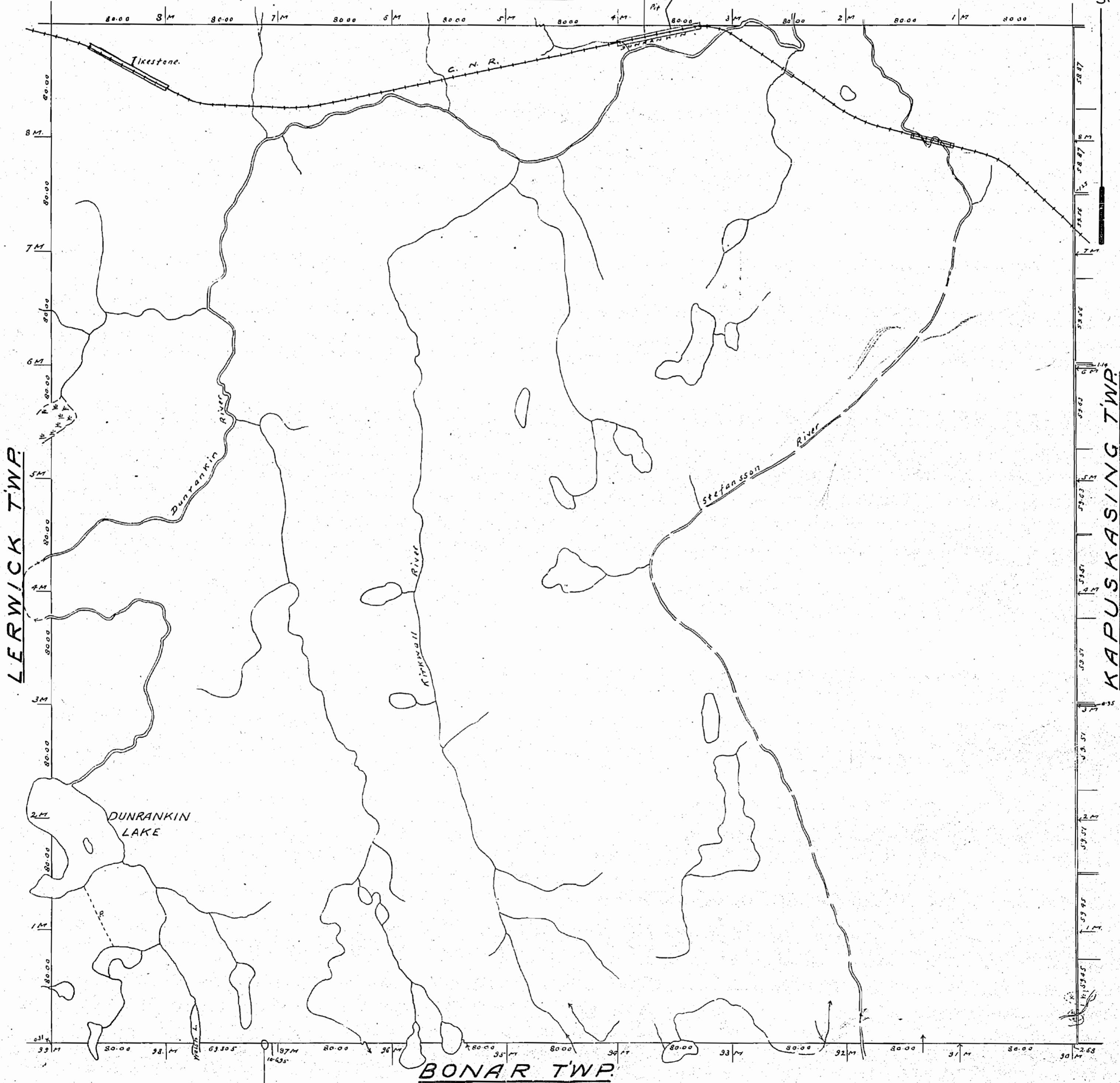

BONAR TWP.

NOTES.

Railways shown thus	Non-perennial streams
Paved Highways	Bridges
Gravel	Buildings
Other Roads	Swamps
Highway Route Nos.	Areas marked
Trails & Paths	⊙ are Patented
Telephony & Telegraph Lines	⊙ are Leased
Electric Power Lines	⊙ are held under License of Occupation