

Terms of Use: NOTICE: This is a dated, archived document that does not represent current mining claim activity in Ontario. This archived document is provided for information purposes only and MNDM and the Government of Ontario accept no liability and make no warranty or any representation regarding the use, accuracy, applicability, completeness, performance, availability, security or reliability of the information. *This archive "Historical Claim Map" does not meet provincial accessibility standards. If you need accessible formats, communication support or would like information about this map please contact the Provincial Recording Office @ 1-888-415-9845 Ext 5784. For current mining claim status, please use the MNDM online claim maps website at: <http://www.mndm.gov.on.ca/en/mines-and-minerals/applications/claimaps>

PLAN OF BOMPAS TWP.

LARDER LAKE MINING DIVISION.
DISTRICT OF TIMISKAMING

— Scale 40 chains to an inch —

M-330 W

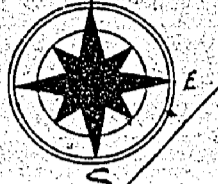

LEE TWP.

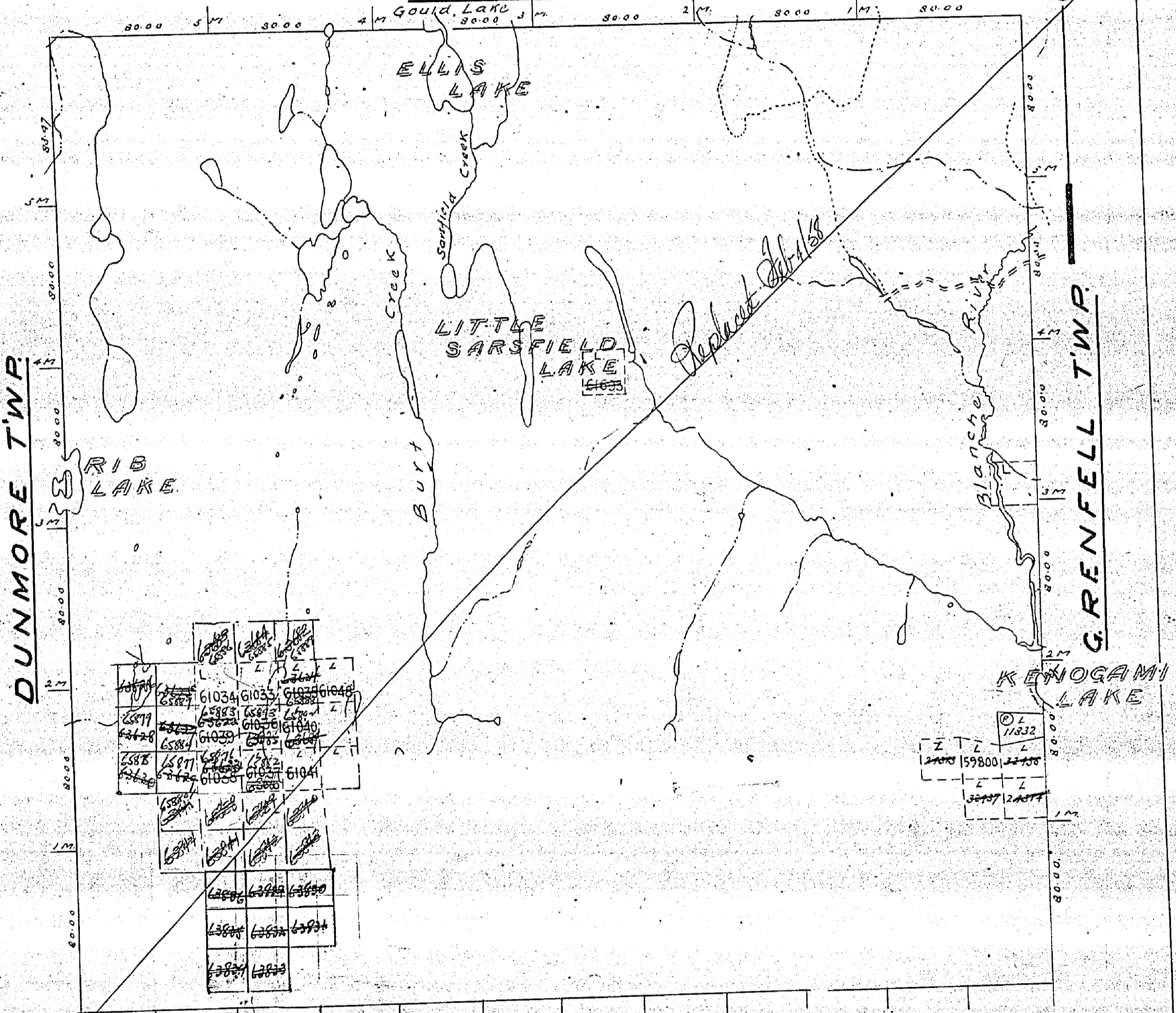

DUNMORE TWP.

G. RENFELL TWP.

BURT TWP.

Notes

- Railways shown
- Paved Highways
- Gravel
- Highway Route No.
- Other Roads
- Trails & Paths
- Telephone & Telegraph Lines
- Electric Power Lines
- Surface reservations 400' wide by Dept. of L. & F. shown
- Non-perennial streams
- Bridges
- Buildings
- Swamps
- Areas marked (L) are Potentially Leased held under Licence of Occupation!

11832
59800
12437

MINING RECORDER
RECEIVED
JAN 18 1955
SWASTIKA - ONT.

330

Lancaster

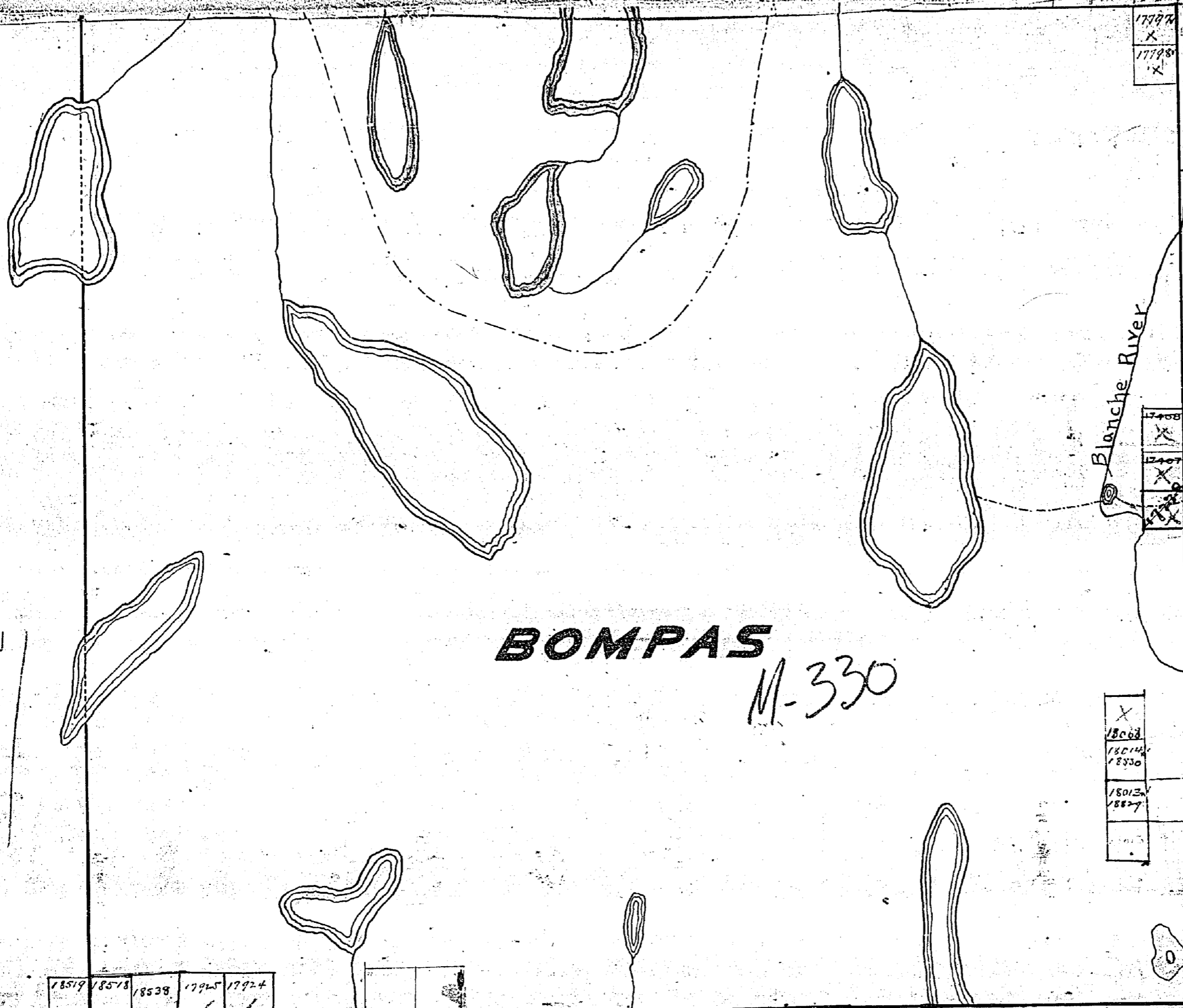

BOMPAS

M-330

GRENFELL

18519	18518	18538	17925	17924
-------	-------	-------	-------	-------

BURT

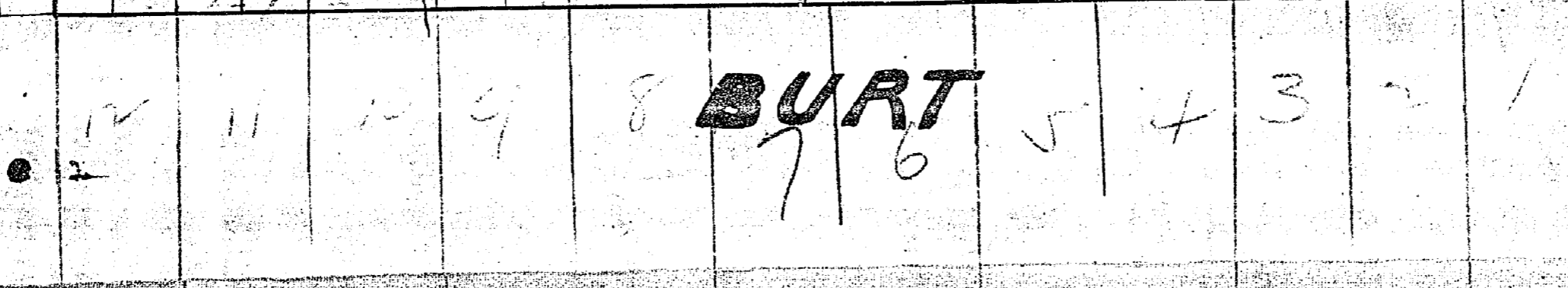

X
18003
18014
18015
18016
18017
18018
18019
18020
18021
18022
18023
18024
18025
18026
18027
18028
18029
18030
18031
18032
18033
18034
18035
18036
18037
18038
18039
18040
18041
18042
18043
18044
18045
18046
18047
18048
18049
18050
18051
18052
18053
18054
18055
18056
18057
18058
18059
18060
18061
18062
18063
18064
18065
18066
18067
18068
18069
18070
18071
18072
18073
18074
18075
18076
18077
18078
18079
18080
18081
18082
18083
18084
18085
18086
18087
18088
18089
18090
18091
18092
18093
18094
18095
18096
18097
18098
18099
18100

PLAN OF BOMPAS TWP.

MINING RECORDER
RECEIVED
JUN 12 1921
KIRKLAND LAKE - ONT.

ORDER LAKE MINING DIVISION.
DISTRICT OF TIMISKAMING

— Scale 40 chains to an inch —

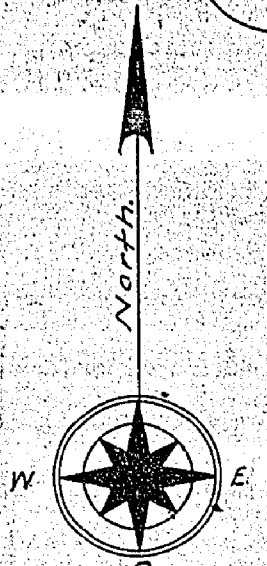

M-330

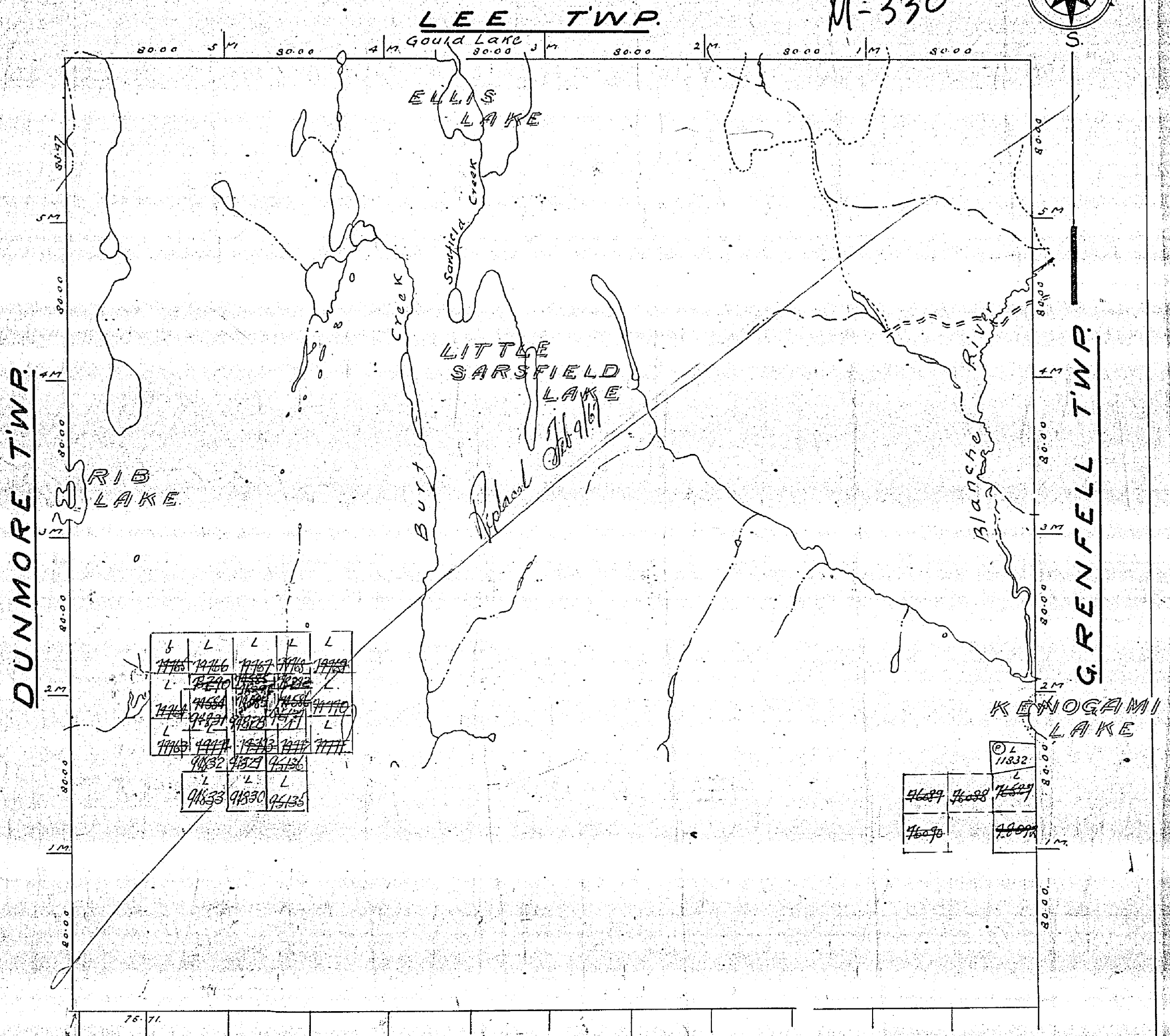

1715	1716	1717	1718	1719
1720	1721	1722	1723	1724
1725	1726	1727	1728	1729
1730	1731	1732	1733	1734
1735	1736	1737	1738	1739
1740	1741	1742	1743	1744
1745	1746	1747	1748	1749
1750	1751	1752	1753	1754
1755	1756	1757	1758	1759
1760	1761	1762	1763	1764

11332	11333	11334
11335	11336	11337

Notes

- Railways shown
- Paved Highways
- Gravel
- Highway Route No.
- Other Roads
- Trails & Paths
- Telephone & Telegraph Lines
- Electric Power Lines
- Surface reservations 400' wide by Dept. of L & F shown
- Non-perennial streams
- Bridges
- Buildings
- Swamps
- Areas marked (C) are Patented
- (L) are Leased
- (O) are held under Licence of Occupation

CROWN LAND SALE
LOCATED LAND
MINING RIGHTS ONLY
SURFACE RIGHTS ONLY
CANCELLED

C.S.
Loc.
M.R.O.
S.R.O.
C.

MINING RECORDER
RECEIVED
FEB 1 1958
SIVASTIKA - ONT.

PLAN OF BOMPAS TWP. LARDER LAKE MINING DIVISION. DISTRICT OF TIMISKAMING

— Scale 40 chains to an inch —

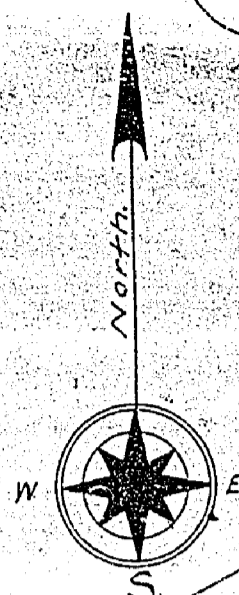

LEE TWP.

M-330

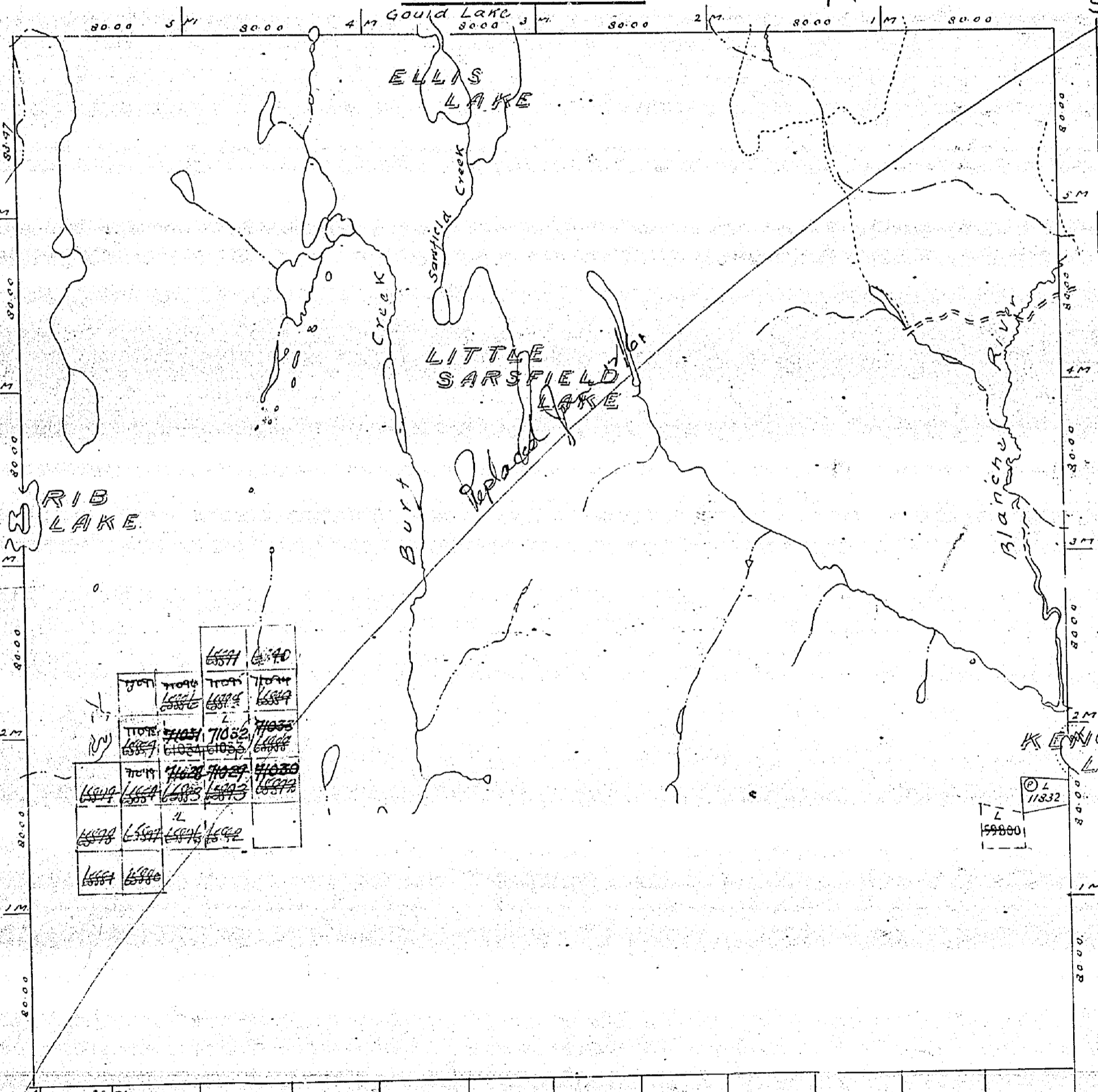

DUNMORE TWP.

G. RENFELL TWP.

BURT TWP.

7071	7096	7101	7104
6557	6576	6584	6589
7105	7107	7108	7109
6559	6561	6562	6563
7111	7128	7129	7130
6564	6565	6566	6567
6568	6569	6570	6571
6572	6573	6574	6575
6576	6577	6578	6579
6580	6581	6582	6583

Notes

- Railways shown
- Paved Highways
- Gravel
- Highway Route Nos.
- Other Roads
- Trails & Paths
- Telephone & Telegraph Lines
- Electric Power Lines
- Sulfate reservations 400' wide by Dept of L. & F. shown
- Non-perennial streams
- Bridges
- Buildings
- Swamps
- Areas marked (L) are Patented Leases held under Licence of Occupation

#13

PLAN OF BOMPAS TWP.

LARDER LAKE MINING DIVISION. DISTRICT OF TIMISKAMING

— Scale 40 chains to an inch —

m. 330 W

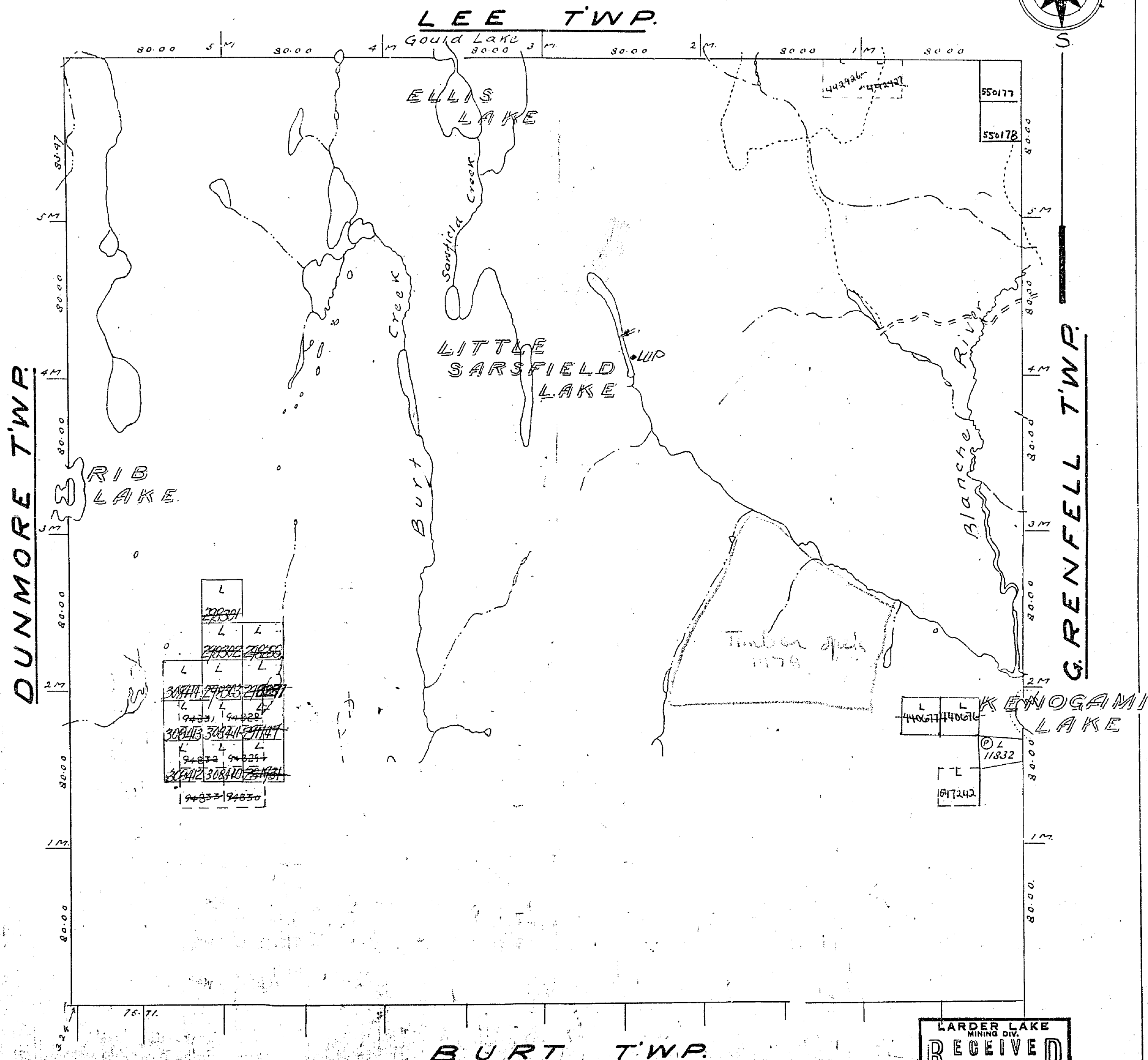
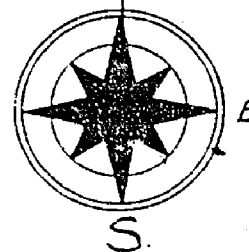

L	
20291	
20291	L
20302	20302
L	L
30844	30844
L	L
19433	19433
30843	30843
L	L
19433	19433
30842	30842
19433	19433

L	L
44067	44067
L	L
11832	
L	
197242	

Notes

Railways shown
 Paved Highways
 Gravel
 Highways Railways
 100' surface marks reservation around all lakes and rivers

Non-perennial streams
 Bridges
 Buildings
 Swamps
 Patented
 Leases
 Held under
 License of Occupation

LARDER LAKE
 MINING DIV.
RECEIVED
 FEB 9 - 1967

Crown Land Sale # 4518
 Located Land
 Mining Rights Only
 Surface Rights Only
 Cancelled
 C.S. Loc. M.R. S.R.O. C.

Respected by M. J. [Signature]
 Feb 7/67

PLAN OF
BOMPAS TWP.
 LARDER LAKE MINING DIVISION.
 DISTRICT OF TIMISKAMING
 — Scale 40 chains to an inch —

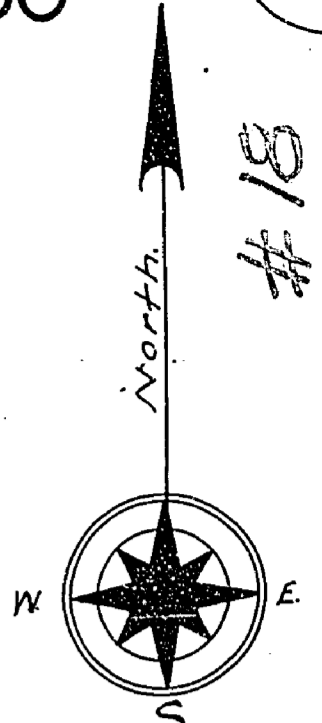

#18

LEE TWP.

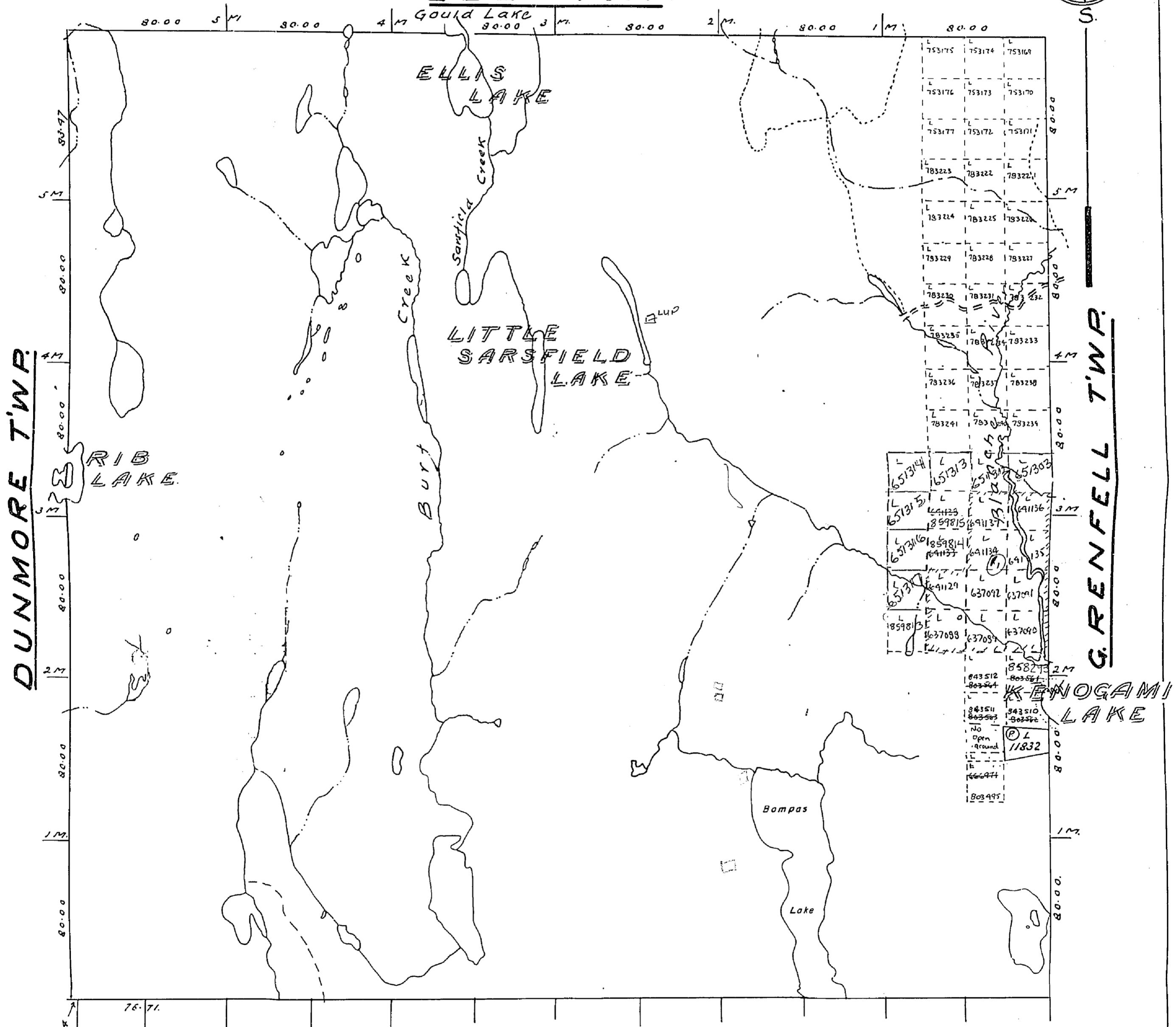

DUNMORE TWP.

GRENFELL TWP.

BURT TWP.

Notes

- Railways shown
- Paved Highways
- Gravel Highways
- Highway Route Nos.
- Other Roads
- Trails & Paths
- Telephone & Telegraph Lines
- Electric Power Lines

- Non-perennial streams
- Bridges
- Buildings
- Swamps
- Areas marked are Patented
- are Leased
- are held under Licence of Occupation

CROWN LAND SALE
 LOCATED LAND
 MINING RIGHTS ONLY
 SURFACE RIGHTS ONLY
 CANCELLED

C.S.
 Loc.
 M.R.O.
 S.R.O.
 C.

400' Surface rights reservation around all lakes and rivers.

with drawn
 Sec 36/80 W. 9/86 24/01/80 mts

Areas shown in red Canadian Forestry Service Study Plots MNR 18/10/10 Lake Dist

G-3605

AREAS WITHDRAWN FROM DISPOSITION

- M.H.O. - MINING RIGHTS ONLY
- S.R.O. - SURFACE RIGHTS ONLY
- M.+S. - MINING AND SURFACE RIGHTS

Description	Order No.	Date	Disposition	File
SEC 36/80	W9/86	24/01/86	M.+S.	
SEC 35/80	04-27/85	25/01/85	M.S.	

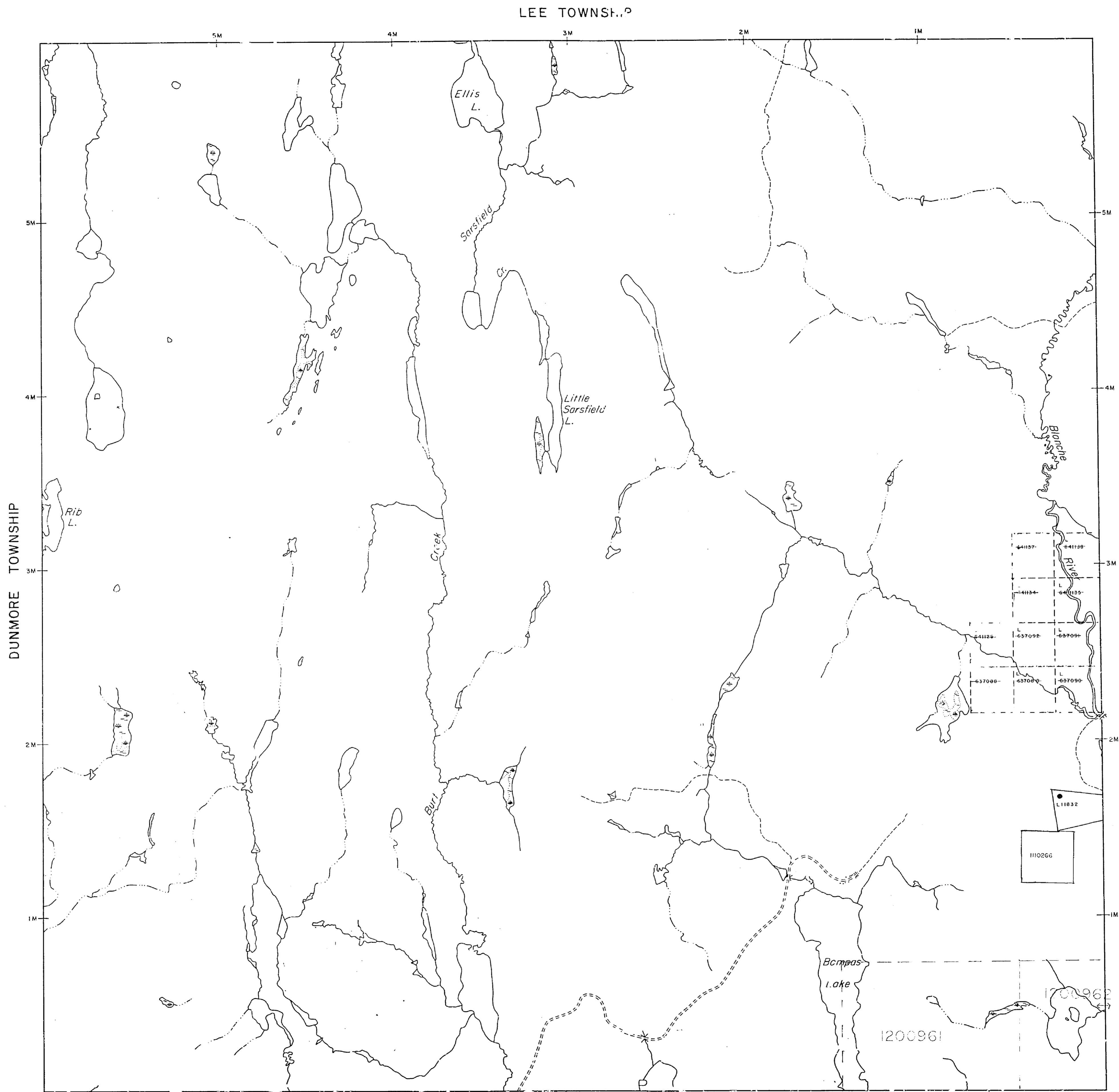

LEGEND

HIGHWAY AND ROUTE No.	
OTHER ROADS	
TRAILS	
SURVEYED LINES	
TOWNSHIPS, BASE LINES, ETC.	
LOTS, MINING CLAIMS, PARCELS, ETC.	
UNSURVEYED LINES	
LOT LINES	
PARCEL BOUNDARY	
MINING CLAIMS ETC.	
RAILWAY AND RIGHT OF WAY	
UTILITY LINES	
NON PERENNIAL STREAM	
FLOODING OR FLOODING RIGHTS	
SUBDIVISION OR COMPOSITE PLAN	
RESERVATIONS	
ORIGINAL SHORELINE	
MARSH OR MUSKEG	
MINES	
TRAVERSE MONUMENT	

DISPOSITION OF CROWN LANDS

TYPE OF DOCUMENT	SYMBOL
PATENT, SURFACE & MINING RIGHTS	
" SURFACE RIGHTS ONLY	
" MINING RIGHTS ONLY	
LEASE, SURFACE & MINING RIGHTS	
" SURFACE RIGHTS ONLY	
" MINING RIGHTS ONLY	
LICENCE OF OCCUPATION	
ORDER IN COUNCIL	
RESERVATION	
CANCELLED	
SAND & GRAVEL	

NOTE: MINING RIGHTS IN PARCELS PATENTED PRIOR TO MAY 6, 1913, VESTED IN ORIGINAL PATENTEE BY THE PUBLIC LANDS ACT, R.S.O. 1970, CHAP. 380, SEC. 63, SUBSEC. 1.

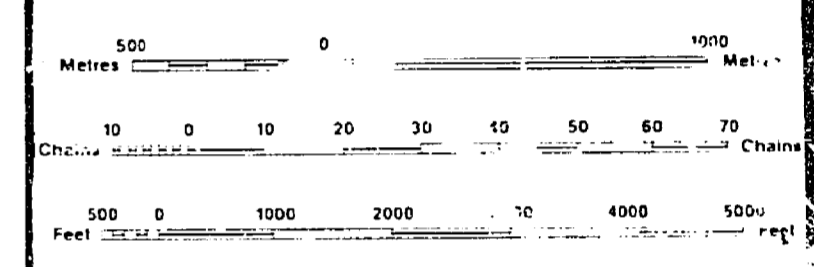

SCALE 1:20 000

NOTICE OF FORESTRY ACTIVITY
 THIS TOWNSHIP AREA FALLS WITHIN THE
 PLONSKI FOREST MANAGEMENT UNIT
 AND MAY BE SUBJECT TO FORESTRY ACTIVITY OPERATIONS.
 THE MNR UNIT FORESTER FOR THIS AREA CAN BE
 CONTACTED AT:
 P.O. BOX 129
 SWASTIKA, ONTARIO
 POK 1T0
 705-642-3222

THE INFORMATION THAT APPEARS ON THIS MAP HAS BEEN COMPILED FROM VARIOUS SOURCES, AND ACCURACY IS NOT GUARANTEED. THOSE WISHING TO STAKE MINING CLAIMS SHOULD CONSULT WITH THE MINING RECORDER, MINISTRY OF NORTHERN DEVELOPMENT AND MINES FOR ADDITIONAL INFORMATION ON THE STATUS OF THE LANDS SHOWN HEREON.

TOWNSHIP
BOMPAS
 M.N.R. ADMINISTRATIVE DISTRICT
KIRKLAND LAKE
 MINING DIVISION
LARDER LAKE
 LAND TITLES / REGISTRY DIVISION
TIMISKAMING

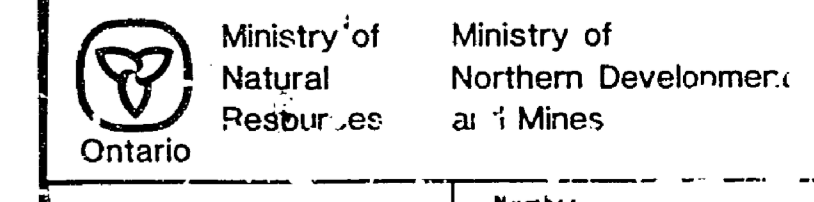

Date: AUGUST, 1986
 Number: **G-3605**
 APPROVED MARCH 24/97

BOMPAZ I.M.15

G-3602

G-3602

G-3602

G-3602

C-3602

AREAS WITHDRAWN FROM DISPOSITION

- M.R.O. - MINING RIGHTS ONLY
- S.R.O. - SURFACE RIGHTS ONLY
- M.+S. - MINING AND SURFACE RIGHTS

Description	Order No.	Date	Disposition	File
SEC 36/80	W9/86	24/01/86	M+S	
SEC 35/80	O-L-27/85	05/01/85	M+S	

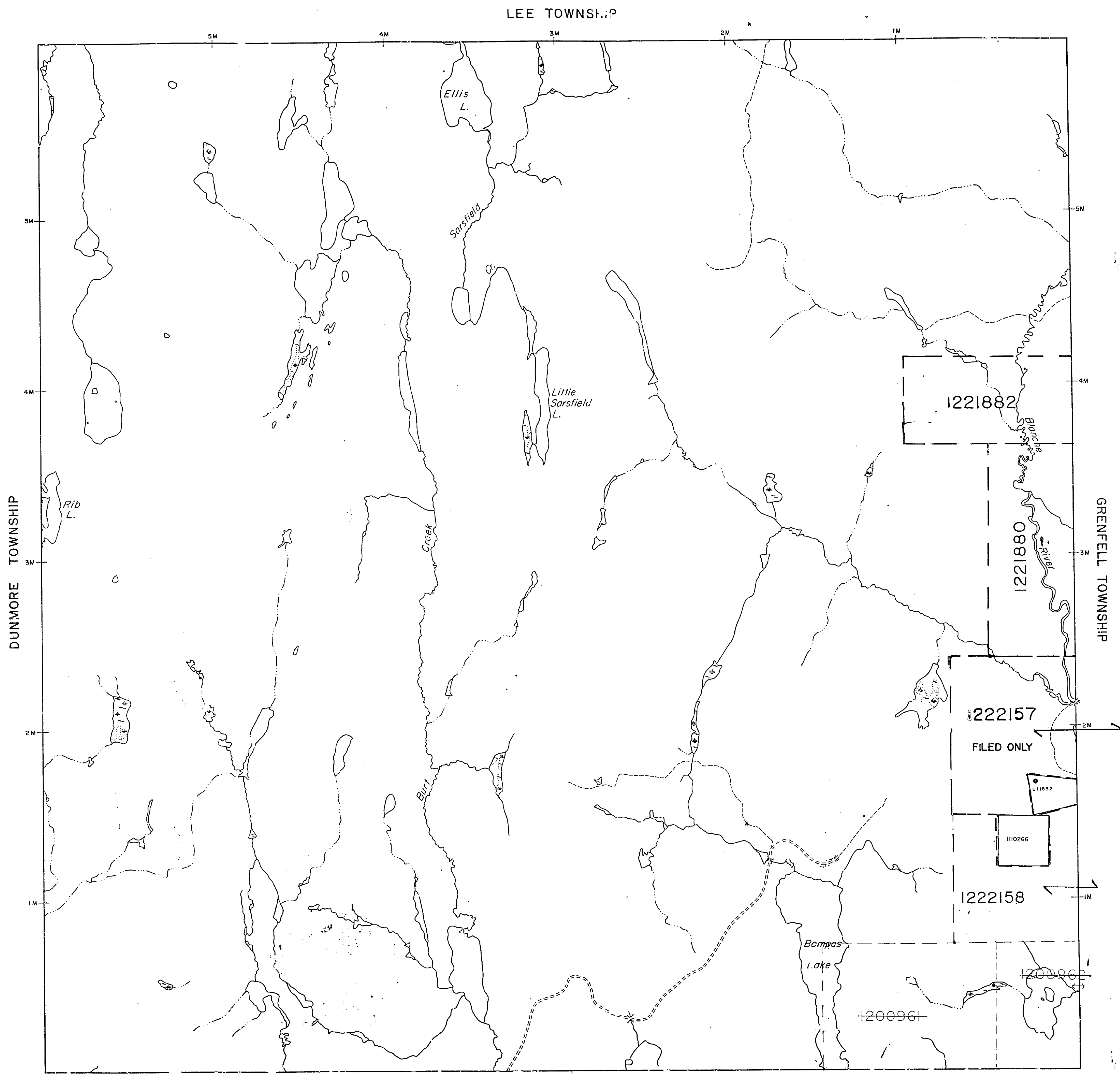

LEGEND

HIGHWAY AND ROUTE No	
OTHER ROADS	
TRAILS	
SURVEYED LINES	
TOWNSHIPS, BASE LINES, ETC	
LOTS, MINING CLAIMS, PARCELS, ETC	
UNSURVEYED LINES	
LOT LINES	
PARCEL BOUNDARY	
MINING CLAIMS ETC	
RAILWAY AND RIGHT OF WAY	
UTILITY LINES	
NON-PERENNIAL STREAM	
FLOODING OR FLOODING RIGHTS	
SUBDIVISION OR COMPOSITE PLAN	
RESERVATIONS	
ORIGINAL SHORELINE	
MARSH OR MUSKEG	
MINES	
TRAVERSE MONUMENT	

DISPOSITION OF CROWN LANDS

TYPE OF DOCUMENT	SYMBOL
PATENT, SURFACE & MINING RIGHTS	
" SURFACE RIGHTS ONLY	
" MINING RIGHTS ONLY	
LEASE, SURFACE & MINING RIGHTS	
" SURFACE RIGHTS ONLY	
" MINING RIGHTS ONLY	
LICENCE OF OCCUPATION	
ORDER-IN-COUNCIL	
RESERVATION	
CANCELLED	
SAND & GRAVEL	

NOTE: MINING RIGHTS IN PARCELS PATENTED PRIOR TO MAY 6, 1913, VESTED IN ORIGINAL PATENTEE BY THE PUBLIC LANDS ACT, R.S.O. 1970, CHAP. 380, SEC. 63, SUBSEC. 1

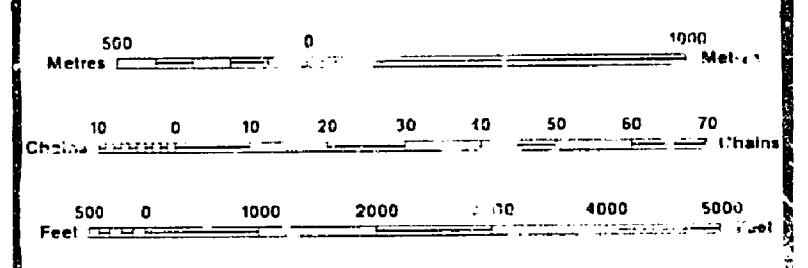

SCALE 1:20 000

THE INFORMATION THAT APPEARS ON THIS MAP HAS BEEN COMPILED FROM VARIOUS SOURCES, AND ACCURACY IS NOT GUARANTEED. THOSE WISHING TO STAKE MINING CLAIMS SHOULD CONSULT WITH THE MINING RECORDER, MINISTRY OF NORTHERN DEVELOPMENT AND MINES, FOR ADDITIONAL INFORMATION ON THE STATUS OF THE LANDS SHOWN HEREON.

NOTICE OF FORESTRY ACTIVITY
 THIS TOWNSHIP AREA FALLS WITHIN THE
 PLONSKI FOREST MANAGEMENT UNIT
 AND MAY BE SUBJECT TO FORESTRY ACTIVITY OPERATIONS.
 THE MNR UNIT FORESTER FOR THIS AREA CAN BE
 CONTACTED AT: P.O. BOX 129
 SWASTIKA, ONTARIO
 POK 1T0
 705-642-3222.

TOWNSHIP
BOMPAS
 M.N.R. ADMINISTRATIVE DISTRICT
 KIRKLAND LAKE
 MINING DIVISION
 LARDER LAKE
 LAND TITLES / REGISTRY DIVISION
TIMISKAMING

DATE OF ISSUE
 APR 01 1988
 PROVINCIAL RECORDING
 OFFICE - SUDBURY

Ministry of Natural Resources Ontario
 Ministry of Northern Development and Mines
 Date: AUGUST, 1986
 Number: **G-3605**
 ARCHIVED MARCH 24/97

BOMBAS

C-3602

C-3602

BOMBAS

C-3602