

Terms of Use: NOTICE: This is a dated, archived document that does not represent current mining claim activity in Ontario. This archived document is provided for information purposes only and MNDM and the Government of Ontario accept no liability and make no warranty or any representation regarding the use, accuracy, applicability, completeness, performance, availability, security or reliability of the information. *This archive "Historical Claim Map" does not meet provincial accessibility standards. If you need accessible formats, communication support or would like information about this map please contact the Provincial Recording Office @ 1-888-415-9845 Ext 5784. For current mining claim status, please use the MNDM online claim maps website at: <http://www.mndm.gov.on.ca/en/mines-and-minerals/applications/claimaps>

NOTES

400 surface rights reservation along the shores of all lakes and rivers

THE INFORMATION THAT APPEARS ON THIS MAP HAS BEEN COMPILED FROM VARIOUS SOURCES, AND ACCURACY IS NOT GUARANTEED. THOSE WISHING TO STAKE MINING CLAIMS SHOULD CONSULT WITH THE MINING RECORDER, MINISTRY OF NORTHERN DEVELOPMENT AND MINES, FOR ADDITIONAL INFORMATION ON THE STATUS OF THE LANDS SHOWN HEREON.

NOTICE OF FORESTRY ACTIVITY.

THIS TOWNSHIP / AREA FALLS WITHIN THE WATABEAG MANAGEMENT UNIT AND MAY BE SUBJECT TO FORESTRY OPERATIONS. THE MNR UNIT FORESTER FOR THIS AREA CAN BE CONTACTED AT: P.O. BOX 129 SWASTIKA, ONT. POK ITO 705-642-3222

BLACK TP. M.329

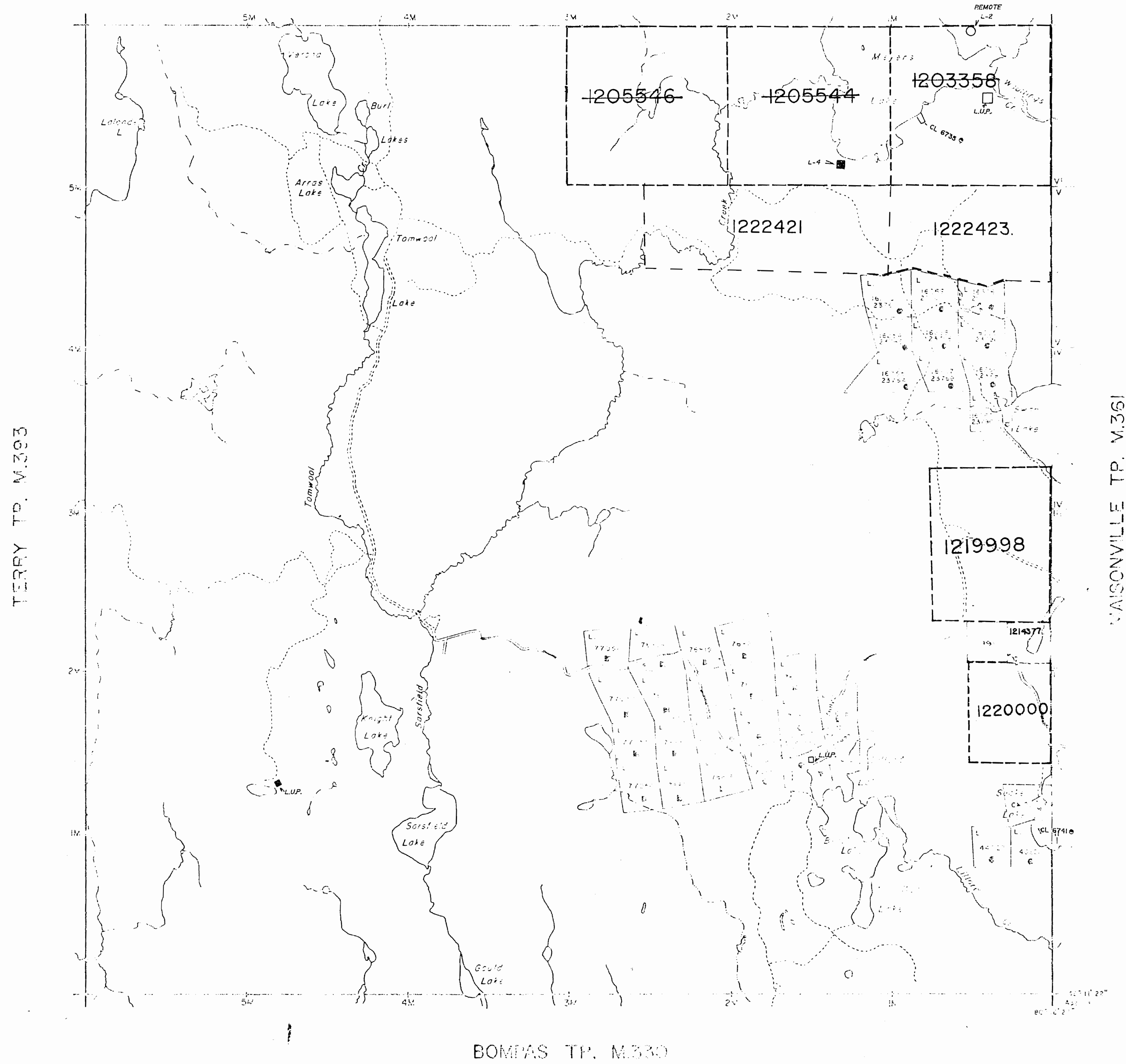

LEGEND

- HIGHWAY AND ROUTE NO.
- OTHER ROADS
- TRAILS
- SURVEYED LINES
 - TOWNSHIP BASE LINES, ETC.
 - LOTS, MINING CLAIMS, PARCELS, ETC.
- UNSURVEYED LINES
 - LOT LINES
 - PARCEL BOUNDARY
 - MINING CLAIMS, ETC.
- RAILWAY AND RIGHT OF WAY
- UTILITY LINES
- NON-PERENNIAL STREAM
- FLOODING OR FLOODING RIGHTS
- SUBDIVISION
- ORIGINAL SHOPELINE
- MARSH OR MUSKEG
- MINES

DISPOSITION OF CROWN LANDS

- TYPE OF DOCUMENT
 - PATENT SURFACE & MINING RIGHTS
 - SURFACE RIGHTS ONLY
 - MINING RIGHTS ONLY
- LEASE SURFACE & MINING RIGHTS
 - SURFACE RIGHTS ONLY
 - MINING RIGHTS ONLY
- LICENCE OF OCCUPATION
- CROWN LAND SALE
- ORDER-IN-COUNCIL
- RESERVATION
- CANCELLED
- SAND & GRAVEL

DATE OF ISSUE

NOV 13 1997

PROVINCIAL RECORDING OFFICE - SUDBURY

SCALE: 1 INCH = 40 CHAINS

ACRES	HECTARES
40	16

TOWNSHIP

V

DISTRICT

TIMISKAMING

MINING DIVISION

LARDER LAKE

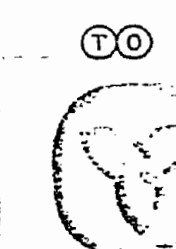

MINISTRY OF NORTHERN DEVELOPMENT AND MINES

Date: JUNE 10, 1968

Plan No.

M.360

ARCHIVED NOVEMBER 15, 1994

ARCHIVED DECEMBER 13, 1996

DATE RECEIVED FEB 8/89

ARCHIVED MAY 1/97

LE E

M 360

#7

LARDER LAKE MINING DIVISION

DISTRICT OF TIMISKAMING

Scale - 40 Chains = 1 Inch.

BLACK

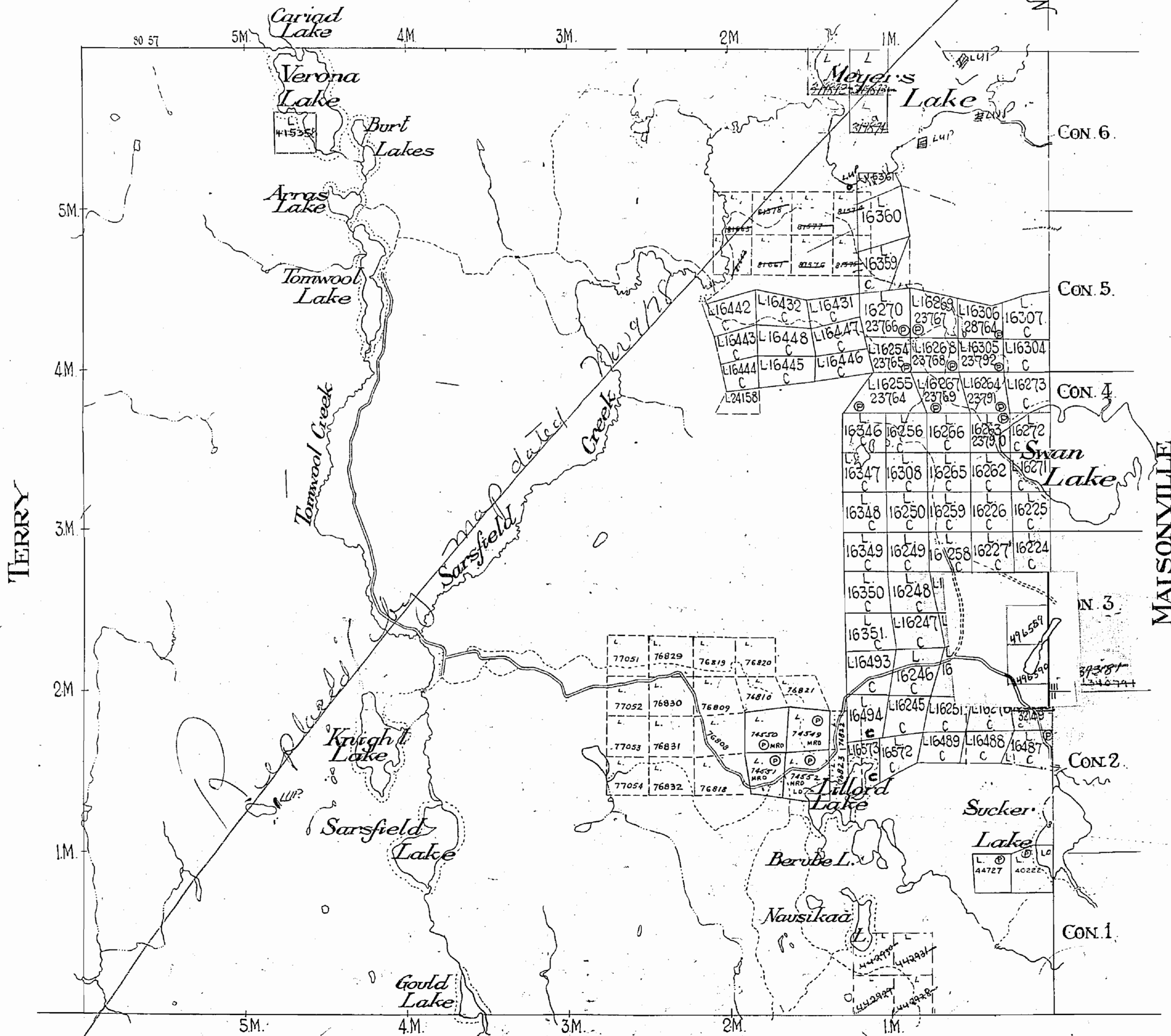

TERRY

MAISONVILLE

Roads
Trail or Path

BOMPAS

LEGEND

- PATENTED ———— ⊙
- LEASED ———— ⊙
- LICENSE OF OCCUPATION ———— ⊙
- CANCELLED ———— C
- CROWN LAND SALE ———— C.S.
- LOCATED LAND ———— LOC
- MINING RIGHTS ONLY ———— M.R.O.
- SURFACE RIGHTS ONLY ———— S.R.O.

LARDER LAKE
MINING DIV.
RECEIVED
JAN - 5 1966
AM
709.10.11.12.34.56

400 Surface rights reservation around all lakes & rivers.

NOTES

400' surface rights reservation along the shores of all lakes and rivers.

BLACK TP. M.329

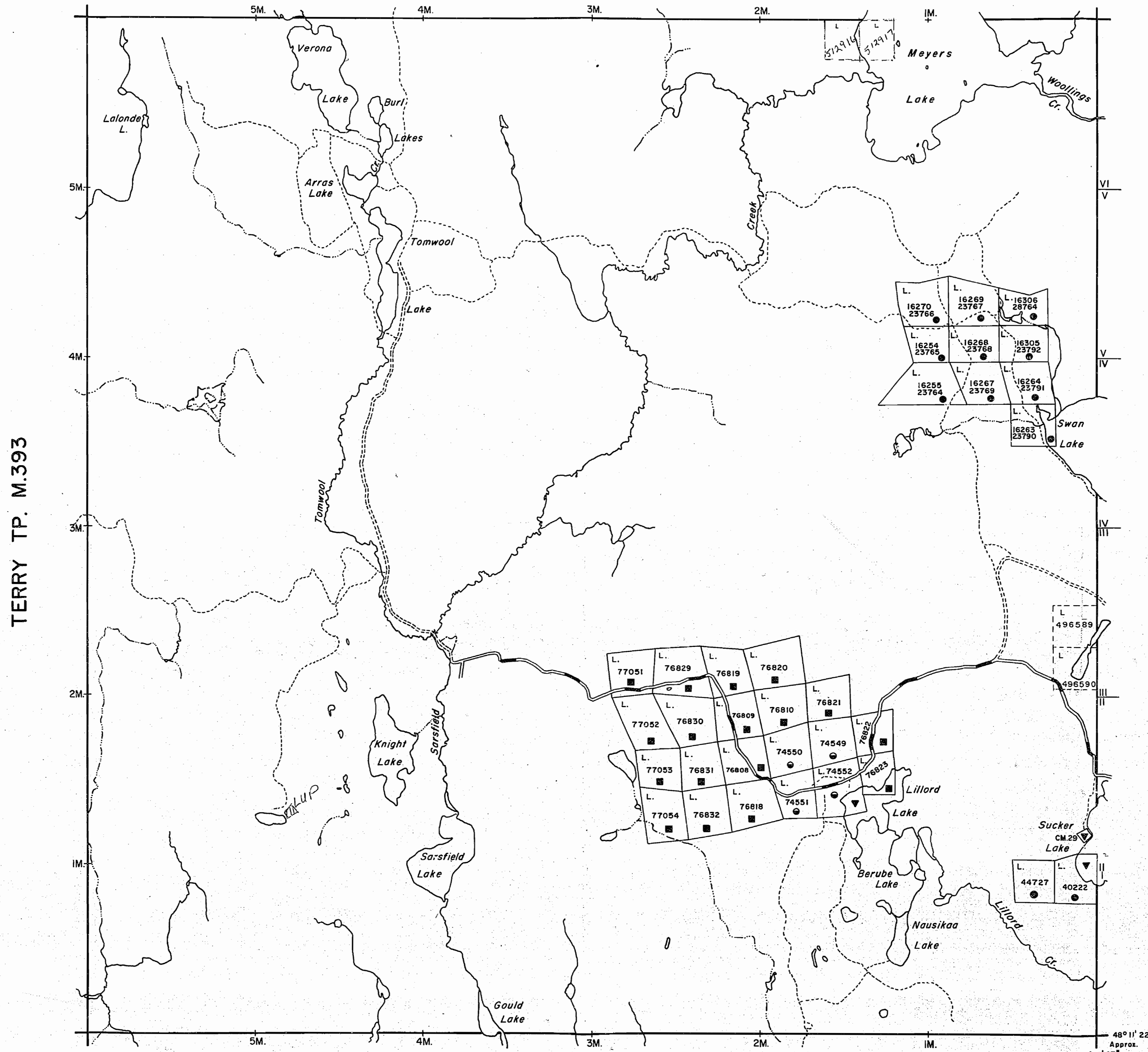

DATE OF ISSUE
10V 9/1978

LEGEND

- HIGHWAY AND ROUTE No.
- OTHER ROADS
- TRAILS
- SURVEYED LINES:
 - TOWNSHIPS, BASE LINES, ETC.
 - LOTS, MINING CLAIMS, PARCELS, ETC.
- UNSURVEYED LINES:
 - LOT LINES
 - PARCEL BOUNDARY
 - MINING CLAIMS ETC.
- RAILWAY AND RIGHT OF WAY
- UTILITY LINES
- NON-PERENNIAL STREAM
- FLOODING OR FLOODING RIGHTS
- SUBDIVISION
- ORIGINAL SHORELINE
- MARSH OR MUSKEG
- MINES

DISPOSITION OF CROWN LANDS

TYPE OF DOCUMENT	SYMBOL
PATENT, SURFACE & MINING RIGHTS	
" SURFACE RIGHTS ONLY	
" MINING RIGHTS ONLY	
LEASE, SURFACE & MINING RIGHTS	
" SURFACE RIGHTS ONLY	
" MINING RIGHTS ONLY	
LICENCE OF OCCUPATION	
CROWN LAND SALE	
ORDER-IN-COUNCIL	
RESERVATION	
CANCELLED	
SAND & GRAVEL	

*Repl. by Mayland
Sept 13/79*

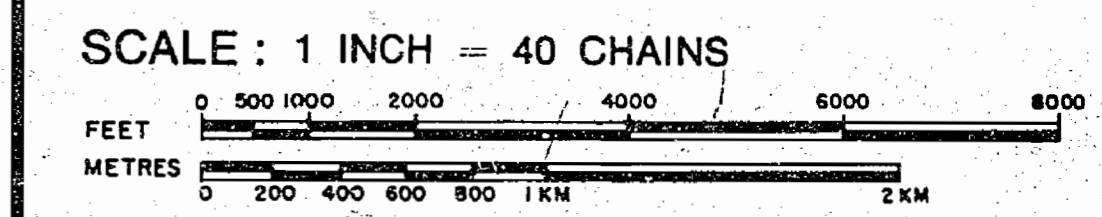

ACRES	HECTARES
40	16

TOWNSHIP
LEE

DISTRICT
TIMISKAMING

MINING DIVISION
LARDER LAKE (7)

Ministry of Natural Resources
Ontario Surveys and Mapping Branch

Date FEB. 11, 75. Plan No. M.360
Whitney Block
Queen's Park, Toronto

BOMPAS TP. M.330

48° 11' 22"
Approx.
80° 16' 27"

NOTES

400' surface rights reservation along the shores of all lakes and rivers.

THE INFORMATION THAT APPEARS ON THIS MAP HAS BEEN COMPILED FROM VARIOUS SOURCES, AND ACCURACY IS NOT GUARANTEED. THOSE WISHING TO STAKE MINING CLAIMS SHOULD CONSULT WITH THE MINING RECORDER, MINISTRY OF NORTHERN DEVELOPMENT AND MINES, FOR ADDITIONAL INFORMATION ON THE STATUS OF THE LANDS SHOWN HEREON.

NOTICE OF FORESTRY ACTIVITY.

THIS TOWNSHIP / AREA FALLS WITHIN THE WATABEAG MANAGEMENT UNIT

AND MAY BE SUBJECT TO FORESTRY OPERATIONS. THE MNR UNIT FORESTER FOR THIS AREA CAN BE CONTACTED AT: P.O. BOX 129 SWASTIKA, ONT. POK ITO 705-642-3222

ARCHIVED NOVEMBER 16, 1994

ARCHIVED DECEMBER 13, 1996

BLACK TP. M.329

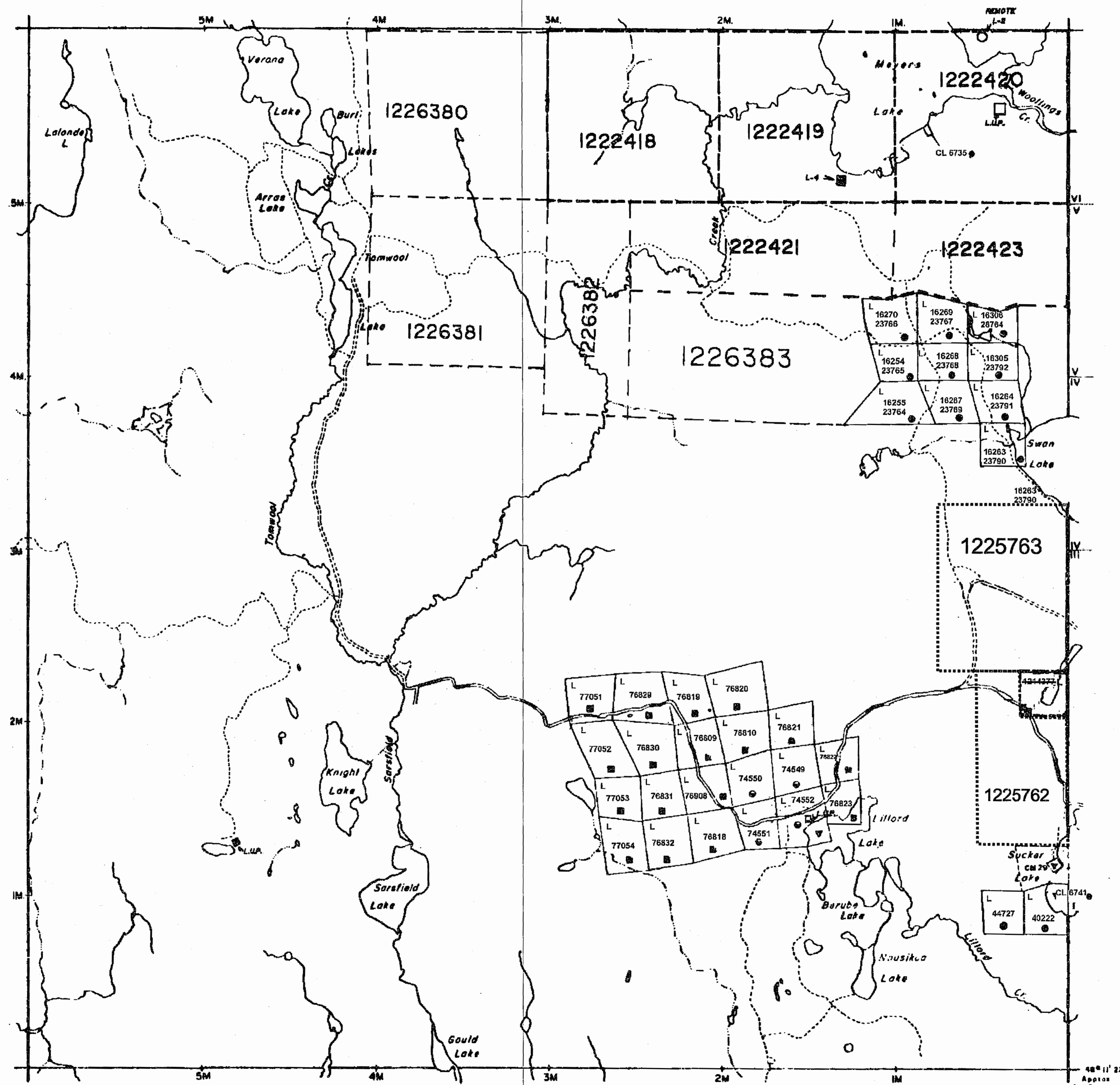

TERRY TP. M.393

MAISONVILLE TP. M.361

BOMPAS TP. M.330

LEGEND

- HIGHWAY AND ROUTE No.
- OTHER ROADS
- TRAILS
- SURVEYED LINES:
 - TOWNSHIPS, BASE LINES, ETC.
 - LOTS, MINING CLAIMS, PARCELS, ETC.
- UNSURVEYED LINES:
 - LOT LINES
 - PARCEL BOUNDARY
 - MINING CLAIMS ETC.
- RAILWAY AND RIGHT OF WAY
- UTILITY LINES
- NON-PERENNIAL STREAM
- FLOODING OR FLOODING RIGHTS
- SUBDIVISION
- ORIGINAL SHORELINE
- MARSH OR MUSKEG
- MINES

DISPOSITION OF CROWN LANDS

- | TYPE OF DOCUMENT | SYMBOL |
|---------------------------------|--------|
| PATENT, SURFACE & MINING RIGHTS | |
| " SURFACE RIGHTS ONLY | |
| " MINING RIGHTS ONLY | |
| LEASE, SURFACE & MINING RIGHTS | |
| " SURFACE RIGHTS ONLY | |
| " MINING RIGHTS ONLY | |
| LICENCE OF OCCUPATION | |
| CROWN LAND SALE | CS |
| ORDER-IN-COUNCIL | OC |
| RESERVATION | |
| CANCELLED | |
| SAND & GRAVEL | |

SCALE: 1 INCH = 40 CHAINS

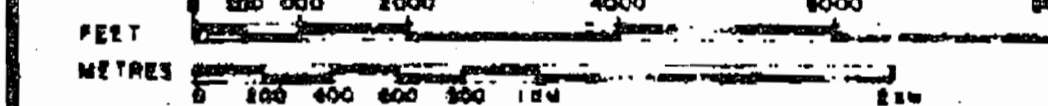

ACRES HECTARES



TOWNSHIP
LEE

DISTRICT
TIMISKAMING

MINING DIVISION
LARDER LAKE

MINISTRY OF NORTHERN DEVELOPMENT AND MINES

Date JUNE 10, 1988 Plan No.

M.360

DATE RECEIVED FEB 8/89
ARCHIVED MAY 1/87

NOTES

400' surface rights reservation along the shores of all lakes and rivers.

(R) Sec 26/80 W. 8/80 20/01/80 mts

NOTICE OF FORESTRY ACTIVITY

THIS TOWNSHIP / AREA FALLS WITHIN THE _____
 WATABEAG MANAGEMENT UNIT
 AND MAY BE SUBJECT TO FORESTRY OPERATIONS.
 THE MNR UNIT FORESTER FOR THIS AREA CAN BE
 CONTACTED AT: P.O. BOX 129
 SWASTIKA, ONT.
 POK ITO
 705-642-3222

BLACK TP. M.329

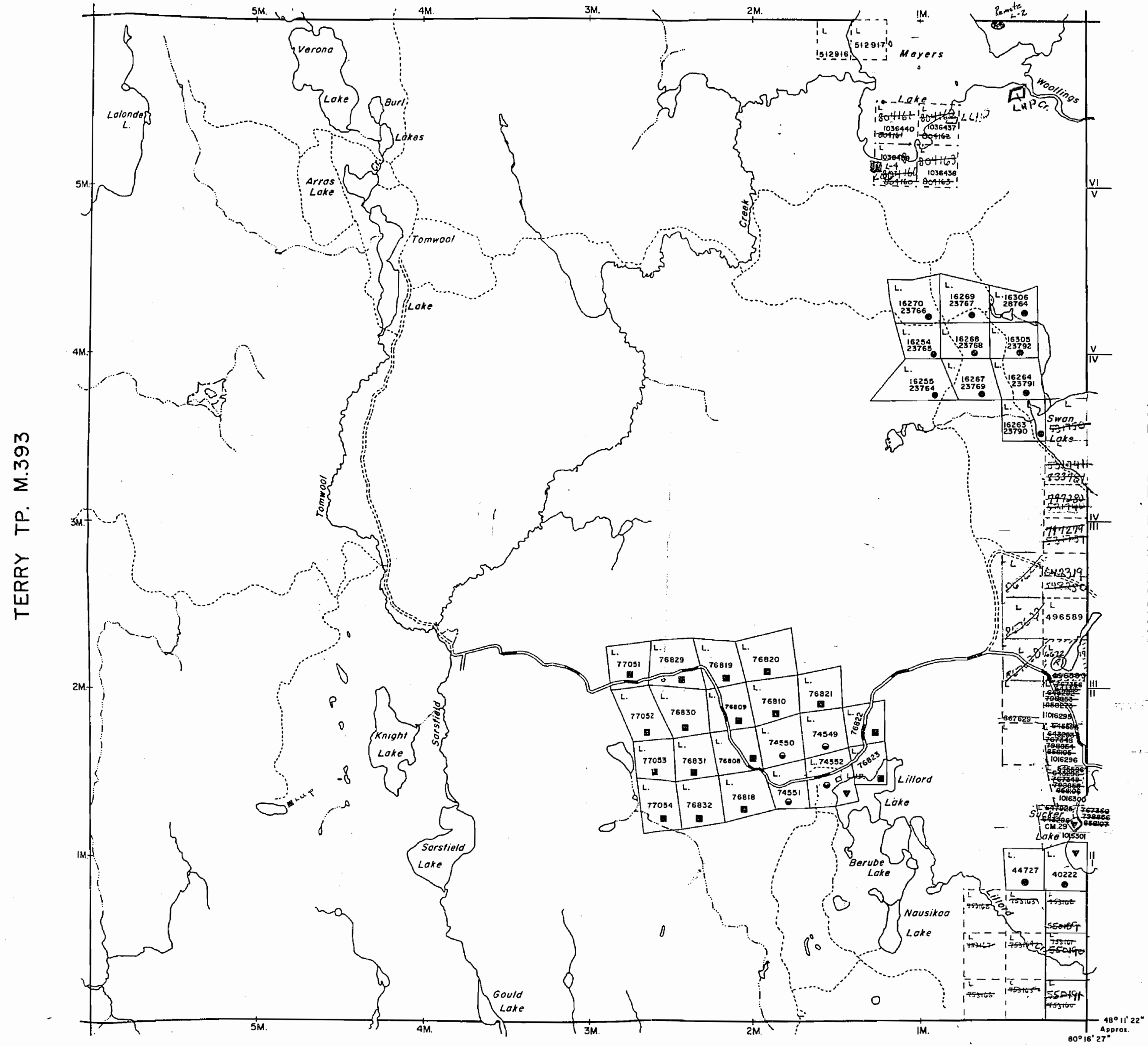

TERRY TP. M.393

MAISONVILLE TP. M.361

BOMPAS TP. M.330

DATE REPLACED FEB 8 1989

LEGEND

- HIGHWAY AND ROUTE No.
- OTHER ROADS
- TRAILS
- SURVEYED LINES:
 - TOWNSHIPS, BASE LINES, ETC.
 - LOTS, MINING CLAIMS, PARCELS, ETC.
- UNSURVEYED LINES:
 - LOT LINES
 - PARCEL BOUNDARY
 - MINING CLAIMS ETC.
- RAILWAY AND RIGHT OF WAY
- UTILITY LINES
- NON-PERENNIAL STREAM
- FLOODING OR FLOODING RIGHTS
- SUBDIVISION
- ORIGINAL SHORELINE
- MARSH OR MUSKEG
- MINES

DISPOSITION OF CROWN LANDS

TYPE OF DOCUMENT	SYMBOL
PATENT, SURFACE & MINING RIGHTS	
" SURFACE RIGHTS ONLY	
" MINING RIGHTS ONLY	
LEASE, SURFACE & MINING RIGHTS	
" SURFACE RIGHTS ONLY	
" MINING RIGHTS ONLY	
LICENCE OF OCCUPATION	
CROWN LAND SALE	C.S.
ORDER-IN-COUNCIL	O.C.
RESERVATION	
CANCELLED	
SAND & GRAVEL	

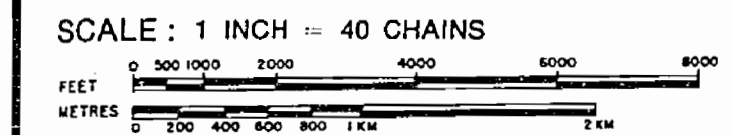

ACRES	HECTARES
40	16

TOWNSHIP
LEE
 DISTRICT
 TIMISKAMING
 MINING DIVISION
 LARDER LAKE

Ministry of Natural Resources
 Ontario Surveys and Mapping Branch

Date FEB. 11, 75 Plan No.
 Whitney Block Queen's Park, Toronto **M.360**

48° 11' 22" Approx.
 80° 16' 27"

NOTES

400' surface rights reservation along the shores of all lakes and rivers.

(R) SURFACE AND MINING RIGHTS WITHDRAWN FROM STAKING, SECTION 36/80, ORDER W.8/86, JAN.20, 1986

THE INFORMATION THAT APPEARS ON THIS MAP HAS BEEN COMPILED FROM VARIOUS SOURCES, AND ACCURACY IS NOT GUARANTEED. THOSE WISHING TO STAKE MINING CLAIMS SHOULD CONSULT WITH THE MINING RECORDER, MINISTRY OF NORTHERN DEVELOPMENT AND MINES, FOR ADDITIONAL INFORMATION ON THE STATUS OF THE LANDS SHOWN HEREON.

NOTICE OF FORESTRY ACTIVITY.

THIS TOWNSHIP / AREA FALLS WITHIN THE WATABEAG MANAGEMENT UNIT

AND MAY BE SUBJECT TO FORESTRY OPERATIONS. THE MNR UNIT FORESTER FOR THIS AREA CAN BE CONTACTED AT: P.O. BOX 129

SWASTIKA, ONT.
POK ITO
705-642-3222

BLACK TP. M.329

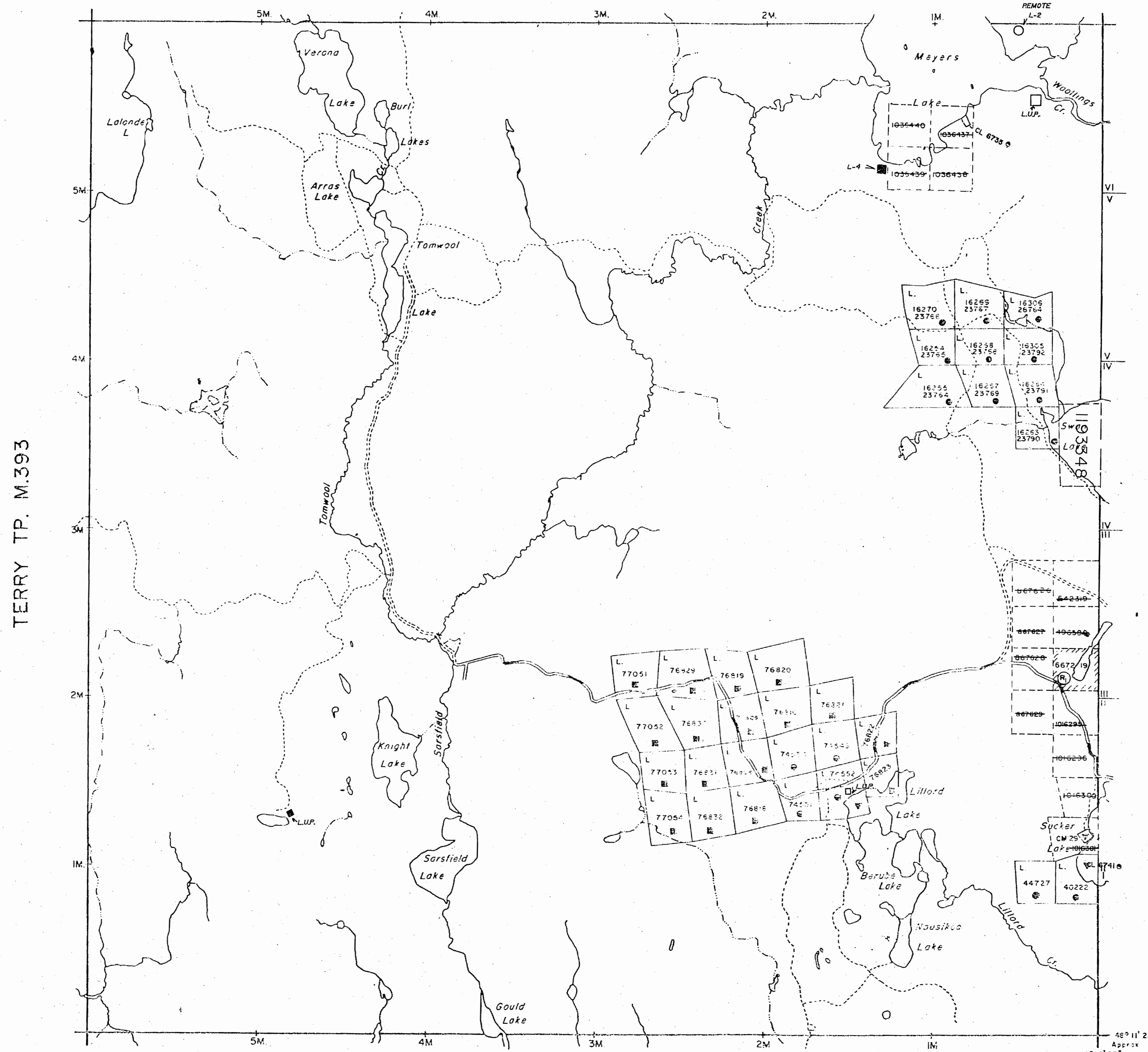

LEGEND

- HIGHWAY AND ROUTE No.
- OTHER ROADS
- TRAILS
- SURVEYED LINES:
 - TOWNSHIPS, BASE LINES, ETC.
 - LOTS, MINING CLAIMS, PARCELS, ETC.
- UNSURVEYED LINES:
 - LOT LINES
 - PARCEL BOUNDARY
 - MINING CLAIMS ETC.
- RAILWAY AND RIGHT OF WAY
- UTILITY LINES
- NON-PERENNIAL STREAM
- FLOODING OR FLOODING RIGHTS
- SUBDIVISION
- ORIGINAL SHORELINE
- MARSH OR MUSKEG
- MINES

DISPOSITION OF CROWN LANDS

TYPE OF DOCUMENT	SYMBOL
PATENT, SURFACE & MINING RIGHTS	
SURFACE RIGHTS ONLY	
MINING RIGHTS ONLY	
LEASE, SURFACE & MINING RIGHTS	
SURFACE RIGHTS ONLY	
MINING RIGHTS ONLY	
LICENCE OF OCCUPATION	
CROWN LAND SALE	C.S.
ORDER-IN-COUNCIL	OC
RESERVATION	
CANCELLED	
SAND & GRAVEL	

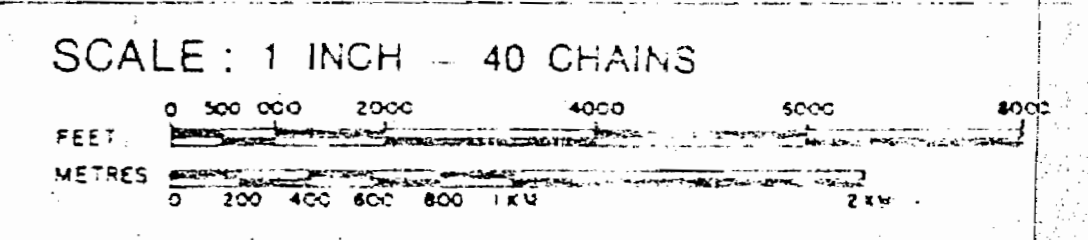

ACRES	HECTARES
40	16

TOWNSHIP

DATE OF ISSUE
LEE NOV 15 1994
LARDER LAKE
MINING RECORDER'S OFFICE

DISTRICT
TIMISKAMING

MINING DIVISION
LARDER LAKE

MINISTRY OF NORTHERN DEVELOPMENT AND MINES

Date JUNE 10, 1988. Plan No. **M.360**

BOMPAS TP. M.330

LEE

LARDER LAKE MINING DIVISION DISTRICT OF TIMISKAMING

Scale - 40 Chains = 1 Inch. M-~~360~~ 360

MINING RECORDER
RECEIVED
JUL 8 1957
SWASTIKA - ONT.

BLACK

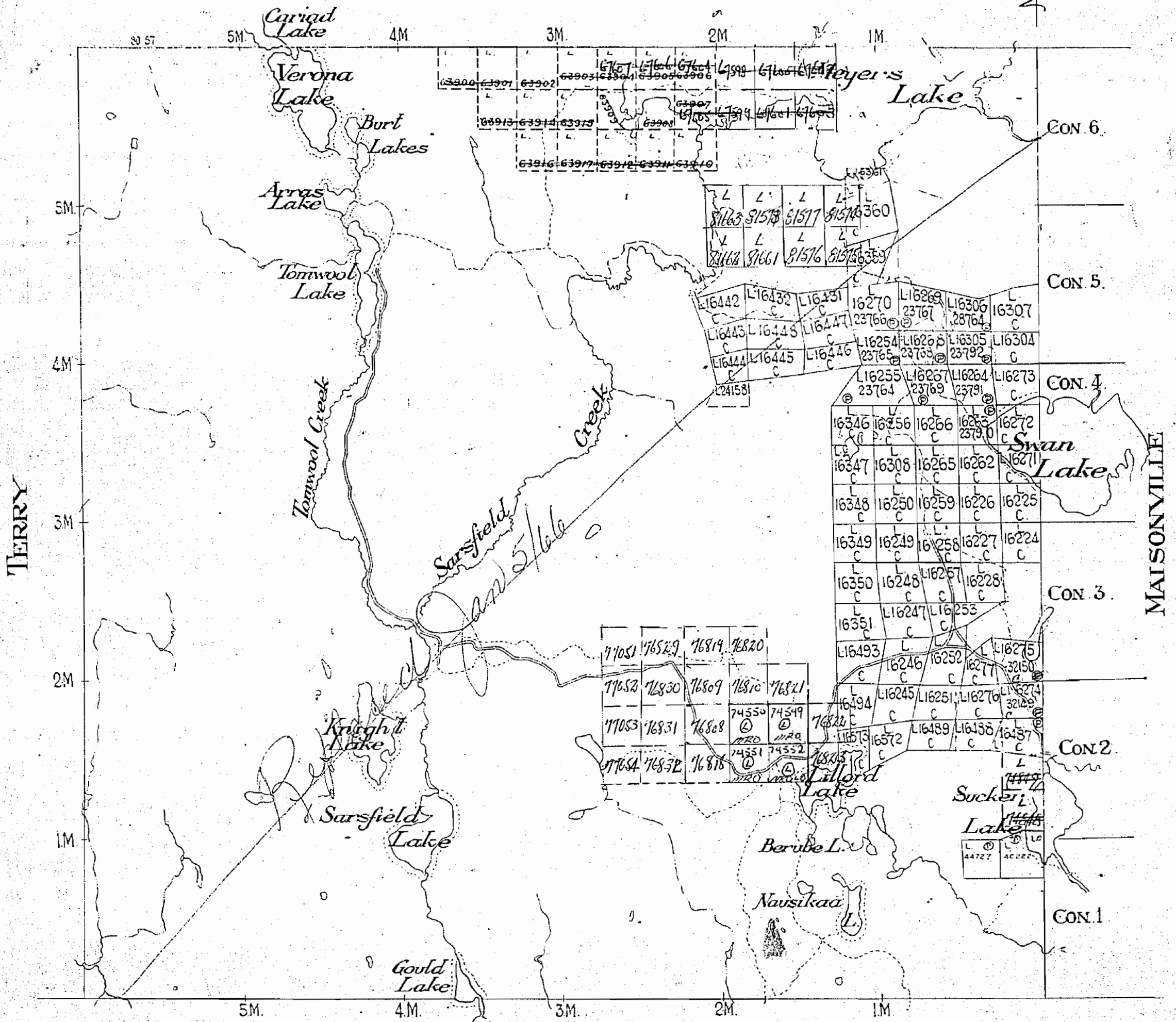

Roads Trail or Path

BOMPAS

PATENTED
 LEASED
 LICENSE OF OCCUPATION
 CANCELLED

NOTES

400' surface rights reservation along the shores of all lakes and rivers.

THE INFORMATION THAT APPEARS ON THIS MAP HAS BEEN COMPILED FROM VARIOUS SOURCES, AND ACCURACY IS NOT GUARANTEED. THOSE WISHING TO STAKE MINING CLAIMS SHOULD CONSULT WITH THE MINING RECORDER, MINISTRY OF NORTHERN DEVELOPMENT AND MINES, FOR ADDITIONAL INFORMATION ON THE STATUS OF THE LANDS SHOWN HEREON.

NOTICE OF FORESTRY ACTIVITY.

THIS TOWNSHIP / AREA FALLS WITHIN THE WATABEAG MANAGEMENT UNIT

AND MAY BE SUBJECT TO FORESTRY OPERATIONS. THE MNR UNIT FORESTER FOR THIS AREA CAN BE CONTACTED AT: P.O. BOX 129

SWASTIKA, ONT.
POK ITO
705-642-3222

ARCHIVED NOVEMBER 15, 1994

BLACK TP. M.329

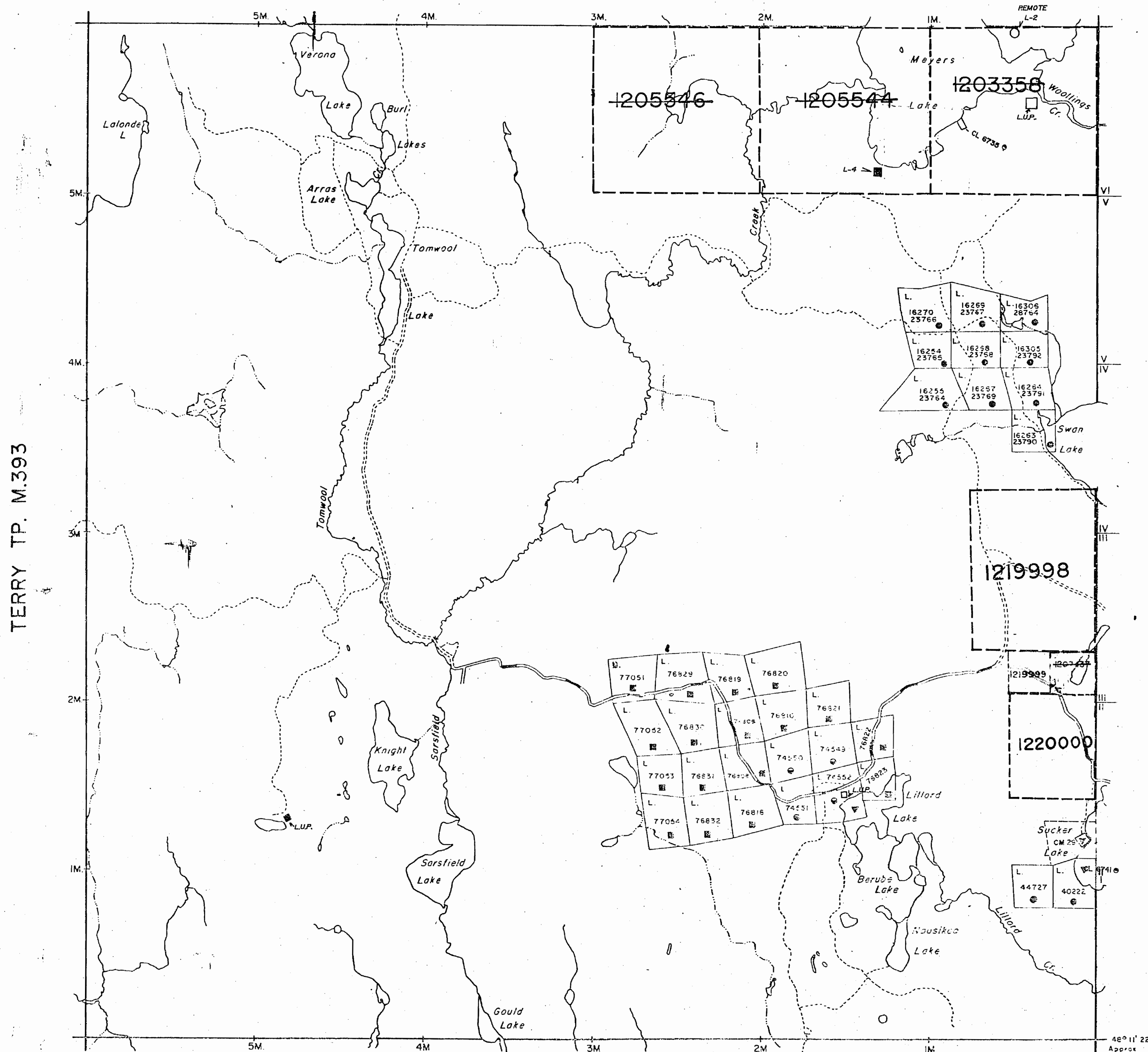

BOMPAS TP. M.330

LEGEND

- HIGHWAY AND ROUTE No.
- OTHER ROADS
- TRAILS
- SURVEYED LINES:
 - TOWNSHIPS, BASE LINES, ETC.
 - LOTS, MINING CLAIMS, PARCELS, ETC.
- UNSURVEYED LINES:
 - LOT LINES
 - PARCEL BOUNDARY
 - MINING CLAIMS ETC.
- RAILWAY AND RIGHT OF WAY
- UTILITY LINES
- NON-PERENNIAL STREAM
- FLOODING OR FLOODING RIGHTS
- SUBDIVISION
- ORIGINAL SHORELINE
- MARSH OR MUSKEG
- MINES

DISPOSITION OF CROWN LANDS

TYPE OF DOCUMENT	SYMBOL
PATENT, SURFACE & MINING RIGHTS	
" SURFACE RIGHTS ONLY	
" MINING RIGHTS ONLY	
LEASE, SURFACE & MINING RIGHTS	
" SURFACE RIGHTS ONLY	
" MINING RIGHTS ONLY	
LICENCE OF OCCUPATION	
CROWN LAND SALE	
ORDER-IN-COUNCIL	
RESERVATION	
CANCELLED	
SAND & GRAVEL	

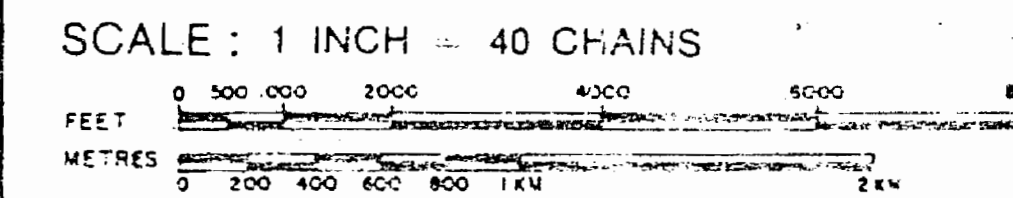

ACRES	HECTARES
40	16

TOWNSHIP
LEE

DISTRICT
TIMISKAMING

MINING DIVISION
LARDER LAKE

TO MINISTRY OF NORTHERN DEVELOPMENT AND MINES

Date JUNE 10, 1988

Plan No.

M.360

360

LEE

LARDER LAKE MINING DIVISION DISTRICT OF TIMSKAMING

Scale 40 Chains = 1 inch.

M-360

BLACK

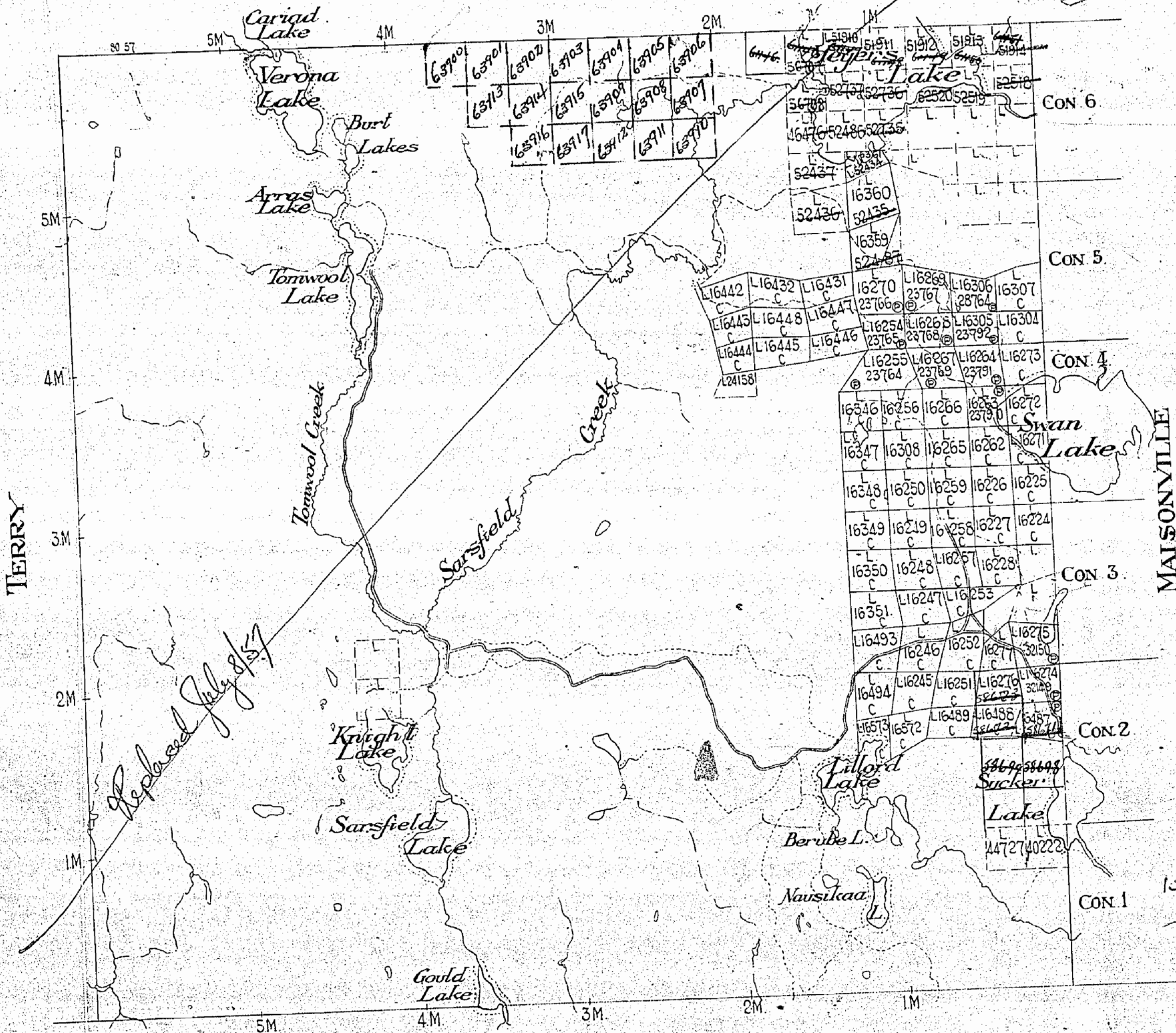

MAISONVILLE

15365

BLACK

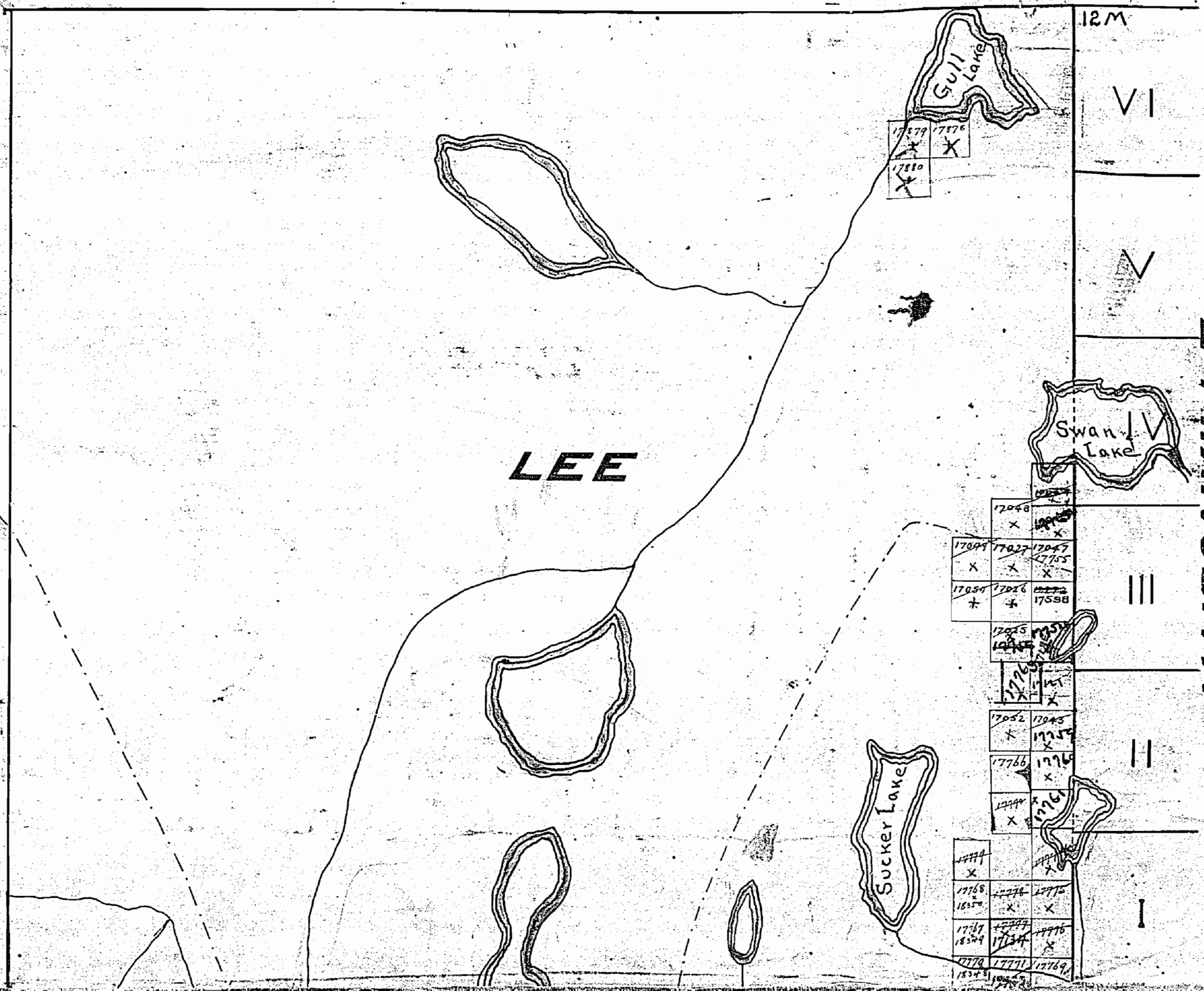

NOTES

400' surface rights reservation along the shores of all lakes and rivers.

THE INFORMATION THAT APPEARS ON THIS MAP HAS BEEN COMPILED FROM VARIOUS SOURCES, AND ACCURACY IS NOT GUARANTEED. THOSE WISHING TO STAKE MINING CLAIMS SHOULD CONSULT WITH THE MINING RECORDER, MINISTRY OF NORTHERN DEVELOPMENT AND MINES, FOR ADDITIONAL INFORMATION ON THE STATUS OF THE LANDS SHOWN HEREON.

NOTICE OF FORESTRY ACTIVITY.

THIS TOWNSHIP / AREA FALLS WITHIN THE WATABEAG MANAGEMENT UNIT

AND MAY BE SUBJECT TO FORESTRY OPERATIONS. THE MNR UNIT FORESTER FOR THIS AREA CAN BE CONTACTED AT: P.O. BOX 129

SWASTIKA, ONT.
POK ITO
705-642-3222

ARCHIVED NOVEMBER 15, 1994

BLACK TP. M.329

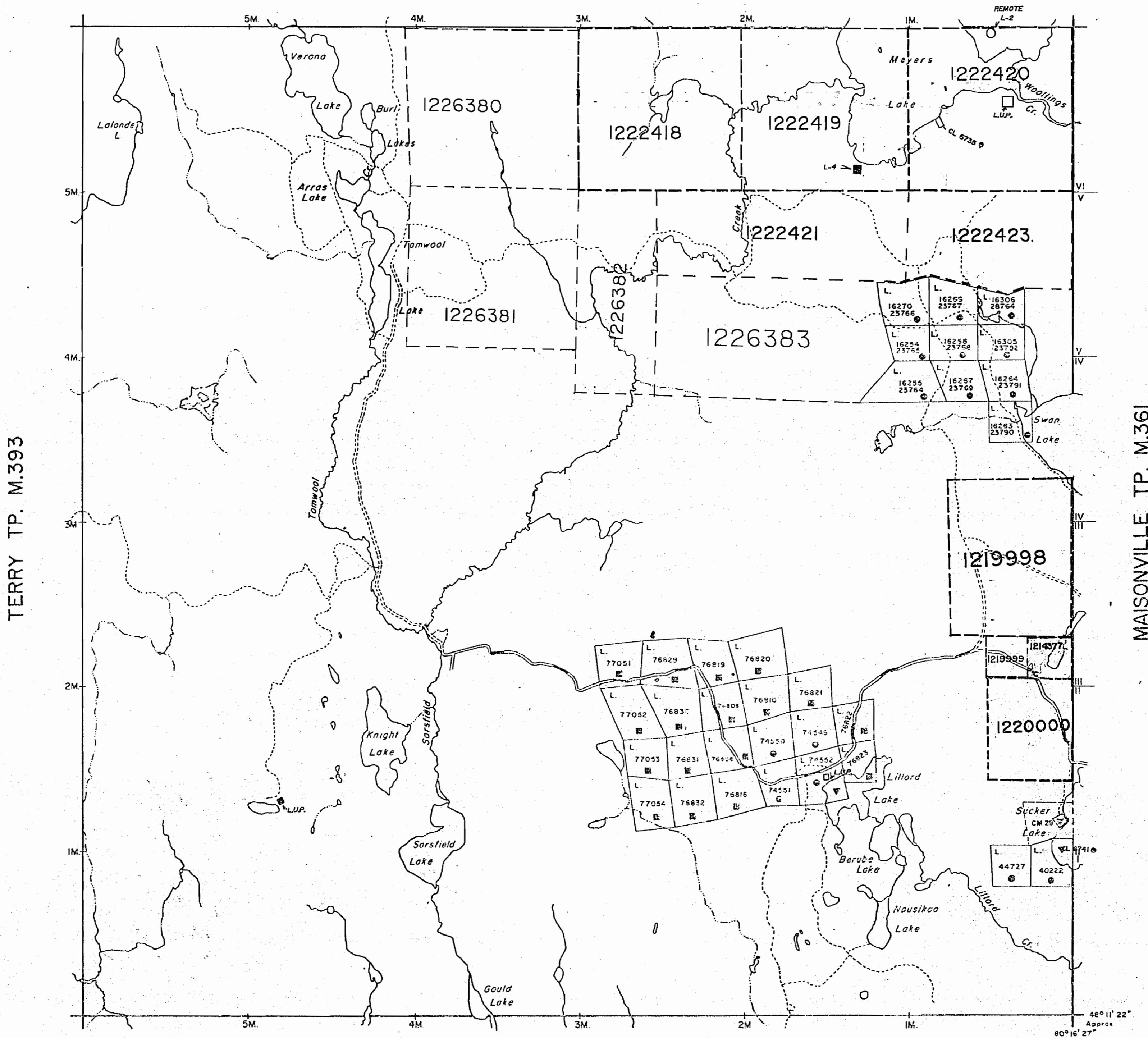

LEGEND

- HIGHWAY AND ROUTE No.
- OTHER ROADS
- TRAILS
- SURVEYED LINES:
 - TOWNSHIPS, BASE LINES, ETC.
 - LOTS, MINING CLAIMS, PARCELS, ETC.
- UNSURVEYED LINES:
 - LOT LINES
 - PARCEL BOUNDARY
 - MINING CLAIMS ETC.
- RAILWAY AND RIGHT OF WAY
- UTILITY LINES
- NON-PERENNIAL STREAM
- FLOODING OR FLOODING RIGHTS
- SUBDIVISION
- ORIGINAL SHORELINE
- MARSH OR MUSKEG
- MINES

DISPOSITION OF CROWN LANDS

TYPE OF DOCUMENT	SYMBOL
PATENT, SURFACE & MINING RIGHTS	
" SURFACE RIGHTS ONLY	
" MINING RIGHTS ONLY	
LEASE, SURFACE & MINING RIGHTS	
" SURFACE RIGHTS ONLY	
" MINING RIGHTS ONLY	
LICENCE OF OCCUPATION	
CROWN LAND SALE	
ORDER-IN-COUNCIL	
RESERVATION	
CANCELLED	
SAND & GRAVEL	

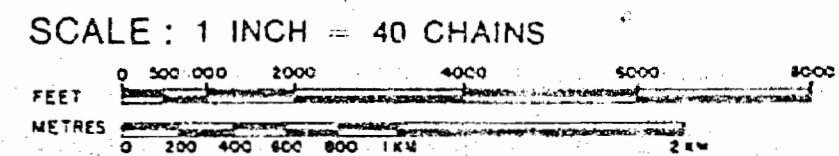

ACRES	HECTARES
40	16

TOWNSHIP
LEE

DISTRICT
TIMISKAMING

MINING DIVISION
LARDER LAKE

MINISTRY OF NORTHERN DEVELOPMENT AND MINES

Date JUNE 10, 1988. Plan No. **M.360**