

Tram service changes

12 Sunday 3 January, from 11pm to last tram Thursday 14 January
Route 12 trams will operate as Route 12a in two sections.

96 Sunday 3 January from 6pm to 11am Friday 15 January
Route 96 trams will operate as Route 96a in two sections.
Buses will replace trams between the two sections, diverting around the work zone.

109 Sunday 3 January, from 11pm to last tram Thursday 14 January
Route 109 trams will operate as Route 109a between Box Hill and Southern Cross Station/Spencer St, with buses replacing trams between Southern Cross Station and Port Melbourne.

During these changes, trams and replacement buses will operate to the normal frequency however, actual travel times may differ from the printed timetable. We suggest you allow extra time for your journey.

For more details and a map of these service changes, refer to an onboard brochure or visit works.yarratrams.com.au

Please note existing Stop 124B and Stop 125 on Clarendon Street will be removed once the new level access tram stop is complete to optimise the spacing between tram stops.

Furthermore when the new level access stop opens on Friday 15 January 2016, the stop will be renamed Stop 125, Clarendon Street Junction.



New Port Junction tram stop
Artist impression only, subject to change.



For more information visit ptv.vic.gov.au/route96, call 1800 800 007 or email ptvprojects@ptv.vic.gov.au

If you have a hearing or speech impairment, contact us through the National Relay Service:

> TTY users phone 133 677, then ask for 1800 800 007

For information in other languages call:

عربي	9321 5440	普通話	9321 5454
廣東話	9321 5441	Somali	9321 5446
Hrvatski	9321 5442	Español	9321 5447
Dinka	9321 5452	سوداني	9321 5453
Ελληνικά	9321 5443	Türkçe	9321 5448
Italiano	9321 5444	Việt-ngữ	9321 5449
Македонски	9321 5445	All other languages	9321 5450

ROUTE 96 UPGRADE

TRAM UPGRADE WORKS ON CLARENDON STREET & NORMANBY ROAD

Public Transport Victoria and Yarra Trams are building a new level access tram stop and upgrading tram infrastructure on the corner of Clarendon Street and Normanby Road in Southbank. The works are critical to the ongoing improvement of the network and will require a large construction zone that will cause disruptions.



TIMING

11pm, Sunday 3 January 2016 to 4:30am, Friday 15 January 2016



ROAD USERS

Street closures and detours will be in place around the construction zone



TRAM SERVICES

Tram service changes will be in effect during this period for Routes 12, 96 and 109



PEDESTRIANS

Street closures and detours will be in place around the construction zone

What is planned?



These important works are scheduled to begin at 11pm on Sunday 3 January 2016 and be completed by 4:30am on Friday 15 January 2016.

During this time the following activities will occur:

Monday 4 January to Friday 8 January 2016

- > Preparation of the site and traffic management set-up
- > Saw-cutting of asphalt and concrete
- > Breaking out existing track
- > Excavation of concrete debris and track

Friday 8 January to Friday 15 January 2016

- > Installation of new track
- > Construction of the new platforms including shelters and fencing
- > Finishing works

Businesses and residents can expect to hear construction related noise. While work will be carried out around the-clock during the thirteen days, where possible the noisier work such as saw cutting and excavation of track will take place between 6am and 10pm. The first five days of the main work period are expected to be the noisiest with high impact construction activities occurring. Once the rail works are complete, construction will shift to the new platforms along with installation of the new overhead wires. These construction activities are expected to cause less disruption to the surrounding community.

Our workers will be mindful of keeping noise to a minimum and respecting the needs of the local community.

Landscaping works

To enhance the surrounding area, provision for some planting along Whiteman Street will be undertaken creating much needed shade and amenity to this streetscape.

After the main tram infrastructure construction, Yarra Trams will work closely with the City of Melbourne to reinstate trees and plant some additional vegetation in the area. It is expected these finishing works will be completed in early 2016.

Detour information

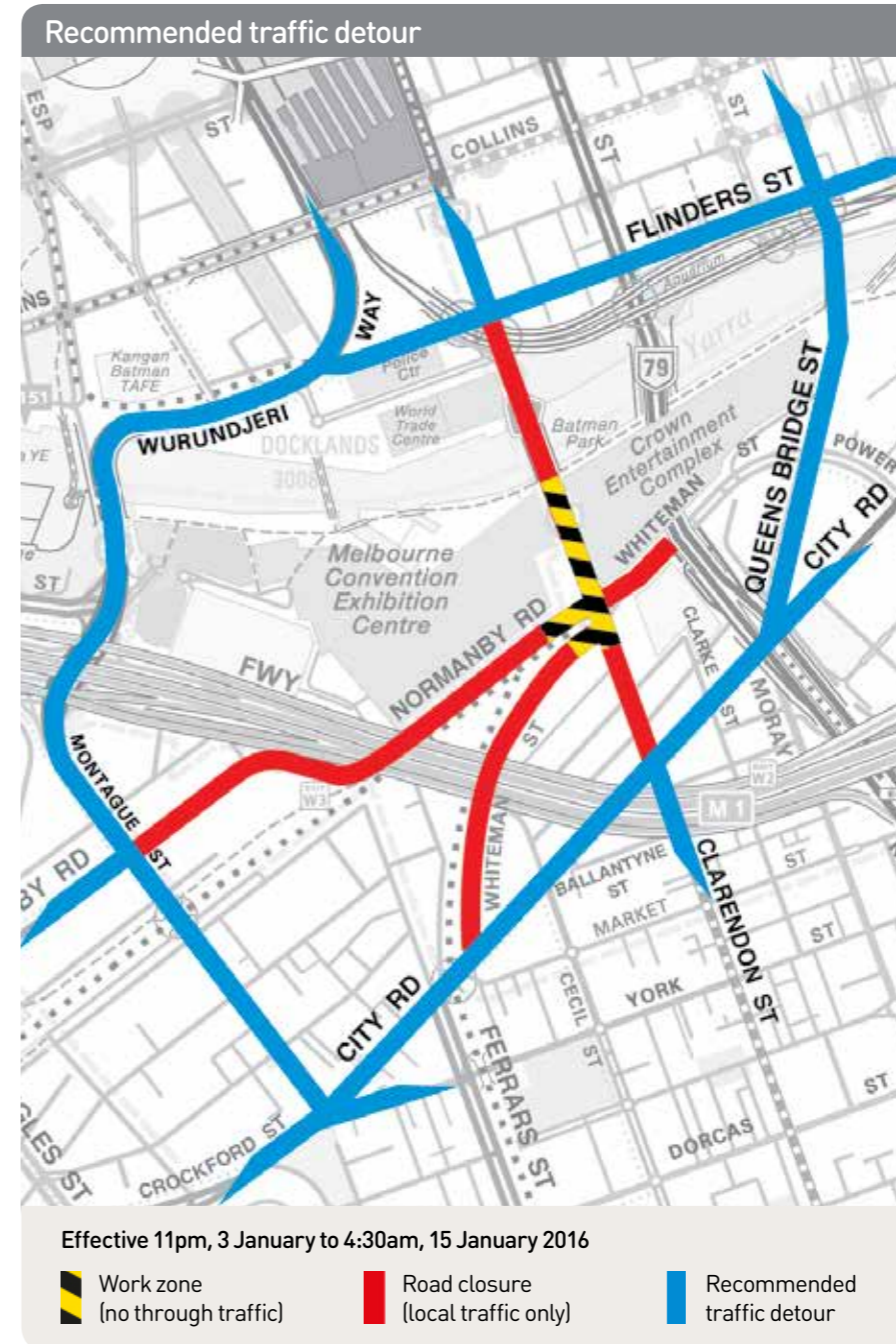

Road users

Sunday 3 January to Friday 15 January 2016

The Clarendon Street and Normanby Road intersection will be closed from 11pm Sunday 3 January to 4:30am Friday 15 January, 2016. No through traffic will be permitted during this time.

Road closures will be in place on Clarendon Street between Flinders Street and City Road. Normanby Road will be closed from Montague Street. Whiteman Street will be closed between Kings Way and City Road.

Motorists can expect traffic delays and are recommended to avoid the area. Please refer to the detour map.

Local access

Traffic management will be in place during the work period to help manage local access. Although road closures will be in place, our traffic controllers will permit access to local properties. If in doubt please approach one of our traffic controllers who will be happy to help.

Pedestrians

In the interest of public safety Yarra Trams will fence off the entire work site. Footpaths will remain open around the work area, maintaining pedestrian access to all properties. Pedestrians will be diverted around the work site and there may be times where an additional walk is required. Please refer to the 'Construction zone' map on the opposite page and pedestrian signage on the day to reach your destination.

