

5791B
 5791A
 5791C
 5791D
 5791E
 5791F
 5791G
 5791H
 5791I
 5791J
 5791K
 5791L
 5791M
 5791N
 5791O
 5791P
 5791Q
 5791R
 5791S
 5791T
 5791U
 5791V
 5791W
 5791X
 5791Y
 5791Z

NO. 1
 SHEET
 DATE
 SCALE
 PROJECT
 DRAWN BY
 CHECKED BY
 APPROVED BY

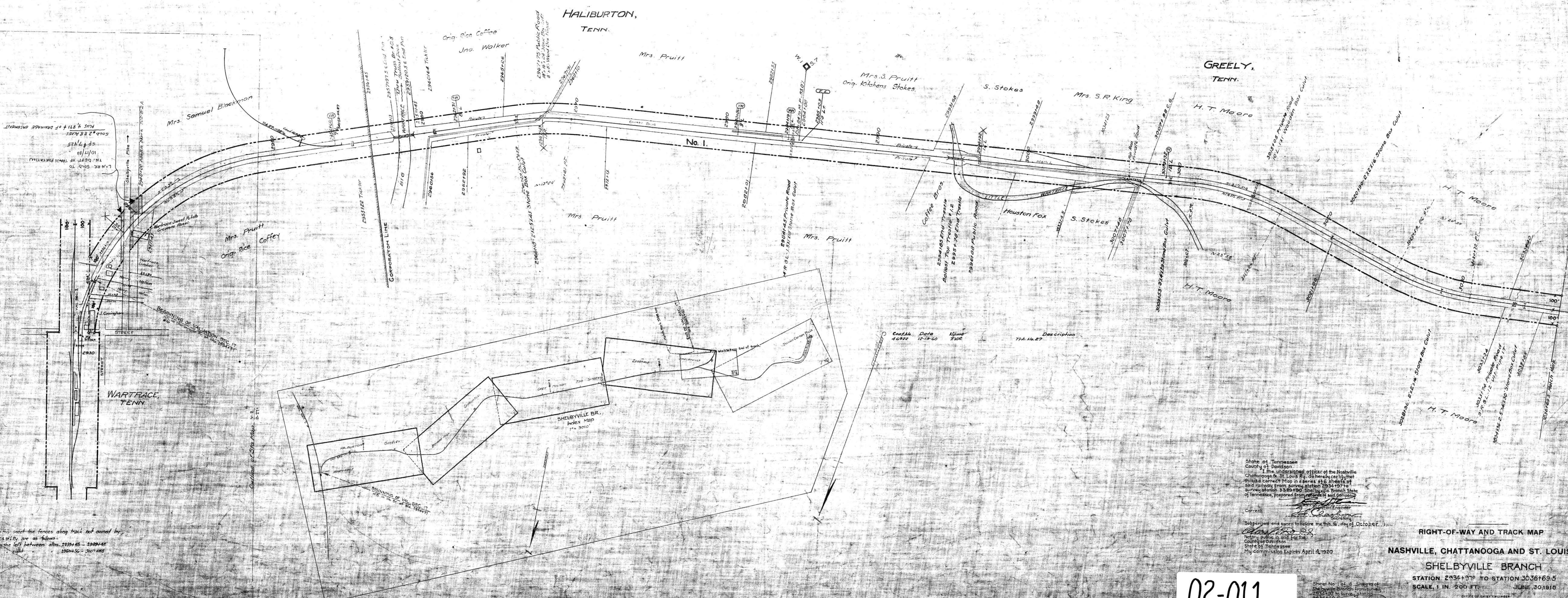

706-B-1

02-011

State of Tennessee
 County of Davidson
 I, the undersigned officer of the Nashville
 Chattanooga & St. Louis Ry. do hereby certify that
 this is a correct map in a series of 16 sheets of
 said railway from survey station 2934+57 to
 survey station 3036+69.5 Shelbyville Branch State
 of Tennessee, prepared from records of said railway.
 Surveyor General
 Notary Public in and for the
 County of Davidson
 State of Tennessee
 My commission Expires April 4, 1920

RIGHT-OF-WAY AND TRACK MAP
NASHVILLE, CHATTANOOGA AND ST. LOUIS RY.
SHELBYVILLE BRANCH
STATION 2934+57 TO STATION 3036+69.5
SCALE 1 IN. = 200 FT. JUNE 30, 1916
M.P. 00 to 20