

AFE No.	Date Comp.	Description of Change
12979	5-14-29	Inst of 8" 76 Sub Drain from 239+26 to 244+27 - 6' Lat Drains to H.
13216	12-6-29	Const of 1850 pipe line from W.C. (278+92) to Sec Houses
13022	6-20-30	Inst of 8" 76 Sub drain from Sta. 12185+03 to 12197+01
13075	8-21-30	Ret of 6" pipe at 12229+50
33471	8-23-35	Inst elect lights and annunciator in depot at Duff
36025	2-12-37	Ret of 6"x24" Section of Depot Platform at Duff
36485	11-1-47	RET NORTH T.O. (170) TRK 60-A
36791	11-1-47	RET 171 SOUTH T.O. AND REMAINING 133' TRK 60-A
36323	1-5-48	REC OLD WATER TANK AND CONST NEW ONE.
36390	4-26-47	Retire Money Guardrail from Main Trk.
40570	8-14-52	Agents House Part No. 12282+425
40039	7-9-53	Retire Trk #61 521' long
46041	7-6-55	Ret Water hose fixtures 4' line and 2' line
49152	12-22-56	Ret 20" 18" CIP in place and install 30" 24" CMP
58160	5-17-67	Ret 20" 18" CIP in place and install 30" 24" CMP

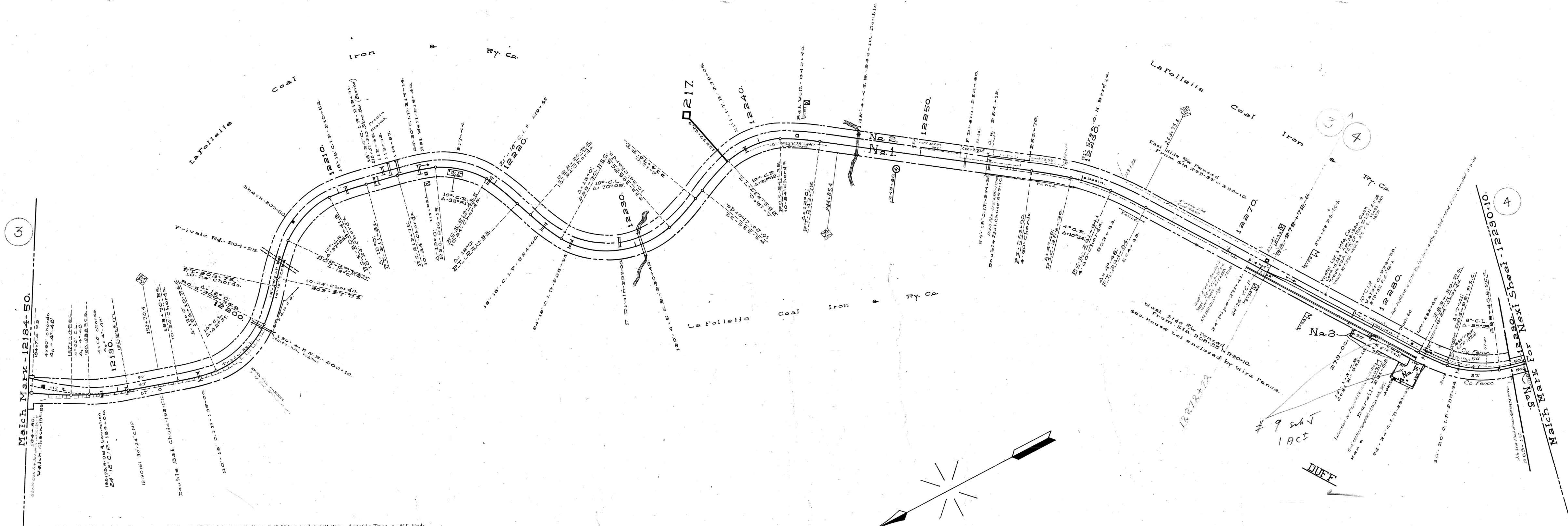

Cont.	Date	Description
30294	2-12-48	Beecher Burger lease of 85 Acre at 497+24.6 (700 x 50) 1/2 Sec. 2 15-54 Est. to 2-11-57; Memo. 4-11-62 - Trans. to W.E. Hinds
27545	2-17-34	Evvin J. Parrott lease of part par 2 Section 1220+00 and 1228+27 - Trans. Robert Milton 2-17-38 - Trans. James Hender 3-19-40 can. 1942
27580	7-20-31	Shirley Duff lease of 1/2 Acre from 1221+00 to 1221+00 - Trans. Robert Milton 2-17-38 - Trans. James Hender 3-19-40 can. 1942
27591	3-10-34	Shirley Duff lease of 1/2 Acre from 1221+00 to 1221+00 - Trans. Robert Milton 2-17-38 - Trans. James Hender 3-19-40 can. 1942
27677	4-1-34	Mrs. Julia Hill Greene lease of 1/2 Acre par 2 583+ to 583+ to 583+ to 583+ - Trans. James Hender 3-19-40 can. 1942
28771	4-15-36	J.F. Hendon lease 43 x 100 along S. Rev. line beg. of MR 217 thence South 700' can. 1942
34316	3-13-42	J.G. Duff lease 20 x 100 on left 43' over Sta. 1221+00 to 1221+00
30442	4-16-42	Shirley Duff lease of 1/2 Acre from 1221+00 to 1221+00 - Trans. Robert Milton 2-17-38 - Trans. James Hender 3-19-40 can. 1942
30810	5-6-39	David Boyd lease of 1/2 Acre (92+15.4 to 92+26.4) southeast 1/4 of track can. 0-9-42
28216	3-4-40	I.S. Orick lease 20 x 100 on left 43' over Sta. 12267+58 to 1227+98 ext. to 3-16-33 - Trans. to James Hender 3-19-40 can. 1942
31528	5-31-40	James Hender lease part of track 90+00 to 90+00 - Trans. Robert Milton 2-17-38 - Trans. James Hender 3-19-40 can. 1942
31627	7-26-40	J.W. Boyd lease of 1/2 Acre from 1221+00 to 1221+00 - Trans. Robert Milton 2-17-38 - Trans. James Hender 3-19-40 can. 1942
31628	8-14-40	Wm. Overholt lease of 1/2 Acre from 1221+00 to 1221+00 - Trans. Robert Milton 2-17-38 - Trans. James Hender 3-19-40 can. 1942
32101	4-14-41	Edw. Kennedy lease of 1/2 Acre from 1221+00 to 1221+00 - Trans. Robert Milton 2-17-38 - Trans. James Hender 3-19-40 can. 1942
34102	4-28-40	Jim Cleary et al. 3x30 wooden footbridge 18.3' right of K3.4 W. 88+90.6
34103	5-22-40	City of LaFollette - Wire over of 28+45.0
35151	10-17-46	Henry Hill lease of 1/2 Acre of 1/2 Acre 63+225' from Sta. 12285+22 to 87+47. Ext. to 10-16-61
31667	8-11-48	Mrs. Laura Scott lease of part of par 2-34+032 wide Sta. 1225+44 - 117' long East side can. 1942 - LEASED TO EUGENE CHILDS 7-25-54
39194	7-2-51	Joe L. Johnson 2-log Loading Ramps & Lease of 30' spaces on 76-61-56-78-4 to 75-73 - CANCELLED 8/16/52
39193	1-13-54	W.A. Foster 40' 0" of Part of Par. No. 2 Sta. 1221+00 to 1221+00 - CANCELLED 8/16/52
42707	5-31-55	Henry C. Hill 2' Water Line each Sta. 262+23 to 272+27
26042	5-29-59	Sou. Bell T.&T. Co. - Wire King over Sta. 12283+98.6

Sheet No. 61 of 89 of Knoxville Division from Survey Station 12184+50 to Survey Station 12290+10
 Valuation Engineer

RIGHT OF WAY AND TRACK MAP
 LOUISVILLE AND NASHVILLE R. R. CO.
 KNOXVILLE DIVISION
 STATION 12184+50 TO STATION 12290+10
 SCALE: 1 INCH = 200 FT. JUNE 30 1917.

007-012