

NASHVILLE, TENN.

Central Blvd.

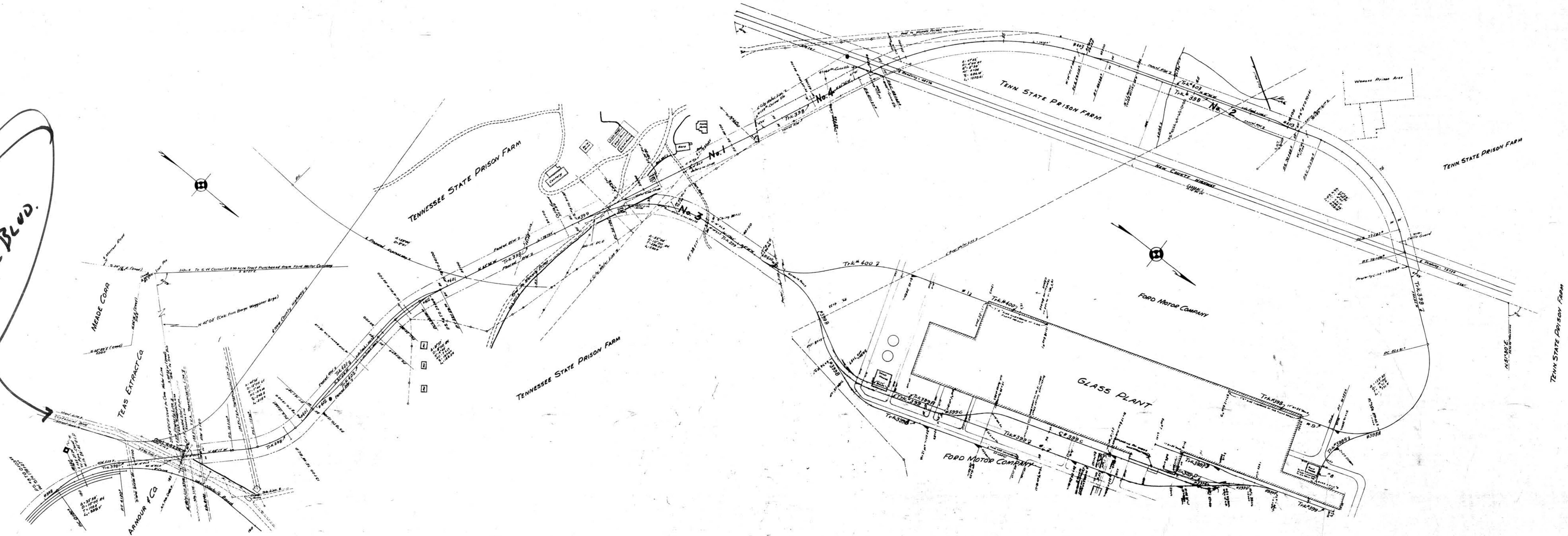

Cont 44224 3-29-58 City of Nashville - Wire King over Sta 7440

DAVIDSON COUNTY

19-002

RIGHT OF WAY AND TRACK MAP
NASHVILLE, CHATTANOOGA & ST. LOUIS RY.
WEST NASHVILLE BRANCH.
FORD GLASS CO. TRACKS.
SCALE: 1" = 200'
1956

