

INDEX NO.	WORK AUTH.	DESCRIPTION	DATE COMPLETED
1	1885	Replaces No. 1 & 2 with New	April 1923
2	1885	Replaces No. 3 with New	April 1923
3	1885	Replaces No. 4 with New	April 1923
4	1885	Replaces No. 5 with New	April 1923
5	1885	Replaces No. 6 with New	April 1923
6	1885	Replaces No. 7 with New	April 1923
7	1885	Replaces No. 8 with New	April 1923
8	1885	Replaces No. 9 with New	April 1923
9	1885	Replaces No. 10 with New	April 1923
10	1885	Replaces No. 11 with New	April 1923
11	1885	Replaces No. 12 with New	April 1923
12	1885	Replaces No. 13 with New	April 1923
13	1885	Replaces No. 14 with New	April 1923
14	1885	Replaces No. 15 with New	April 1923
15	1885	Replaces No. 16 with New	April 1923
16	1885	Replaces No. 17 with New	April 1923
17	1885	Replaces No. 18 with New	April 1923
18	1885	Replaces No. 19 with New	April 1923
19	1885	Replaces No. 20 with New	April 1923
20	1885	Replaces No. 21 with New	April 1923
21	1885	Replaces No. 22 with New	April 1923
22	1885	Replaces No. 23 with New	April 1923
23	1885	Replaces No. 24 with New	April 1923
24	1885	Replaces No. 25 with New	April 1923
25	1885	Replaces No. 26 with New	April 1923
26	1885	Replaces No. 27 with New	April 1923
27	1885	Replaces No. 28 with New	April 1923
28	1885	Replaces No. 29 with New	April 1923
29	1885	Replaces No. 30 with New	April 1923
30	1885	Replaces No. 31 with New	April 1923
31	1885	Replaces No. 32 with New	April 1923
32	1885	Replaces No. 33 with New	April 1923
33	1885	Replaces No. 34 with New	April 1923
34	1885	Replaces No. 35 with New	April 1923
35	1885	Replaces No. 36 with New	April 1923
36	1885	Replaces No. 37 with New	April 1923
37	1885	Replaces No. 38 with New	April 1923
38	1885	Replaces No. 39 with New	April 1923
39	1885	Replaces No. 40 with New	April 1923
40	1885	Replaces No. 41 with New	April 1923
41	1885	Replaces No. 42 with New	April 1923
42	1885	Replaces No. 43 with New	April 1923
43	1885	Replaces No. 44 with New	April 1923
44	1885	Replaces No. 45 with New	April 1923
45	1885	Replaces No. 46 with New	April 1923
46	1885	Replaces No. 47 with New	April 1923
47	1885	Replaces No. 48 with New	April 1923
48	1885	Replaces No. 49 with New	April 1923
49	1885	Replaces No. 50 with New	April 1923
50	1885	Replaces No. 51 with New	April 1923
51	1885	Replaces No. 52 with New	April 1923
52	1885	Replaces No. 53 with New	April 1923
53	1885	Replaces No. 54 with New	April 1923
54	1885	Replaces No. 55 with New	April 1923
55	1885	Replaces No. 56 with New	April 1923
56	1885	Replaces No. 57 with New	April 1923
57	1885	Replaces No. 58 with New	April 1923
58	1885	Replaces No. 59 with New	April 1923
59	1885	Replaces No. 60 with New	April 1923
60	1885	Replaces No. 61 with New	April 1923
61	1885	Replaces No. 62 with New	April 1923
62	1885	Replaces No. 63 with New	April 1923
63	1885	Replaces No. 64 with New	April 1923
64	1885	Replaces No. 65 with New	April 1923
65	1885	Replaces No. 66 with New	April 1923
66	1885	Replaces No. 67 with New	April 1923
67	1885	Replaces No. 68 with New	April 1923
68	1885	Replaces No. 69 with New	April 1923
69	1885	Replaces No. 70 with New	April 1923
70	1885	Replaces No. 71 with New	April 1923
71	1885	Replaces No. 72 with New	April 1923
72	1885	Replaces No. 73 with New	April 1923
73	1885	Replaces No. 74 with New	April 1923
74	1885	Replaces No. 75 with New	April 1923
75	1885	Replaces No. 76 with New	April 1923
76	1885	Replaces No. 77 with New	April 1923
77	1885	Replaces No. 78 with New	April 1923
78	1885	Replaces No. 79 with New	April 1923
79	1885	Replaces No. 80 with New	April 1923
80	1885	Replaces No. 81 with New	April 1923
81	1885	Replaces No. 82 with New	April 1923
82	1885	Replaces No. 83 with New	April 1923
83	1885	Replaces No. 84 with New	April 1923
84	1885	Replaces No. 85 with New	April 1923
85	1885	Replaces No. 86 with New	April 1923
86	1885	Replaces No. 87 with New	April 1923
87	1885	Replaces No. 88 with New	April 1923
88	1885	Replaces No. 89 with New	April 1923
89	1885	Replaces No. 90 with New	April 1923
90	1885	Replaces No. 91 with New	April 1923
91	1885	Replaces No. 92 with New	April 1923
92	1885	Replaces No. 93 with New	April 1923
93	1885	Replaces No. 94 with New	April 1923
94	1885	Replaces No. 95 with New	April 1923
95	1885	Replaces No. 96 with New	April 1923
96	1885	Replaces No. 97 with New	April 1923
97	1885	Replaces No. 98 with New	April 1923
98	1885	Replaces No. 99 with New	April 1923
99	1885	Replaces No. 100 with New	April 1923

C.M. & G. JUNCTION, TENN.

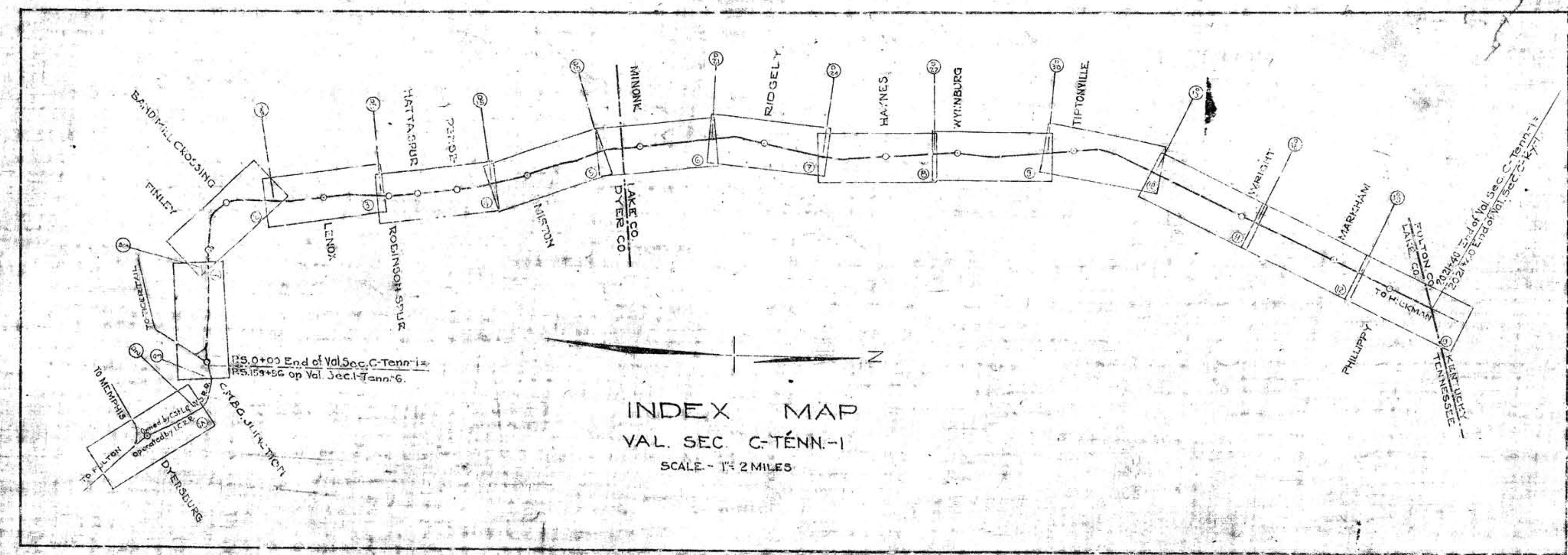

No.	Quantity	Grantee	Acq. Date	Revol.	Cont. No.
1	W. B. Bunnell et al	Dyersburg Nor. & G. Co.	W.D. 10-23-03	26-800	7-20-05
2	"	"	Ad. pos.	"	"
3	"	"	Cont.	1-1-06	"
4	"	"	W.D.	3-16-07	27-426
5	"	"	Deed	7-27-06	26-285
6	H. B. Avery heirs by D. O. Olin & H. H. Cotton of Tenn.	"	"	"	26-285
7	"	"	W.D.	7-27-06	26-296
8	"	"	"	11-10-06	26-205
9	"	"	"	3-16-07	27-426



SOLD 3/11 to Hickman River City Development Corp
ties, Ballast etc to Knoxville Tennessee Hamilton Line
for Hickman, Tenn 9-28-53

Fence Notes:

2nd W. South of Wye	107 + 30	to	10 + 05
1st W. or South	101	to	10 + 50
3rd W.	55	to	10 + 55
4th W.	51	to	10 + 57
5th W.	3	to	9 + 06
6th W.	73	to	22 + 90
7th W.	17	to	23 + 54
8th W.	17	to	23 + 33
9th W.	28	to	22 + 63
10th W.	17	to	155 + 10

State of Illinois
County of Cook
I, the undersigned, Chief Engineer of the Illinois Central
Railroad Company, do hereby certify that this is a correct
and true copy of the original plan, profile and
supplemental sheets of said railroad from
Station C.M. & G. Jct. to Station Ky.-Tenn. State Line,
State of Tennessee, prepared from the records of said company.

Corrected by: VINCENNES ENGINEER
CHIEF CORPORATE ENGINEER
Submitted and sworn to before me this _____ day, _____
Notary Public in and for the State of Illinois
My commission expires _____

ALL THE C.M. & G. JCT. PROPERTY ON THIS
SHEET CONVEYED TO I.C.R.R. CO.
JUNE 1953 (2-23959)

023-01

RIGHT-OF-WAY AND TRACK MAP
CHICAGO, MEMPHIS, & GULF R.R.
OPERATED BY THE
ILLINOIS CENTRAL RAILROAD
C.M. & G. JCT. TO KY.-TENN. STATE LINE
STATION C100 TO STATION 155-67
M. P. 21-30E TO M. P. D-6
SCALE 1 IN. = 300 FT.
REV. Dec 31, 1927
OFFICE OF CHIEF ENGINEER,
CHICAGO, ILL.

