

For Land Schedule See other sheet


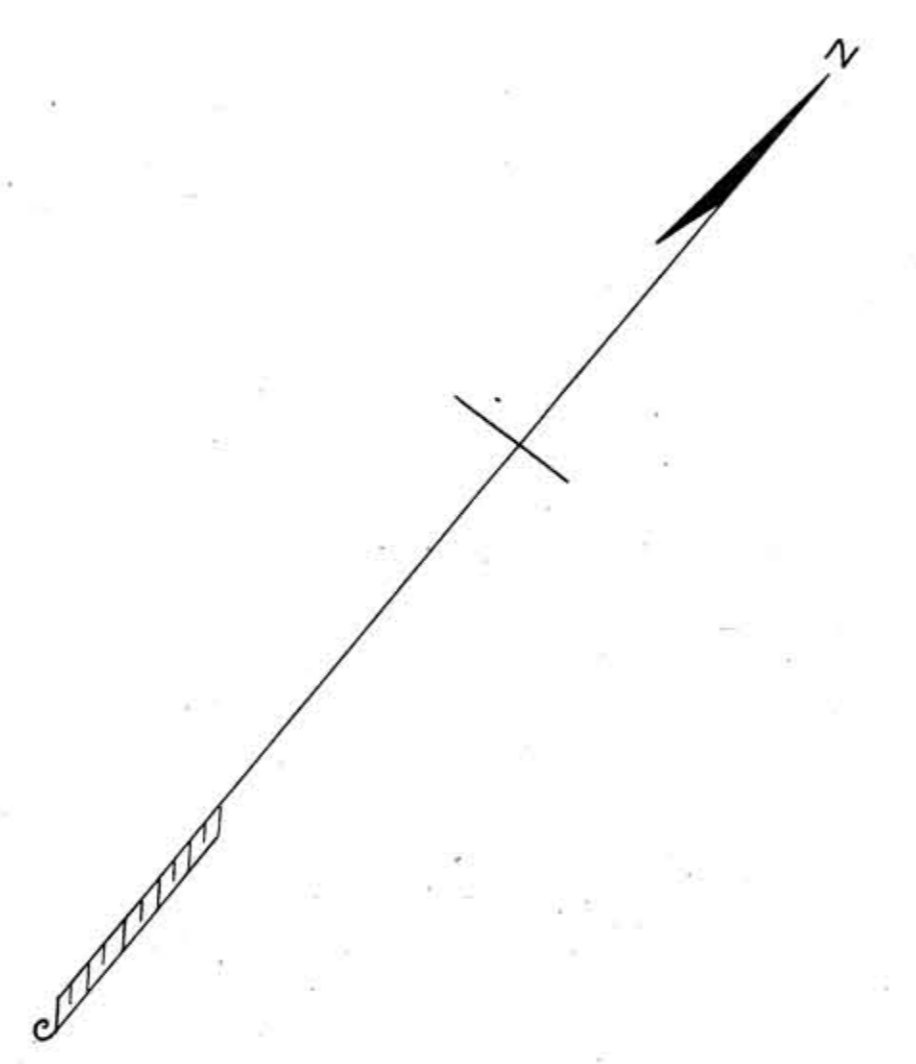

NOTE
Construction stations marked thus 326'613's.

706-C-18

GRUNDY COUNTY, TENN.

031-013

RIGHT-OF-WAY AND TRACK MAP
NASHVILLE, CHATTANOOGA AND ST. LOUIS RY.
TRACY CITY BRANCH

Sheet No. 26 of 23 sheets of
Tracy City Branch from survey
station 1708111 to survey station
1814131

STATION 1708111 TO STATION 1814131
SCALE, 1 IN. = 200 FT. JUNE 30, 1919

OFFICE OF CHIEF ENGINEER
NASHVILLE, TENN.
M.P. 32.6 to 34.6

V. 10
17

28-2