

- 44 Cont. 45070 2-4-59 Eastside Utility District - 6" water pipe X-ing under sta. 139+58
- Deed 14497 8-27-59 Ctn., N.O., & Tex. Pac. Rwy. - X-ing easement through Par. 1 & 2
- Cont. 47831 10-27-61 Chattanooga Gas Co. - 8" gas pipe X-ing under Sta. 85+34
- 48008 1-19-62 Dept. of Highways & Sew. Rwy. - Overhead Bridge at 71+32.1
- 39922 11-27-82 4-10-62 Farmers Coven. Assn. Inc. - SUTCHING RECONSTRUCT LOCATIONS ORIGINARY WORKS
- 45481 6-27-63 Southern Railway & Farmers Chem. Assn. Inc. - Track Maintenance
- 45700 12-16-63 Phillips Van House - Track #27 L.D. 118-000 - Intensity - 3000 - 12-1-71

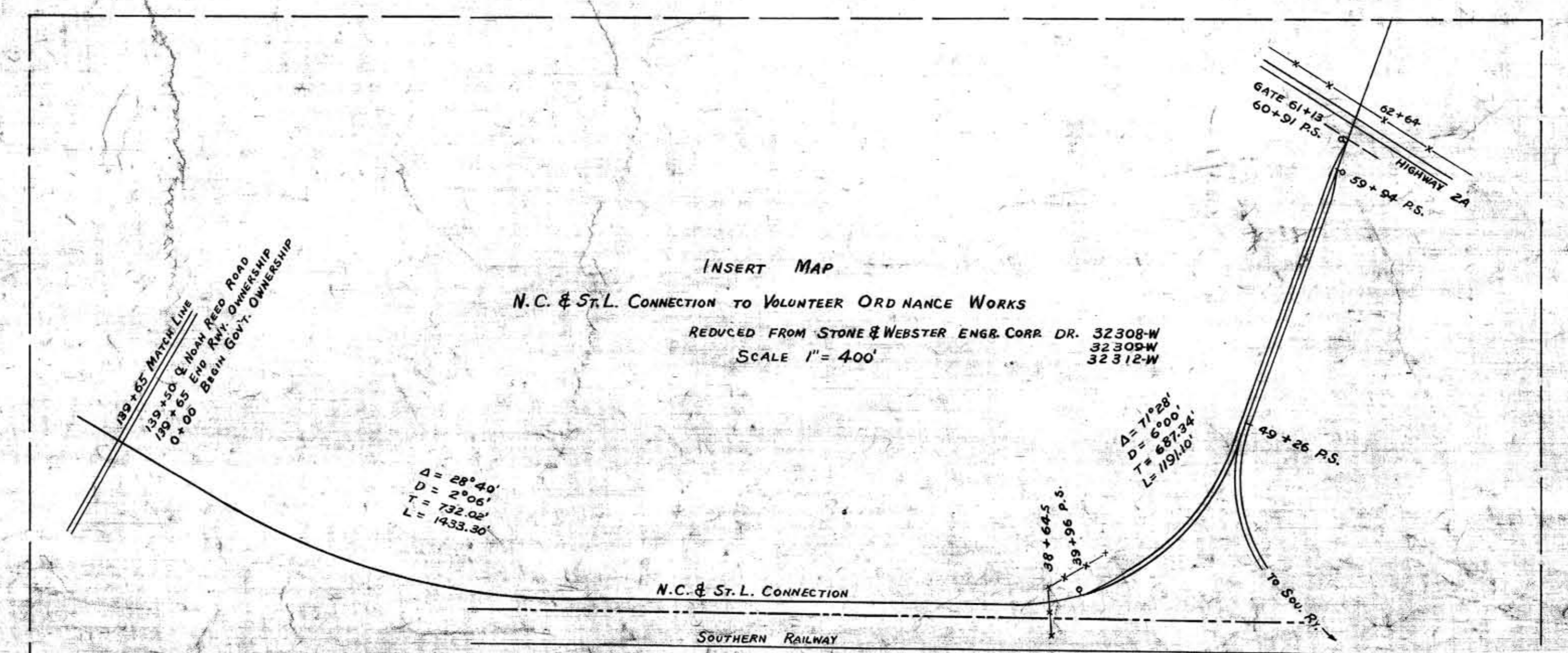

RIGHT-OF-WAY AND TRACK MAP
 NASHVILLE CHATTANOOGA & ST. LOUIS RY.
 TYNER SPUR
 M.P. 1287 ATLANTA DIVISION

STATION 0+00 TO STATION 139+65
 SCALE 1 IN. = 200 FT. JULY 16, 1952

OFFICE OF CHIEF ENGINEER
 NASHVILLE, TENN.

033-040