

HAMILTON COUNTY, TENN.

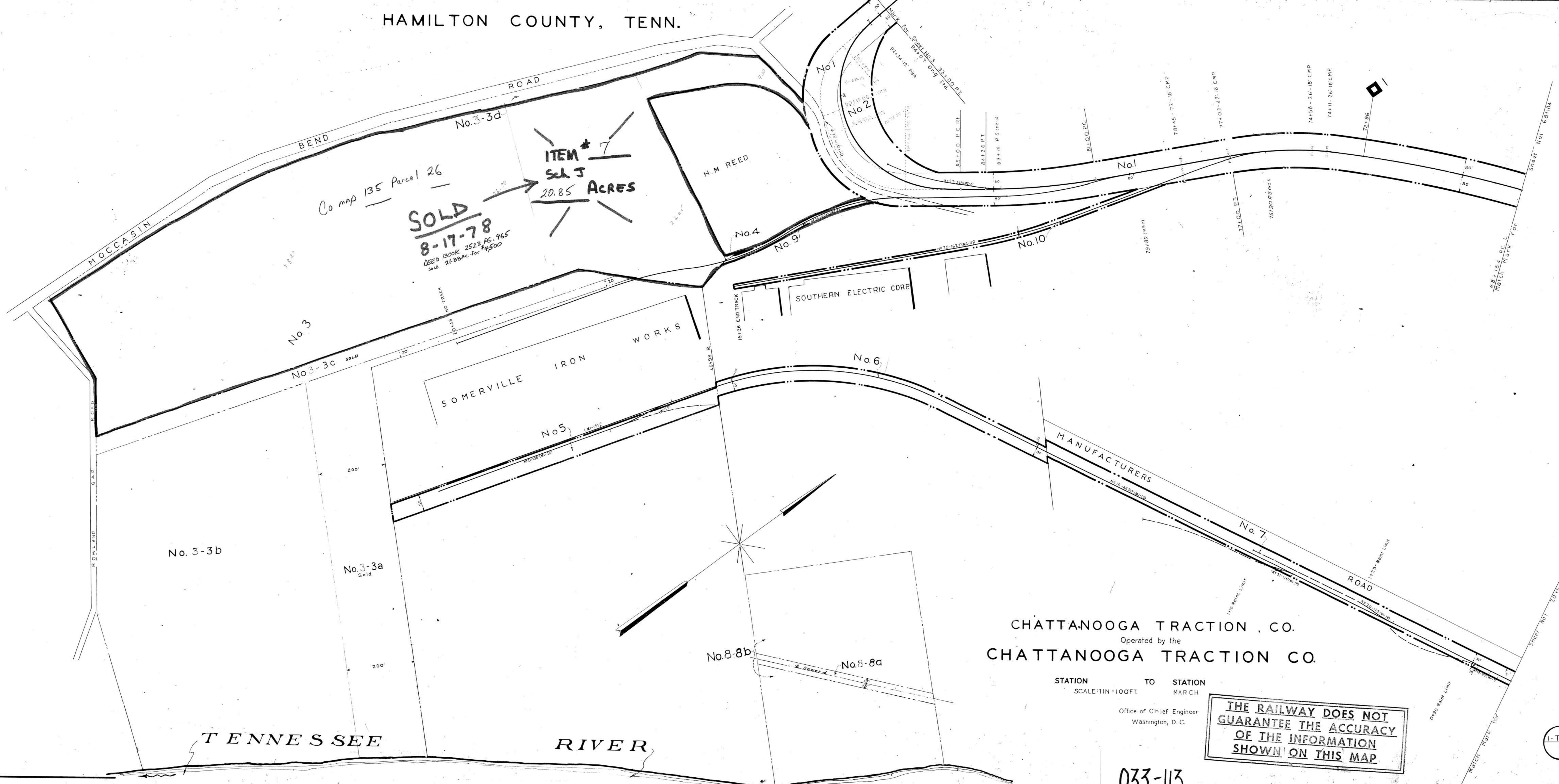

ITEM # 7
Sched J
20.85 ACRES
SOLD
8-17-78
DEED BOOK 2523, PS. 965
sold 21.88 AC for \$4500

SOMERVILLE IRON WORKS

SOUTHERN ELECTRIC CORP

H.M. REED

CHATTANOOGA TRACTION CO.
Operated by the
CHATTANOOGA TRACTION CO.

STATION TO STATION
SCALE: 1" = 100 FT. MARCH

Office of Chief Engineer
Washington, D. C.

THE RAILWAY DOES NOT
GUARANTEE THE ACCURACY
OF THE INFORMATION
SHOWN ON THIS MAP

033-113

1-TENN
2

37A
2

TENNESSEE RIVER