

AFENo. Date Comp. Description of Change
 2888 1-13-28 Const. of fence both sides from Sta. 19225+00 to 19313+31
 A.F.E. 37608 5-13-48 Track for Pittman Const. Co. 3 of M.P.C. 330 at Sta 70+85
 A.F.E. 38367 1-17-49 Ref. Trk #122A 1252 1/2

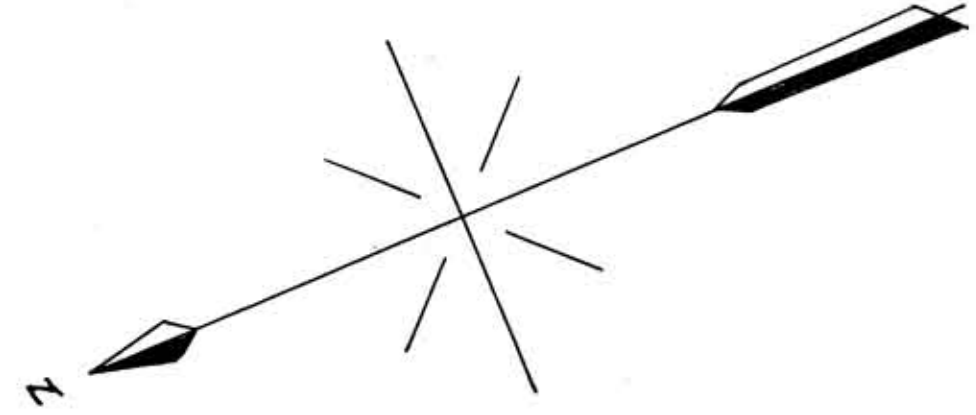

59



Note: - Row fenced on Left Sta 19219+00 to Sta 19224+00

"	"	Right	"	19224+00	"	19225+165
"	"	Left	"	19225+170	"	19226+136
"	"	Right	"	19226+160	"	19227+160
"	"	Left	"	19227+136	"	19228+160

Conf. 3/10/48 A-1-10 Dept. of Highways & Pub. Wks. State of Tenn. Const. of O.R.C. State Highway #53 1920 So. of MP 350
 L.F. 19429 36.432 4-21-48 Pittman Construction Company const. Trk #122A at Sta 70+85
 L.F. 19436 36.390 4-6-50 Volunteer Electric Co-op. Power line x-ing at Sta. 19277+20.7

RIGHT OF WAY AND TRACK MAP
 LOUISVILLE AND NASHVILLE R. R. CO.
 ATLANTA DIVISION "NEW LINE"
 STATION 19219+00 TO STATION 19324+60
 SCALE - 1 INCH = 200 FT. JUNE 30 1917.

070-009

SHEET NO. 38 OF 51 OF ATLANTA DIVISION - NEW LINE FROM SURVEY
 STATION 19219+00 TO SURVEY STATION 19324+60

N. B. Williams
 SURVEYOR

Polk County Tenn.

59

129
 38