

A.F.E. No.	DATE	DESCRIPTION
371	4-30-19	Replace 60" Angle Bars with 60" x 24" Cont. Jts. Mile 157-247. Mile 158-352.
538	3-29-20	Install electric lights in Rockwood Depot.
542	5-24-20	Construct Wells Slope Spur Track - 830' long. R.S. sta. 8320+11.
587	6-15-20	Retire 2244' of Wrights Mine Track #169 by sale to R.I. Co. (H.F. to end).
578	10-27-20	Erect 11,900 Gal. Water Tank at Rockwood. Sta. 8278+00.
601	9-23-21	Retire Clymers Slope Track #170 and Siding Trk #171.
692	9-23-21	Retire Wells Slope Spur Track, 830' long.
701	1-31-22	Retire all roadway property by sale to T.C.R.R. Co.
53	2-1-22	Addition of all roadway property by purchase from T.C.R.R. Co.
399	2-10-23	Apply 760 add. 7"x9" tie plates - Mile 157.
22	6-22-23	Apply add. 7"x9" tie plates. Mile 157-800. Mile 158-1350.
15	12-31-23	Lay new 80" rail. Main Track - sta. 8231+70 to 8331+30. Trk. #161-132. Trk. #162-110' and lengthen 8; R.S. 8280+38. Trk. #160-115' and lengthen 5; P.S. 8278+58. Trk. #169-73'.
242	12-31-23	Apply 100 add. 5"x7" tie plates - Trk #164.
1020	12-31-23	Apply slag ballast. Mile 157-165 Cu.Yd. Mile 158-182 Cu.Yd. Convert 28 Cu.Yd. Cinders to emb. - Mile 157.
1020	12-31-24	Apply slag ballast. Mile 157-104 C.Y. Mile 158-337 C.Y. Convert 18 C.Y. Cinder ballast to emb. - Mile 157.
372	1-6-25	Install fire extinguisher in Rockwood Depot.
1020	12-31-25	Apply 243 Cu.Yd. Slag ballast and convert 41 Cu.Yd. Cinder ballast to embankment - Mile 157.
1366	1925	Retire cross ties from Main Track. Mile 157-52. Mile 158-43.
539	4-5-26	Retire Comb. Station at Rockwood.
495	6-12-26	Apply add. 7"x9" tie plates. Mile 157-1632. Mile 158-4090. Trk. #161-162. Trk. #163-144. Trk. #164-339. Trk. #165-392. Trk. #166-668.
562	10-20-26	Apply 840 add. 7"x8 1/2" tie plates - Mile 157.
969	12-31-26	Place 1 set #9 treated switch ties - Trk. #161.
1020	12-31-26	Apply slag ballast. Mile 157-314 C.Y. Mile 158-261 C.Y. Convert 53 C.Y. Cinders to embankment - Mile 157.
601	7-6-27	Construct creos. B. & W. ties 91' and 62' long replacing E. and W. Approaches of Br. #156-21.
631	8-31-27	Apply 1490 add. 7"x9" tie plates - Mile 157.
1086	8-31-27	Retire Track #167.
967	12-31-27	Place 184 creos. cross ties - Mile 157.
1020	12-31-27	Apply 175 C.Y. Slag ballast and convert 29 C.Y. Cinder ballast to emb. - Mile 157.
1430	12-31-27	Construct R.H. Fence, S. side sta. 8327+80 to 8331+30.
760	7-30-28	Install single 70" Gal. Rail with Mancy fittings - sta. 8242+01 to 8251+82.5.
503	12-30-28	Lay new 80" rail. Main Track - sta. 8225+70 to 8252+64.

A.F.E. No.	DATE	DESCRIPTION
1020	12-31-28	Apply 384 Cu.Yd. add. Slag ballast - Mile 158.
992	12-31-29	Apply add. ballast. Mile 157-100 Cu.Yd. Mile 158-105 Cu.Yd.
1114	12-31-30	Apply 33 Cu.Yd. add. Screenings ballast - Mile 158.
1271	2-3-31	Retire 166' W. end Passing Track #161.
1240	12-31-31	Apply 34 Cu.Yd. add. Screenings ballast - Mile 157.
1474	12-31-31	Replace unt. cross ties with creos. cross ties. Mile 157-415. Mile 158-300.
1009	1931	Apply add. 7"x9" tie plates. Mile 157-200. Mile 158-160.
1608	1-5-32	Retire Wrights Mine Track #169-73' long.
1353	12-31-32	Apply 34 Cu.Yd. add. Stone ballast - Mile 157.
1502	8-19-33	Construct Freight and Passenger Depot at Rockwood - 2 Coach Bodies.
1505	9-27-33	Construct Passing Track 2109' long. R.S. sta. 8282+23 and 8303+32. Retire Trk. #168.
1504	9-31-33	Retire Trks. #161, 163, 164, 165, 1038' of #166, 1436' of #162. Extend Trk. #162 westerly 352' - new length 477'.
1706	10-35	Install car body freight Depot.
1983	11-2-37	Construct 411' Team Track.
1995	11-20-37	Retire two Westerly Section Dwellings.
1963	11-10-37	Replace Pass. & Frt. facilities with Comb. Station.

THIS MAP WAS NOT PREPARED OR INTENDED FOR USE AS A REAL ESTATE TITLE MAP. THE RAILWAY COMPANY DOES NOT REPRESENT OR SUGGEST THAT THE PROPERTY LINES AND RIGHT-OF-WAY LINES SHOWN ON THE MAP ARE ACCURATE, OR THAT ANY OTHER INFORMATION ON THE MAP IS CORRECT. THE COMPANY DOES NOT REPRESENT THAT IT HAS CHECKED THIS MAP FOR ACCURACY.

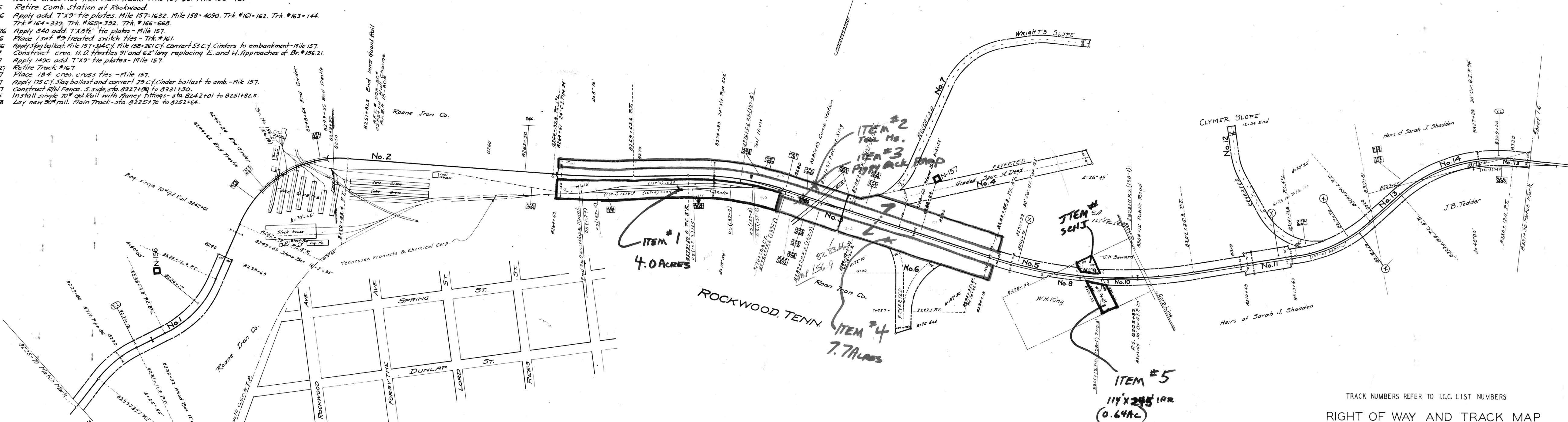

PARCEL	GRANTOR	GRANTEE	INSTR.	DATE	CONSID.	AREA ACRES	RECORDED BOOK	RECORDED PAGE	RECORDED DATE	CUSTOD.	REMARKS
1, 2, 3, 4	A. Battle Rader Trust I.C.R. Co.	H. & N.E. R.R. Co.	deed	3-20-69						ASB-83	
5, 10, 11, 12, 14	"	"	"	"						"	
All	H. & N.E. R.R. Co.	C.N.O. & T.P. R.R. Co.	Finance	Docket	No. 2501	Service Data	3-18-70			"	

TRACK NUMBERS REFER TO I.C.C. LIST NUMBERS
 RIGHT OF WAY AND TRACK MAP
 HARRIMAN & NORTHEASTERN R.R. CO.
 OPERATED BY THE
 HARRIMAN & NORTHEASTERN R.R. CO.

STATION 8225+70 TO STATION 8331+30
 SCALE: 1 IN. = 200 FT. REVISED MAY 1969
 OFFICE OF CHIEF ENGINEER ATLANTA, GA.

