

SULLIVAN COUNTY, TENN.

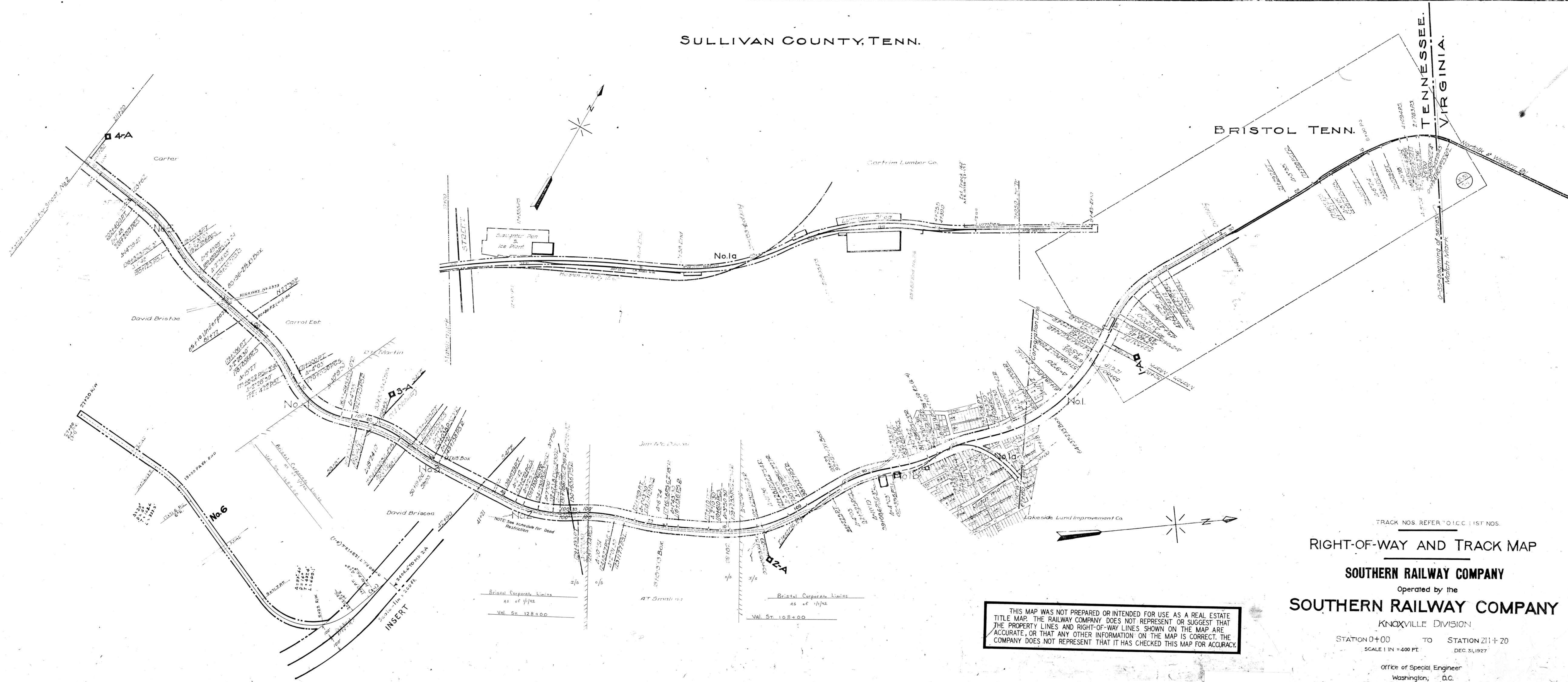

BRISTOL TENN.

TENNESSEE-VIRGINIA

TRACK NOS REFER TO I.C.C. LIST NOS.

RIGHT-OF-WAY AND TRACK MAP

SOUTHERN RAILWAY COMPANY

Operated by the

SOUTHERN RAILWAY COMPANY

KNOXVILLE DIVISION

STATION 0+00 TO STATION 211+20

SCALE 1 IN = 400 FT. DEC. 31, 1927

Office of Special Engineer
Washington, D.C.

THIS MAP WAS NOT PREPARED OR INTENDED FOR USE AS A REAL ESTATE TITLE MAP. THE RAILWAY COMPANY DOES NOT REPRESENT OR SUGGEST THAT THE PROPERTY LINES AND RIGHT-OF-WAY LINES SHOWN ON THE MAP ARE ACCURATE, OR THAT ANY OTHER INFORMATION ON THE MAP IS CORRECT. THE COMPANY DOES NOT REPRESENT THAT IT HAS CHECKED THIS MAP FOR ACCURACY.