

SULLIVAN COUNTY, TENN.



Retired, AFE 7871 Nov. 1939.

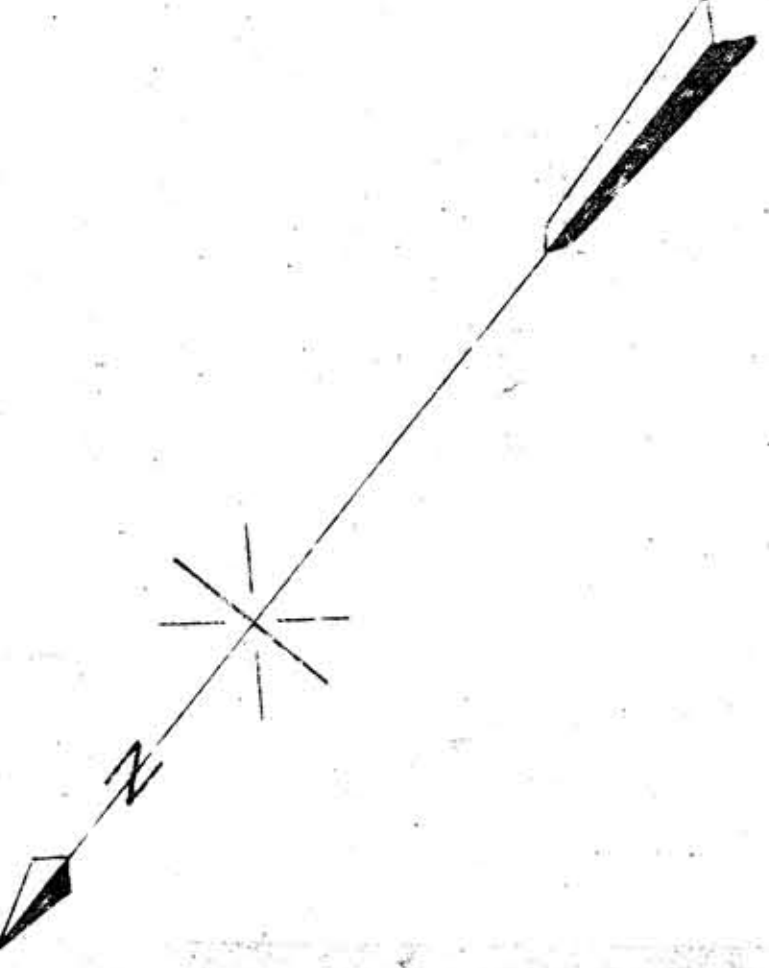

THIS MAP WAS NOT PREPARED OR INTENDED FOR USE AS A REAL ESTATE TITLE MAP. THE RAILWAY COMPANY DOES NOT REPRESENT OR SUGGEST THAT THE PROPERTY LINES AND RIGHT-OF-WAY LINES SHOWN ON THE MAP ARE ACCURATE, OR THAT ANY OTHER INFORMATION ON THE MAP IS CORRECT. THE COMPANY DOES NOT REPRESENT THAT IT HAS CHECKED THIS MAP FOR ACCURACY.

TRACK NOS. REFER TO I.C.C. LIST NOS.

RIGHT-OF-WAY AND TRACK MAP  
 VIRGINIA & SOUTHWESTERN RAILWAY COMPANY  
 OPERATED BY THE  
 SOUTHERN RAILWAY COMPANY  
 APPALACHIA DIVISION

STATION 29+42 TO STATION 240+62  
 SCALE 1 IN. = 400 FT. DECEMBER 31, 1927

OFFICE OF SPECIAL ENGINEER  
 WASHINGTON, D.C.

STATIONING REFERS TO I.C.C. INVENTORY CHAINAGE—1916.

V.5  
 1