

This is the main line of R.R.

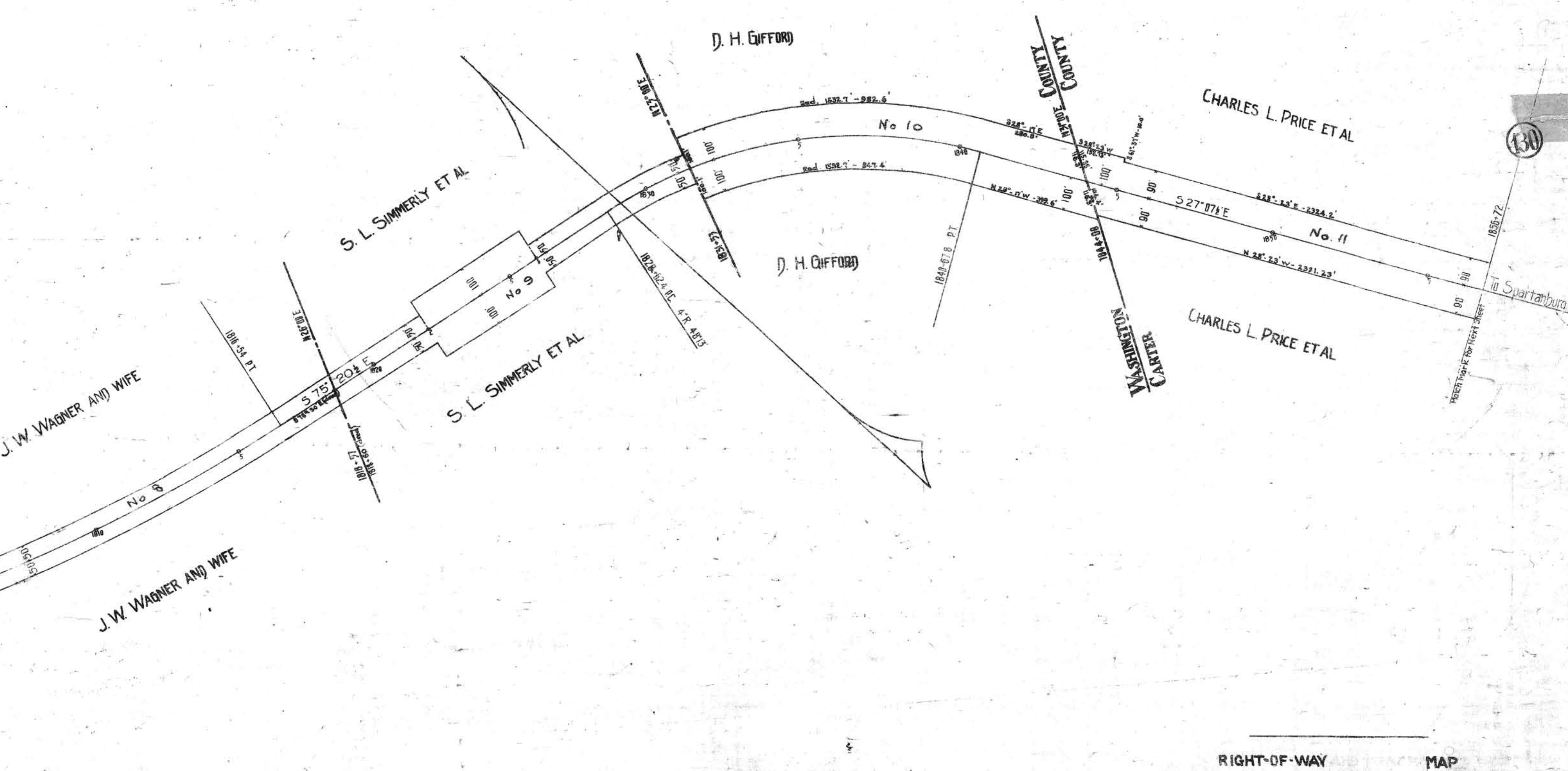

RIGHT-OF-WAY MAP
CAROLINA, CLINCHFIELD AND OHIO RAILWAY
 MILE POST 128 TO MILE POST 130
 STATION 1751+12 TO STATION 1856+72
 SCALE: 1 in. = 200 ft. JUNE 30, 1917.
 OFFICE OF CHIEF ENGINEER,
 JOHNSON CITY, TENN.
 REVISED AND CORRECTED TO DEC. 31, 1928.

Sheet No. 17a of sheets of the Carolina, Clinchfield and Ohio Railway from Survey Station to Survey Station.
O. Morgan
 Engineer.

090-009

V-TENN 17a