

NO.	GRANTOR	GRANTEE	INSTRUMENT	DATE	RECORD	COST. NO.	REMARKS
1	Bon Air Coal, Lend & Lumber Co.	N.C. & St. L. Ry.	Deed	Nov. 21, 1901	DB 41-145-Jan. 16, 1902	3035	See Note 1
2	The Bon Air Coal & Iron Co.	N.C. & St. L. Ry.	Deed	Mar. 21, 1902	DB 43-161-Mar. 30, 1903	3036	Track 2-See Note 2.
3			None				

Note 1- Deed provides for such additional right of way as may be required at deep cuttings and embankments and for the change of common roads and water courses, for the full and correct construction and maintenance of the railroad.  
 Note 2- Title by possession.

All Track Abandoned  
 + Property Reverted on  
 Disposed

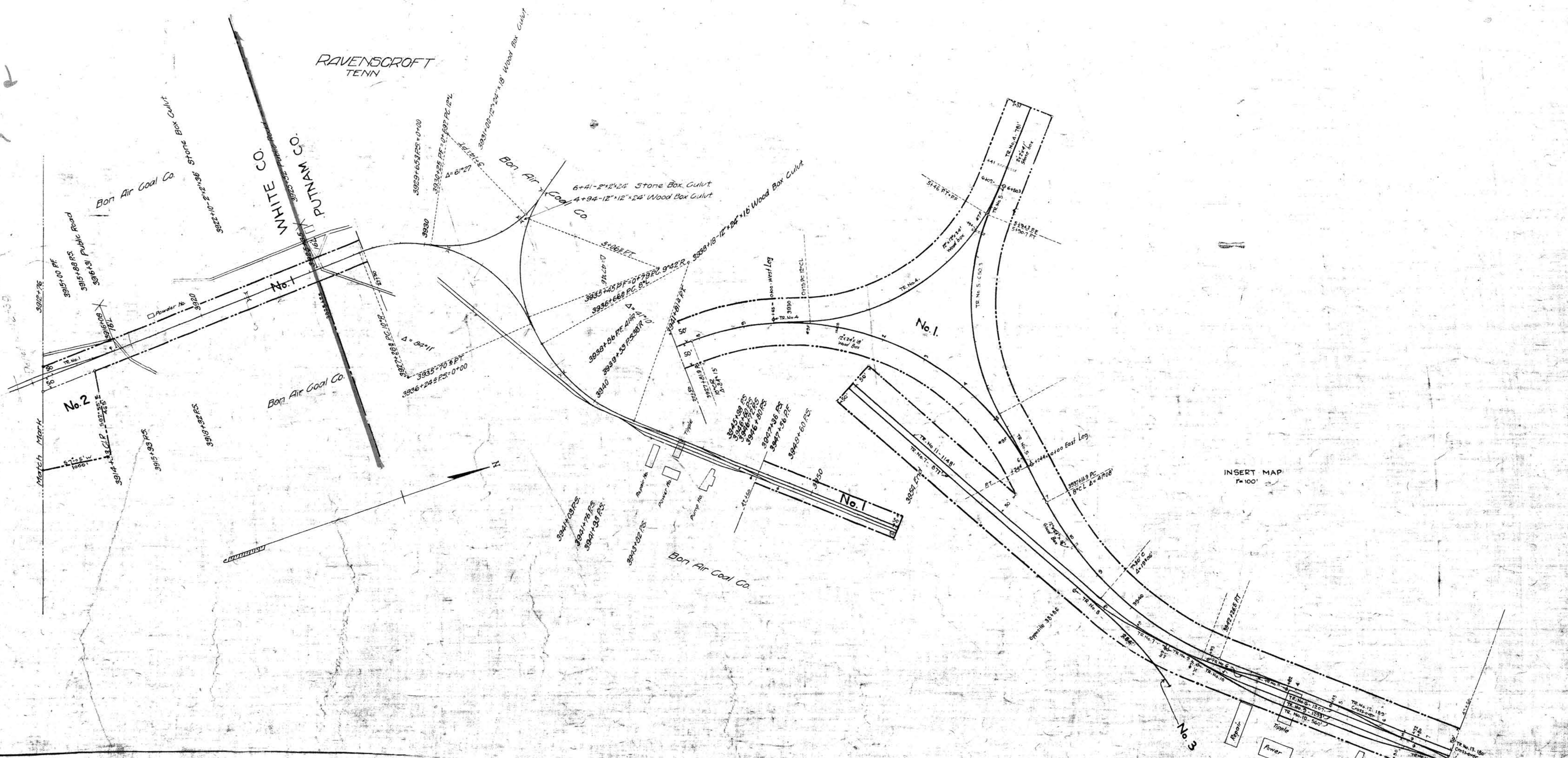

INSERT MAP  
 1"=100'

RIGHT-OF-WAY AND TRACK MAP  
 NASHVILLE, CHATTANOOGA AND ST. LOUIS RY.  
 SPARTA BRANCH  
 STATION 3912+76 TO STATION 3954+00  
 SCALE, 1 IN. = 200 FT. JUNE 30, 1916  
 OFFICE OF CHIEF ENGINEER  
 NASHVILLE, TENN.

Sheet No. 37-B of 44 sheets of  
 Sparta Branch from survey  
 station 3912+76 to survey station  
 3954+00

093-017