

A/E No.	DATE	DESCRIPTION
54	8-25-18	Retire 60" angle bars and replace with 60" 24" Weber Joints. Mile 27+273.
369	4-25-19	Apply 7" 18 1/2" tie plates to Main Track, Mile 27+1340. Mile 28+640.
701	1-31-22	Retire all roadway property by sale to T.C.R.R. Co.
53	2-1-22	Addition of oil roadway property by purchase from T.C.R.R. Co.
1423	12-31-22	Retire and replace R/W Fence, N.&S. sides, sta. 1452+70 to sta. 1465+30.
22	6-22-23	Apply add. tie plates to Main Track, Mile 27+852-719'. Mile 28+1160-7' 1/2'.
15	12-31-23	Lay new 80" rail in Main Track, sta. 1361+50 to sta. 1467+10.
1424	12-31-23	Construct R/W Fence, N.&S. sides, sta. 1426+65 to 1447+62. Retire R/W Fence, N. side, sta. 1426+65 to 1447+62.
214	2-12-24	Construct ballasted deck bridge, 14' long, replacing Br. #27+40.
320	3-10-24	Retire Br. #27+40, 14' long.
337	7-18-24	Retire Track #24, at Horn Springs.
345	11-20-24	Retire 608-5 1/2" x 8" tie plates from Main Track-Mile 27.
1020	12-31-24	Place 300 cu. yd. slag ballast and convert 1300 cu. yd. cover ballast to embankment-Mile 28.
1020	12-31-25	Apply 53 cu. yd. slag ballast and convert 53 cu. yd. stone ballast to embankment-Mile 27. Apply 50 cu. yd. slag ballast and convert 50 cu. yd. cinder ballast to embankment-Mile 28.
1366	1925	Retire cross ties from Main Track, Mile 27+4. Mile 28+285.
1020	12-31-26	Place 47 cu. yd. Stone ballast and convert 47 cu. yd. Cinder ballast to embankment-Mile 28.
1020	12-31-27	Apply add. Stone ballast, Mile 27+135 cu. yd. Mile 28+186 cu. yd. Convert 186 cu. yd. of Cinder ballast to embankment-Mile 28.
849	10-20-28	Widen fills for Main Track-Mile 27.
808	5-10-29	Apply 430-7' 1/2" and 460-7' 1/2" tie plates to Main Track-Mile 27.
292	12-31-29	Apply 154 Cu. yd. add. ballast to Main Track-Mile 28.
1002	4-23-30	Apply add. 7' x 9" tie plates to Main Track, Mile 27+426. Mile 28+464.
1474	12-31-31	Replace 55 unit cross ties with cross ties-Mile 28.
1606	1931	Retire and replace R/W Fence, S. side, sta. 1361+50 to sta. 1387+00. N. side, sta. 1376+00 to sta. 1393+00. N.&S. sides, sta. 1465+30 to sta. 1467+10.
1731	12-31-36	Construct E/W Fence, N. side, sta. 1414+45 to sta. 1417+25. S. side, sta. 1417+25 to sta. 1418+05. Sta. 1418+05 to sta. 1423+15. S. side, sta. 1406+04 to sta. 1417+25. Retire fence N. side, sta. 1414+45 to sta. 1423+15 & S. side, sta. 1421+20 to sta. 1425+15, S. side, sta. 1406+04 to sta. 1415+46. Install 2 farm gates on Mile 28.
1866	12-31-37	Construct E/W Fence N. Side, Sta. 1363+92 to Sta. 1375+92. Retire fence same limits.
2006	12-31-38	Place tie plates in M.T. Miles 26 & 27.

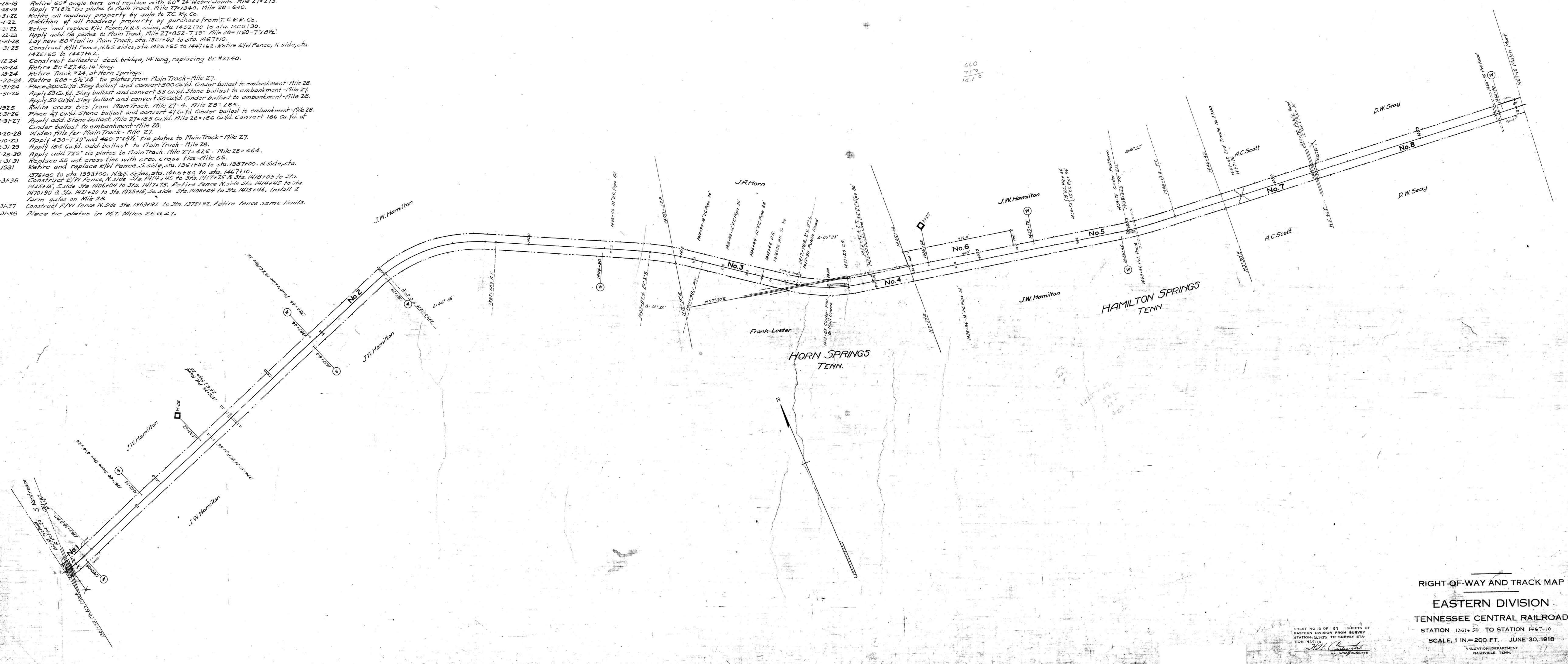

RIGHT-OF-WAY AND TRACK MAP
 EASTERN DIVISION
 TENNESSEE CENTRAL RAILROAD
 STATION 1361+50 TO STATION 1467+10
 SCALE, 1 IN. = 200 FT. JUNE 30, 1918
 VALUATION DEPARTMENT
 NASHVILLE, TENN.

SHEET NO. 13 OF 37 SHEETS OF
 EASTERN DIVISION FROM SURVEY
 STATION 1361+50 TO SURVEY STA-
 TION 1467+10
 J. H. C. [Signature]
 VALUATION ENGINEER