

*Honolulu  
International Airport*





## Basement Level

- International baggage handling areas
- Building utility systems
- Tenant supply and support facilities

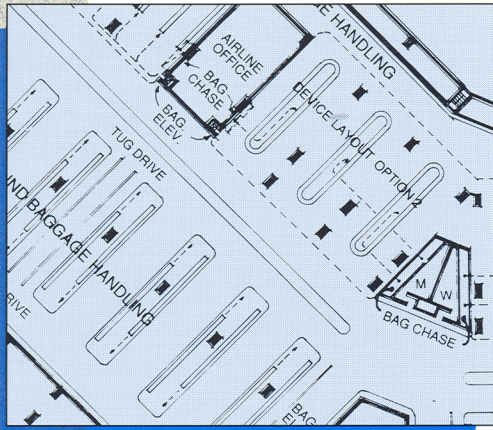

## Ground Level

- Federal Inspection Services (FIS) facilities
- Enplaning and deplaning passenger tour group facilities
- International tour group baggage handling system

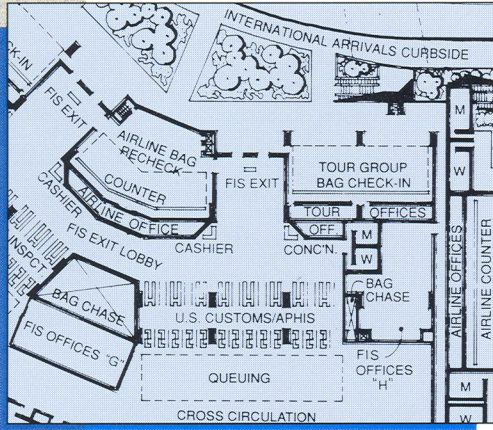

## Second Level

- International passenger check-in and ticketing facilities
- Concessions and passenger service facilities
- Security screening and agricultural inspection

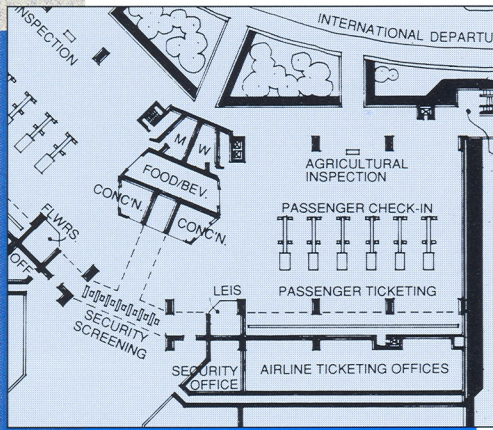

## Third/Fourth Level

- Airline VIP clubrooms and offices
- FIS "Aloha" lounges
- On-Airport ride system

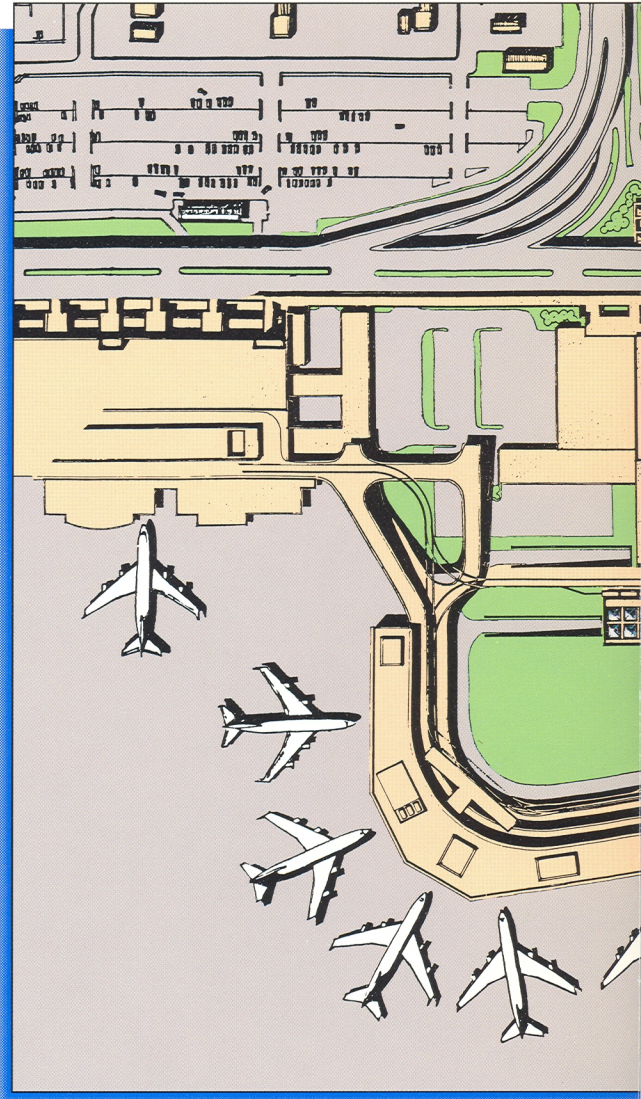
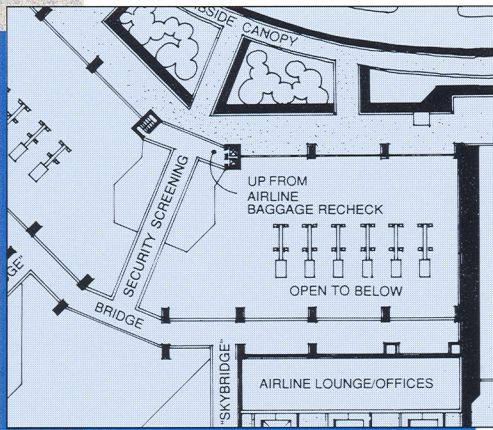

## Plan Features

A terminal building for arriving and departing international passengers that reflects the spirit of Hawaii.

A spacious and aesthetically pleasing arrival hall for baggage claim and passenger processing by the Federal Inspection Services.



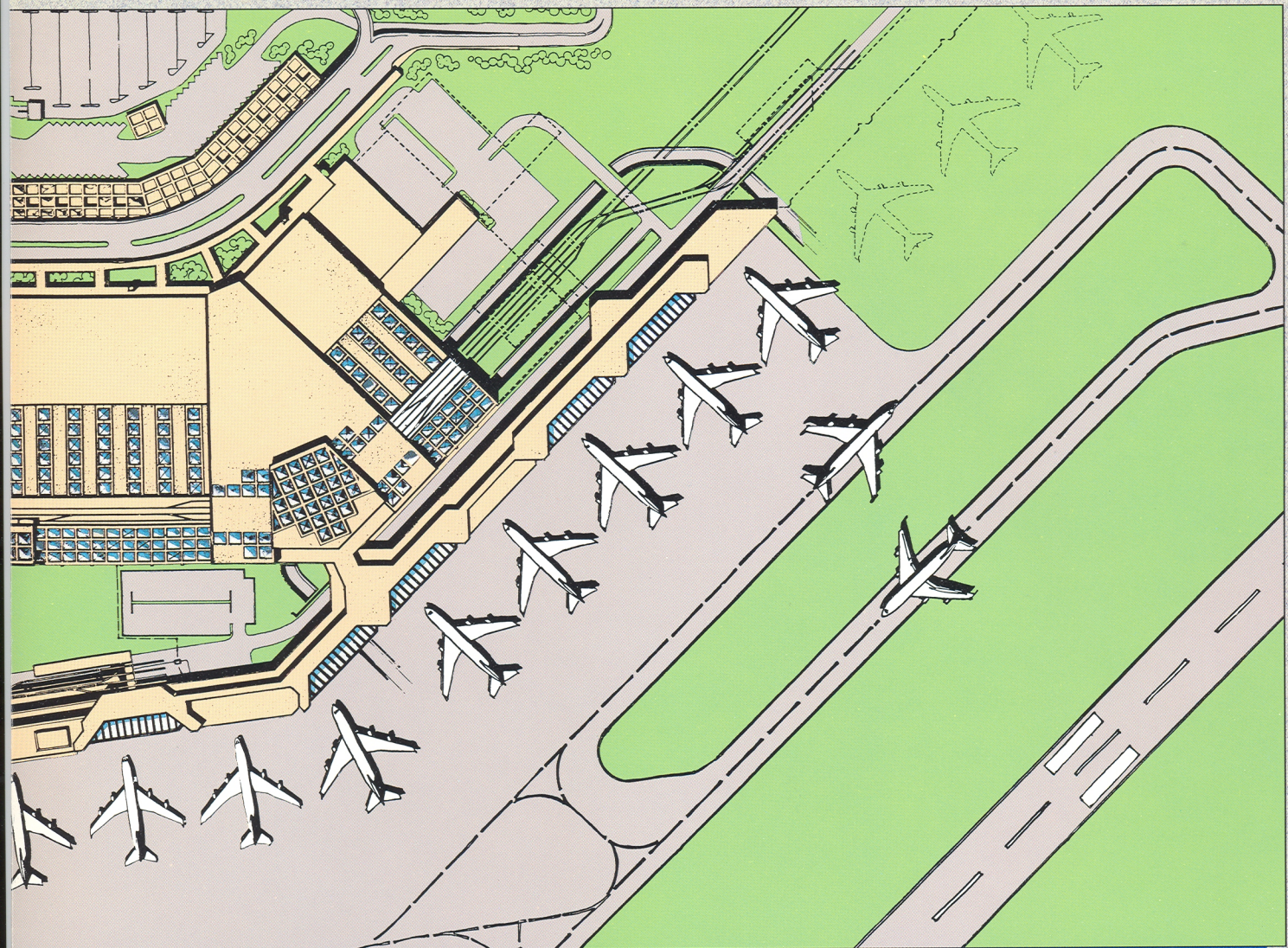

An extension of the Diamond Head Concourse to provide additional passenger waiting lounges and aircraft parking positions.

Conveniently located ticketing and check-in facilities adjacent to a central shopping atrium to allow passengers to purchase duty-free goods, Hawaiian gifts and packaged foods prior to walking or riding to their gates.

A state-of-the-art people-mover system for transporting passengers to and from their gates and between terminals.

An attractive ground transportation center for arriving international tour group passengers, where lei greeting, picture taking, distribution of tour literature and boarding of ground transportation vehicles can take place.



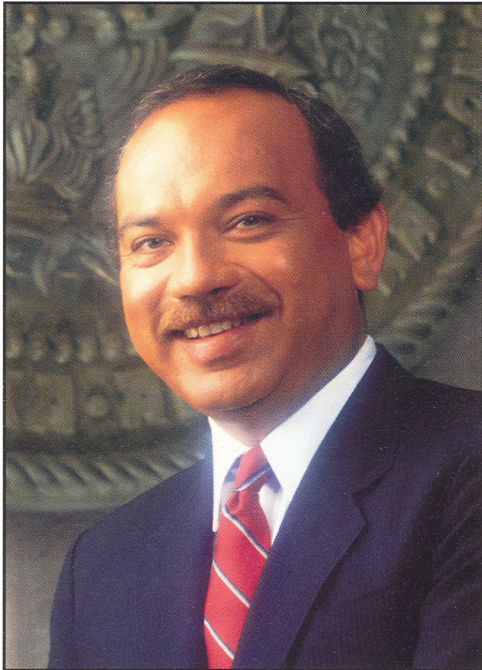

## Message from Governor John Waihee

In 1987 and 1988, international traffic at Honolulu International Airport increased more than 20% per year. With the continued expansion of the Pacific Rim economy and the potential for increased numbers of tourists from Europe, it is anticipated that the strong growth in international traffic will continue well into the twenty-first century. However, the growth in international traffic is currently constrained by two factors: (1) the number of flights permitted between various countries and Hawaii, and (2) the airport facilities currently available to accommodate arriving international passengers.

The State Department of Transportation is working hard, together with the federal government, to open new routes to Hawaii. Our action is in the best interest of Hawaii's traveling public and our visitors because it gives people options. And, when we expand our air routes, we also open new markets for the export of Hawaiian agricultural products. First class airport facilities will serve the people of Hawaii, the visitors to Hawaii, and the businesses of Hawaii.

We are the premier gateway to the United States from the Pacific Rim. We will have the premier international airport in the United States to serve all who use it.

A handwritten signature in black ink that reads "John Waihee". The signature is fluid and cursive, with a long horizontal stroke at the beginning.



Edward Y. Hirata, Director  
Department of Transportation  
State of Hawaii  
869 Punchbowl Street  
Honolulu, Hawaii 96813  
(808) 548-2268