

# D0-16

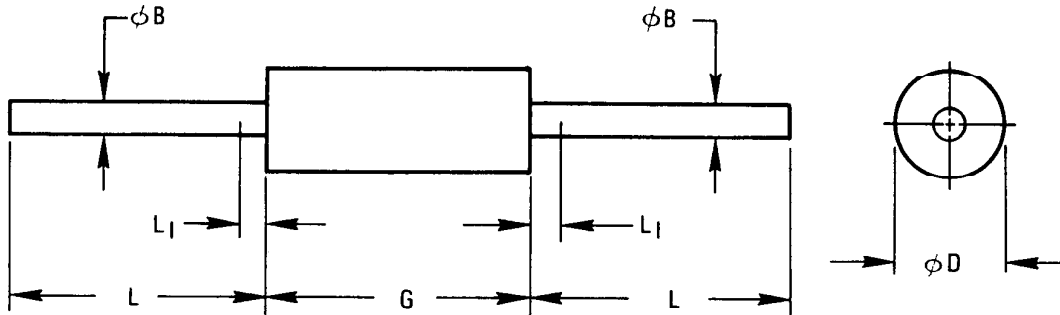

MILLIMETER DIMENSIONS ARE DERIVED FROM ORIGINAL INCH DIMENSIONS.

SYMBOL	INCHES		MILLIMETERS		NOTES
	MIN.	MAX.	MIN.	MAX.	
$\phi B$	.009	.013	.228	.330	-
$\phi D$	-	.050	-	1.27	1
G	.050	.100	1.27	2.54	1
L	.450	-	11.43	-	-
$L_1$	-	.050	-	1.27	2

## NOTES:

1. PACKAGE CONTOUR OPTIONAL WITHIN CYLINDER OF DIAMETER  $\phi D$  AND LENGTH  $G$ . SLUGS, IF ANY, SHALL BE INCLUDED WITHIN THIS CYLINDER.
2. LEAD DIAMETER NOT CONTROLLED IN THIS ZONE TO ALLOW FOR FLASH, LEAD FINISH BUILD-UP, AND MINOR IRREGULARITIES OTHER THAN SLUGS.