

LCD Digital Colour TV

Operating Instructions

Setting Up

Watching TV

Using PlayStation™2

Additional Information

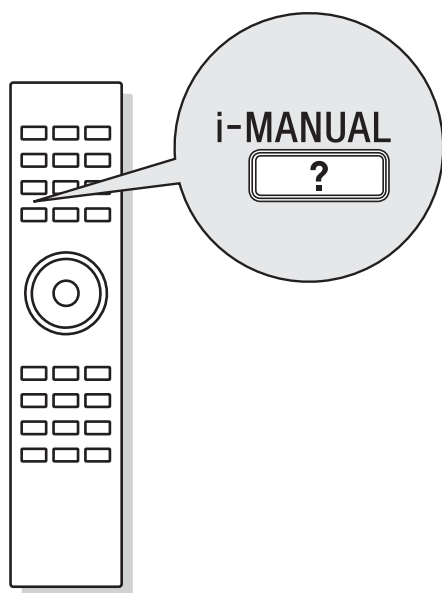

BRAVIA

NOTICE FOR CUSTOMERS IN THE UNITED KINGDOM

A moulded plug complying with BS 1363 is fitted to this equipment for your safety and convenience.

Should the fuse in the plug supplied need to be replaced with the same rating of fuse approved by ASTA or BSI to BS 1362 (i.e., marked with \diamond or \heartsuit) must be used. When an alternative type of plug is used it should be fitted with the same rating of fuse, otherwise the circuit should be protected by a 10 AMP FUSE at the distribution board.

If the plug supplied with this equipment has a detachable fuse cover, be sure to attach the fuse cover after you change the fuse. Never use the plug without the fuse cover. If you should lose the fuse cover, please contact your nearest Sony service station.

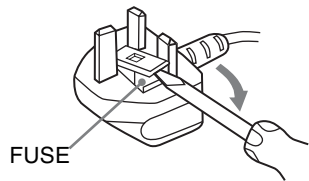
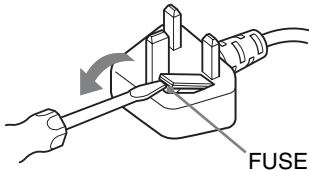

How to replace the fuse

Open the fuse compartment with a blade screwdriver, and replace the fuse. Please refer to the illustration that actually equipped with the product.

Introduction

Thank you for choosing this Sony product. Before operating the TV, please read this manual thoroughly and retain it for future reference.

The manufacturer of this product is Sony Corporation, 1-7-1 Konan Minato-ku Tokyo, 108-0075 Japan. The Authorized Representative for EMC and product safety is Sony Deutschland GmbH, Hedelfinger Strasse 61, 70327 Stuttgart, Germany. For any service or guarantee matters please refer to the addresses given in separate service or guarantee documents.

Notes on Digital TV function

- Any functions related to Digital TV (DV3) will only work in countries or areas where DVB-T (MPEG-2 and H.264/MPEG-4 AVC) digital terrestrial signals are broadcast or where you have access to a compatible DVB-C (MPEG-2 and H.264/MPEG-4 AVC) cable service. Please confirm with your local dealer if you can receive a DVB-T signal where you live or ask your cable provider if their DVB-C cable service is suitable for integrated operation with this TV.
- Your cable provider may charge a fee for their services, or require you to agree to its terms and conditions of business.
- This TV set complies with DVB-T and DVB-C specifications, but compatibility with future DVB-T digital terrestrial and DVB-C digital cable broadcasts are not guaranteed.
- Some Digital TV functions may not be available in some countries/areas and DVB-C cable may not operate correctly with some providers.

For a list of compatible cable providers, refer to the support web site:

<http://support.sony-europe.com/TV/DVBC/>

Trademark information

DV3 is a registered trademark of the DVB Project.

HDMI, the HDMI Logo, and High-Definition Multimedia Interface are trademarks or registered trademarks of HDMI Licensing LLC in the United States and other countries.

DLNA®, the DLNA Logo and DLNA CERTIFIED® are trademarks, service marks, or certification marks of the Digital Living Network Alliance.

DivX® is a video file compression technology, developed by DivX, Inc.

DivX®, DivX Certified® and associated logos are registered trademarks of DivX, Inc. and are used under license.

ABOUT DIVX VIDEO: DivX® is a digital video format created by DivX, Inc. This is an official DivX Certified device that plays DivX video. Visit www.divx.com for more information and software tools to convert your files into DivX video.

ABOUT DIVX VIDEO-ON-DEMAND: This DivX Certified® device must be registered in order to play DivX Video-on-Demand (VOD) content. To generate the registration code, locate the DivX VOD section in the device setup menu. Go to vod.divx.com with this code to complete the registration process and learn more about DivX VOD.

Manufactured under license from Dolby Laboratories. Dolby and the double-D symbol are trademarks of Dolby Laboratories.

“BRAVIA” and BRAVIA are trademarks of Sony Corporation.

“XMB” and “cross media bar” are trademarks of Sony Corporation and Sony Computer Entertainment Inc.

“PS”, “PlayStation”, “PS2”, “DUALSHOCK” and “△ ○ × □” are registered trademarks of Sony Computer Entertainment Inc.

Sony Corporation uses DNAS (Dynamic Network Authentication System), a proprietary authentication system, to help protect copyright and security in connecting the PlayStation™2 console to a network. DNAS may retrieve information about a user's hardware and software for authentication, copy protection, account blocking, system, rules, or game management and other purposes. The information collected does not identify the user personally. The unauthorised transfer, exhibition, export, import or transmission of programs and devices circumventing its authentication scheme may be prohibited by law.

DVD VIDEO is a trademark of DVD Format/Logo Licensing Corporation.

HDMI
HIGH-DEFINITION MULTIMEDIA INTERFACE

DOLBY
DIGITAL

DLNA
CERTIFIED

DVD
VIDEO

COMPACT
disc

DVD
ROM

About copy protection

Attempted copying of DVDs played on this device may be prevented or restricted by copy protection technology contained on the DVD. Attempted recording or copying of DVDs for private use by the removal or circumvention of copy protection technology may be prohibited under applicable law.

Guarantee

Thank you for buying this Product. The term “Product” means the PlayStation™2 computer entertainment system together with the accessories and/or peripherals with which it is packaged. This Guarantee does not cover any software whether or not packaged with the Product.

Table of Contents

Checking the accessories	3
Inserting batteries into the remote	3
Setting Up	
Connecting an antenna (aerial)/Set Top Box/recorder (e.g. DVD recorder)	4
Preventing the TV from toppling over	4
Organising the AC power cord (mains lead)	5
Performing the initial set-up	5
Watching TV	
To watch programmes	6
To utilise the TV's features	6
To use i-Manual	7
Using PlayStation™2	
About advanced operations of the PlayStation™2	8
Playing content	8
Displaying the main menu.....	8
Additional Information	
Troubleshooting	11
Specifications	12
Safety Information.....	14
Precautions	15
Warning about PlayStation™2	16
Precautions about PlayStation™2.....	16

- Operating instructions are built into your BRAVIA TV. Refer to “To use i-Manual” for operation (page 7).
- Before operating the TV, please read “Safety Information” (page 14). Retain this manual for future reference.

Checking the accessories

Remote (1)

Size AAA batteries (R3 type) (2)

Analog controller (DUALSHOCK®2) (1)

Inserting batteries into the remote

Push and lift the cover to open.

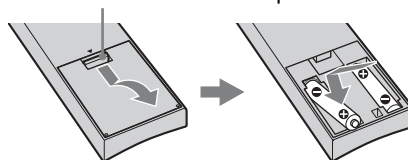

Connecting an antenna (aerial)/Set Top Box/ recorder (e.g. DVD recorder)

Connecting a Set Top Box/recorder (e.g. DVD recorder) with SCART

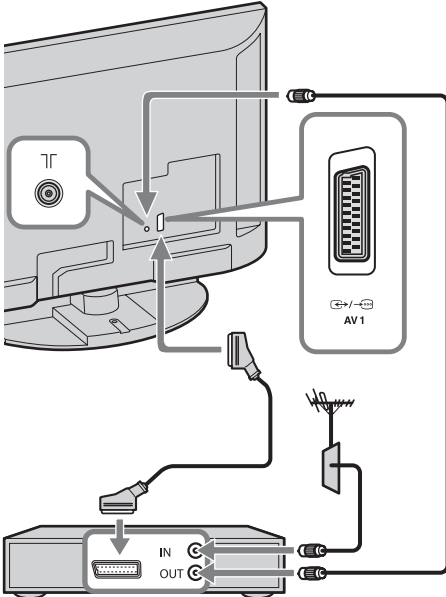

Set Top Box/recorder (e.g. DVD recorder)

Connecting a Set Top Box/recorder (e.g. DVD recorder) with HDMI

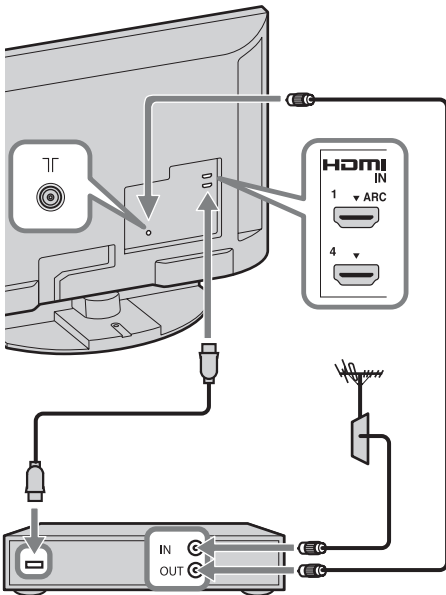

Set Top Box/recorder (e.g. DVD recorder)

Preventing the TV from toppling over

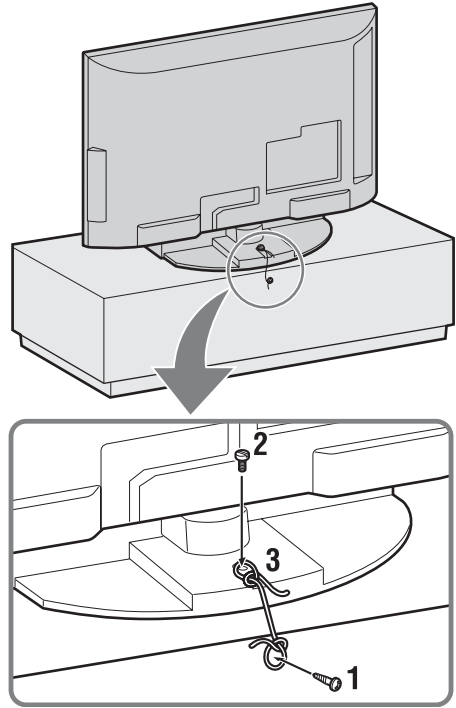

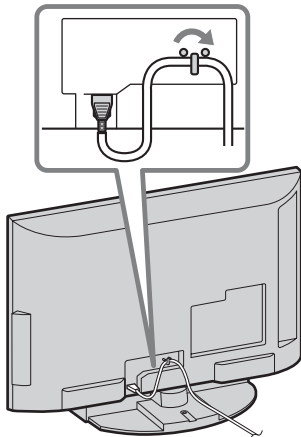

- 1** Install a wood screw (4 mm in diameter, not supplied) in the TV stand.
- 2** Install a machine screw (M4 × 16, not supplied) into the screw hole of the TV.
- 3** Tie the wood screw and the machine screw with a strong cord (not supplied).

Organising the AC power cord (mains lead)

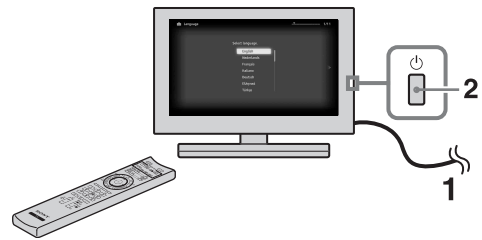

Performing the initial set-up



- 1 Connect the TV to your AC power outlet (mains socket).
- 2 Press  on the TV.
When you switch on the TV for the first time, the Language menu appears on the screen.

3

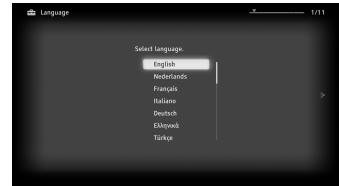





Follow the instructions on the screen.

Digital Auto Tuning: When you select “Cable”, we recommend that you select “Quick Scan” for quick tuning. Set “Frequency” and “Network ID” according to the information supplied from your cable provider. If no channel is found using “Quick Scan”, try “Full Scan” (though it may take some time).

For a list of compatible cable providers, refer to the support web site:

<http://support.sony-europe.com/TV/DVBC/>

Programme Sorting: Changes the order of analogue channels stored in the TV.

- 1 Press  to select the channel you want to move to a new position, then press .
- 2 Press  to select the new position for the channel, then press .



- You can also tune channels manually.
- “Language”, “Time Zone” and “Daylight Savings Time (Summer Time)” of the PlayStation™2 setting menu cannot be set in the initial set-up. They can be set in the main menu for PlayStation settings (page 8).

Watching TV

To watch programmes

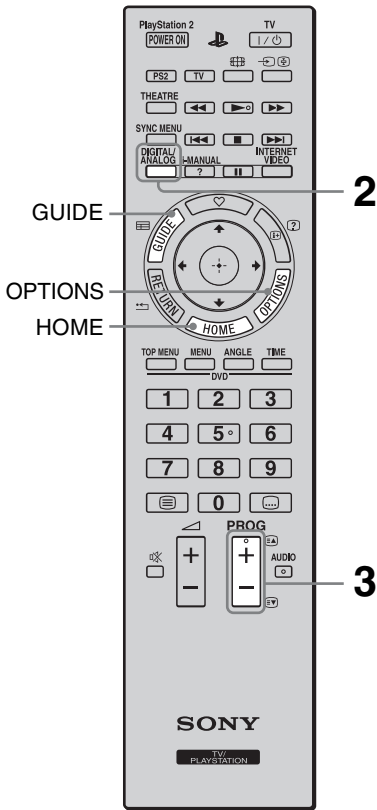

1 Turn on the TV.

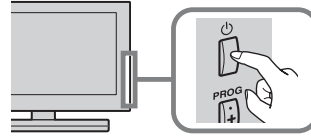

Press  on the TV to turn on the TV.

2 Select a mode.



3 Select a TV channel.

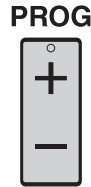

Using Digital Electronic Programme Guide

Press **GUIDE** in digital mode to display the programme guide.



- The number **5**, **▶**, **PROG +** and **AUDIO** buttons on the remote have a tactile dot. Use the tactile dots as a reference when operating the TV.

To utilise the TV's features

HOME button

Press to display various operation and setting screens.

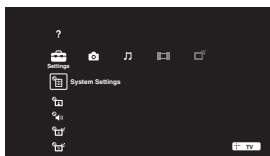

OPTIONS button

Press to display convenient functions based on the current input or content.

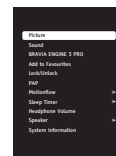

To use i-Manual

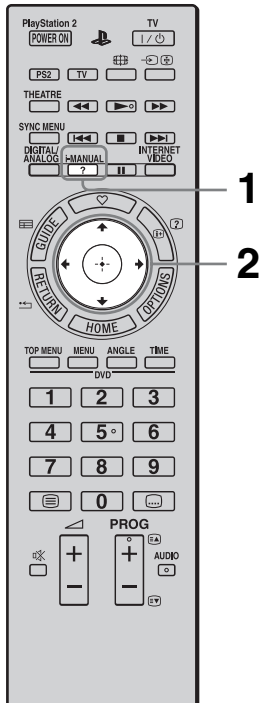

Operating instructions are built into your BRAVIA TV and can be displayed on the screen. You can browse your i-Manual anytime you need to find the varieties of convenient functions.

1 Press i-MANUAL.



2 Press $\leftarrow/\rightarrow/\uparrow/\downarrow/\oplus$ to select items.

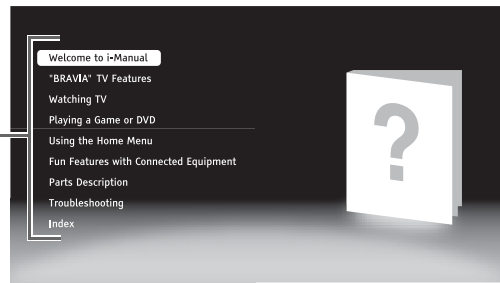
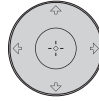

■ Welcome to i-Manual

■ "BRAVIA" TV Features

■ Watching TV

Introduces convenient features such as EPG Guide, Favourites, etc.

■ Playing a Game or DVD

■ Using the Home Menu

Customise your TV settings, etc.



- Images and illustrations may differ from what is displayed on the screen.

■ Fun Features with Connected Equipment

Introduces how to connect optional equipment.

■ Parts Description

■ Troubleshooting

Find solutions for your problem.

■ Index

Using PlayStation™2

About advanced operations of the PlayStation™2

The PlayStation™2 User's Guide is provided for further operation of the PlayStation™2. The User's Guide (in PDF format) is accessible from a PC through the Internet and contains information on performing advanced operations, technical specifications and other information.

Visit www.sony-europe.com/myproduct/, and enter your model name to search for the corresponding User's Guide.

Playing content

You can play games, DVD-Videos and audio CDs on the PlayStation™2.

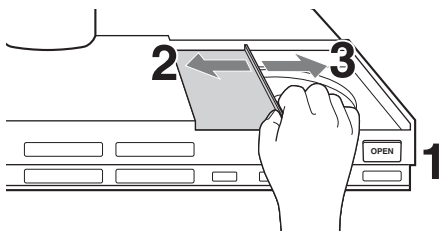

- 1 Press the **OPEN** button to release the disc cover lock.
- 2 Slide the disc cover to the left, then place the disc with the label side facing up.
- 3 Close the disc cover by sliding it to the right until it is locked.



- Be sure to lock the disc cover to play a disc.

Displaying the main menu

From the main menu, you can access information and change various settings. You can also move to the following screens from the main menu. The main menu is displayed when you turn on the console without a disc inserted.

- Browser screen (page 9)
- System Configuration menu (page 9)

- 1 Press **PlayStation 2 POWER ON** on the TV's remote.

The main menu is displayed. Note that it may take some time for the main menu to be displayed.

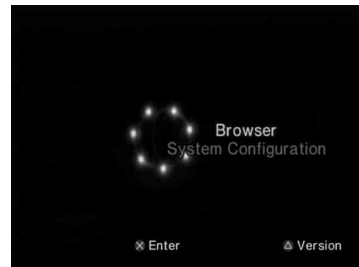

- If you press **PlayStation 2 POWER ON** on the TV's remote with a disc inserted, the main menu will not be displayed. To display the main menu, press the **OPEN** button on the console front and remove the disc. Then press **PlayStation 2 POWER ON** on the TV's remote.

Using the Browser screen

You can do the following from the Browser screen:

- Copy or delete game data saved on a Memory Card
- Start a game
- Start playback of an audio CD
- Start playback of a DVD

- 1 Display the main menu.
- 2 Using the directional buttons, select “Browser” and then press **(X)** button. The Browser screen is displayed.
- 3 Insert a disc or Memory Card. The icon for the inserted item is displayed on the Browser screen.

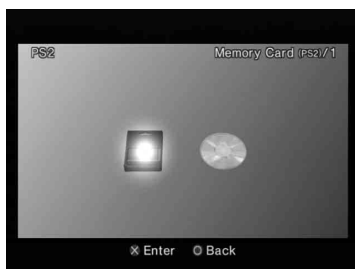

- 4 Select an icon, and then press **(X)** button.
 - When you select the Memory Card icon, icons for data saved on the Memory Card are displayed. To copy or delete saved game data, see i-Manual.
 - If you select the icon for a PlayStation™2 or PlayStation™ format software disc, the game will start.
 - When you select the icon for an audio CD, the tracks contained on the CD are displayed. See i-Manual.
 - If you select the icon for a DVD, playback of the DVD will begin.



- The message “There is no data” is displayed on the Browser screen when no Memory Card or disc is inserted in the console.

Using the System Configuration menu

From the System Configuration menu, you can change settings for numerous options including language or time display, and audio or video output method.

- 1 Display the main menu.
- 2 Using the directional buttons, select “System Configuration” and then press **(X)** button. The System Configuration menu is displayed.



- 3 Select an item, and then press **(X)** button. The menu option becomes active and can be selected.
- 4 Select the desired setting, and then press **(X)** button. For details, see the instructions for each menu item (page 10).





- The default setting for each menu item is underlined in the explanations below.
>
- Changes to each setting are saved and remain in effect even after you turn off or reset the console.

Clock Adjustment

You can set the date and time. Use the directional buttons to set “Year”, “Month”, “Day”, “Hour”, “Minute” and “Second”. The setting goes into effect when you press the **(X)** button.

Optional settings

If you press the  button at the “Clock Adjustment” screen, you can set options such as “Date Format” or “Time Format”. Use the directional buttons and the  button to make each setting.

Time Format	Sets the system clock to either 12-hour or 24-hour clock display
Date Format	Sets the display order of year, month and day
Time Zone	Sets the time zone
Daylight Savings Time	Sets Standard or Daylight Savings (Summer Time). Normally select “Standard”.

Screen Size

You can set the display mode for the TV.

4:3
Full*
16:9

* “Full” display mode is compatible with the System Configuration menu, Browser screen and audio CD screen.

Digital Out (Optical)

You can set whether to output the signal through the DIGITAL OUT (OPTICAL) connector.

On	Select this option when you want to output signal through the DIGITAL OUT (OPTICAL) connector.
Off	Select this option when you do not want to output signal through the DIGITAL OUT (OPTICAL) connector.

Remote Control

You can set this option when using the DVD Remote Control (for PlayStation™2) (sold separately).

Gameplay Function On	Select this option when operating PlayStation™2 or PlayStation™ format software with the DVD Remote Control.
Gameplay Function Off	Select this option when not operating PlayStation™2 or PlayStation™ format software with the DVD Remote Control.



- The following limitations apply when the DVD Remote Control is set to “Gameplay Function On”:

- Depending on the software, some remote control buttons may not work properly
- The buttons of the DVD Remote Control will not work when two or more buttons are pressed at the same time.
- Some software titles may stop operating properly when a controller is removed from controller port 1. If this happens, set to “Gameplay Function Off”.

Language

You can use this option to select the language displayed on the main menu, Browser screen, System Configuration menu, and Version Information screen.

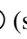

English	Displays messages in English
French	Displays messages in French
Spanish	Displays messages in Spanish
German	Displays messages in German
Italian	Displays messages in Italian
Dutch	Displays messages in Dutch
Portuguese	Displays messages in Portuguese

Troubleshooting

Check whether the  (standby) indicator is flashing in red.

When the (standby) indicator is flashing

The self-diagnosis function is activated.







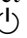
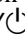



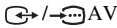

- 1 Count how many times the  (standby) indicator flashes between each three second break.
For example, the indicator may flash three times, go off for three seconds, then flash again three times.
- 2 Press  on the TV to turn it off, disconnect the AC power cord (mains lead), and inform your dealer or Sony service centre of how the indicator flashes (number of flashes).

When the (standby) indicator is not flashing

- 1 Check the items in the tables below. (Also refer to “Troubleshooting” in the i-Manual.)
- 2 If the problem persists, have your TV serviced by qualified service personnel.

Condition	Explanation/Solution
Picture	
There is no picture (screen is dark) and no sound.	<ul style="list-style-type: none"> • Check the antenna (aerial)/cable connection. • Connect the TV to the AC power (mains), and press  on the TV. • If the  (standby) indicator lights up in red, press TV I/.
Tiny black points and/or bright points appear on the screen.	<ul style="list-style-type: none"> • The screen is composed of pixels. Tiny black points and/or bright points (pixels) on the screen do not indicate a malfunction.
Sound	
The audio output from a DVD is low.	<ul style="list-style-type: none"> • Select “Off” in “Digital Out (Optical)” (page 10), and change the output volume from the DVD to “+1” or “+2”. For details, see the User’s Guide on the Internet (page 8).
General	
The TV turns off automatically (the TV enters standby mode).	<ul style="list-style-type: none"> • Check if the “Sleep Timer” is activated, or confirm the “Duration” setting of “On Timer”. • Check if the “Idle TV Standby” is activated.
The remote does not function.	<ul style="list-style-type: none"> • Replace the batteries. • Your TV may be in SYNC mode. Press SYNC MENU, select “TV Control” and then select “Home (Menu)” or “Options” to control the TV. • Check the function buttons on the remote. If PS2 is selected in TV mode or TV is selected in PS2 mode, the remote will not function.
The “Parental Lock” password of the TV setting menu has been forgotten.	<ul style="list-style-type: none"> • Enter 9999 for the PIN code. (PIN code 9999 is always accepted.)
The TV surrounds become warm.	<ul style="list-style-type: none"> • When the TV is used for an extended period, the TV surrounds become warm. You may feel hot when touching there by the hand.

Specifications

System	
Panel system	LCD (Liquid Crystal Display) Panel
TV system	Analogue: Depending on your country/area selection: B/G/H, D/K, L, I Digital: DVB-T/DVB-C
Colour/video system	Analogue: PAL, PAL60 (only video input), SECAM, NTSC3.58 (only video input), NTSC4.43 (only video input) Digital: MPEG-2 MP@ML/HL, H.264/MPEG-4 AVC MP/HP@L4
Channel coverage	Analogue: VHF: E2–E12/UHF: E21–E69/CATV: S1–S20/HYPER: S21–S41 D/K: R1–R12, R21–R69/L: F2–F10, B–Q, F21–F69/I: UHF B21–B69 Digital: VHF/UHF
Sound output	5 W + 5 W
Input/Output jacks	
Antenna (aerial) cable	75 ohm external terminal for VHF/UHF
 AV1	21-pin scart connector (CENELEC standard) including audio/video input, RGB input and TV audio/video output.
 COMPONENT IN	Supported formats: 1080p, 1080i, 720p, 576p, 576i, 480p, 480i
 COMPONENT IN	Audio input (phono jacks)
HDMI IN1, 2, 3, 4	Video: 1080/24p, 1080p, 1080i, 720p, 576p, 576i, 480p, 480i Audio: Two channel linear PCM: 32, 44.1 and 48 kHz, 16, 20 and 24 bits, Dolby Digital Analogue audio input (minijack) (HDMI IN4 only) PC Input
 AV2	Video input (phono jack)
 AV2	Audio input (phono jacks)
 DIGITAL AUDIO OUT (OPTICAL)	Digital optical jack (Two channel linear PCM, Dolby Digital)
 (VAR/FIX)	Audio output (phono jacks)
 PC IN	PC Input (Mini D-sub 15-pin)  PC audio input (minijack)
	USB port
	Headphones jack
	CAM (Conditional Access Module) slot
 LAN	10BASE-T/100BASE-TX connector (Depending on the operating environment of the network, connection speed may differ. 10BASE-T/100BASE-TX communication rate and communication quality are not guaranteed for this TV.) * For LAN connections, use a Category 7 10BASE-T/100BASE-TX cable (not supplied).

Model name KDL-		22PX300
Power and others		
Power requirements		220 V – 240 V AC, 50 Hz
Screen size (measured diagonally)		Approx. 54.8 cm/22 inches
Display resolution		1,366 dots (horizontal) × 768 lines (vertical)
Power consumption	in “Home”/ “Standard” mode	39.0 W
	in “Shop”/“Vivid” mode	90.0 W
Standby power consumption*1		0.9 W (13 W when “Quick Start” is set to “On”)
Average annual energy consumption*2		57 kWh
Laser		Type: Semiconductor, continuous DVD Wavelength: 645 - 660 nm Power: Max 6 mW CD Wavelength: 770 - 800 nm Power: Max 7 mW
Dimensions (Approx.) (w × h × d)		
with Table-Top Stand		57.5 × 42.9 × 25.3 cm
Mass (Approx.)		
with Table-Top Stand		9.8 kg
Supplied accessories		See “Checking the accessories” (page 3).

Model name KDL-	22PX300
Operating temperature	5 °C to 35 °C

*1 Specified standby power is reached after the TV finishes necessary internal processes.

*2 4 hours a days and 365 days a year



• To save power consumption

– when you reduce backlight setting (the brightness of the screen), the power consumption reduce.

– the “Eco” settings (e.g. “Power Saving”, “Idle TV Standby”) help you to reduce the power consumption and thus save money by reducing electricity bills.

Design and specifications are subject to change without notice.

Optional accessories

When purchasing optional accessories, be sure to purchase those that are compatible with this model of the PlayStation™2 console.

About the DVD remote control (for PlayStation™2)

When purchasing a new DVD remote control, choose model number SCPH-10420 E which does not include the IR receiver unit (for PlayStation™2).

Accessories not compatible with this model

The following accessories for the PlayStation™ console and the PlayStation™2 console are not compatible with this model of the PlayStation™2 console.

Product name
Network Adaptor (Ethernet) (for PlayStation™2)
Multitap
Vertical stand (for PlayStation™2)
Horizontal stand (for PlayStation™2)
Products that use the  S400 i.LINK connector
Component AV Cable
Component AV Cable (for PlayStation™2)
Euro-AV Cable
RFU Adaptor

Safety Information

Installation/Set-up

Install and use the TV set in accordance with the instructions below in order to avoid any risk of fire, electrical shock or damage and/or injuries.

Installation

- The TV set should be installed near an easily accessible mains socket.
- Place the TV set on a stable, level surface.
- Only qualified service personnel should carry out wall installations.

Transporting

- Before transporting the TV set, disconnect all cables.
- When transporting the TV set by hand, hold it as shown on the right. Do not put stress on the LCD panel and the frame around the screen.
- When lifting or moving the TV set, hold it firmly from the bottom.
- When transporting the TV set, do not subject it to jolts or excessive vibration.
- When transporting the TV set for repairs or when moving, pack it using the original carton and packing material.

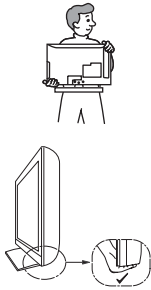

Ventilation

- Never cover the ventilation holes or insert anything in the cabinet.
- Leave space around the TV set as shown below.

Installed with stand

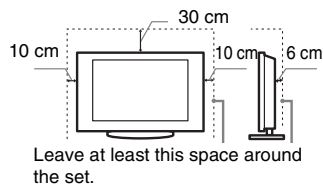

- To ensure proper ventilation and prevent the collection of dirt or dust:
 - Do not lay the TV set flat, install upside down, backwards, or sideways.
 - Do not place the TV set on a shelf, rug, bed or in a closet.
 - Do not cover the TV set with a cloth, such as curtains, or items such as newspapers, etc.

- Do not install the TV set as shown below.

Air circulation is blocked.

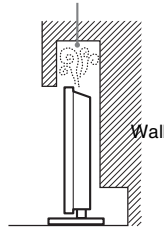

Mains lead

Handle the mains lead and socket as follows in order to avoid any risk of fire, electrical shock or damage and/or injuries:

- Use only mains leads supplied by Sony, not other suppliers.
- Insert the plug fully into the mains socket.
- Operate the TV set on a 220-240 V AC supply only.
- When wiring cables, be sure to unplug the mains lead for your safety and take care not to catch your feet on the cables.
- Disconnect the mains lead from the mains socket before working on or moving the TV set.
- Keep the mains lead away from heat sources.
- Unplug the mains plug and clean it regularly. If the plug is covered with dust and it picks up moisture, its insulation may deteriorate, which could result in a fire.

Notes

- Do not use the supplied mains lead on any other equipment.
- Do not pinch, bend, or twist the mains lead excessively. The core conductors may be exposed or broken.
- Do not modify the mains lead.
- Do not put anything heavy on the mains lead.
- Do not pull on the mains lead itself when disconnecting the mains lead.
- Do not connect too many appliances to the same mains socket.
- Do not use a poor fitting mains socket.

Prohibited Usage

Do not install/use the TV set in locations, environments or situations such as those listed below, or the TV set may malfunction and cause a fire, electrical shock, damage and/or injuries.

Location:

Outdoors (in direct sunlight), at the seashore, on a ship or other vessel, inside a vehicle, in medical institutions, unstable locations, near water, rain, moisture or smoke.

Environment:

Places that are hot, humid, or excessively dusty; where insects may enter; where it might be exposed to mechanical vibration, near flammable objects (candles, etc). The TV set shall not be exposed to dripping or splashing and no objects filled with

liquids, such as vases, shall be placed on the TV.

Situation:

Do not use when your hands are wet, with the cabinet removed, or with attachments not recommended by the manufacturer. Disconnect the TV set from mains socket and aerial during lightning storms.

Broken pieces:

- Do not throw anything at the TV set. The screen glass may break by the impact and cause serious injury.
- If the surface of the TV set cracks, do not touch it until you have unplugged the mains lead. Otherwise electric shock may result.

When not in use

- If you will not be using the TV set for several days, the TV set should be disconnected from the mains for environmental and safety reasons.
- As the TV set is not disconnected from the mains when the TV set is just turned off, pull the plug from the mains to disconnect the TV set completely.
- However, some TV sets may have features that require the TV set to be left in standby to work correctly.

For children

- Do not allow children to climb on the TV set.
- Keep small accessories out of the reach of children, so that they are not mistakenly swallowed.

If the following problems occur...

Turn off the TV set and unplug the mains lead immediately if any of the following problems occur.

Ask your dealer or Sony service centre to have it checked by qualified service personnel.

When:

- Mains lead is damaged.
- Poor fitting of mains socket.
- TV set is damaged by being dropped, hit or having something thrown at it.
- Any liquid or solid object falls through openings in the cabinet.

Warning

To prevent the spread of fire, keep candles or other open flames away from this product at all time.



Precautions

Viewing the TV

- View the TV in moderate light, as viewing the TV in poor light or during long period of time, strains your eyes.
- When using headphones, adjust the volume so as to avoid excessive levels, as hearing damage may result.

LCD Screen

- Although the LCD screen is made with high-precision technology and 99.99% or more of the pixels are effective, black dots may appear or bright points of light (red, blue, or green) may appear constantly on the LCD screen. This is a structural property of the LCD screen and is not a malfunction.
- Do not push or scratch the front filter, or place objects on top of this TV set. The image may be uneven or the LCD screen may be damaged.
- If this TV set is used in a cold place, a smear may occur in the picture or the picture may become dark. This does not indicate a failure. These phenomena disappear as the temperature rises.
- Ghosting may occur when still pictures are displayed continuously. It may disappear after a few moments.
- The screen and cabinet get warm when this TV set is in use. This is not a malfunction.
- The LCD screen contains a small amount of liquid crystal. Some fluorescent tubes used in this TV set also contain mercury. Follow your local ordinances and regulations for disposal.

Handling and cleaning the screen surface/cabinet of the TV set

Be sure to unplug the mains lead connected to the TV set from mains socket before cleaning.

To avoid material degradation or screen coating degradation, observe the following precautions.

- To remove dust from the screen surface/cabinet, wipe gently with a soft cloth. If dust is persistent, wipe with a soft cloth slightly moistened with a diluted mild detergent solution.
- Do not spray water or detergent directly on the TV set. It may drip to the bottom of the screen or exterior parts, and may cause a malfunction.
- Never use any type of abrasive pad, alkaline/acid cleaner, scouring powder, or volatile solvent, such as alcohol, benzene, thinner or insecticide. Using such materials or maintaining prolonged contact with rubber or vinyl materials may result in damage to the screen surface and cabinet material.
- Periodic vacuuming of the ventilation openings is recommended to ensure to proper ventilation.
- When adjusting the angle of the TV set, move it slowly so as to prevent the TV set from moving or slipping off from its table stand.

Optional Equipment

- Keep optional components or any equipment emitting electromagnetic radiation away from the TV set. Otherwise picture distortion and/or noisy sound may occur.
- This equipment has been tested and found to comply with the limits set out in

the EMC Directive using a connection signal cable shorter than 3 meters.

Batteries

- Observe the correct polarity when inserting batteries.
- Do not use different types of batteries together or mix old and new batteries.
- Dispose of batteries in an environmentally friendly way. Certain regions may regulate the disposal of batteries. Please consult your local authority.
- Handle the remote with care. Do not drop or step on it, or spill liquid of any kind onto it.
- Do not place the remote in a location near a heat source, a place subject to direct sunlight, or a damp room.

Disposal of the TV set



Disposal of Old Electrical & Electronic Equipment (Applicable in the European

Union and other European countries with separate collection systems)

This symbol on the product or on its packaging indicates that this product shall not be treated as household waste. Instead it shall be handed over to the applicable collection point for the recycling of electrical and electronic equipment. By ensuring this product is disposed of correctly, you will help prevent potential negative consequences for the environment and human health, which could otherwise be caused by inappropriate waste handling of this product. The recycling of materials will help to conserve natural resources. For more detailed information about recycling of this product, please contact your local Civic Office, your household waste disposal service or the shop where you purchased the product.



Pb



Disposal of waste batteries (applicable in the European Union and other European countries with separate collection systems)

This symbol on the battery or on the packaging indicates that the battery provided with this product shall not be treated as household waste. On certain batteries this symbol might be used in combination with a chemical symbol. The chemical symbols for mercury (Hg) or lead (Pb) are added if the battery contains more than 0.0005% mercury or 0.004% lead. By ensuring these batteries are disposed of correctly, you will help prevent potentially negative consequences for the environment and human health

which could otherwise be caused by inappropriate waste handling of the battery. The recycling of the materials will help to conserve natural resources. In case of products that for safety, performance or data integrity reasons require a permanent connection with an incorporated battery, this battery should be replaced by qualified service staff only. To ensure that the battery will be treated properly, hand over the product at end-of-life to the applicable collection point for the recycling of electrical and electronic equipment. For all other batteries, please view the section on how to remove the battery from the product safely. Hand the battery over to the applicable collection point for the recycling of waste batteries. For more detailed information about recycling of this product or battery, please contact your local Civic Office, your household waste disposal service or the shop where you purchased the product.

Warning about PlayStation™2

Caution

Use of controls or adjustments or performance of procedures other than those specified herein may result in hazardous radiation exposure. The use of optical instruments with this product will increase eye hazard.

CLASS 1 LASER PRODUCT
LUOKAN 1 LASERLAITE
KLASS 1 LASERAPPARAT

This appliance is classified as a CLASS 1 LASER product under IEC60825-1: 2001.

Read carefully before operating your PlayStation™2 console

A few people may experience epileptic seizures when viewing flashing lights or patterns in our daily environment. These persons may experience seizures while watching TV or playing video games, including DVD-Videos or games played on the PlayStation™2 console. Players who have not had any seizures may nonetheless have an undetected epileptic condition. Consult your physician before operating the PlayStation™2 console if you have an epileptic condition or experience any of the following symptoms while watching TV programmes or playing video games: altered vision, muscle twitching, other involuntary movements, loss of awareness of your surroundings, mental confusion, and/or convulsions.

Software title compatibility

Some PlayStation™ or PlayStation™2 format software titles may perform differently on this console than they do on previous PlayStation™2 or PlayStation™ consoles, or may not perform properly on this console. For more information, visit our Web site at www.eu.playstation.com/ps2.

Precautions about PlayStation™2

Safety

This product has been designed with the highest concern for safety. However, any electrical device, if used improperly, has the potential for causing fire, electrical shock or personal injury. To help ensure accident-free operation, follow these guidelines:

- Observe all warnings, precautions and instructions.
- Stop use and unplug the AC power cord from the electrical outlet immediately if the device functions in an abnormal manner or produces unusual sounds or smells.
- Never connect cables other than those specified in this manual to the network connector.
- Contact the appropriate PlayStation™ customer service helpline which can be found within every PlayStation™ and PlayStation™2 format software manual if the device does not operate properly.

Use and handling

- When operating the unit, play in a well-lit room and keep a safe distance from the TV screen.
- Avoid prolonged use of the console. To help prevent eye strain, take a break of about 15 minutes during every hour of play.
- Stop using the console immediately if you experience any of the following symptoms. If the condition persists, consult a doctor.
 - Lightheadedness, nausea, or a sensation similar to motion sickness
 - Tired, uncomfortable or aching hands or arms
 - Tired, dry or aching eyes
- Do not use the console near water.
- Do not place the console and connected accessories on the floor or in a place where they may cause persons walking by to trip or stumble.
- Do not place the console or accessories on surfaces that are unstable, tilted or subject to vibration.
- Do not expose the console or accessories to high temperatures, high humidity or direct sunlight (use in an environment where temperatures range from 5°C to 35°C/41°F to 95°F).
- Do not place the console in locations of poor ventilation such as small, enclosed areas, directly against a wall or on a thick carpet or bedding.
- Do not expose the console to dust, smoke or steam.
- Do not allow liquid or small particles to get into the console.
- Do not put any objects on the console.
- Do not touch or insert foreign objects into the connectors of the console or accessories.
- Do not allow dust or foreign matter to build up around the console vents. Remove the dust with a low-powered vacuum cleaner.
- Do not leave a disc in the console when moving or changing the position of the console.

- Do not touch a disc while it is spinning.
- Do not close the disc cover in a way that could pinch your hand or fingers.
- Adjust the settings of the DVD player according to the instructions provided before playing a DVD.
- Keep the console and accessories, including cable ties and fasteners, out of the reach of small children.

When using software that supports the vibration function of the analog controller (DUALSHOCK®2)

Do not use the vibration function if you have any ailment or injury to the bones, joints or muscles of your hands or arms. In most cases, the vibration function can be set to "Off" in the options menu of the software.

Network (except Local Area Networks)

- A broadband Internet connection is required to connect to a network.
- When you connect your PlayStation™2 console to a network, the Internet service provider may charge additional usage fees. In some cases, usage charges may be more than anticipated. For details, refer to the information provided in your service contract or contact your Internet service provider.
- Parents are encouraged to monitor children in online gaming to ensure safe and responsible Internet usage.

Connecting with an Ethernet cable

Do not connect Ethernet cables or telephone cords of the following types to the network connector:

- Ethernet cables not appropriate for use with a 10Base-T/100Base-TX network
- Standard residential telephone lines
- Any ISDN (digital) compatible phone or data line
- PBX phone lines
- Other "unknown" types of telephone lines

Disc handling

- Do not touch the disc surface when handling a disc; hold it by the edges.
- Do not stick paper or tape onto discs and do not write on discs.
- Fingerprints, dust, dirt or scratches on the disc can distort the picture or reduce sound quality. Always handle carefully and make sure discs are clean before use.
- Do not leave discs near a heat source, in direct sunlight or in high humidity.
- Store discs in their cases when not in use.
- Clean discs using a soft cloth, lightly wiping from the centre outwards. Do not use solvents such as benzene, commercially available cleaners not intended for CDs or anti-static spray intended for vinyl LPs.
- Do not use irregularly shaped discs (for example, heart- or star-shaped discs) or damaged, reshaped or repaired discs.

Never disassemble the console or supplied accessories

Use the PlayStation™2 console and accessories according to the instructions in the product documentation. No authorization for the analysis or modification of the console, or the analysis and use of its circuit configurations, is provided. There are no user serviceable components inside the PlayStation™2 console. Disassembling the console will void the warranty. Additionally, there is a risk of exposure to laser radiation as well as to electrical shock hazards.

Note on safety when playing DVDs or CDs

If you set the volume too high, it may harm your hearing or damage the speakers. Exercise care when setting the volume.

Moisture condensation

If the console or disc is brought directly from a cold location to a warm one, moisture may condense on the lens inside the console or on the disc. Should this occur, the console may not operate properly. In this case, remove the disc and turn off and unplug the console. Do not put the disc back in until the moisture evaporates (this may take several hours). If the console still does not operate properly, contact the appropriate PlayStation™ customer service helpline which can be found within every PlayStation™ and PlayStation™2 format software manual.

Cleaning

- For safety reasons, before cleaning the console or connected accessories, 1) turn off the console, 2) disconnect the mains power plug for the console from the electrical outlet, and 3) disconnect the Ethernet cable from the console.
- When cleaning the console, use a soft, dry cloth. Do not use solvents or other chemicals or a chemically-treated dust cloth to clean the product.
- Do not touch the lens located inside the disc cover. To help protect the lens from dust, keep the disc cover closed except when inserting or removing discs.
- The cooling fan maintains low temperature inside the PlayStation™2 console. If there is dust around the ventilation holes, temperature may rise inside of the PlayStation™2 console and result in malfunction. Clean the ventilation holes on the side and rear of the PlayStation™2 console regularly (preferably once a month).

Exterior protection

To help prevent damage to the painted parts, follow the precautions below:

- Do not spill liquids such as alcohol, solvents or other chemicals on the product.
- Do not place any rubber or vinyl materials on the console exterior for an extended period of time.

Keep this important information about how to re-tune your TV during the digital TV switchover

Keep this Instruction manual safe you'll need it

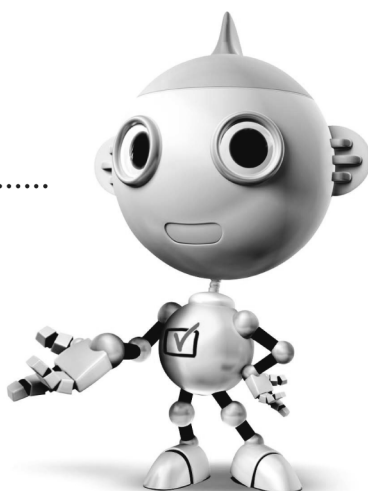

Television in the UK is going digital, bringing us all more.

Please see overleaf to find out when your area switches to digital.

Digital UK is the independent, non-profit organisation leading the process of digital TV switchover in the UK. Digital UK provides impartial information on what people need to do to prepare for the move to digital, and when they need to do it.

How the switchover affects your TV equipment:

Your new TV has a digital tuner built in, which means it is ready to receive the Freeview signal by simply plugging it into your aerial socket (check if you can get digital TV through your aerial now, or whether you'll have to wait until switchover, at www.digitaluk.co.uk).

When the TV switchover happens in your area, there are at least two occasions when you will need to re-tune your TV in order to continue receiving your existing TV channels, and also to pick up new ones. Digital UK, the body leading the digital TV switchover, will advise you when you need to re-tune during the switchover.

How to re-tune:

- 1 Press "**HOME**" on the remote
- 2 Press ⇄ to select "Settings"
- 3 Press ⇄ to select "Digital Set-up", then press ⊕
- 4 Press ⊕ to select "Digital Auto Tuning"
- 5 Press ⇄ to select "Yes" then press ⊕ to start "Digital Auto Tuning"
- 6 Follow the on screen instructions.

If you are missing any channels, it may be that they are not available in your area, or that your aerial needs upgrading.

If you have any questions, please contact Sony on **08705 111 999** or call Digital UK on **0845 6 50 50 50** or visit www.digitaluk.co.uk

When does switchover happen?

*Copeland switches on October 17, 2007



The exact date you switch depends on the transmitter you are served by. To check when you switch, go to Digital UK's postcode checker on www.digitaluk.co.uk

Check your ITV news service or look at Teletext page 106 to see what TV region you're in.



Visit us at digitaluk.co.uk call us on **0845 6 50 50 50**†

†Calls charged at BT rate of 3p per minute daytime and 1p per minute evenings and weekends. Rates may vary for calls from non-BT lines.



For useful information about Sony products

<http://www.sony-europe.com/myproduct/>



4256733121

4-256-733-12(1)

<http://www.sony.net/>

© 2010 Sony Corporation